

PROJECT REFERENCE NO. <b>R-5014</b>	SHEET NO. <i>EC-16/CONST.16</i>
RW SHEET NO. ROADWAY DESIGN ENGINEER	HYDRAULICS ENGINEER

-L-  
 PI Sta 187+68.88  
 $\Delta = 43^{\circ}02'44.8"$  (RT)  
 $D = 4^{\circ}30'00.0"$   
 $L = 956.57'$   
 $T = 502.13'$   
 $R = 1273.24'$   
 SE = EXIST.  
 $V = 55$  MPH

ALL CONSTRUCTION PERFORMED OUTSIDE OF THE EXISTING RIGHT OF WAY IS ALLOWED THROUGH SPECIAL USE PERMIT # USA 18 5700 16

NO CLAIM

132  
 UNITED STATES DEPARTMENT OF INTERIOR  
 DB 78 - PG 206

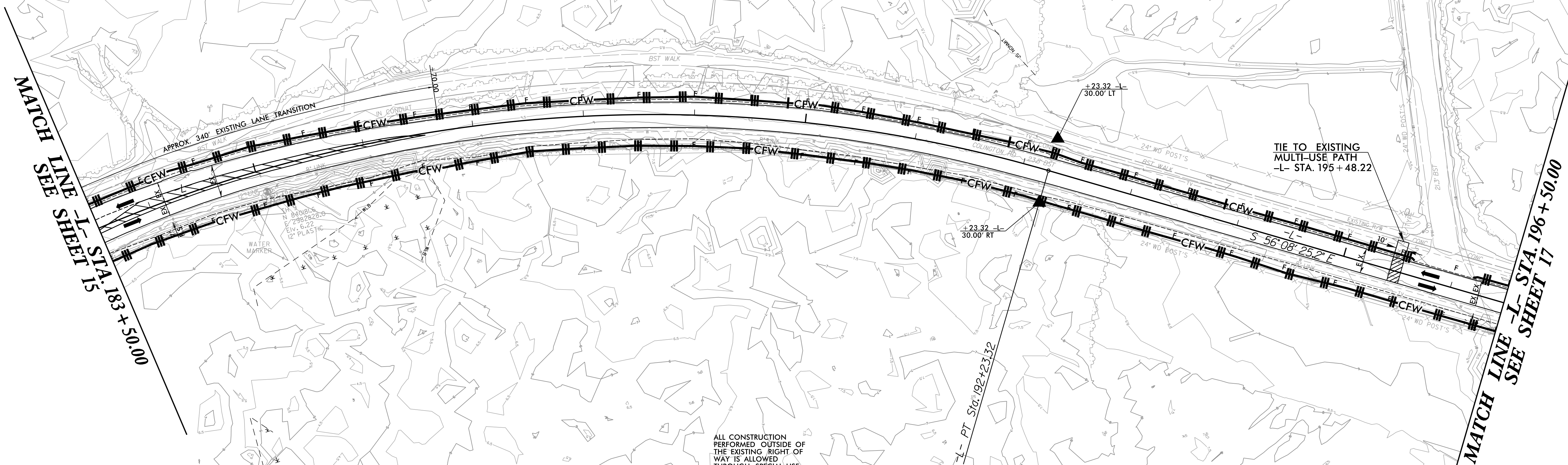

ALL CONSTRUCTION PERFORMED OUTSIDE OF THE EXISTING RIGHT OF WAY IS ALLOWED THROUGH SPECIAL USE PERMIT # USA 18 5700 16

NO CLAIM

133  
 UNITED STATES DEPARTMENT OF INTERIOR  
 DB 78 - PG 206

CLEARING AND GRUBBING  
 EROSION CONTROL FOR  
 CONSTRUCTION SHEET 16

NOTE:  
 PLACE TEMPORARY ROCK SEDIMENT DAMS TYPE - B  
 AND TEMPORARY ROCK SILT CHECKS TYPE - A AT  
 DRAINAGE OUTLETS.

PAVED SHOULDER

NOTES:  
 DRIVEWAY RADII ARE 10' UNLESS OTHERWISE NOTED  
 SEE SHEET 27 FOR -L- PROFILE

REVISIONS

8/17/99  
 I:\5/2008\Projects\Commentary\Design\RE014\_hyd\_EC\_psh\_16.dgn  
 16/08/2008 10:50:00 AM  
 16/08/2008 10:50:00 AM  
 16/08/2008 10:50:00 AM