

GEOTECHNICAL ENGINEER

ENGINEER

SEAL 45898

DocuSigned by:
Jesse Norris
2/28/2019

SIGNATURE DATE SIGNATURE DATE

**DOCUMENT NOT CONSIDERED FINAL
UNLESS ALL SIGNATURES COMPLETED**

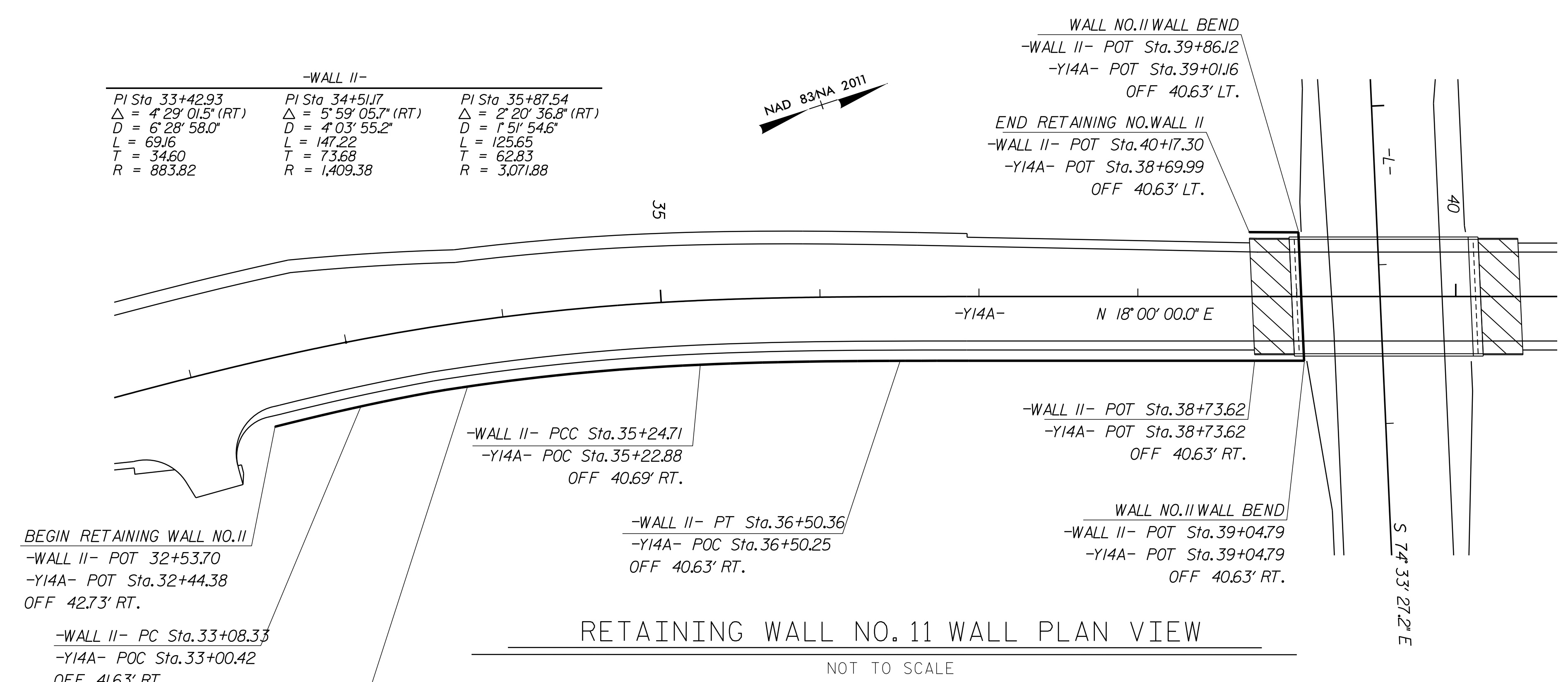

ESTIMATED MSE WALL QUANTITY
(SQUARE FEET)

MSE RETAINING WALL NO. 11	14,880 SF
---------------------------	-----------

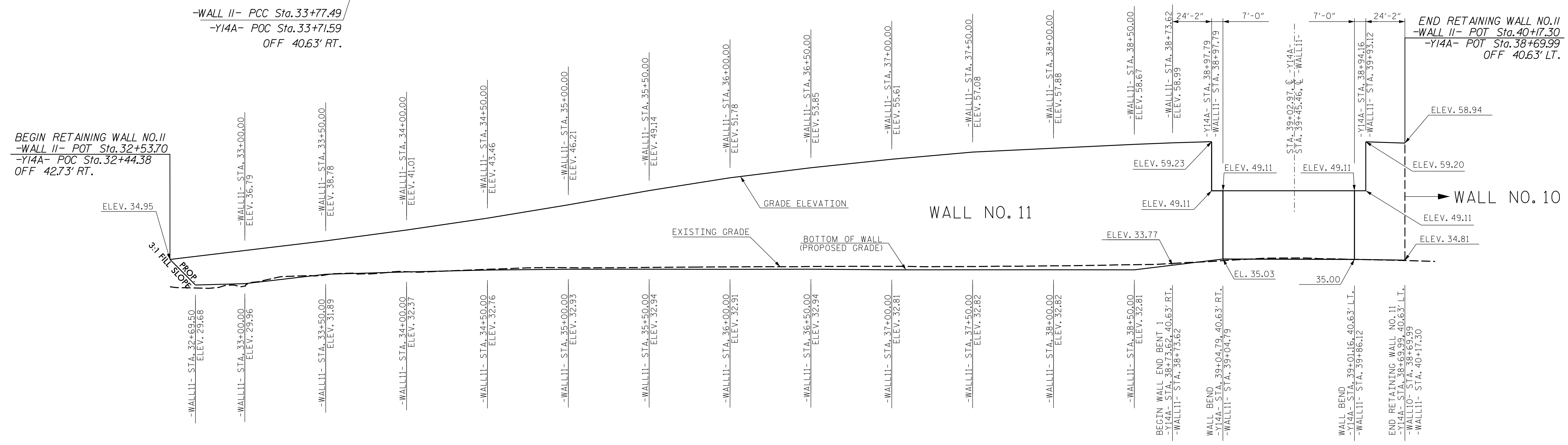

RETAINING WALL NO. 11 WALL ENVELOPE
EXPOSED WALL FACE VIEW - NOT TO SCALE
THE WALL ENVELOPE DOES NOT ACCURATELY DEPICT THE ACTUAL FACE OF THE WALL

PROJECT NO.: R-5021
BRUNSWICK COUNTY
STATION: 39+52.37 -Y14A-
SHEET 4 OF 6

PREPARED BY: J. NORRIS	DATE: 02/25/19
REVIEWED BY: J. NORRIS	DATE: 02/25/19

Prepared in the Office of:

CATLIN
Engineers and Scientists
Wilmington, North Carolina

**NORTH CAROLINA
DEPARTMENT OF TRANSPORTATION
DIVISION OF HIGHWAYS**

**GEOTECHNICAL
ENGINEERING UNIT**

**MSE RETAINING WALL NO. 11
PLAN AND ENVELOPE**

REVISIONS						SHEET NO.
NO.	BY	DATE	NO.	BY	DATE	
1	-	-	3	-	-	W-15
2	-	-	4	-	-	