

**NOTES:**  
 FOR CONCRETE BARRIER RAIL DIMENSIONS, REINFORCING STEEL, AND JOINT SPACING, SEE "CONCRETE BARRIER RAIL" SHEET.  
 FOR SECTION VIEW, SEE "SUPERSTRUCTURE TYPICAL SECTION DETAILS" SHEET 2 OF 2.  
 FOR INTERMEDIATE STEEL DIAPHRAGMS, SEE "INTERMEDIATE STEEL DIAPHRAGMS FOR 72" MODIFIED BULB TEE PRESTRESSED CONCRETE GIRDER" SHEET FOR DETAILS. FOR LOCATION, SEE "SUPERSTRUCTURE FRAMING PLAN" SHEET.  
 GROOVED CONTRACTION JOINTS, 1/2" IN DEPTH, SHALL BE TOOLED IN ALL EXPOSED FACES OF THE MEDIAN STRIP IN ACCORDANCE WITH ARTICLE 825-10(B) OF THE STANDARD SPECIFICATIONS. THE CONTRACTION JOINTS SHALL BE LOCATED AT A SPACING OF 8 FT TO 10 FT BETWEEN EXPANSION JOINTS. NO CONTRACTION JOINTS WILL BE REQUIRED FOR SEGMENTS LESS THAN 10 FEET IN LENGTH.

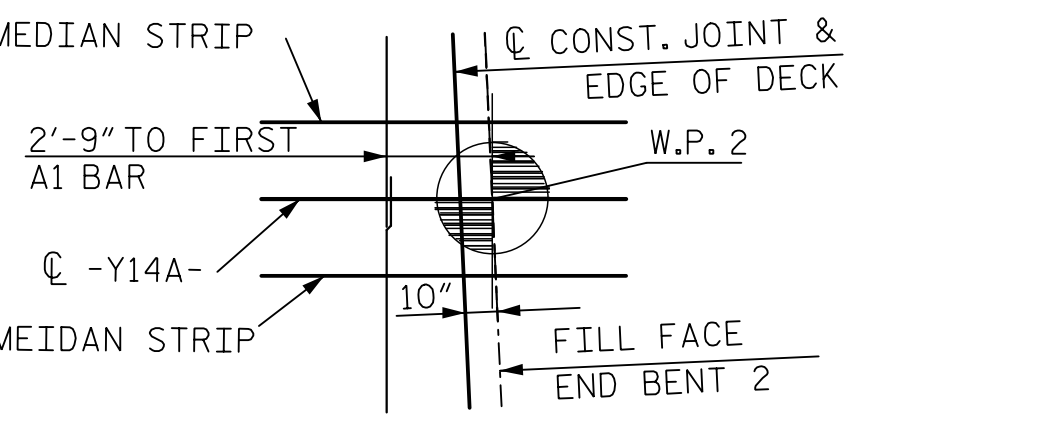

PLAN

PROJECT NO. R-5021  
 BRUNSWICK COUNTY  
 STATION: 39+52.37 -Y14A-

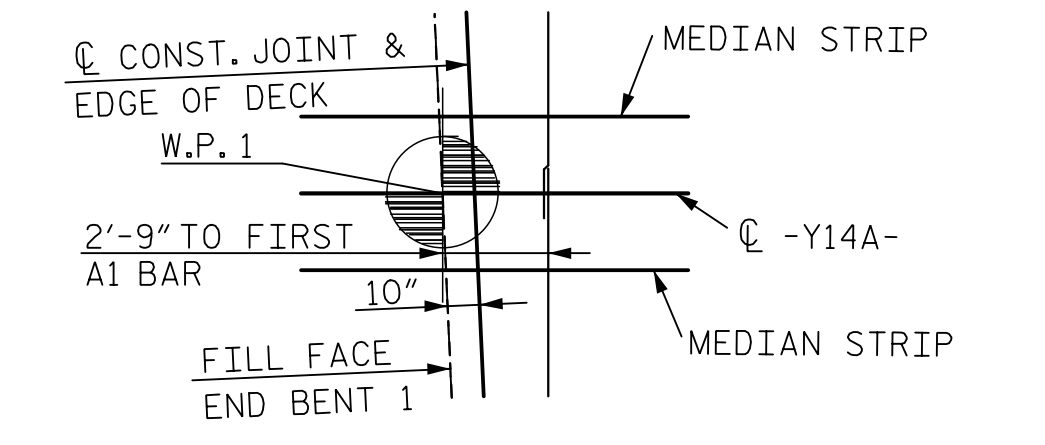
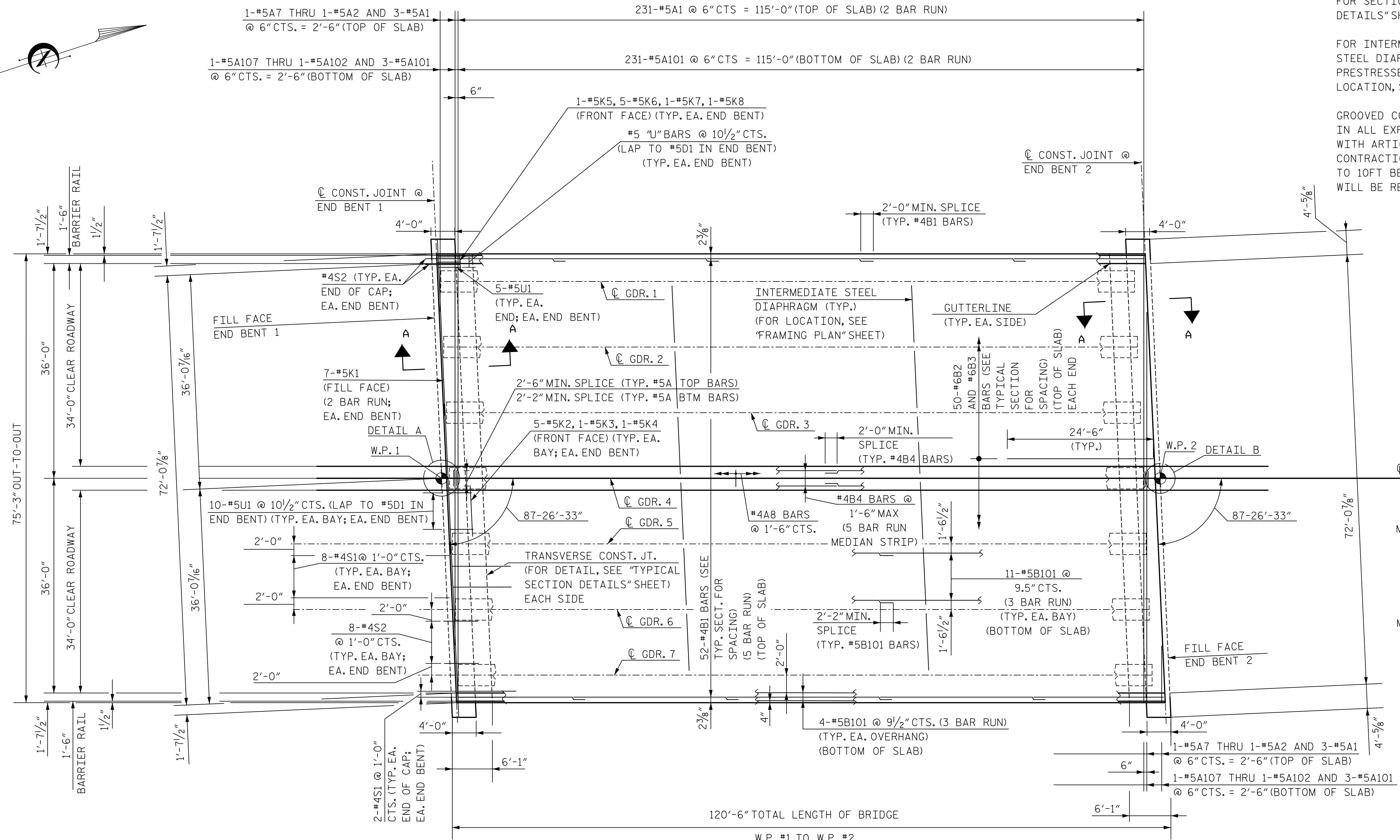
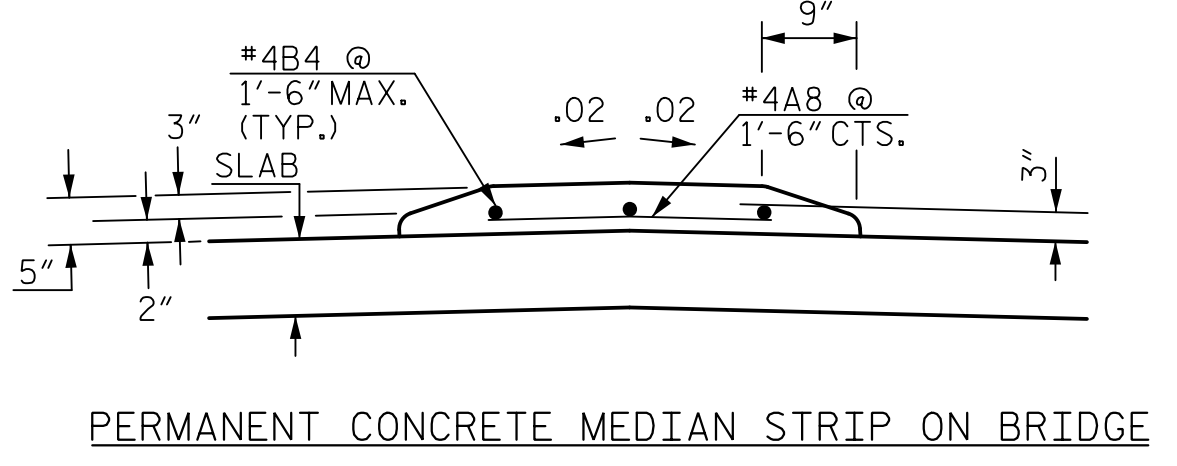
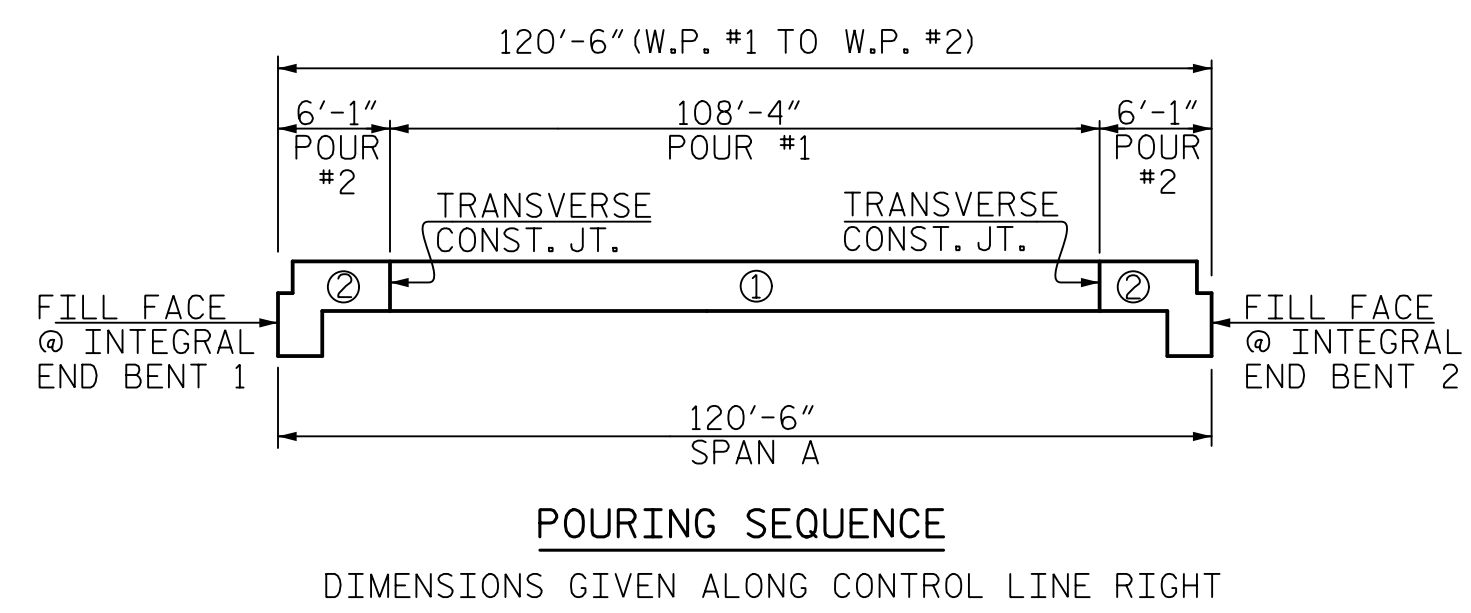

DocuSigned by:  
 HNTB North Carolina, P.C.  
 SEAL 046234  
 ENGINEER  
 BRUCE BOSLEY  
 12/7/2018  
 SEAL 12916  
 ENGINEER  
 PAUL J. BARBER  
 12/7/2018

DOCUMENT NOT CONSIDERED FINAL UNLESS ALL SIGNATURES COMPLETED

<b>HNTB</b>		HNTB NORTH CAROLINA, P.C. NC License No. C-1554 343 E. Six Forks Rd., Suite 200, Raleigh, N.C. 27609	
DRAWN BY: A. GOFF	DATE: 7/18	DWG. NO. 7	
CHECKED BY: J. ELKINS	DATE: 7/18		
DESIGN ENGINEER OF RECORD: B. BOSLEY	DATE: 12/18		

STATE OF NORTH CAROLINA DEPARTMENT OF TRANSPORTATION RALEIGH		SUPERSTRUCTURE PLAN OF SPAN A			
REVISIONS					
NO.	BY	DATE	NO.	BY	DATE
1			3		
2			4		
SHEET NO. S4-7			TOTAL SHEETS 24		