

UTILITIES BY OTHERS

NOTE:
 ALL UTILITY WORK SHOWN ON THIS SHEET WILL BE DONE BY OTHERS. NO PAYMENT WILL BE MADE TO THE CONTRACTOR FOR UTILITY WORK SHOWN ON THIS SHEET.

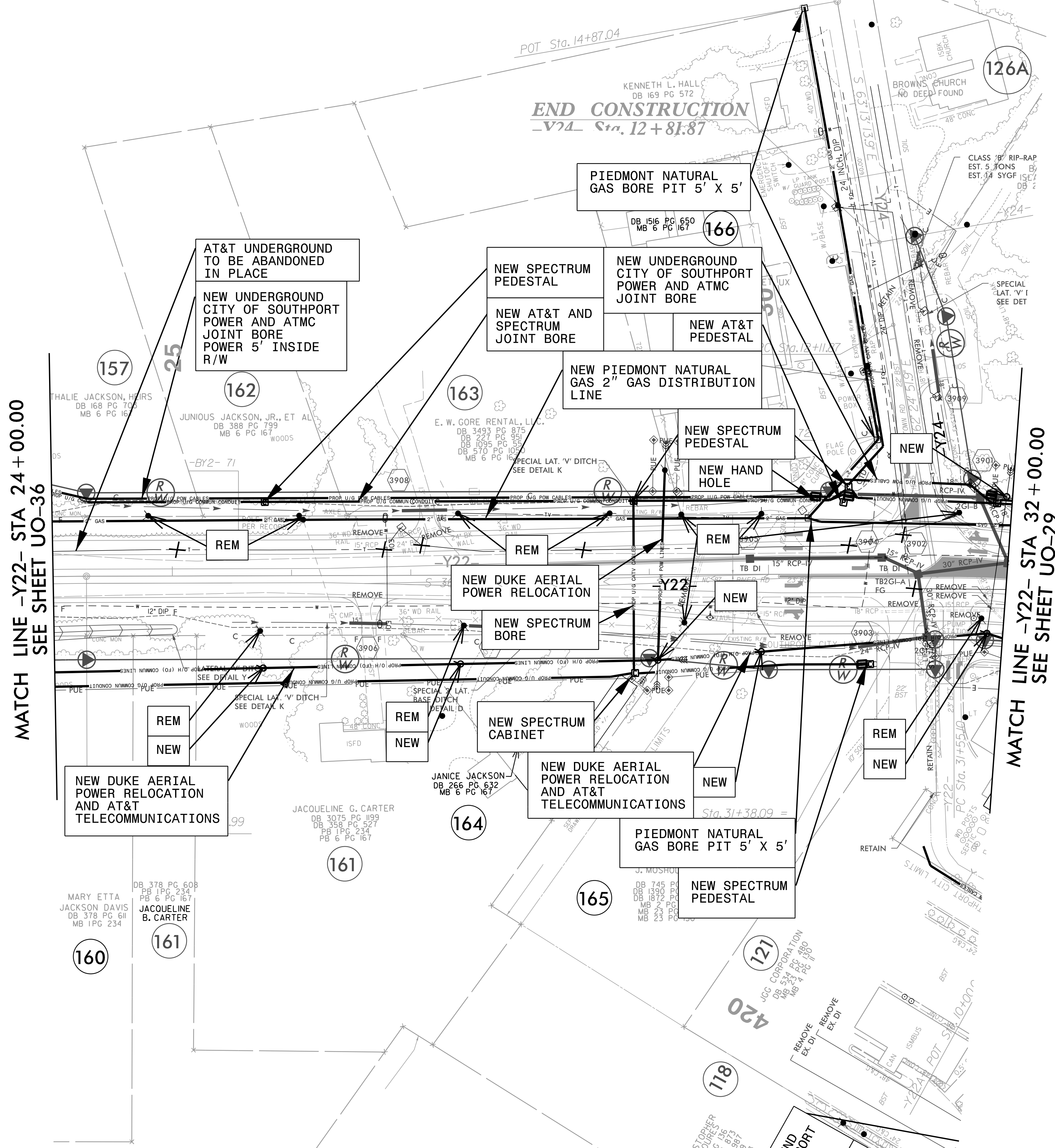
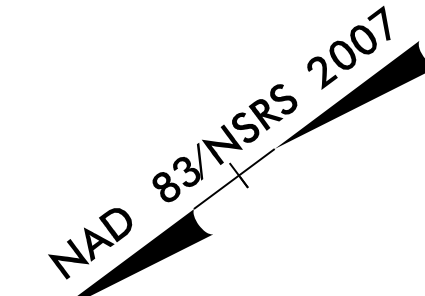

MATCH LINE -Y22- STA 24+00.00
SEE SHEET UO-36

MATCH LINE -Y22- STA 32+00.00
SEE SHEET UO-29

NOTE:
 1. PIEDMONT NATURAL GAS WILL OPEN TRENCH CUT ALL GAS LINE THAT IS LESS THAN 100', EXCEPT IN WETLAND AREAS

UTILITY OWNERS ON THIS SHEET

- DUKE ENERGY - POWER (DIST)
- CITY OF SOUTHPORT POWER - POWER (DIST)
- AT&T - TELECOMMUNICATIONS/FIBER OPTIC
- AT&T - TELECOMMUNICATIONS/FIBER OPTIC
- SPECTRUM - CATV
- PIEDMONT NATURAL GAS - NATURAL GAS

PLANS PREPARED BY :



2/19/2018 \\Fs-sr-v02\w\Projects\2013\1311\Utility_Coordination_(NCD01)\DOLR-5021\NR-5021\Utilities\Engineering\UBOs\Proj\00-R-5021\UBOs_Dry_ONL_Y.R-5021\ut_r_dy39_U037_psh.dgn
 5/14/99