

UTILITIES BY OTHERS

ALL PROPOSED UTILITY WORK SHOWN ON THIS SHEET WILL BE DONE BY OTHERS. NO PAYMENT WILL BE MADE TO THE CONTRACTOR FOR PROPOSED UTILITY WORK SHOWN ON THIS SHEET.

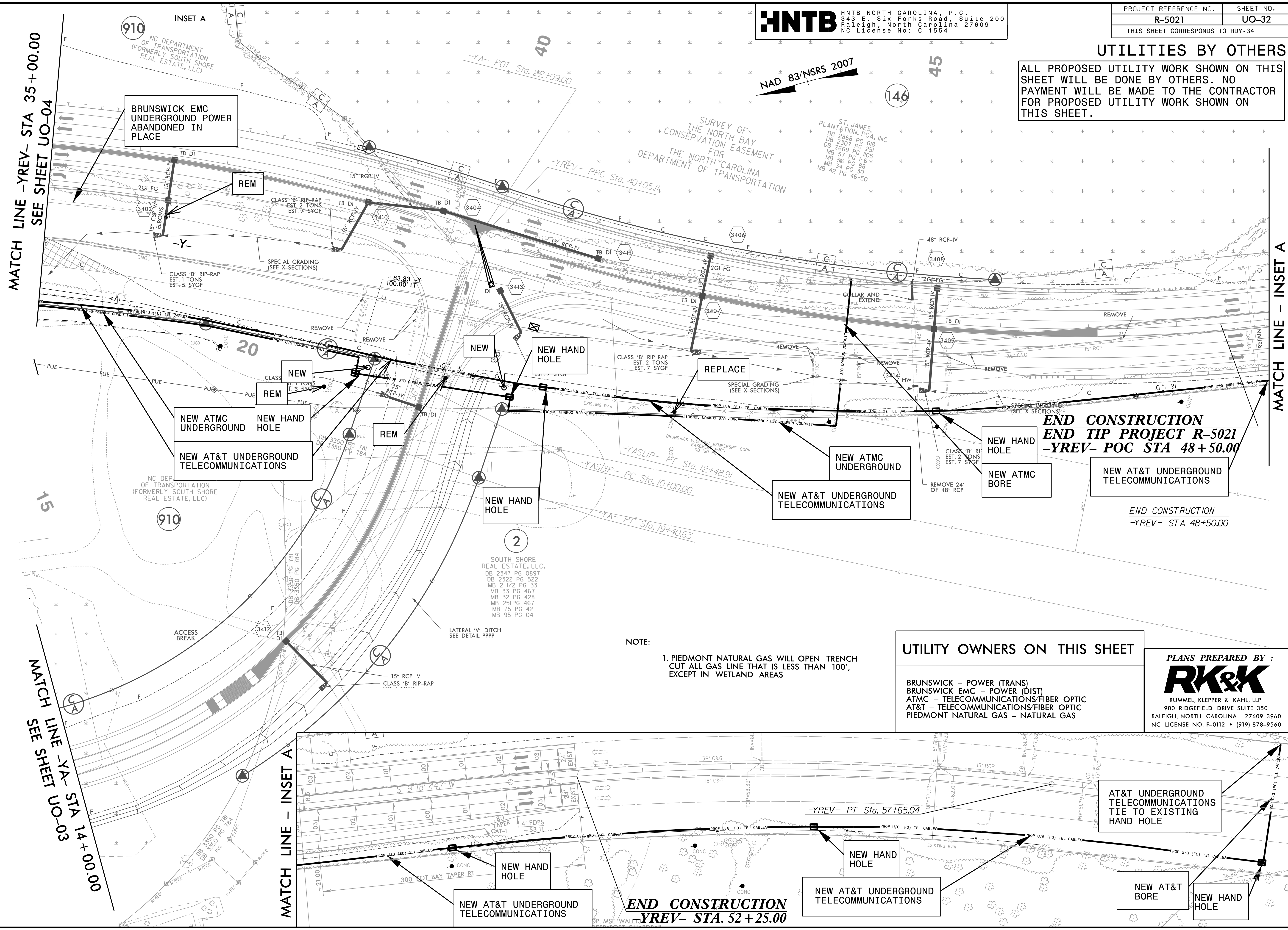

MATCH LINE -YREV- STA 35+00.00
SEE SHEET UO-04

MATCH LINE -YA- STA 14+00.00
SEE SHEET UO-03

MATCH LINE - INSET A

INSET A

MATCH LINE - INSET A

NOTE:
 1. PIEDMONT NATURAL GAS WILL OPEN TRENCH CUT ALL GAS LINE THAT IS LESS THAN 100', EXCEPT IN WETLAND AREAS

UTILITY OWNERS ON THIS SHEET

- BRUNSWICK - POWER (TRANS)
- BRUNSWICK EMC - POWER (DIST)
- ATMC - TELECOMMUNICATIONS/FIBER OPTIC
- AT&T - TELECOMMUNICATIONS/FIBER OPTIC
- PIEDMONT NATURAL GAS - NATURAL GAS

PLANS PREPARED BY :
RK&K
 RUMMEL, KLEPPER & KAHL, LLP
 900 RIDGEFIELD DRIVE SUITE 350
 RALEIGH, NORTH CAROLINA 27609-3960
 NC LICENSE NO. F-0112 • (919) 878-9560

END CONSTRUCTION
END TIP PROJECT R-5021
-YREV- POC STA 48+50.00

END CONSTRUCTION
-YREV- STA 48+50.00

END CONSTRUCTION
-YREV- STA. 52+25.00

AT&T UNDERGROUND TELECOMMUNICATIONS TIE TO EXISTING HAND HOLE

NEW AT&T UNDERGROUND TELECOMMUNICATIONS

NEW AT&T BORE

NEW HAND HOLE

NEW AT&T UNDERGROUND TELECOMMUNICATIONS

NEW ATMC UNDERGROUND

NEW HAND HOLE

NEW ATMC UNDERGROUND

NEW HAND HOLE

NEW AT&T UNDERGROUND TELECOMMUNICATIONS

NEW HAND HOLE

NEW AT&T UNDERGROUND TELECOMMUNICATIONS

REPLACE

NEW AT&T UNDERGROUND TELECOMMUNICATIONS

NEW ATMC UNDERGROUND

NEW AT&T UNDERGROUND TELECOMMUNICATIONS

NEW HAND HOLE

NEW ATMC BORE

NEW AT&T UNDERGROUND TELECOMMUNICATIONS

BRUNSWICK EMC UNDERGROUND POWER ABANDONED IN PLACE

REM

CLASS 'B' RIP-RAP EST. 1 TONS EST. 5 SYGF

SPECIAL GRADING (SEE X-SECTIONS)

CLASS 'B' RIP-RAP EST. 2 TONS EST. 7 SYGF

SOUTH SHORE REAL ESTATE, L.L.C.
 DB 2347 PG 0897
 DB 2322 PG 522
 MB 2 1/2 PG 33
 MB 33 PG 467
 MB 32 PG 428
 MB 25 PG 467
 MB 75 PG 42
 MB 95 PG 04

LATERAL 'V' DITCH SEE DETAIL PPPP

NC DEP. OF TRANSPORTATION (FORMERLY SOUTH SHORE REAL ESTATE, LLC)

SURVEY OF THE NORTH BAY CONSERVATION EASEMENT FOR THE NORTH CAROLINA DEPARTMENT OF TRANSPORTATION

ST. JAMES PLANTATION, POA, INC
 DB 2868 PG 618
 DB 2307 PG 618
 DB 2669 PG 257
 MB 57 PG 1105
 MB 56 PG 1-6
 MB 34 PG 88
 MB 42 PG 30
 MB 42 PG 46-50

S:\14\2019\001\001\001\Utilities\Engineering\UBO\Pro\00-R-5021-UBOs_Dr-y-DNL Y.R-5021-ut_rdy34_U032_psh.dgn