

**UTILITIES BY OTHERS**

ALL PROPOSED UTILITY WORK SHOWN ON THIS SHEET WILL BE DONE BY OTHERS. NO PAYMENT WILL BE MADE TO THE CONTRACTOR FOR PROPOSED UTILITY WORK SHOWN ON THIS SHEET.

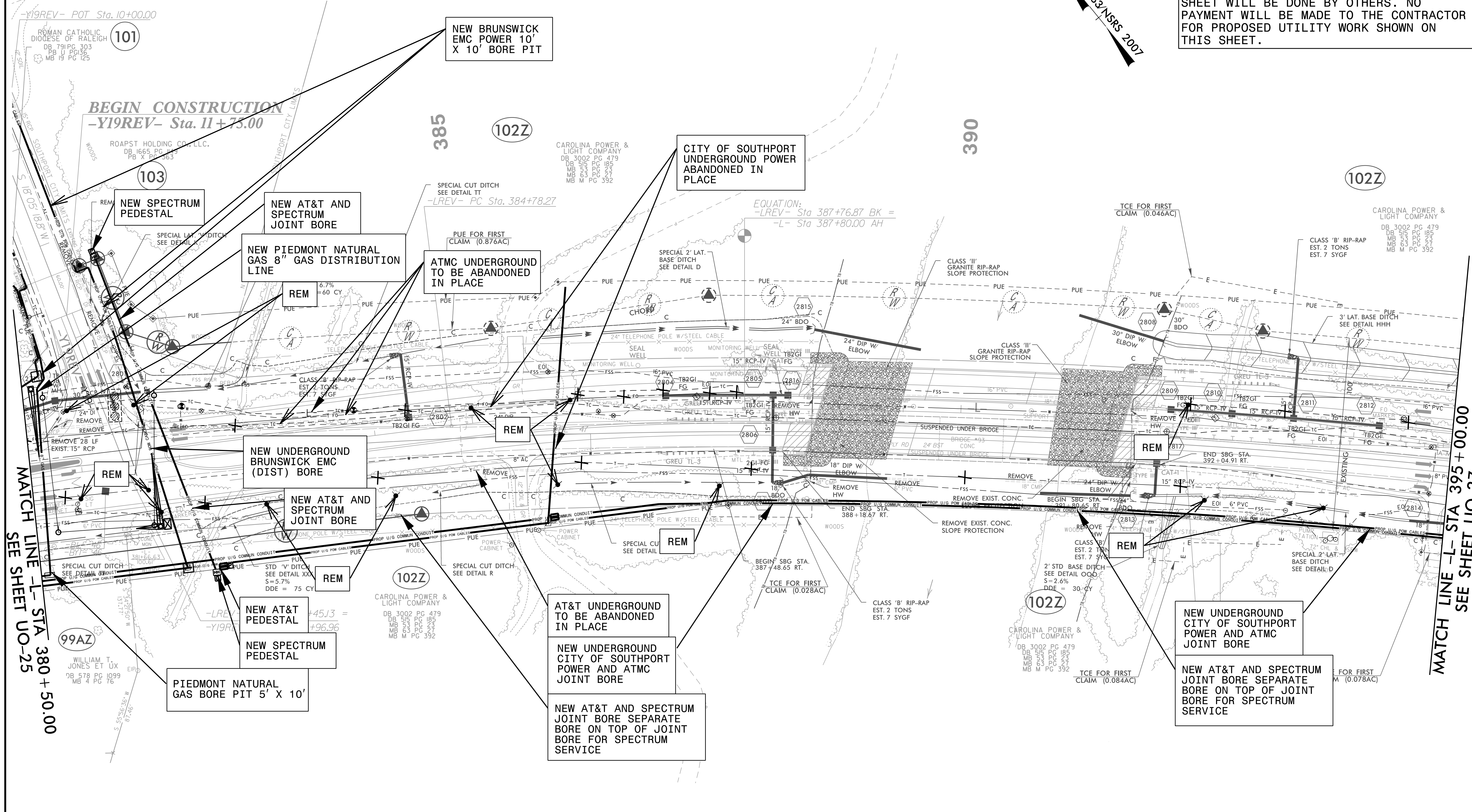
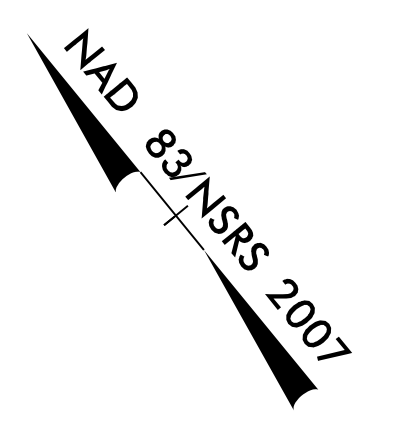

MATCH LINE -L- STA 380 + 50.00  
SEE SHEET UO-25

MATCH LINE -L- STA 395 + 00.00  
SEE SHEET UO-27

**UTILITY OWNERS ON THIS SHEET**

- BRUNSWICK EMC - POWER (DIST)
- CITY OF SOUTHPORT - POWER (DIST)
- AT&T - TELECOMMUNICATIONS/FIBER OPTIC
- AT&M - TELECOMMUNICATIONS/FIBER OPTIC
- SPECTRUM - CATV
- PIEDMONT NATURAL GAS - NATURAL GAS

NOTE:  
 1. PIEDMONT NATURAL GAS WILL OPEN TRENCH CUT ALL GAS LINE THAT IS LESS THAN 100', EXCEPT IN WETLAND AREAS

**PLANS PREPARED BY :**  
  
 RUMMEL, KLEPPER & KAHL, LLP  
 900 RIDGEFIELD DRIVE SUITE 350  
 RALEIGH, NORTH CAROLINA 27609-3960  
 NC LICENSE NO. F-0112 • (919) 878-9560

5/14/99  
 2/19/2019  
 C:\Fg\sr\02\w\Projects\2013\13\Utility\_Coordination\INC001\1\DO\_R-5021\NR-5021\Utilities\Engineering\UB0-R-5021\UB0s\_Dry\_ONL\_Y.R-5021\UT\_rdy28\_U026\_psh.dgn  
 mawson