

UTILITIES BY OTHERS

ALL PROPOSED UTILITY WORK SHOWN ON THIS SHEET WILL BE DONE BY OTHERS. NO PAYMENT WILL BE MADE TO THE CONTRACTOR FOR PROPOSED UTILITY WORK SHOWN ON THIS SHEET.

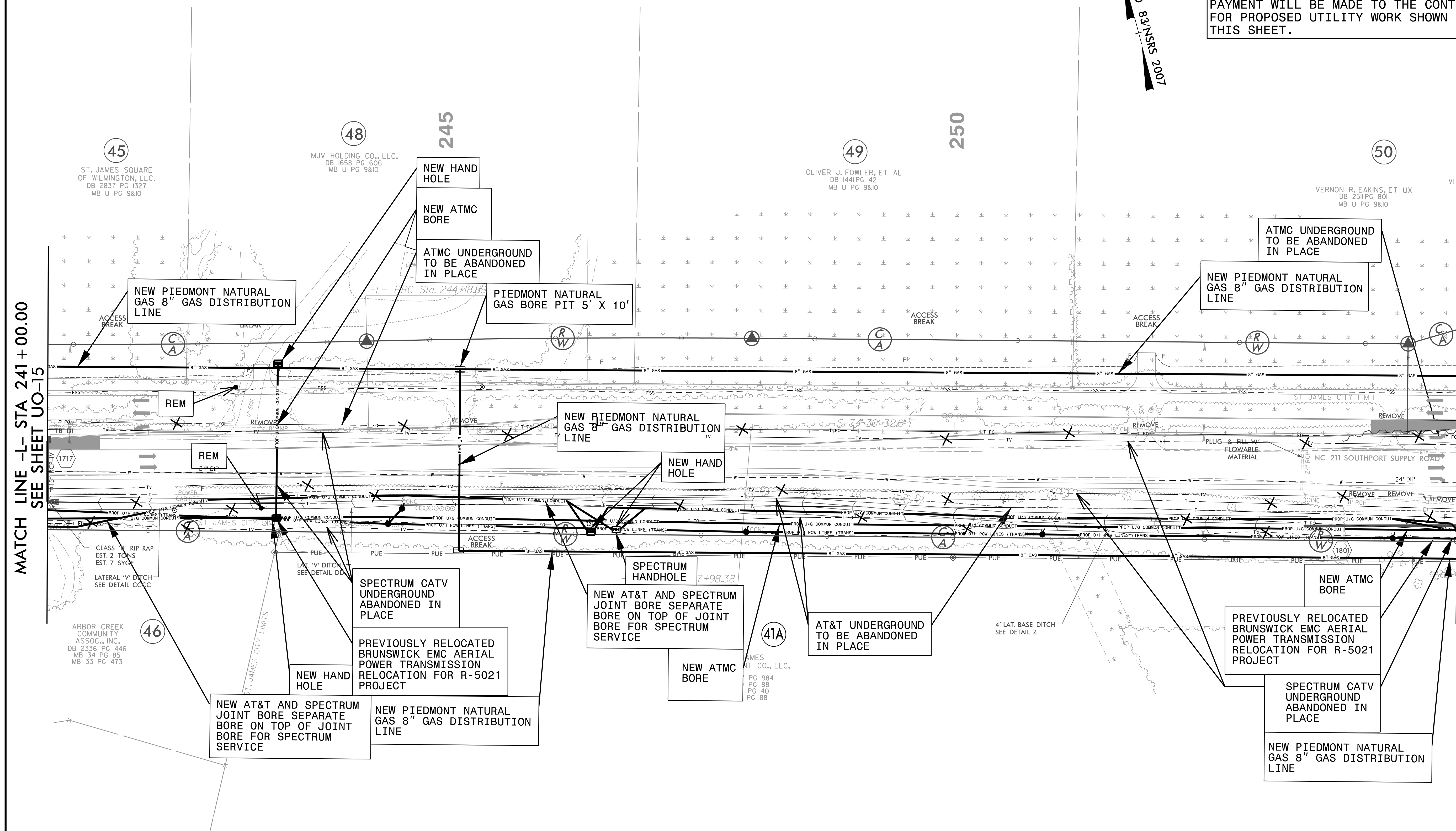
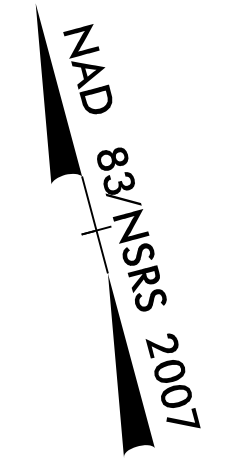

MATCH LINE -L- STA 241+00.00
SEE SHEET UO-15

MATCH LINE -L- STA 255+00.00
SEE SHEET UO-17

NOTE:
 1. PIEDMONT NATURAL GAS WILL OPEN TRENCH CUT ALL GAS LINE THAT IS LESS THAN 100', EXCEPT IN WETLAND AREAS

UTILITY OWNERS ON THIS SHEET

- BRUNSWICK - POWER (TRANS)
- BRUNSWICK EMC - POWER (DIST)
- AT&T - TELECOMMUNICATIONS/FIBER OPTIC
- ATMC - TELECOMMUNICATIONS/FIBER OPTIC
- SPECTRUM - CATV
- PIEDMONT NATURAL GAS - NATURAL GAS

PLANS PREPARED BY :



5/14/99
 7/20/2018
 C:\p\sr\02\in\Project\2013\3111_UH\Utility_Coordination.ncg\01\001_R-5021\UO-16\Utilities\Engineer\ng\UO-16\UO-16.dgn