

**UTILITIES BY OTHERS**

ALL PROPOSED UTILITY WORK SHOWN ON THIS SHEET WILL BE DONE BY OTHERS. NO PAYMENT WILL BE MADE TO THE CONTRACTOR FOR PROPOSED UTILITY WORK SHOWN ON THIS SHEET.

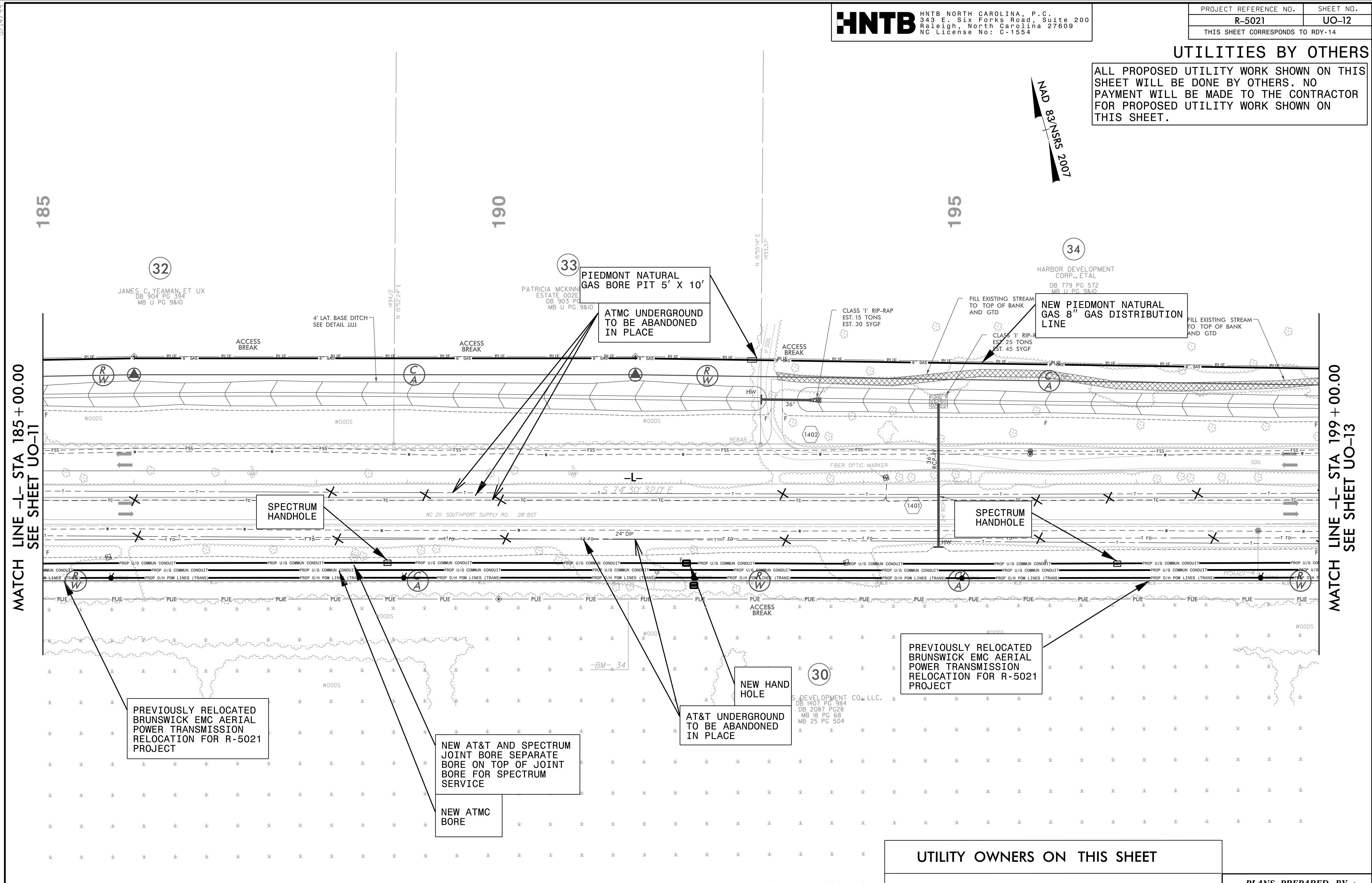
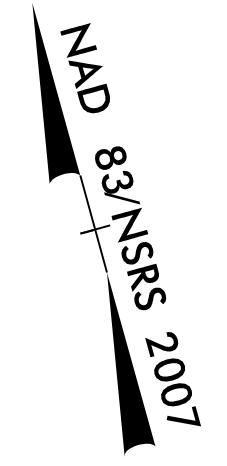

MATCH LINE -L- STA 185 + 00.00  
SEE SHEET UO-11

MATCH LINE -L- STA 199 + 00.00  
SEE SHEET UO-13

PREVIOUSLY RELOCATED BRUNSWICK EMC AERIAL POWER TRANSMISSION RELOCATION FOR R-5021 PROJECT

PREVIOUSLY RELOCATED BRUNSWICK EMC AERIAL POWER TRANSMISSION RELOCATION FOR R-5021 PROJECT

NEW AT&T AND SPECTRUM JOINT BORE SEPARATE BORE ON TOP OF JOINT BORE FOR SPECTRUM SERVICE

NEW AT&T BORE

AT&T UNDERGROUND TO BE ABANDONED IN PLACE

PIEDMONT NATURAL GAS BORE PIT 5' X 10'  
AT&T UNDERGROUND TO BE ABANDONED IN PLACE

PREVIOUSLY RELOCATED BRUNSWICK EMC AERIAL POWER TRANSMISSION RELOCATION FOR R-5021 PROJECT

**UTILITY OWNERS ON THIS SHEET**

- BRUNSWICK - POWER (TRANS)
- BRUNSWICK EMC - POWER (DIST)
- AT&T - TELECOMMUNICATIONS/FIBER OPTIC
- AT&T - TELECOMMUNICATIONS/FIBER OPTIC
- SPECTRUM - CATV
- PIEDMONT NATURAL GAS - NATURAL GAS

**PLANS PREPARED BY :**  
  
 RUMMEL, KLEPPER & KAHL, LLP  
 900 RIDGEFIELD DRIVE SUITE 350  
 RALEIGH, NORTH CAROLINA 27609-3960  
 NC LICENSE NO. F-0112 • (919) 878-9560

NOTE:  
 1. PIEDMONT NATURAL GAS WILL OPEN TRENCH CUT ALL GAS LINE THAT IS LESS THAN 100', EXCEPT IN WETLAND AREAS

2/14/2018  
 C:\p\sr\p02\w\Projects\2013\1311\Utility\_Coordination\_(NCD01)\D01\_R-5021\AR-5021\Utilities\Engineering\UB0-R-5021\UB0s\_Dry\_ONLY\_R-5021\UT\_rdy14\_UO12\_psh.dgn  
 5/14/99