

UTILITIES BY OTHERS

ALL PROPOSED UTILITY WORK SHOWN ON THIS SHEET WILL BE DONE BY OTHERS. NO PAYMENT WILL BE MADE TO THE CONTRACTOR FOR PROPOSED UTILITY WORK SHOWN ON THIS SHEET.

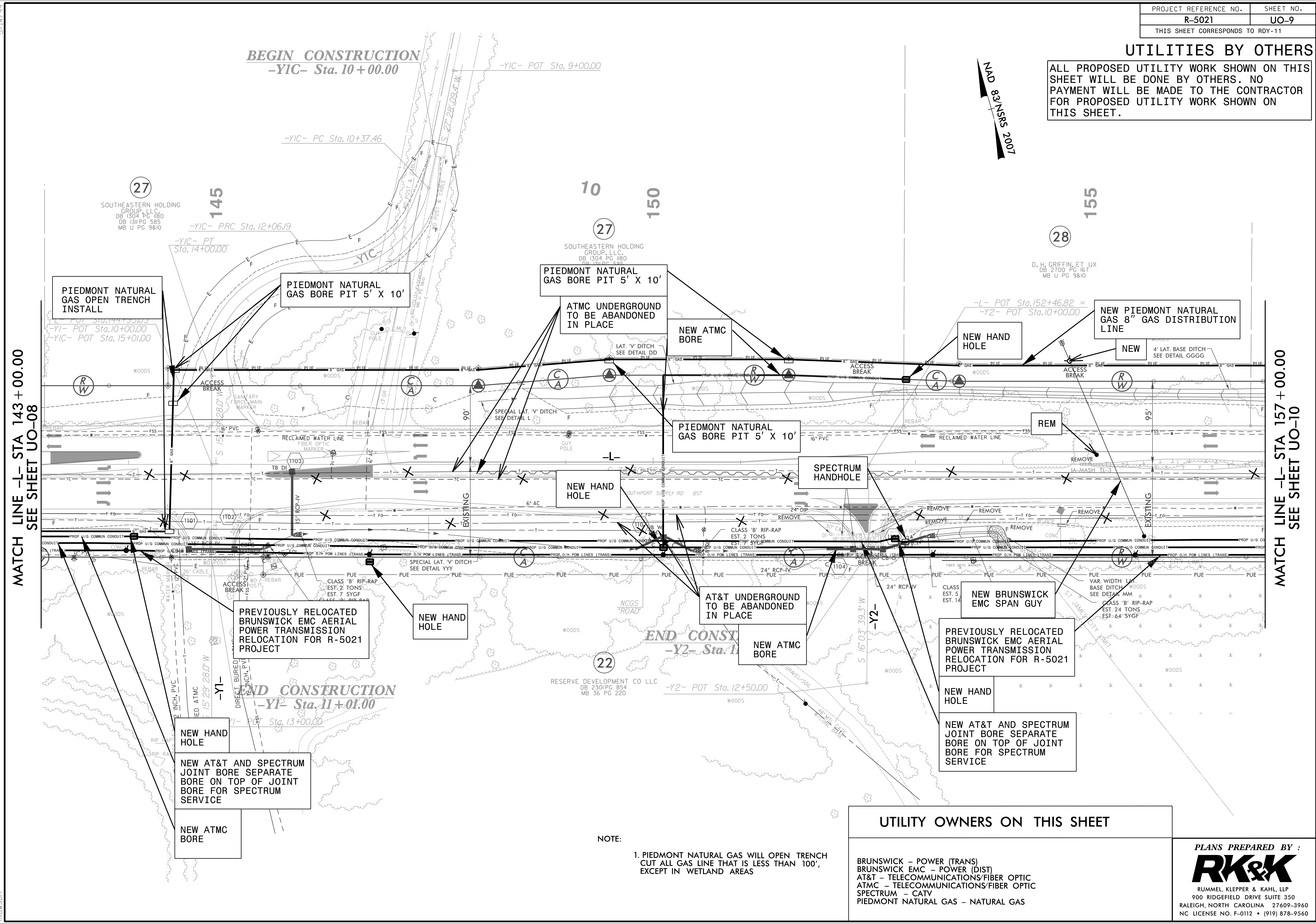
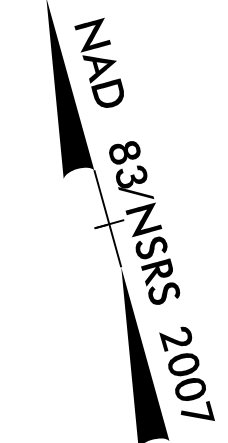

MATCH LINE -L- STA 143 + 00.00
SEE SHEET UO-08

MATCH LINE -L- STA 157 + 00.00
SEE SHEET UO-10

BEGIN CONSTRUCTION
-YIC- Sta. 10 + 00.00

END CONSTRUCTION
-Y2- Sta. 11 + 01.00

27
SOUTHEASTERN HOLDING GROUP, LLC
DB 1304 PG 180
MB U PG 585
MB U PG 9&10

27
SOUTHEASTERN HOLDING GROUP, LLC
DB 1304 PG 180
MB U PG 585
MB U PG 9&10

28
D. H. GRIFFIN, ET UX
DB 2700 PG 167
MB U PG 9&10

PIEDMONT NATURAL GAS OPEN TRENCH INSTALL

PIEDMONT NATURAL GAS BORE PIT 5' X 10'

PIEDMONT NATURAL GAS BORE PIT 5' X 10'

ATMC UNDERGROUND TO BE ABANDONED IN PLACE

NEW ATMC BORE

NEW HAND HOLE

NEW PIEDMONT NATURAL GAS 8" GAS DISTRIBUTION LINE

PIEDMONT NATURAL GAS BORE PIT 5' X 10'

NEW HAND HOLE

SPECTRUM HANDHOLE

AT&T UNDERGROUND TO BE ABANDONED IN PLACE

NEW ATMC BORE

NEW BRUNSWICK EMC SPAN GUY

PREVIOUSLY RELOCATED BRUNSWICK EMC AERIAL POWER TRANSMISSION RELOCATION FOR R-5021 PROJECT

NEW HAND HOLE

NEW AT&T AND SPECTRUM JOINT BORE SEPARATE BORE ON TOP OF JOINT BORE FOR SPECTRUM SERVICE

PREVIOUSLY RELOCATED BRUNSWICK EMC AERIAL POWER TRANSMISSION RELOCATION FOR R-5021 PROJECT

NEW HAND HOLE

NEW HAND HOLE

NEW AT&T AND SPECTRUM JOINT BORE SEPARATE BORE ON TOP OF JOINT BORE FOR SPECTRUM SERVICE

NEW ATMC BORE

UTILITY OWNERS ON THIS SHEET

- BRUNSWICK - POWER (TRANS)
- BRUNSWICK EMC - POWER (DIST)
- AT&T - TELECOMMUNICATIONS/FIBER OPTIC
- ATMC - TELECOMMUNICATIONS/FIBER OPTIC
- SPECTRUM - CATV
- PIEDMONT NATURAL GAS - NATURAL GAS

NOTE:

1. PIEDMONT NATURAL GAS WILL OPEN TRENCH CUT ALL GAS LINE THAT IS LESS THAN 100', EXCEPT IN WETLAND AREAS

PLANS PREPARED BY :

RK&K
RUMMEL, KLEPPER & KAHL, LLP
900 RIDGEFIELD DRIVE SUITE 350
RALEIGH, NORTH CAROLINA 27609-3960
NC LICENSE NO. F-0112 • (919) 878-9560

2/14/2019 2:02:52 PM C:\Projects\2013\3111_UH111\y_Coordination\INGDOT\DLR-5021\NR-5021\Utilities\Engineering\UB0-Proj\00-R-5021\UB0s_Dry_Only\Y-R-5021_UH111.dwg UO09_psh.dgn