

**UTILITIES BY OTHERS**

ALL PROPOSED UTILITY WORK SHOWN ON THIS SHEET WILL BE DONE BY OTHERS. NO PAYMENT WILL BE MADE TO THE CONTRACTOR FOR PROPOSED UTILITY WORK SHOWN ON THIS SHEET.

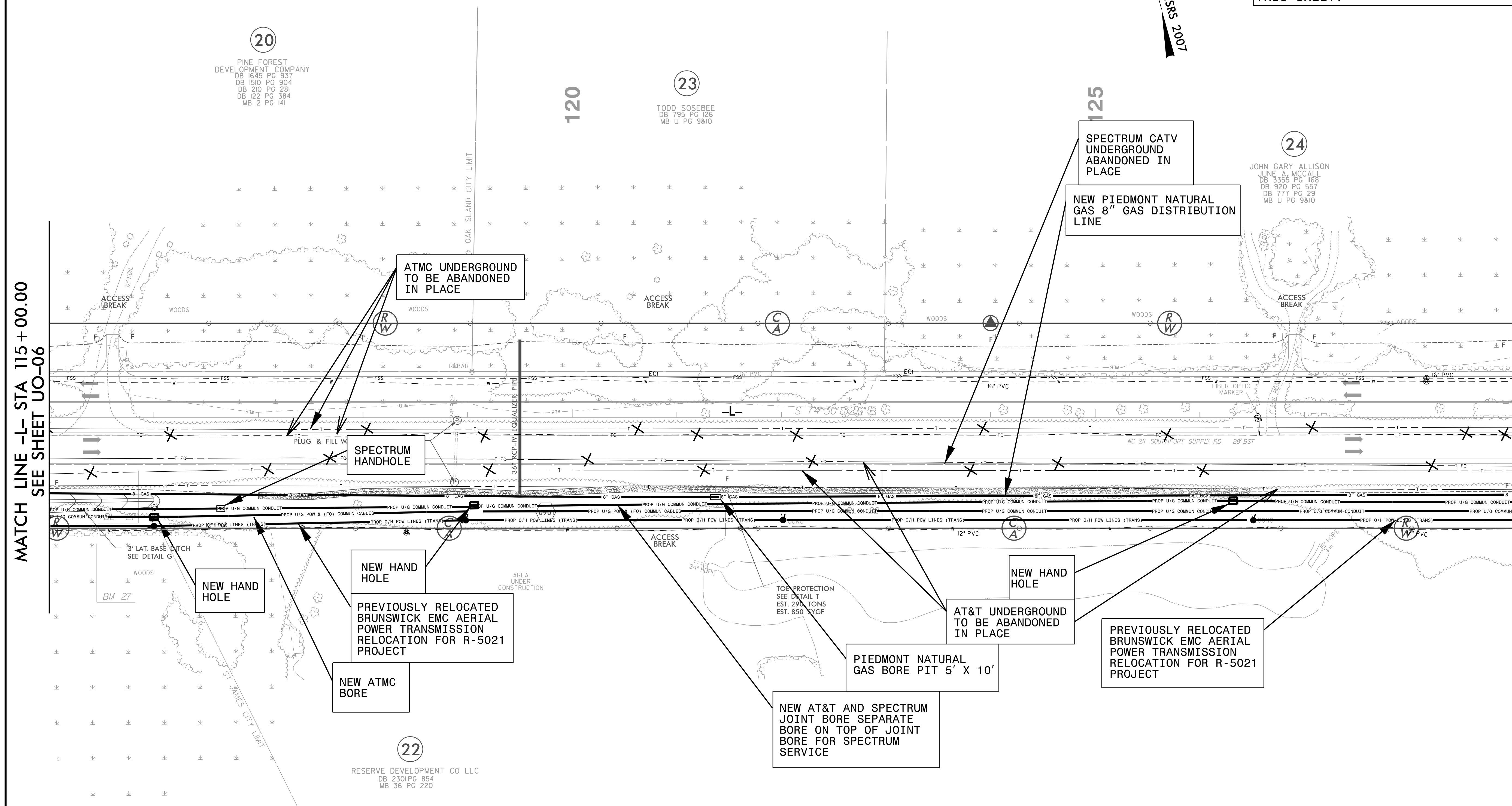
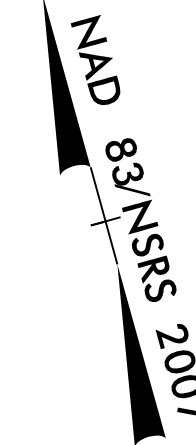

MATCH LINE -L- STA 115 + 00.00  
SEE SHEET UO-06

MATCH LINE -L- STA 129 + 00.00  
SEE SHEET UO-08

20  
 PINE FOREST DEVELOPMENT COMPANY  
 DB 1645 PG 337  
 DB 1510 PG 904  
 DB 210 PG 281  
 DB 122 PG 384  
 MB 2 PG 141

23  
 TODD SOSEBEE  
 DB 795 PG 126  
 MB U PG 9810

24  
 JOHN GARY ALLISON  
 JUNE A. MCCALL  
 DB 3355 PG 1168  
 DB 920 PG 551  
 DB 777 PG 29  
 MB U PG 9810

22  
 RESERVE DEVELOPMENT CO LLC  
 DB 2301 PG 854  
 MB 36 PG 220

**UTILITY OWNERS ON THIS SHEET**

- BRUNSWICK - POWER (TRANS)
- BRUNSWICK EMC - POWER (DIST)
- AT&T - TELECOMMUNICATIONS/FIBER OPTIC
- ATMC - TELECOMMUNICATIONS/FIBER OPTIC
- SPECTRUM - CATV
- PIEDMONT NATURAL GAS - NATURAL GAS

**PLANS PREPARED BY :**  
  
 RUMMEL, KLEPPER & KAHL, LLP  
 900 RIDGEFIELD DRIVE SUITE 350  
 RALEIGH, NORTH CAROLINA 27609-3960  
 NC LICENSE NO. F-0112 • (919) 878-9560

NOTE:  
 1. PIEDMONT NATURAL GAS WILL OPEN TRENCH CUT ALL GAS LINE THAT IS LESS THAN 100', EXCEPT IN WETLAND AREAS

5/14/99  
 2/14/2019  
 C:\pfsr\p02\Projects\2013\311\Utility\_Coordination\_(NCD071)\D01\_R-5021\N-5021\Utilities\Engineer\ng\_ubo\Prj\00-R-5021\UBOs\_Dry\_ONL\YR-5021\ut\_rdy03\_U007psh.dgn  
 mawson