

FOR INFORMATION ONLY
SEE UC-16/UC-61 FOR CONSTRUCTION DETAILS

PROJECT REFERENCE NO.	SHEET NO.
R-5021	I-16
DESIGNED BY: JXL	
DRAWN BY: JXL	
CHECKED BY: BMB	
APPROVED BY: BMB	
REVISER:	
NORTH CAROLINA DEPARTMENT OF TRANSPORTATION	
UTILITIES ENGINEERING SEC. PHONE: (919) 707-6690	UTILITY CONSTRUCTION PLANS ONLY
FAX: (919) 250-4151	

MAD 8/3/NSRS 2007

5/14/99

MATCH LINE -L- STA 213+00.00
SEE SHEET I-15

MATCH LINE -L- STA 227+00.00
SEE SHEET I-17

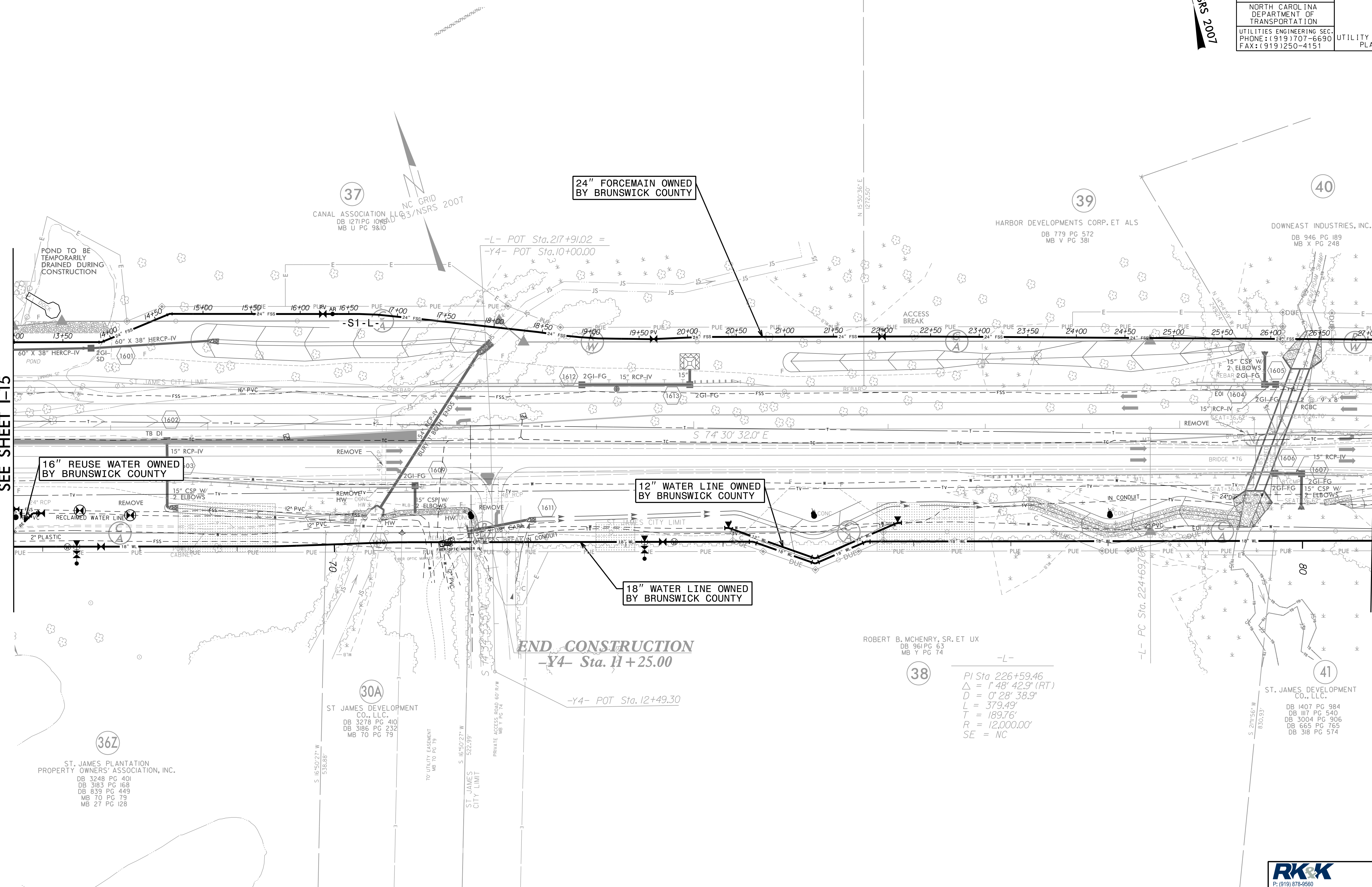

16" REUSE WATER OWNED BY BRUNSWICK COUNTY

24" FORCEMAIN OWNED BY BRUNSWICK COUNTY

12" WATER LINE OWNED BY BRUNSWICK COUNTY

18" WATER LINE OWNED BY BRUNSWICK COUNTY

END CONSTRUCTION
-Y4- Sta. 11+25.00

ROBERT B. MCHENRY, SR. ET UX
DB 96 PG 63
MB Y PG 74

38
-L-
PI Sta 226+59.46
Δ = 1' 48' 42.9" (RT)
D = 0' 28' 38.9"
L = 379.49'
T = 189.76'
R = 12,000.00'
SE = NC

36Z
ST. JAMES PLANTATION
PROPERTY OWNERS' ASSOCIATION, INC.
DB 3248 PG 401
DB 3163 PG 168
DB 3339 PG 449
MB 70 PG 79
MB 27 PG 128

30A
ST. JAMES DEVELOPMENT
CO., LLC.
DB 3278 PG 410
DB 3186 PG 232
MB 70 PG 79

41
ST. JAMES DEVELOPMENT
CO., LLC.
DB 1407 PG 984
DB 1117 PG 540
DB 3004 PG 906
DB 665 PG 765
DB 318 PG 574

RRK
P: (919) 878-9560
8601 Six Forks Road, Forum 1, Suite 700
Raleigh, North Carolina 27615-3960
NC License No. F-0112
Engineers | Construction Managers | Planners | Scientists
www.rrk.com
Responsive People | Creative Solutions