

UTILITY CONSTRUCTION

**DOCUMENT NOT CONSIDERED FINAL
UNLESS ALL SIGNATURES COMPLETED**

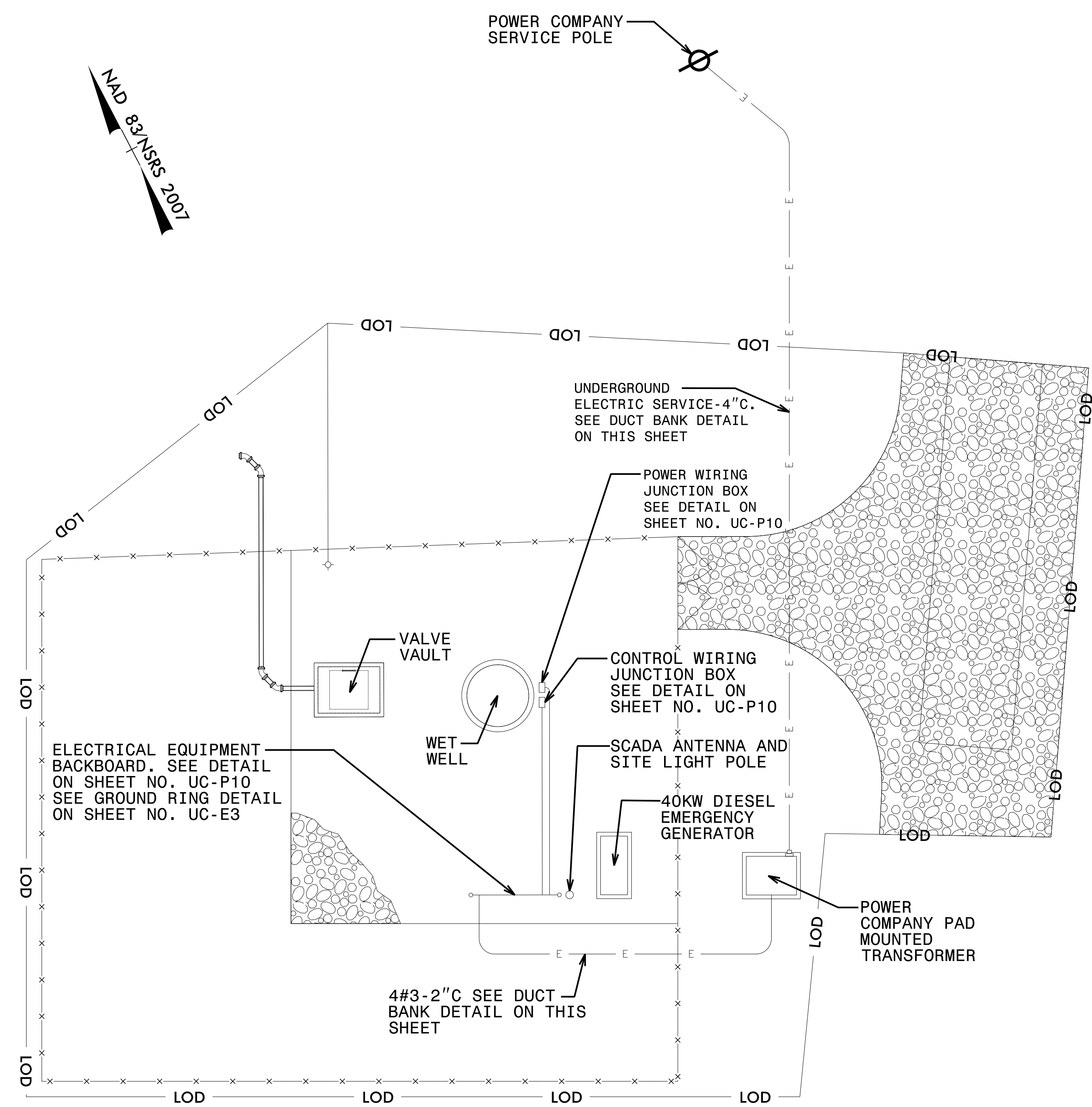

ELECTRICAL SITE PLAN

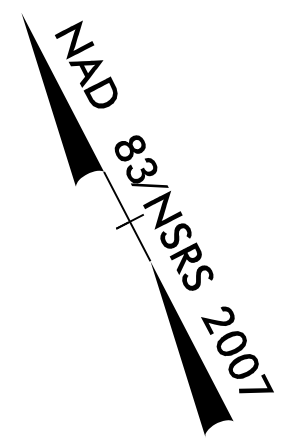
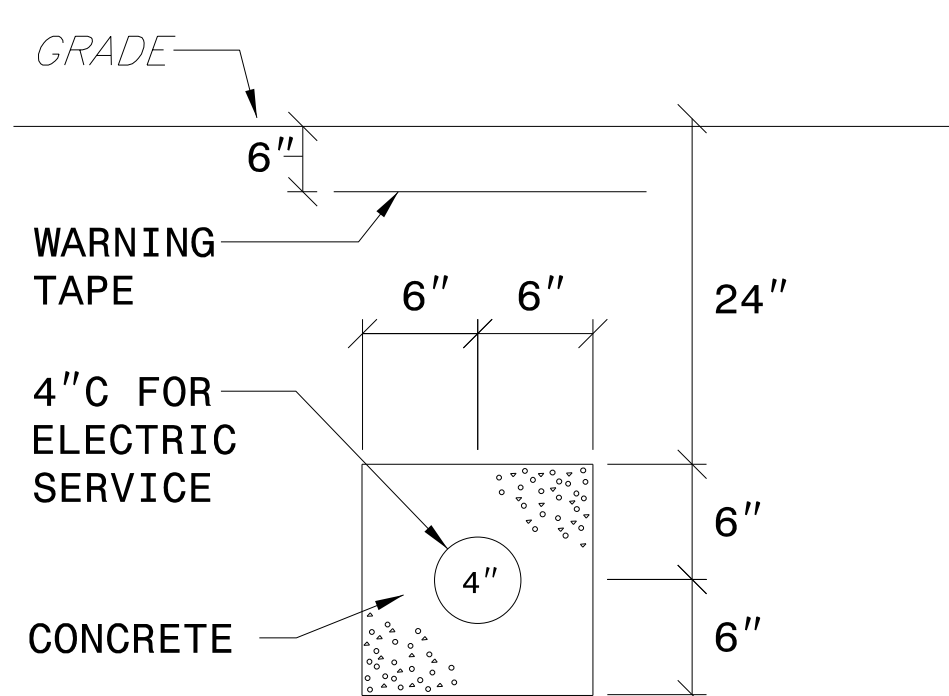
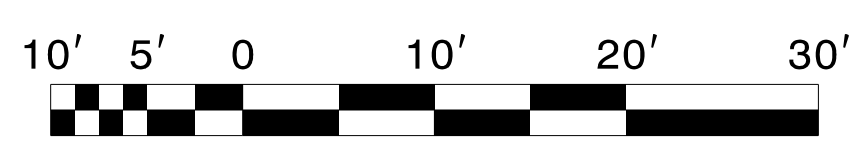

**ELECTRIC SERVICE CONDUIT
DUCT BANK DETAIL**

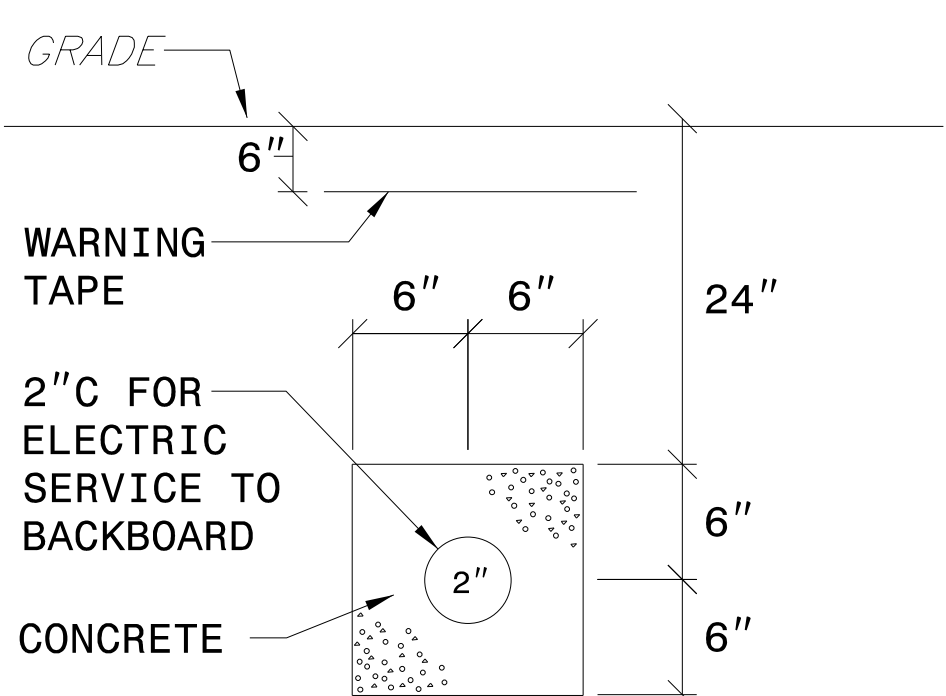

CONDUIT DUCT BANK DETAIL

GENERAL ELECTRICAL NOTES (APPLICABLE TO ALL DRAWINGS)

1. ALL FASTENERS AND MOUNTING HARDWARE USED FOR THE INSTALLATION OF ALL ELECTRICAL ITEMS SHALL BE 316 STAINLESS STEEL.
2. ALL ALUMINUM IN CONTACT WITH CONCRETE SHALL BE COATED WITH TWO COATS OF ZINC CHROMATE PRIMER OR BITUMINOUS PAINT TO PREVENT A REACTION BETWEEN THE ALUMINUM AND CONCRETE.
3. CONTRACTOR SHALL FURNISH AND INSTALL A SEPARATE INSULATED GROUND CONDUCTOR IN ALL CONDUITS. ALL GROUND CONDUCTORS SHALL BE #12 UNLESS NOTED OTHERWISE ON DRAWINGS.
4. CONTRACTOR SHALL COORDINATE THE EXACT LOCATION OF ALL UNDERGROUND CONDUITS TO AVOID INTERFERENCES WITH UNDERGROUND PIPING.
5. RIGID ALUMINUM CONDUIT MAY BE USED ABOVE GRADE TO AND ON THE ELECTRICAL BACKBOARD. CONDUITS WITHIN THE WET WELL AND BELOW GROUND SHALL BE PVC COATED RIGID STEEL.

SITE PLAN NOTES

1. COORDINATE INSTALLATION OF ELECTRIC SERVICE WITH THE POWER COMPANY.

ELECTRICAL ABBREVIATIONS

A	-	AMPERES	NO.	-	NUMBER
ALUM.	-	ALUMINUM	P	-	POLE
C	-	CONDUIT	PH	-	PHASE
DWG.	-	DRAWING	TYP.	-	TYPICAL
GRD	-	GROUND	V	-	VOLTS
HP	-	HORSEPOWER	W	-	WIRE, WATT, WIDE
KW	-	KILOWATT	WP	-	WEATHERPROOF
KVA	-	KILOVOLT AMPERES	XFMR	-	TRANSFORMER

ELECTRICAL SYMBOL SCHEDULE

	-	DISCONNECT SWITCH
	-	JUNCTION BOX
	-	TRANSFORMER
	-	HOME RUN TO PANEL
	-	TICKS INDICATE NUMBER OF WIRES - NOT INCLUDING GROUND CONDUCTOR
	-	CIRCUIT BREAKER

8/3/2021 10:58:11 AM C:\Users\kemp\OneDrive\Documents\Projects\Station\282-027-R-5021-Utilities\ps-electrical\UCP14_psh.dgn