

DEFAULT PHASING DIAGRAM

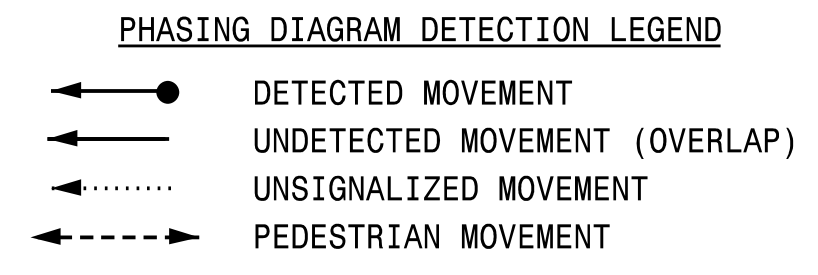

ALTERNATE PHASING DIAGRAM

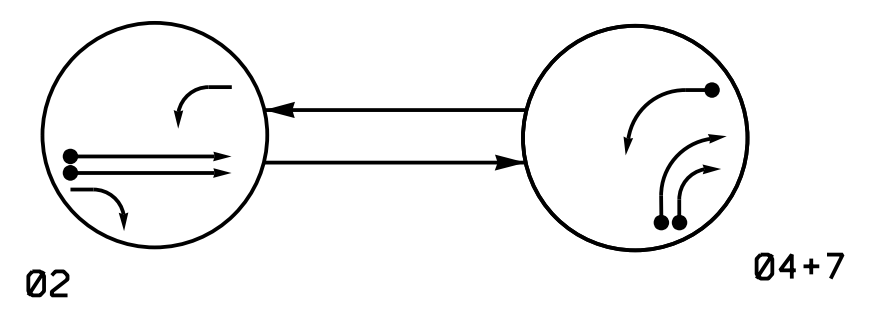
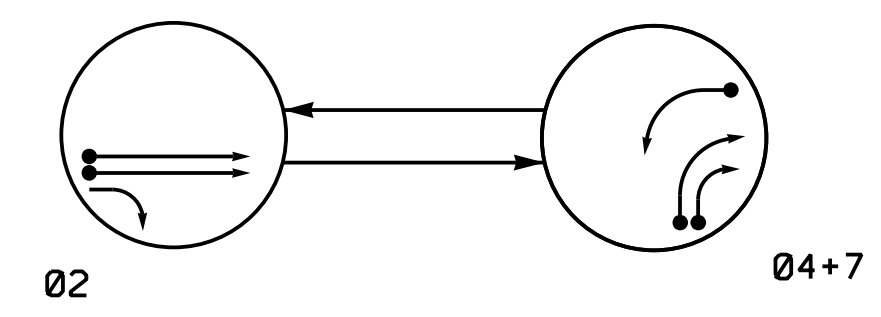

DEFAULT PHASING TABLE OF OPERATION

| SIGNAL FACE | PHASE | | |
|-------------|-------|------|-------|
| | 02 | 04+7 | FLASH |
| 21,22 | G | R | Y |
| 41,42 | R | — | R |
| 71,72 | F | — | — |

ALTERNATE PHASING TABLE OF OPERATION

| SIGNAL FACE | PHASE | | |
|-------------|-------|------|-------|
| | 02 | 04+7 | FLASH |
| 21,22 | G | R | Y |
| 41,42 | R | — | R |
| 71,72 | R | — | — |

OASIS 2070 LOOP & DETECTOR INSTALLATION CHART

| LOOP | SIZE (FT) | DISTANCE FROM STOPBAR (FT) | TURNS | NEW LOOP | DETECTOR PROGRAMMING | | | | | | | |
|------|-----------|----------------------------|-------|----------|----------------------|---------|-----------|-----------------|--------------|------------|-------------|----------|
| | | | | | PHASE | CALLING | EXTENSION | FULL TIME DELAY | STRETCH TIME | DELAY TIME | SYSTEM LOOP | NEW CARD |
| 2A | 6X6 | 420 | 5 | Y | 2 | Y | Y | - | - | - | - | Y |
| 2B | 6X6 | 420 | 5 | Y | 2 | Y | Y | - | - | - | - | Y |
| 4A | 6X40 | 0 | 2-4-2 | Y | 4 | Y | Y | - | - | 15 | - | Y |
| 4B | 6X40 | 0 | 2-4-2 | Y | 4 | Y | Y | - | - | 15 | - | Y |
| 7A | 6X40 | 0 | 2-4-2 | Y | 7 | Y | Y | - | - | *15 | - | Y |

* Reduce delay to 0 seconds during alternate phasing operation.

2 Phase Fully Actuated (NC 133 Closed Loop System)

NOTES

1. Refer to "Roadway Standard Drawings NCDOT" dated January 2018 and "Standard Specifications for Roads and Structures" dated January 2018.
2. Do not program signal for late night flashing operation unless otherwise directed by the Engineer.
3. Set all detector units to presence mode.
4. Locate new cabinet so as not to obstruct sight distance of vehicles turning right on red.
5. The Division Traffic Engineer will determine the hours of use for each phasing plan.
6. Maximum times shown in timing chart are for free-run operation only. Coordinated signal system timing values supersede these values.
7. Closed loop system data: Controller Asset #: 1177.

SIGNAL FACE I.D.

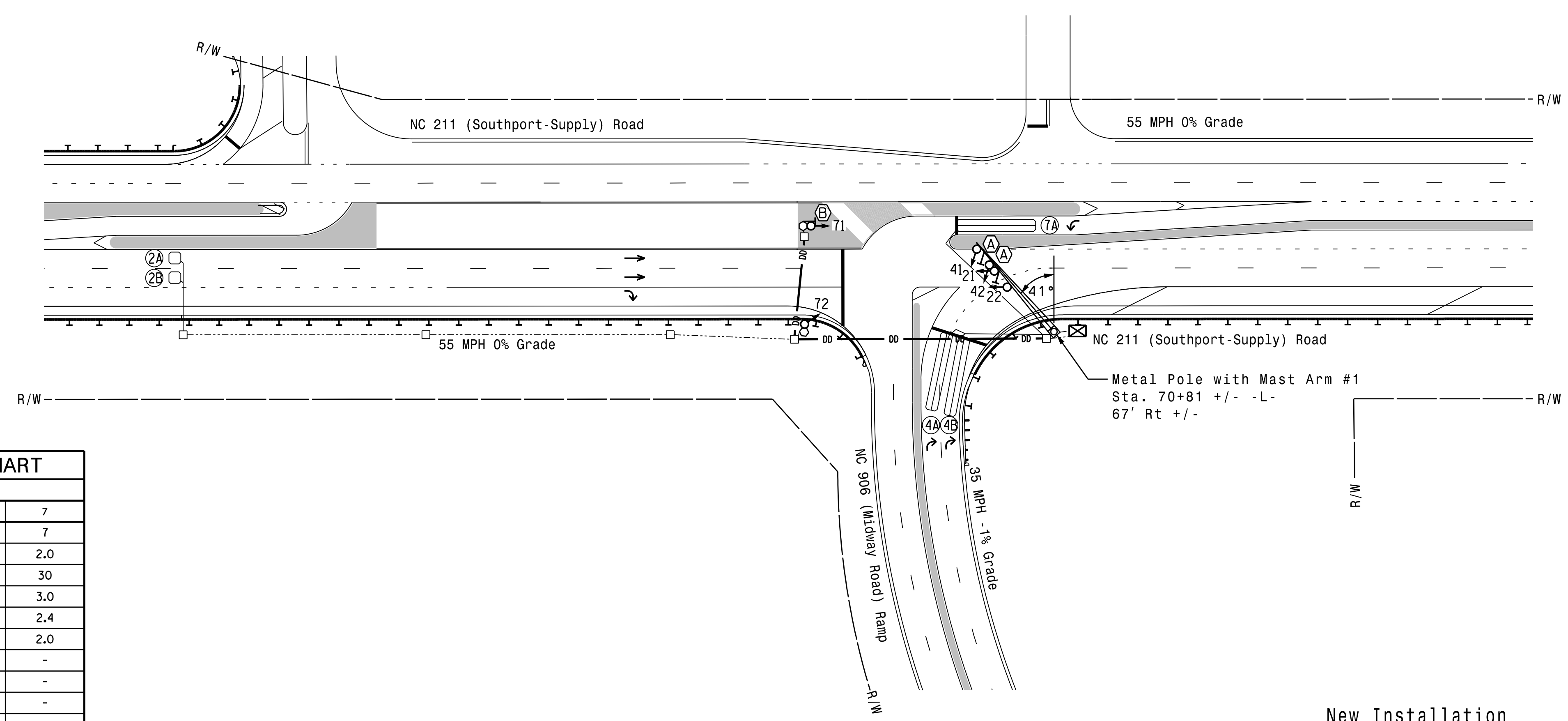
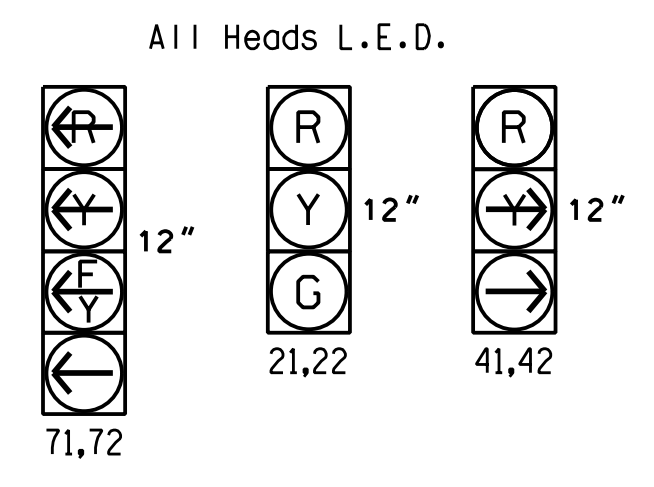

OASIS 2070 TIMING CHART

| FEATURE | PHASE | | |
|-------------------------|------------|-----|-----|
| | 2 | 4 | 7 |
| Min Green 1 * | 14 | 7 | 7 |
| Extension 1 * | 6.0 | 2.0 | 2.0 |
| Max Green 1 * | 90 | 30 | 30 |
| Yellow Clearance | 5.2 | 3.0 | 3.0 |
| Red Clearance | 1.2 | 2.4 | 2.4 |
| Red Revert | 2.0 | 2.0 | 2.0 |
| Walk 1 * | - | - | - |
| Don't Walk 1 | - | - | - |
| Seconds Per Actuation * | 1.5 | - | - |
| Max Variable Initial * | 46 | - | - |
| Time Before Reduction * | 15 | - | - |
| Time To Reduce * | 30 | - | - |
| Minimum Gap | 3.4 | - | - |
| Recall Mode | MIN RECALL | - | - |
| Vehicle Call Memory | YELLOW | - | - |
| Dual Entry | - | ON | ON |
| Simultaneous Gap | ON | ON | ON |

* These values may be field adjusted. Do not adjust Min Green and Extension times for phase 2 lower than what is shown. Min Green for all other phases should not be lower than 4 seconds.

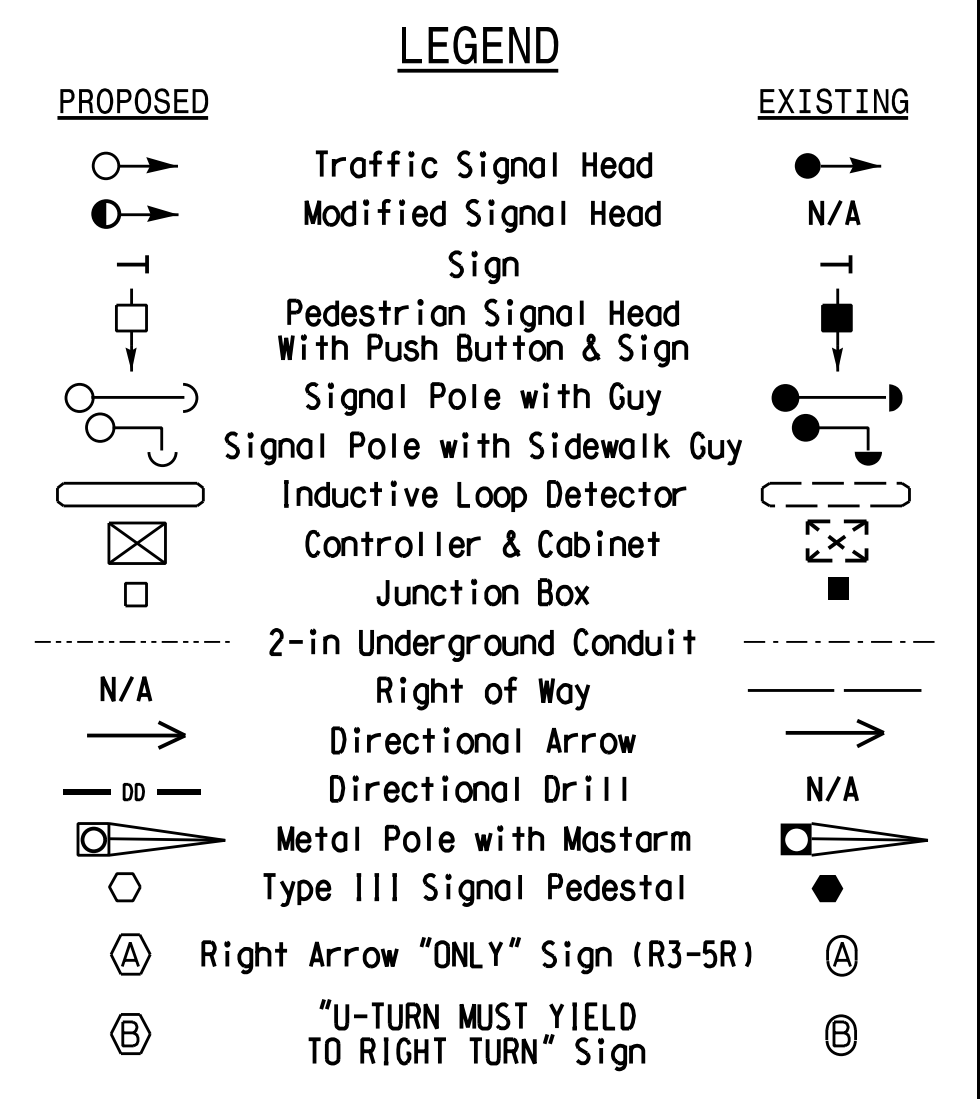

New Installation Final Design

DOCUMENT NOT CONSIDERED FINAL UNLESS ALL SIGNATURES COMPLETED

| | | | |
|--------------|---|--|-----------------|
| | NC 211 (Southport-Supply Road) at NC 906 (Midway Road) Ramp | | |
| | Division 03 Brunswick Co. Southport | PLAN DATE: June 2017 REVIEWED BY: A.D. Klinksiek | |
| SCALE 1"=50' | REVISIONS | INIT. DATE | DATE 10/29/2021 |

HNTB HNTB NORTH CAROLINA, P.C. 343 E. Six Forks Road, Suite 200 Raleigh, North Carolina 27609 NC License No: C-1554 (919) 546-8997