

**DEFAULT PHASING DIAGRAM**

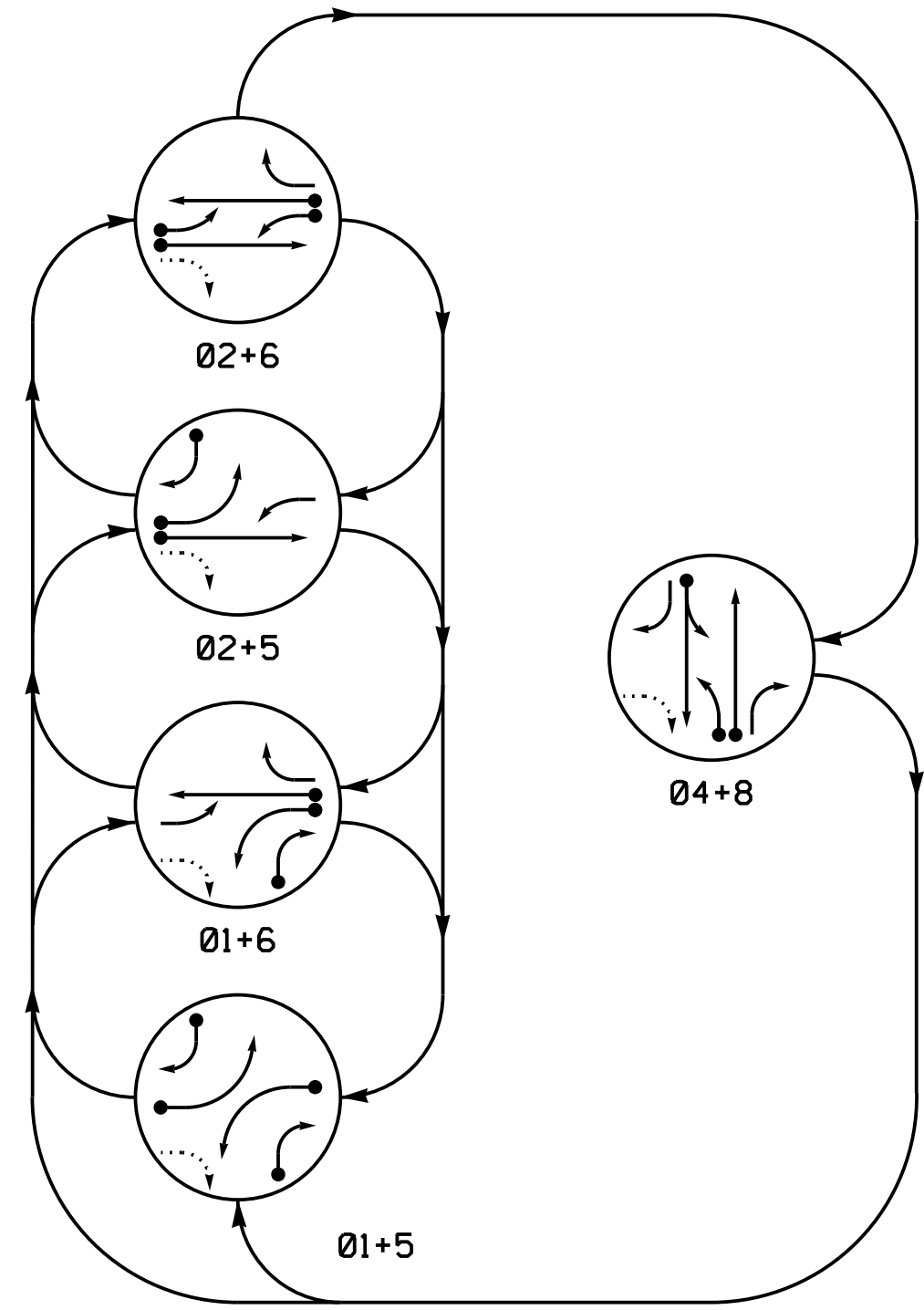

**ALTERNATE PHASING DIAGRAM**

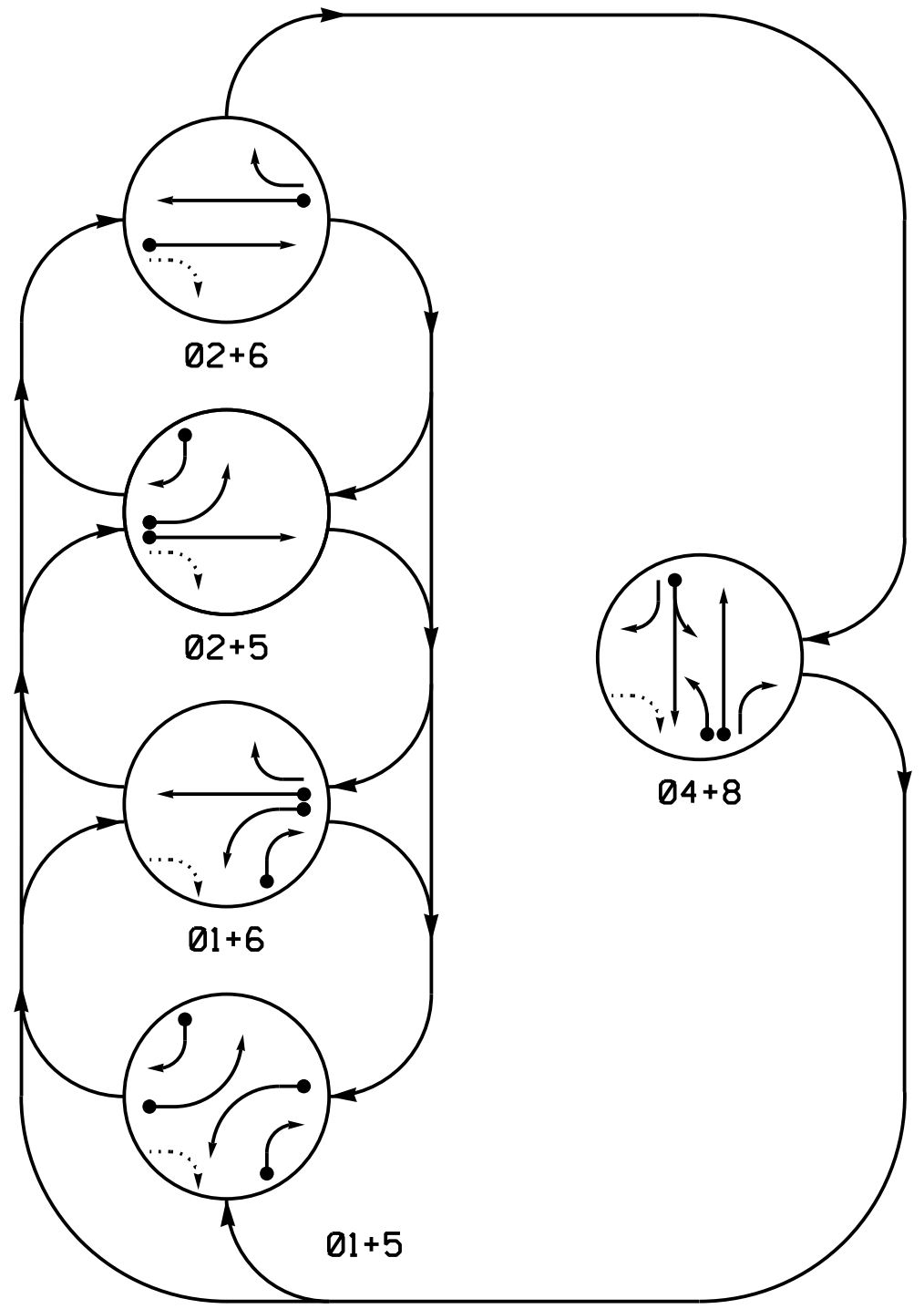

**PHASING DIAGRAM DETECTION LEGEND**

- DETECTED MOVEMENT
- UNDETECTED MOVEMENT (OVERLAP)
- ⋯ UNSIGNALIZED MOVEMENT
- ⚡ PEDESTRIAN MOVEMENT

**DEFAULT PHASING TABLE OF OPERATION**

SIGNAL FACE	PHASE					
	01+5	01+6	02+5	02+6	04+8	F Ped
11	---	---	F	F	R	Y
21,22	R	R	G	G	R	Y
41	R	R	R	R	G	R
42	R	R	R	R	G	R
51	---	---	F	F	R	Y
61,62	R	G	R	G	R	Y
81	R	R	R	R	G	R
82	R	R	R	R	G	R

**ALTERNATE PHASING TABLE OF OPERATION**

SIGNAL FACE	PHASE					
	01+5	01+6	02+5	02+6	04+8	F Ped
11	---	---	R	R	R	Y
21,22	R	R	G	G	R	Y
41	R	R	R	R	G	R
42	R	R	R	R	G	R
51	---	---	R	R	R	Y
61,62	R	G	R	G	R	Y
81	R	R	R	R	G	R
82	R	R	R	R	G	R

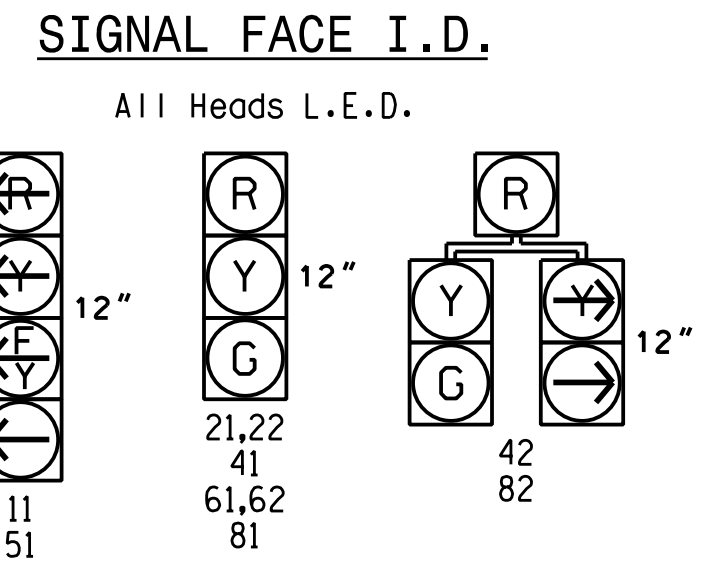

**OASIS 2070 LOOP & DETECTOR INSTALLATION CHART**

LOOP	SIZE (FT)	DISTANCE FROM STOPBAR (FT)	TURNS	NEW LOOP	PHASE			STRETCH TIME	DELAY TIME	SYSTEM LOOP	NEW CARD
					1	2	6				
1A	6X40	0	*	*	1	Y	Y	-	-	***15	-
1B	6X40	0	*	*	1	Y	Y	-	-	3	-
2A	6X6	300	*	*	2	Y	Y	-	-	-	-
4A	6X40	0	*	*	4	Y	Y	-	-	-	-
5A	6X40	0	*	*	5	Y	Y	-	-	***15	-
5B	6X40	0	*	*	5	Y	Y	-	-	15	-
6A	6X6	300	*	*	6	Y	Y	-	-	-	-
8A	6X40	0	*	*	8	Y	Y	-	-	-	-
8B	6X40	0	*	*	8	Y	Y	-	-	-	-

\* Multizone Microwave Detection.  
 \*\* Disable phase 2 and 6 call for 1A and 5A during alternate phasing operation.  
 \*\*\* Reduce delay to 3 seconds during alternate phasing operation.

5 Phase Fully Actuated Isolated

**NOTES**

- Refer to "Roadway Standard Drawings NCDOT" dated January 2018 and "Standard Specifications for Roads and Structures" dated January 2018.
- Do not program signal for late night flashing operation unless otherwise directed by the Engineer.
- Phase 1 and/or phase 5 may be lagged.
- Reposition existing signal heads numbered 21,22, and 51.
- Set all detector units to presence mode.
- The Division Traffic Engineer will determine the hours of use for each phasing plan.
- Incorporate Microwave Detection system for vehicle detection.
- Provide the Engineer with the Manufacturer's approved Microwave Detection locations and mounting heights to obtain detection zones as shown.

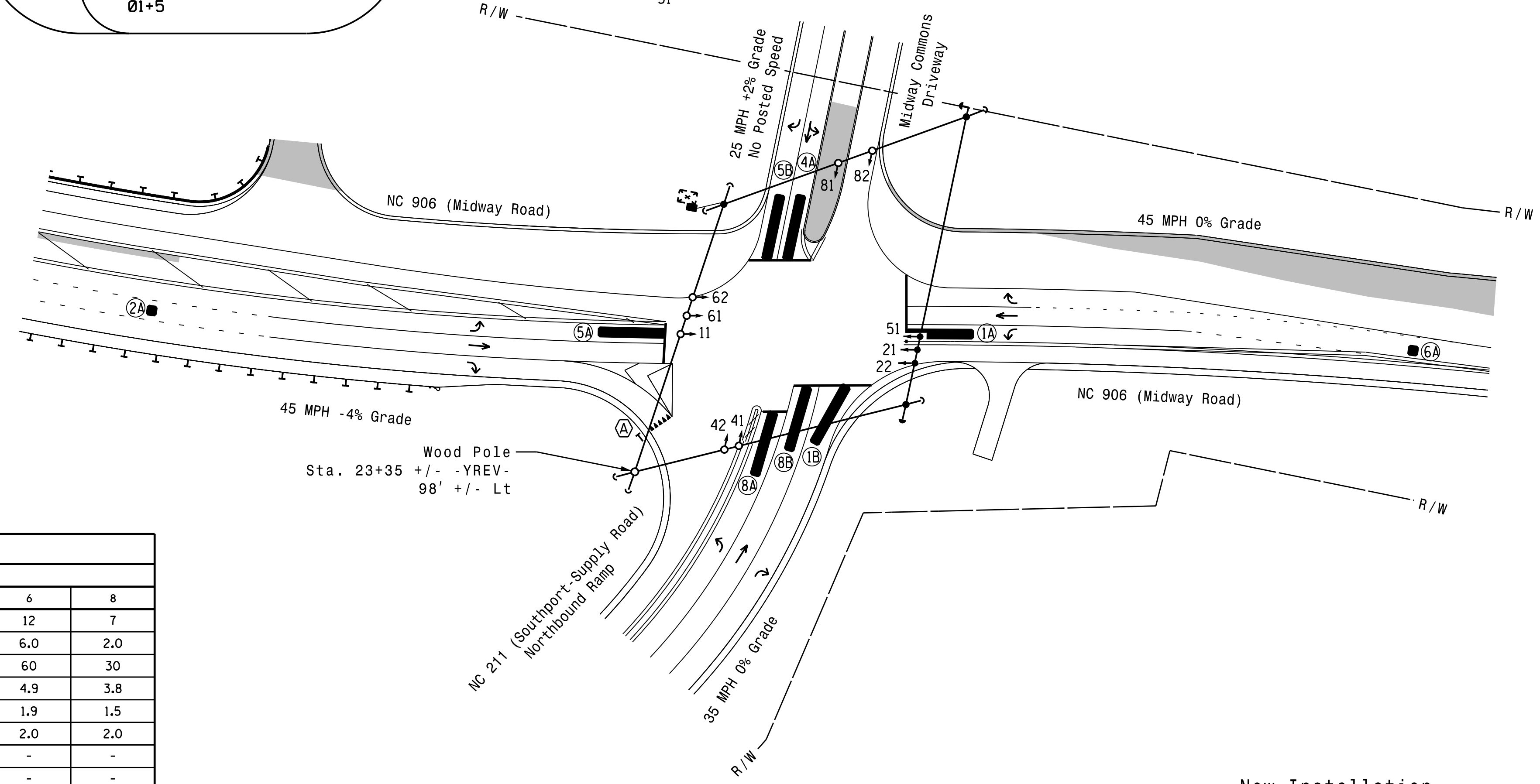

**OASIS 2070 TIMING CHART**

FEATURE	PHASE					
	1	2	4	5	6	8
Min Green 1 *	7	12	7	7	12	7
Extension 1 *	2.0	6.0	2.0	2.0	6.0	2.0
Max Green 1 *	20	60	30	20	60	30
Yellow Clearance	3.0	4.9	3.1	3.0	4.9	3.8
Red Clearance	3.1	1.9	2.5	3.3	1.9	1.5
Red Revert	2.0	2.0	2.0	2.0	2.0	2.0
Walk 1 *	-	-	-	-	-	-
Don't Walk 1	-	-	-	-	-	-
Seconds Per Actuation *	-	2.5	-	-	2.5	-
Max Variable Initial *	-	34	-	-	34	-
Time Before Reduction *	-	15	-	-	15	-
Time To Reduce *	-	30	-	-	30	-
Minimum Gap	-	3.0	-	-	3.0	-
Recall Mode	-	MIN RECALL	-	-	MIN RECALL	-
Vehicle Call Memory	-	YELLOW	-	-	YELLOW	-
Dual Entry	-	-	ON	-	-	ON
Simultaneous Gap	ON	ON	ON	ON	ON	ON

\* These values may be field adjusted. Do not adjust Min Green and Extension times for phases 2 and 6 lower than what is shown. Min Green for all other phases should not be lower than 4 seconds.

**LEGEND**

PROPOSED	EXISTING
○ → Traffic Signal Head	● → N/A
○ → Modified Signal Head	○ → N/A
⊥ Pedestrian Signal Head With Push Button & Sign	⊥ → N/A
○ → Signal Pole with Guy	○ → N/A
⊥ → Signal Pole with Sidewalk Guy	⊥ → N/A
⊠ → Controller & Cabinet	⊠ → N/A
⊠ → Junction Box	⊠ → N/A
⊠ → 2-in Underground Conduit	⊠ → N/A
— → Right of Way	— → N/A
→ → Directional Arrow	→ → N/A
▬ → Microwave Detection Zone	▬ → N/A
▬ → Guardrail	▬ → N/A
▬ → Construction Zone	▬ → N/A
⊠ → "YIELD" Sign (R1-2)	⊠ → N/A

New Installation  
 Temporary Design 2  
 Construction Phase 3

**DOCUMENT NOT CONSIDERED FINAL UNLESS ALL SIGNATURES COMPLETED**

<p>HNTB NORTH CAROLINA, P.C.                  343 E. Six Forks Road, Suite 200                  Raleigh, North Carolina 27609                  NC License No: C-1554                  (919) 546-8997</p>	Prepared For:  TRANSPORTATION MOBILITY AND SAFETY DIVISION STATE OF NORTH CAROLINA SIGNAL DESIGN SECTION	NC 906 (Midway Road) at NC 211 Northbound Ramp/ Midway Commons Driveway Division 03 Brunswick Co. Southport PLAN DATE: June 2017 REVIEWED BY: A.D. Klinksiek PREPARED BY: A.H. Thornburg REVIEWED BY: N.R. Simmons	SEAL  N. R. SIMMONS ENGINEER 031464 9/10/2021
	SCALE 0 50 1" = 50'	REVISIONS INIT. DATE SIGNATURE DATE SIG. INVENTORY NO. 03-1122T2	