

5/14/99

DO NOT DISTURB THE MONUMENT "NCGS K216".

NOTE: INSTALL FABRIC INSERT INLET PROTECTION DEVICE IN LIEU OF ROCK INLET SEDIMENT TRAP TYPE 'C' AS DIRECTED.

NOTE: UTILIZE COIR FIBER MATTING ADJACENT TO WETLANDS / JURISDICTIONAL AREAS, AND AS DIRECTED

HNTB HNTB NORTH CAROLINA, P.C.
343 E. Six Forks Road, Suite 200
Raleigh, North Carolina 27609
NC License No: C-1554

PROJECT REFERENCE NO.	SHEET NO.
R-5021	EC-69/CONST.31
RW SHEET NO.	
ROADWAY DESIGN ENGINEER	HYDRAULICS ENGINEER

NAD 83/NSRS 2007

EXISTING TRAFFIC SIGNAL

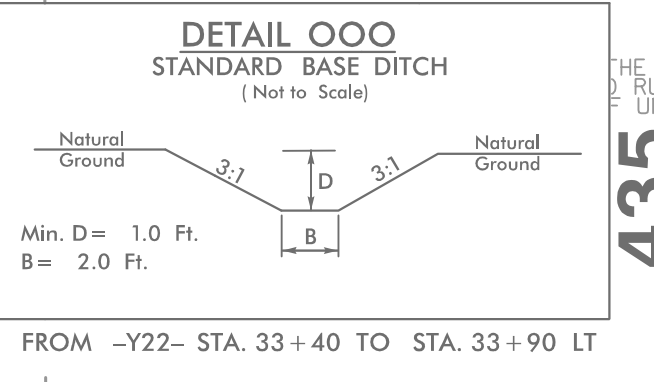
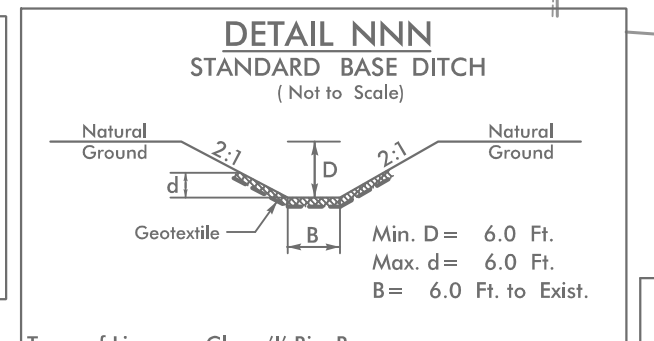
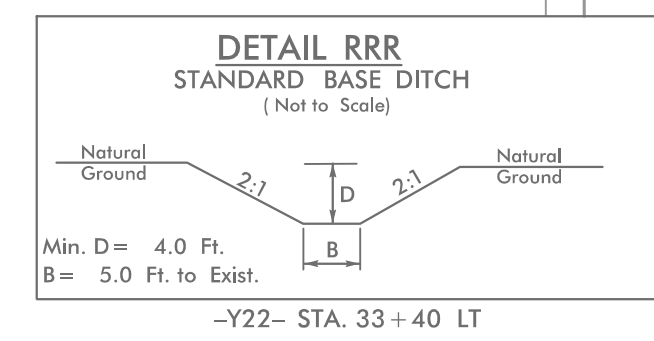
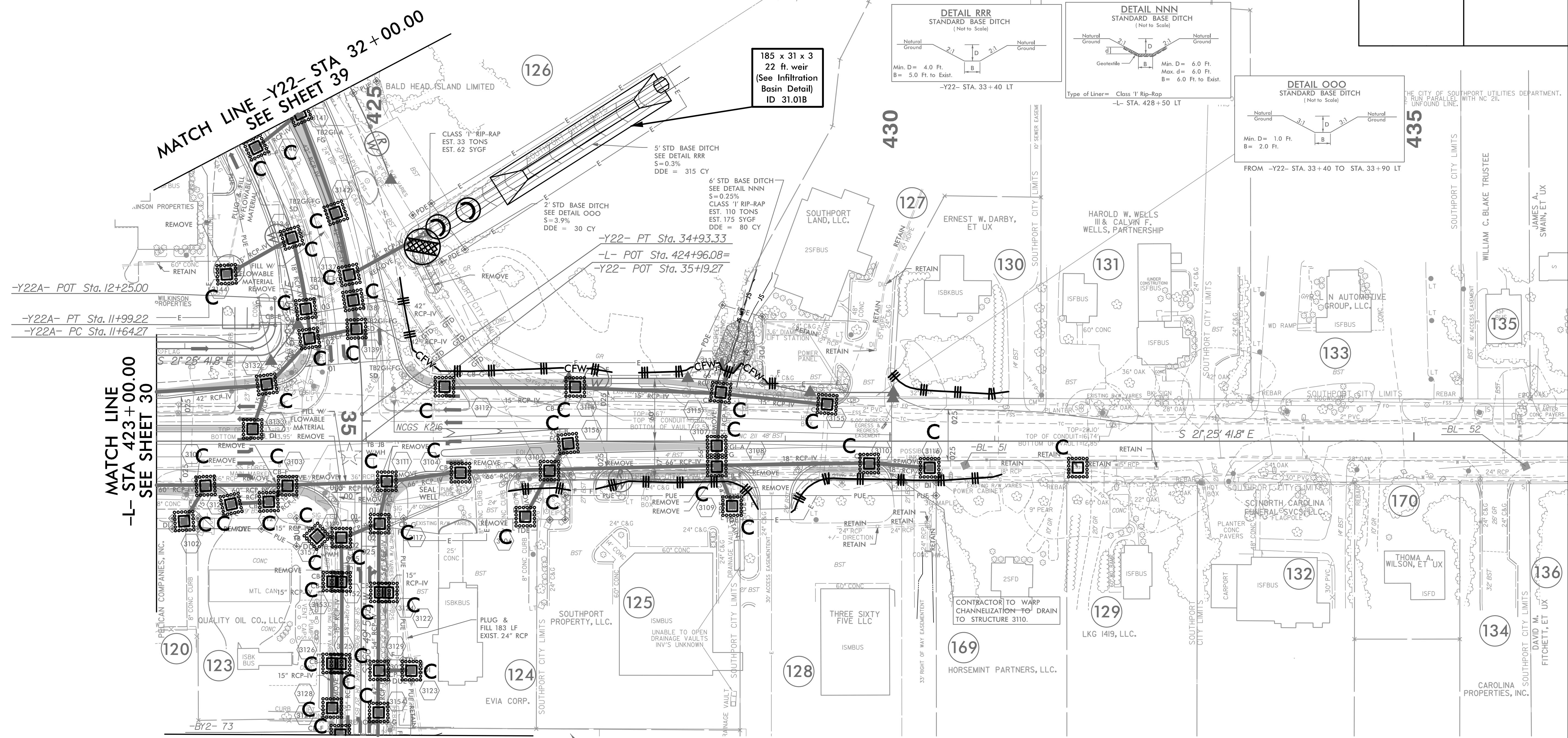

185 x 31 x 3
22 ft. weir
(See Infiltration
Basin Detail)
ID 31.01B

-Y22- PT Sta. 34+93.33
-L- POT Sta. 424+96.08=
-Y22- POT Sta. 35+19.27

-Y22A- POT Sta. 12+25.00
-Y22A- PT Sta. 11+99.22
-Y22A- PC Sta. 11+64.27

MATCH LINE
-L- STA 423+00.00
SEE SHEET 30

MATCH LINE -Y22- STA 38+00.00
SEE SHEET 40

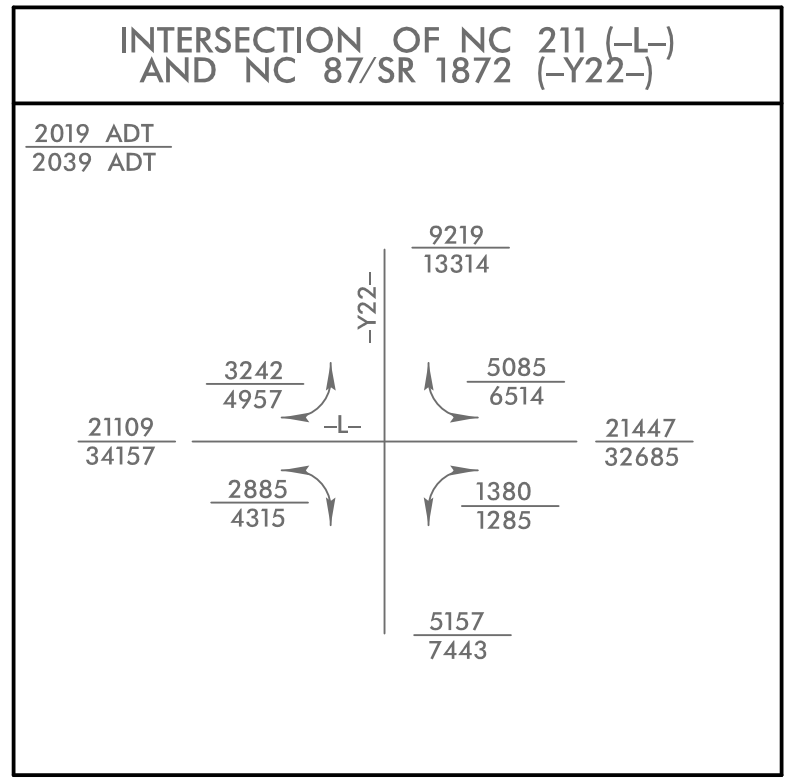

167

SMITHVILLE CROSSING, LLC.
DB 2503 PG 425
MB 13 PG 7
MB 36 PG 107
MB 22 PG 75
MB U PG 346

5/17/2021_EC_PSH31.dgn