

5/14/99

NOTE: UTILIZE COIR FIBER MATTING ADJACENT TO WETLANDS / JURISDICTIONAL AREAS, AND AS DIRECTED

DO NOT DISTURB FENCE AROUND BRUNSWICK ELECTRIC PARCEL

HNTB HNTB NORTH CAROLINA, P.C.
343 E. Six Forks Road, Suite 200
Raleigh, North Carolina 27609
NC License No: C-1554

| | |
|-------------------------|---------------------|
| PROJECT REFERENCE NO. | SHEET NO. |
| R-5021 | EC-62/CONST.24A |
| RW SHEET NO. | |
| ROADWAY DESIGN ENGINEER | HYDRAULICS ENGINEER |

MATCH LINE -Y14D- STA 14 + 50.00
SEE SHEET 36

MATCH LINE -L- STA 333 + 50.00
SEE SHEET 24

MATCH LINE -L- STA 343 + 00.00
SEE SHEET 25

MATCH LINE -Y14G-
STA 12 + 50.00
SEE SHEET 25

Place Matting for Erosion Control
or Coir Fiber Mat, as directed,
on Slope as Work Allows.
-Y14A- Sta. 41 + 00 to Sta. 43 + 50 RT

★ EXISTING TRAFFIC SIGNAL

NAD 83 NRS 2007

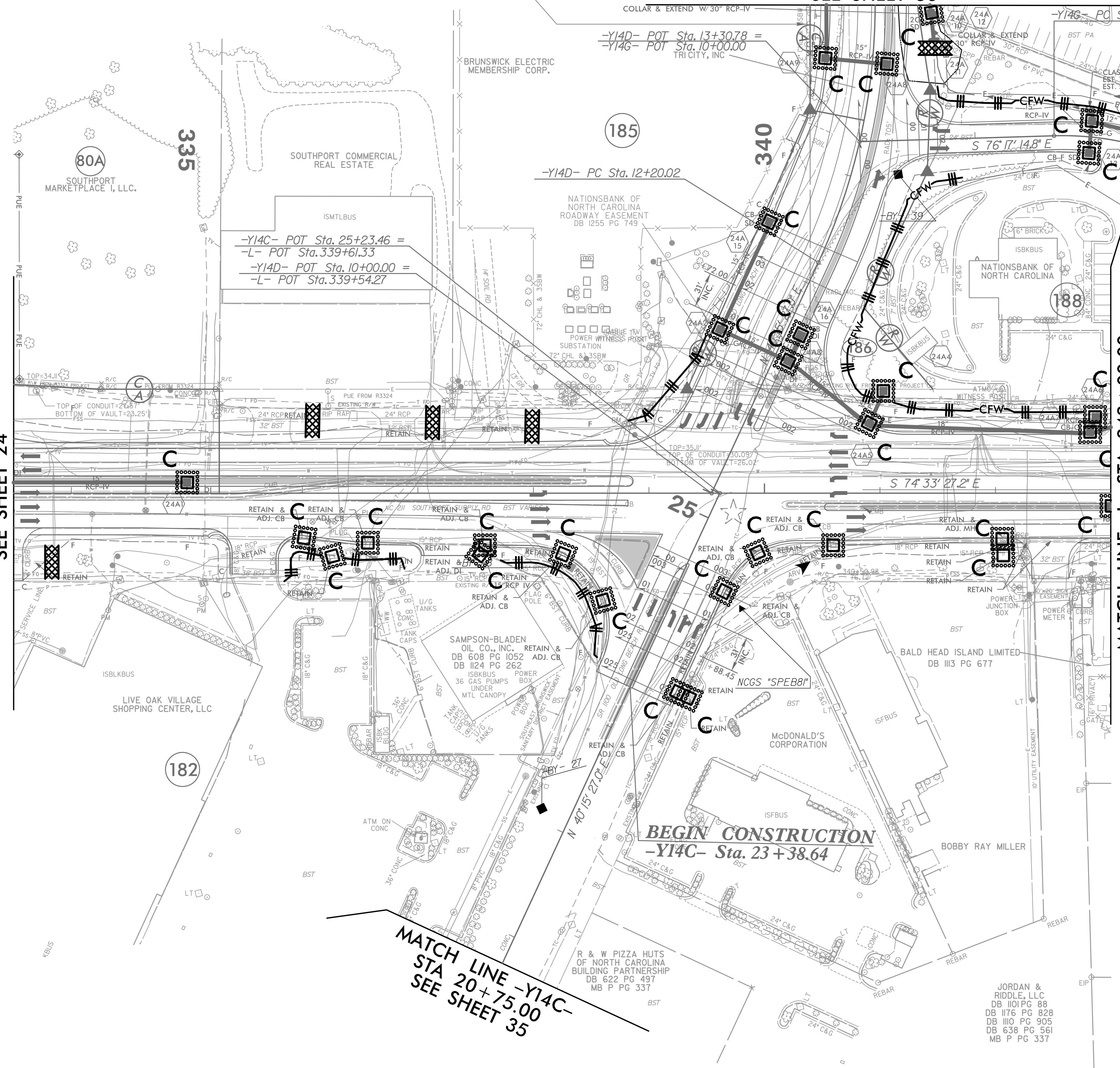

MATCH LINE -Y14C-
STA 20 + 75.00
SEE SHEET 35

INTERSECTION OF NC 211 (-L-) AND OLD LONGBEACH RD (-Y14CD-)

| | | | | |
|----------|---|--------|---|--------|
| 2019 ADT | X | | | |
| 2039 ADT | | | | |
| | | -Y14D- | | |
| | | | | 28,800 |
| | X | | X | |
| | | | | 8,500 |
| X | | -L- | | X |
| | | | | |
| | | | | 36,200 |
| | X | | X | |
| | | | | 11,400 |
| | | -Y14C- | | |
| | | | | 22,700 |
| | | | | |
| | | | | 38,100 |

JORDAN & RIDDLE, LLC
DB 1101 PG 88
DB 1176 PG 828
DB 1110 PG 905
DB 638 PG 561
MB P PG 337

4/21/2021_EC_PSH24A.dgn