

5/14/99

PROJECT REFERENCE NO.	SHEET NO.
R-5021	EC-60/CONST.23
RW SHEET NO.	
ROADWAY DESIGN ENGINEER	HYDRAULICS ENGINEER

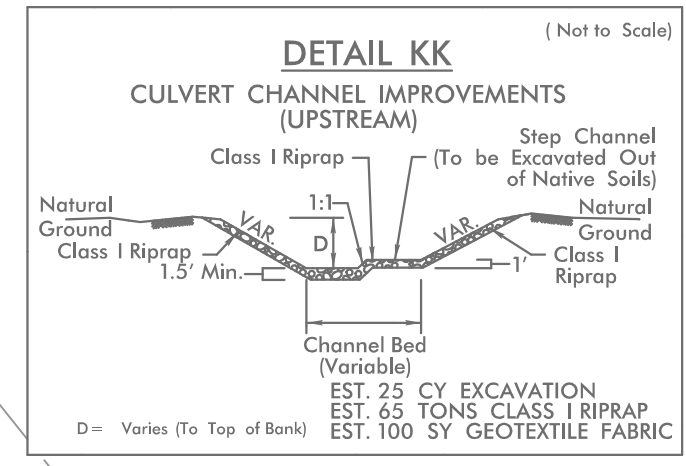
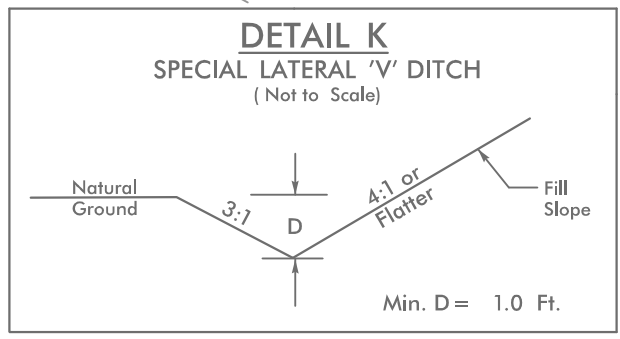
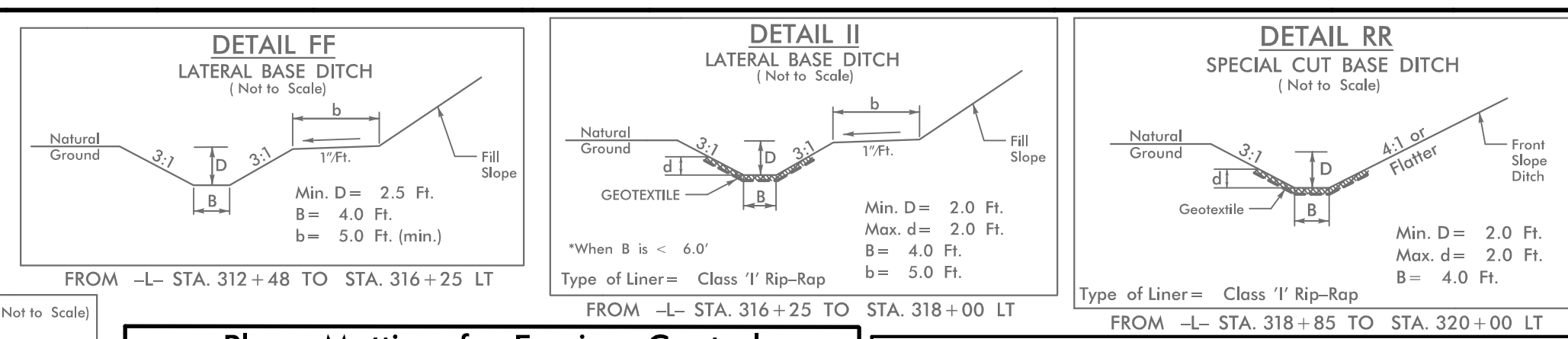

**Place Matting for Erosion Control or Coir Fiber Mat, as directed, on Slope as Work Allows.**

-L- Sta. 311+00 to Sta. 317+50 LT  
 -L- Sta. 313+50 to Sta. 315+50 RT  
 -L- Sta. 316+00 to Sta. 319+00 RT  
 -Y11- Sta. 11+00 to Sta. 11+75 LT & RT

NOTE: UTILIZE COIR FIBER MATTING ADJACENT TO WETLANDS / JURISDICTIONAL AREAS, AND AS DIRECTED

**BEGIN CONSTRUCTION**  
 -Y12- Sta. 11+55.00 -Y13- POT Sta. 10+00.00

**BEGIN CONSTRUCTION**  
 -Y13- Sta. 10+80.00

FROM -Y11- STA. 12+25 TO STA. 12+75 LT  
 FROM -Y11- STA. 12+25 TO STA. 12+75 RT  
 FROM -Y12- STA. 11+55 TO STA. 13+00 LT  
 FROM -Y12- STA. 11+55 TO STA. 12+80 RT  
 FROM -Y13- STA. 10+80 TO STA. 11+38 LT

-L- PC Sta. 314+88.28

110 x 40 x 2  
 31 ft. weir  
 (See Infiltration Basin Detail)  
 ID 23.04B

120 x 45 x 2  
 15 ft. weir  
 (See Infiltration Basin Detail)  
 ID 23.01B

INSTALL DRIVEWAY AFTER EROSION CONTROL BASIN IS REMOVED

Temporary Rock Silt Check Type A  
 2 ft. weir height

MATCH LINE -L- STA 311+00.00  
 SEE SHEET 22

MATCH LINE -L- STA 323+00.00  
 SEE SHEET 24

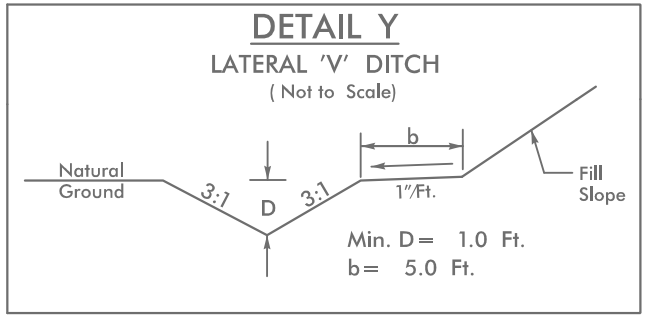
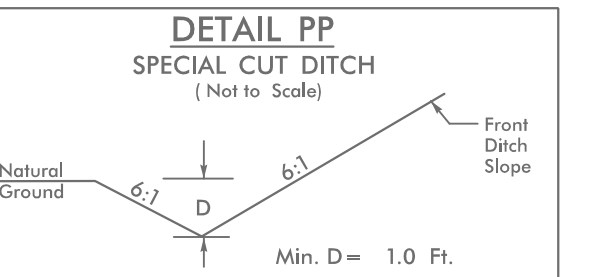
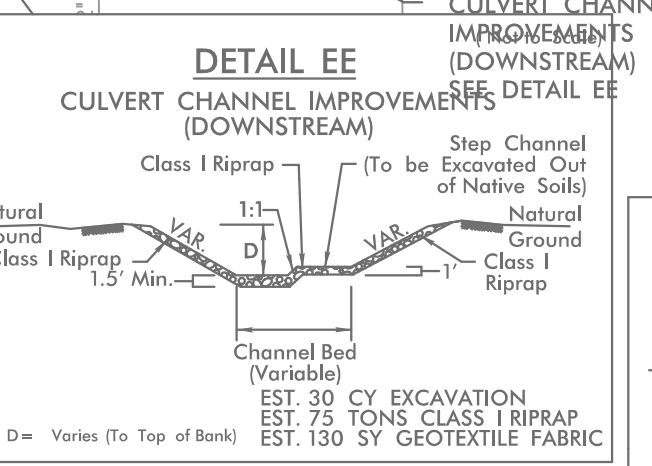
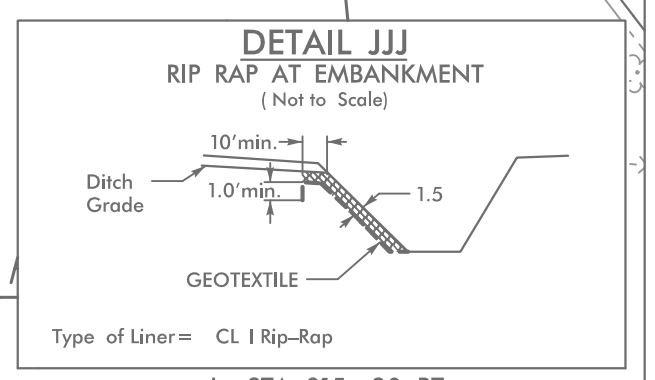
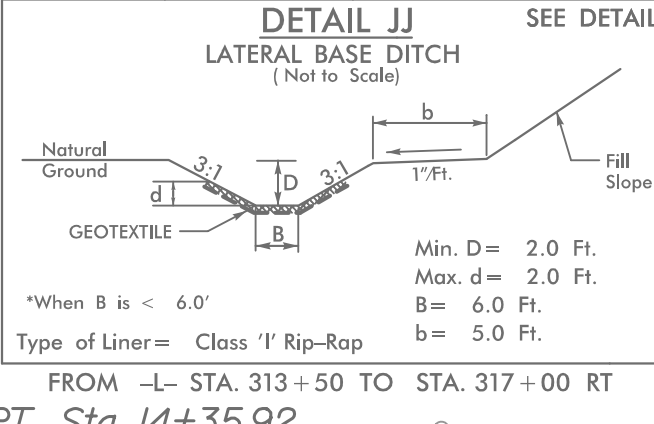
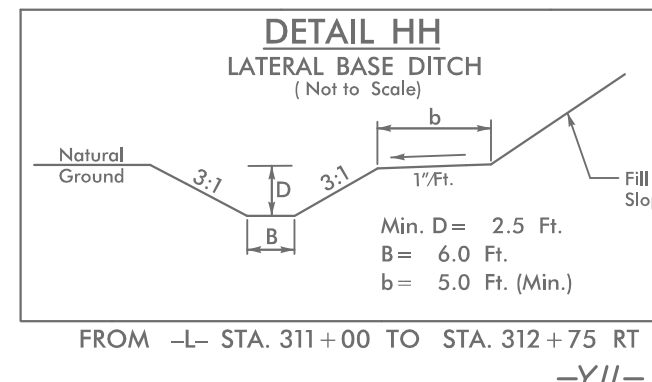
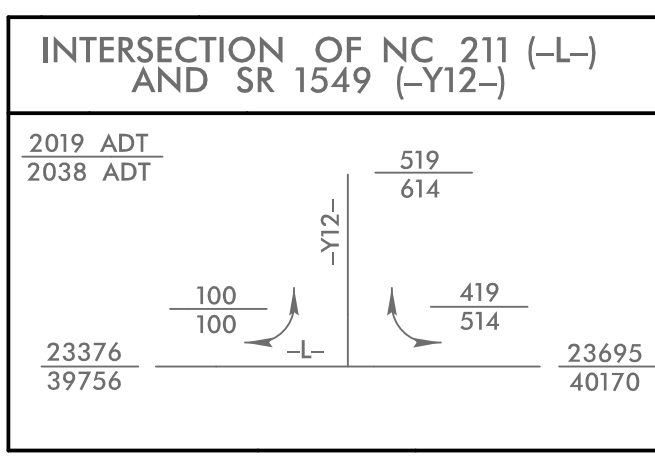
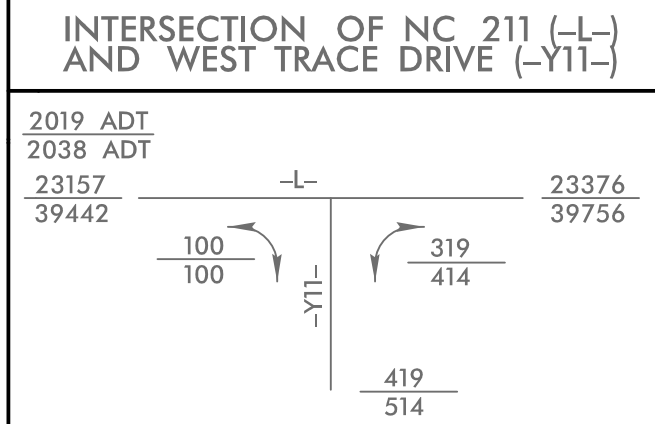
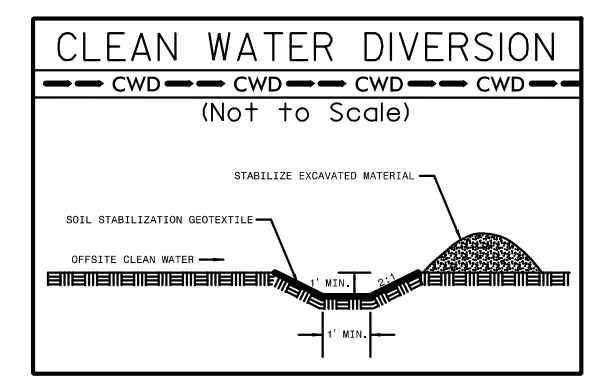
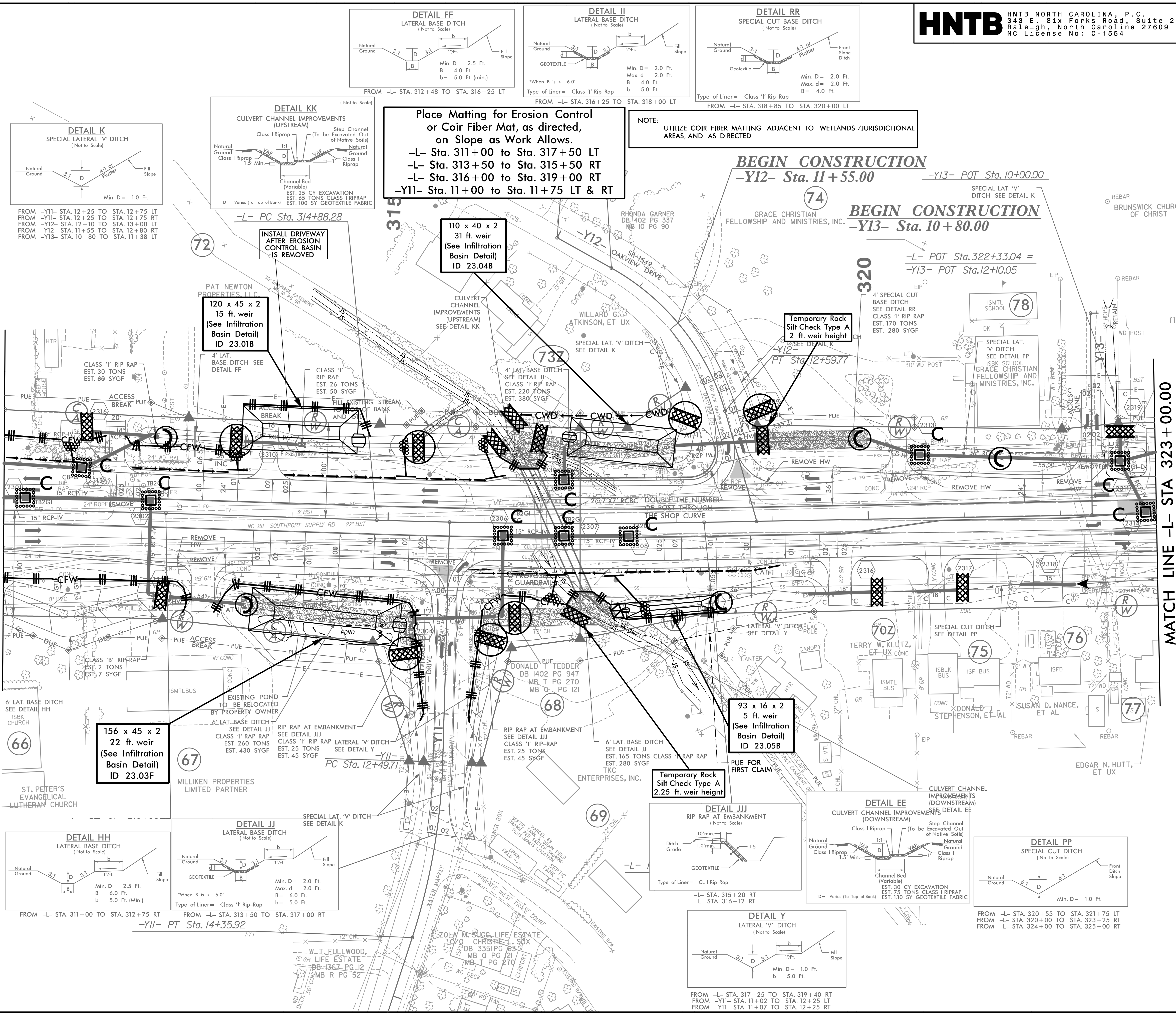

10/13/2021 EC\_PSH23.dgn

NAD 83 NRS 2007