

5/14/99

Place Matting for Erosion Control
or Coir Fiber Mat, as directed,
on Slope as Work Allows.
-L- Sta. 269+00 to Sta. 283+00 RT
-L- Sta. 269+00 to Sta. 283+00 LT

NOTE: UTILIZE COIR FIBER MATTING ADJACENT TO WETLANDS / JURISDICTIONAL AREAS, AND AS DIRECTED

HNTB HNTB NORTH CAROLINA, P.C.
343 E. Six Forks Road, Suite 200
Raleigh, North Carolina 27609
NC License No: C-1554

PROJECT REFERENCE NO.	SHEET NO.
R-5021	EC-57/CONST.20
RW SHEET NO.	
ROADWAY DESIGN ENGINEER	HYDRAULICS ENGINEER

NAD
83/NSRS
2007

MATCH LINE -L- STA 269+00.00
SEE SHEET 19

MATCH LINE -L- STA 283+00.00
SEE SHEET 21

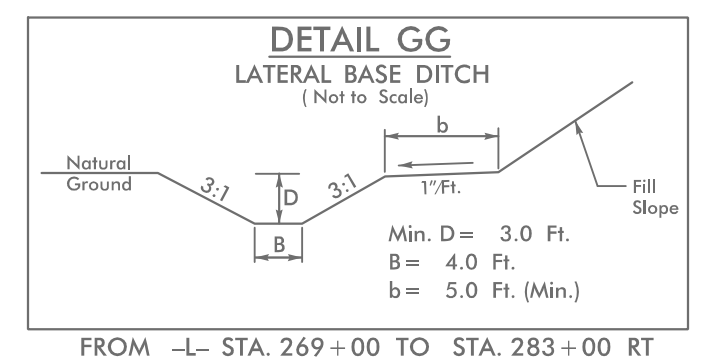
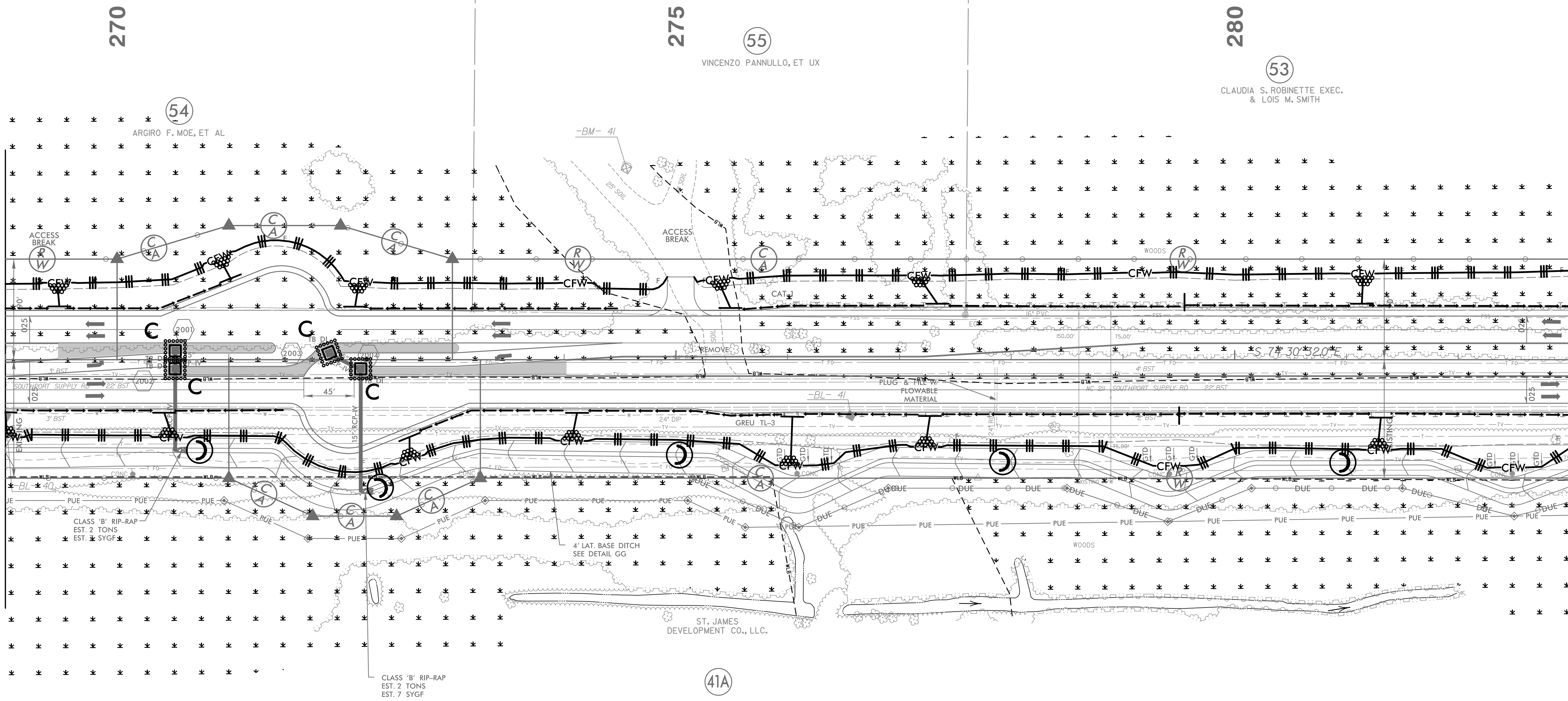

5/14/2021_EC_PSH20.dgn