

5/14/99

NOTE: UTILIZE COIR FIBER MATTING ADJACENT TO WETLANDS / JURISDICTIONAL AREAS, AND AS DIRECTED

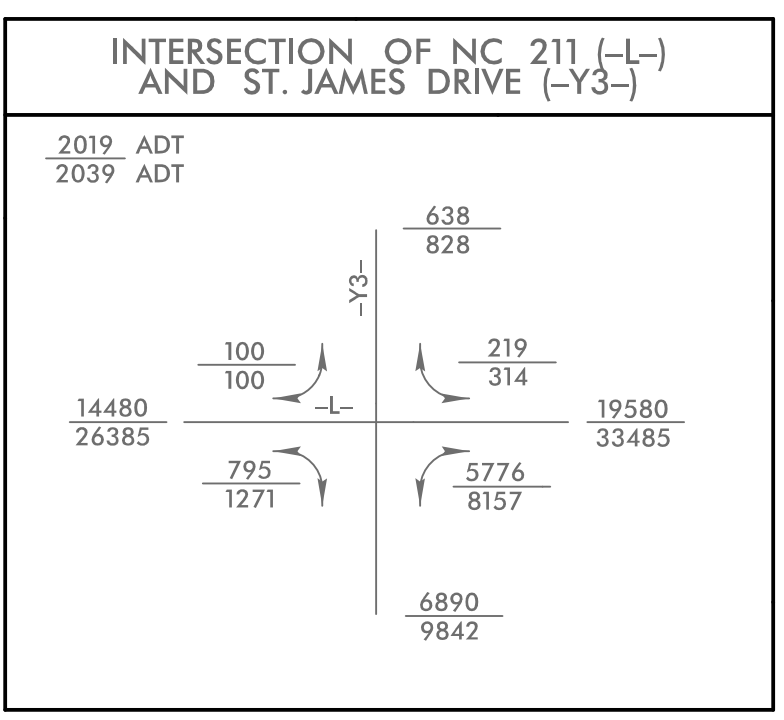
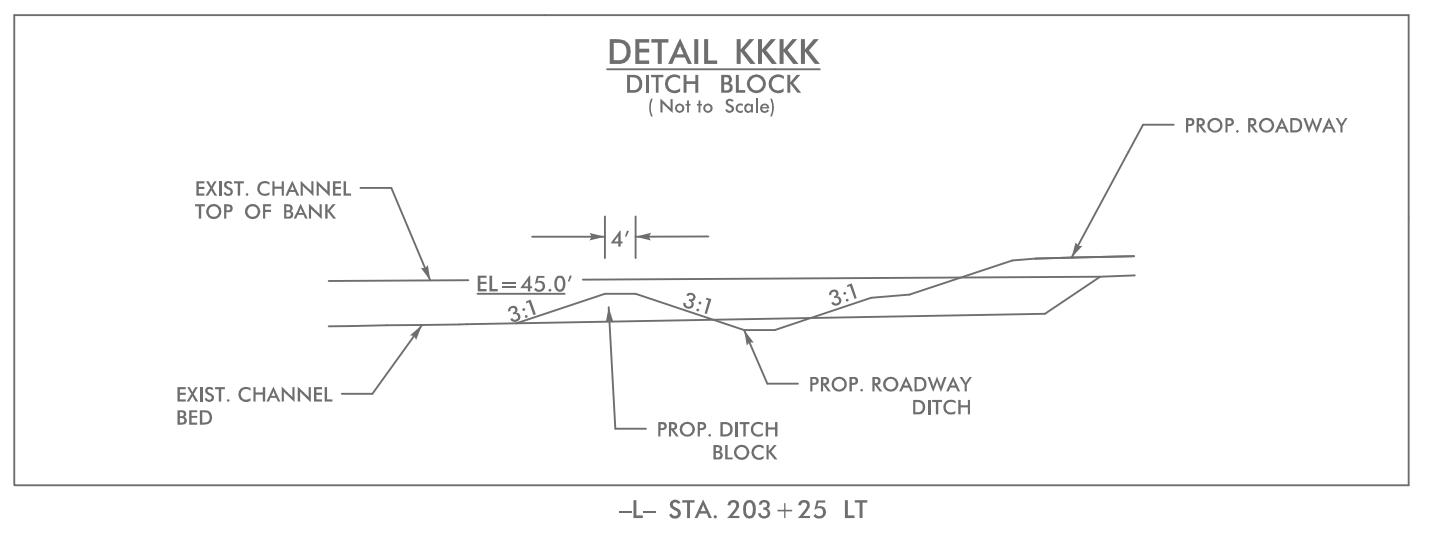

HNTB HNTB NORTH CAROLINA, P.C. 343 E. Six Forks Road, Suite 200 Raleigh, North Carolina 27609 NC License No: C-1554

PROJECT REFERENCE NO.	SHEET NO.
R-5021	EC-52/CONST.15
RW SHEET NO.	
ROADWAY DESIGN ENGINEER	HYDRAULICS ENGINEER

Place Matting for Erosion Control or Coir Fiber Mat, as directed, on Slope as Work Allows.

- L- Sta. 199+00 to Sta. 205+50 RT
- L- Sta. 199+00 to Sta. 204+50 LT
- L- Sta. 205+50 to Sta. 210+00 LT
- L- Sta. 212+00 to Sta. 213+00 LT

2.5 inch Skimmer with 2.25 inch Orifice Diameter 12 ft. weir with 3.5 ft. weir height ID 15.02F (See Earthen Dam with Skimmer Detail)

MATCH LINE -L- STA 199+00.00 SEE SHEET 14

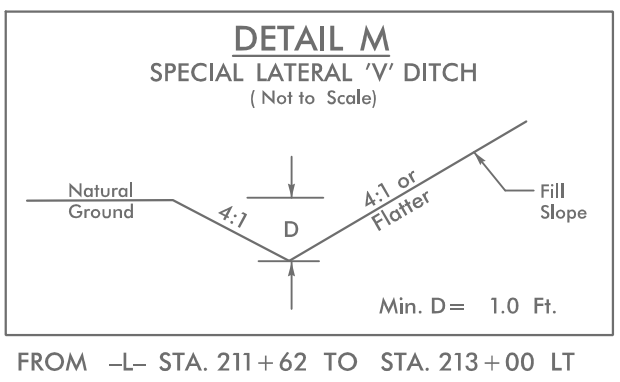
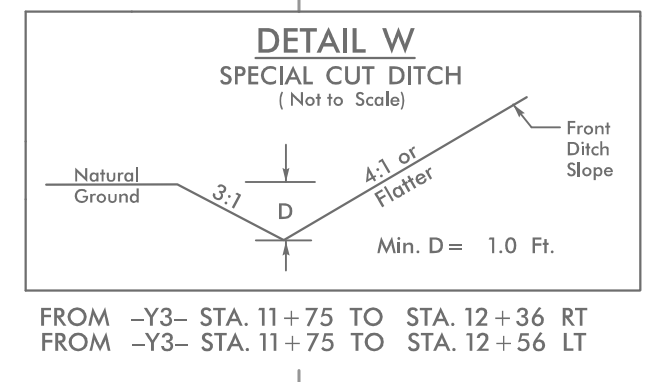
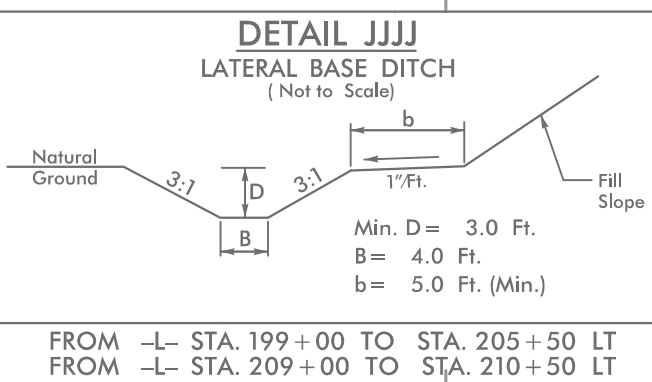
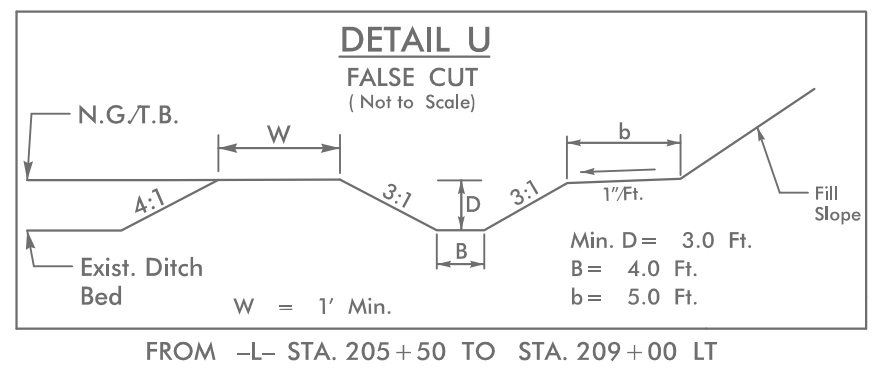
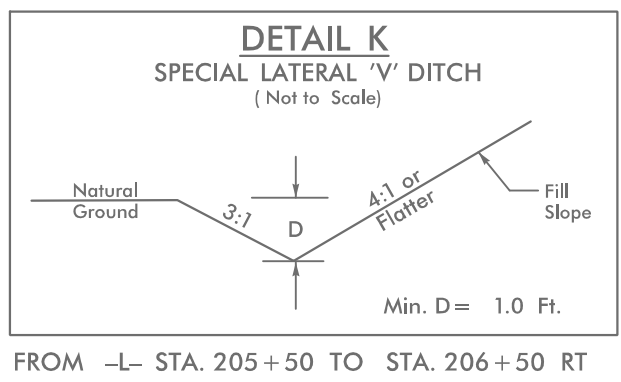
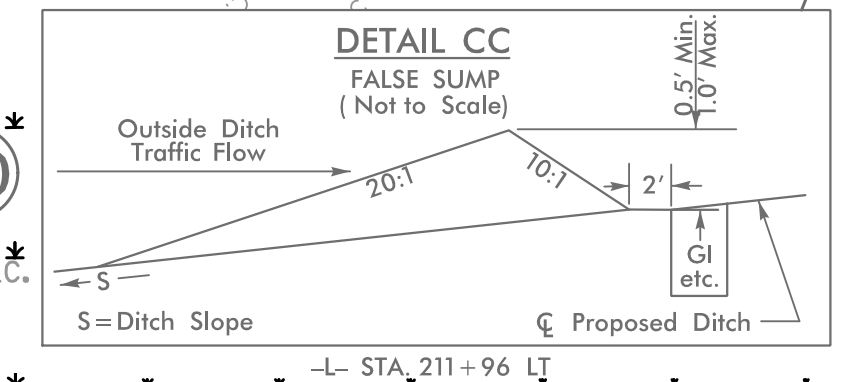
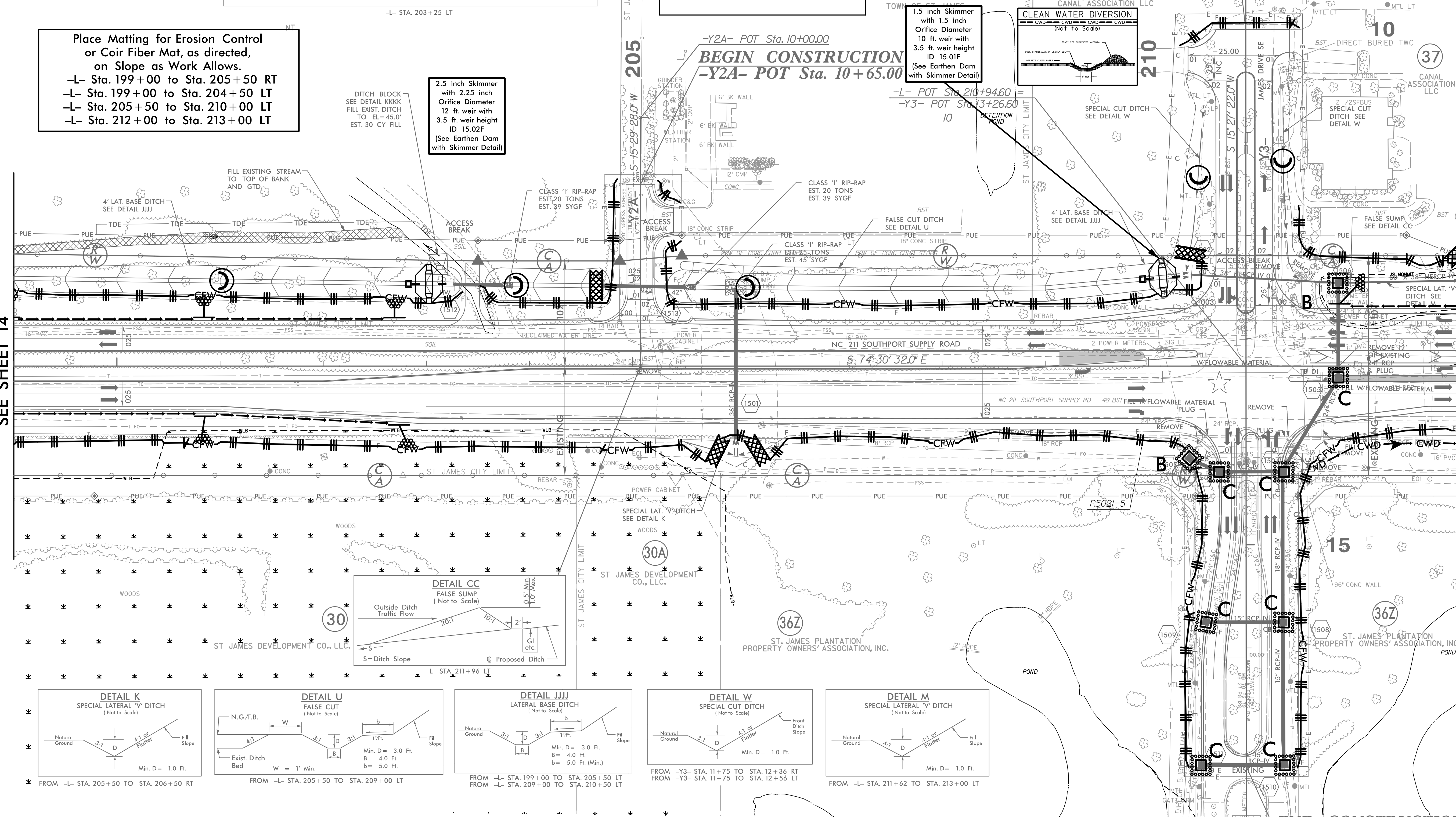

1.5 inch Skimmer with 1.5 inch Orifice Diameter 10 ft. weir with 3.5 ft. weir height ID 15.01F (See Earthen Dam with Skimmer Detail)

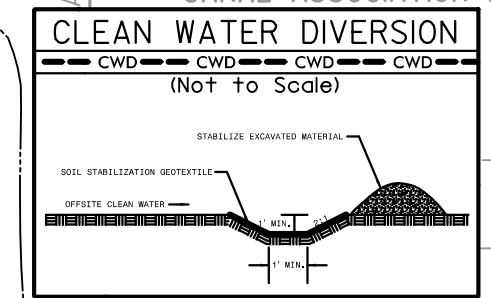

FOR -L- PROFILE, SEE SHEET 46
 FOR -Y2A- & -Y3- PROFILES, SEE SHEET 60
 FOR INTERSECTION DETAIL, SEE SHEET 2B-1
 FOR DRAINAGE DETAILS, SEE SHEETS 2D-1 THRU 2D-3

MATCH LINE -L- STA 213+00.00 SEE SHEET 16

END CONSTRUCTION -Y3- Sta. 17+15.00

4/21/2021_EC_PSH15.dgn