

|                         |                     |
|-------------------------|---------------------|
| PROJECT REFERENCE NO.   | SHEET NO.           |
| R-5021                  | EC-37A/CONST.37     |
| RW SHEET NO.            |                     |
| ROADWAY DESIGN ENGINEER | HYDRAULICS ENGINEER |

**R-5021 CULVERT PHASING 6 OF 6  
 OLD LONG BEACH ROAD OVER UT TO DUTCHMAN CREEK  
 BRUNSWICK COUNTY  
 -Y14D- 23+35**

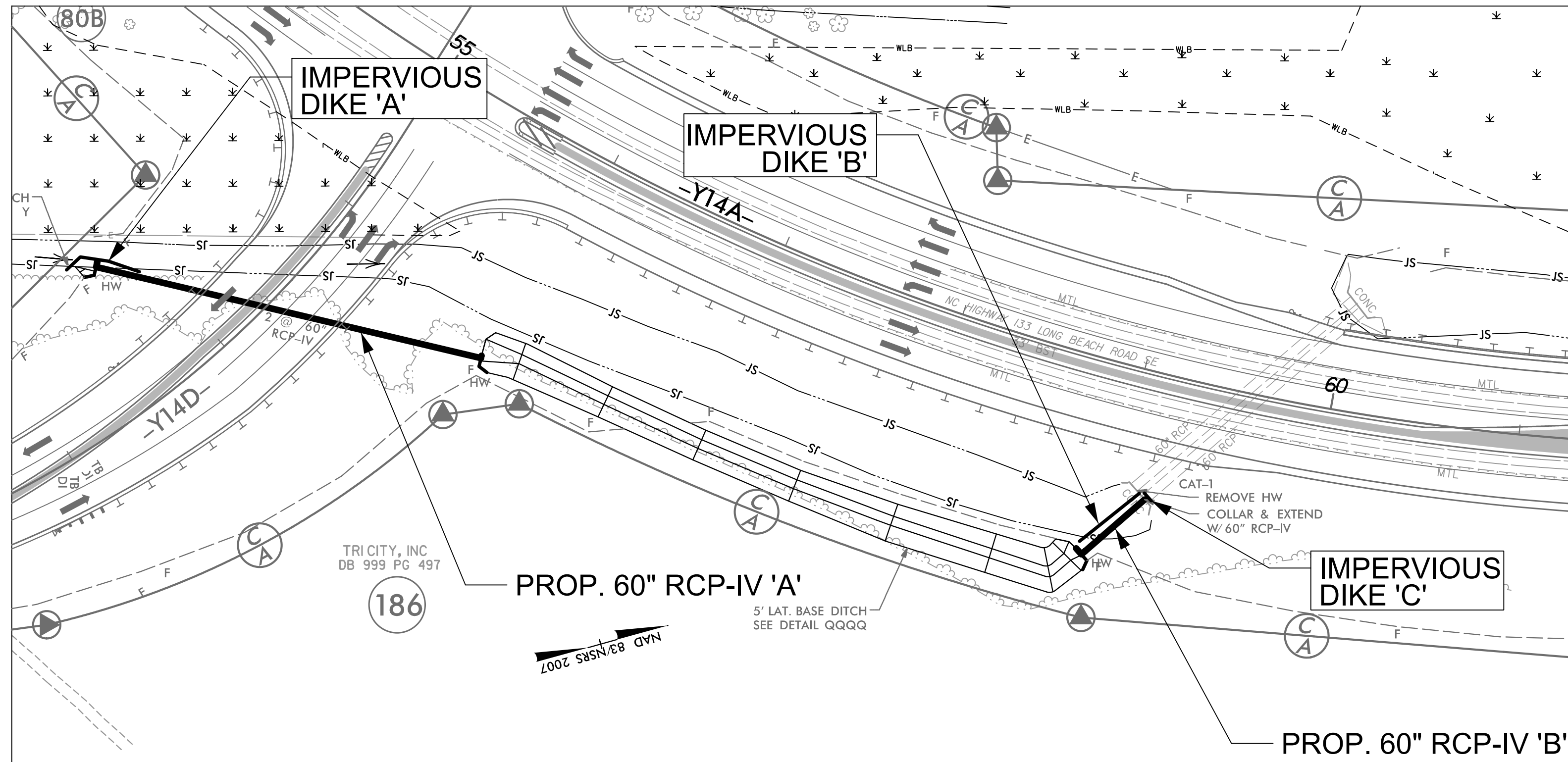

**PHASE I**

1. UTILIZE SPECIAL STILLING BASIN(S) AS NEEDED DURING CULVERT CONSTRUCTION.
2. INSTALL IMPERVIOUS DIKES 'A', 'B' AND 'C'
3. DEWATER CONSTRUCTION AREA(S) INTO SPECIAL STILLING BASIN(S).
4. INSTALL PROPOSED 60" RCP-IV 'A' AND 'B' AND HEADWALLS.
5. CONSTRUCT PROPOSED 5' LATERAL BASE DITCH SOUTH OF Y14A (NC HIGHWAY 133 LONG BEACH ROAD SE).

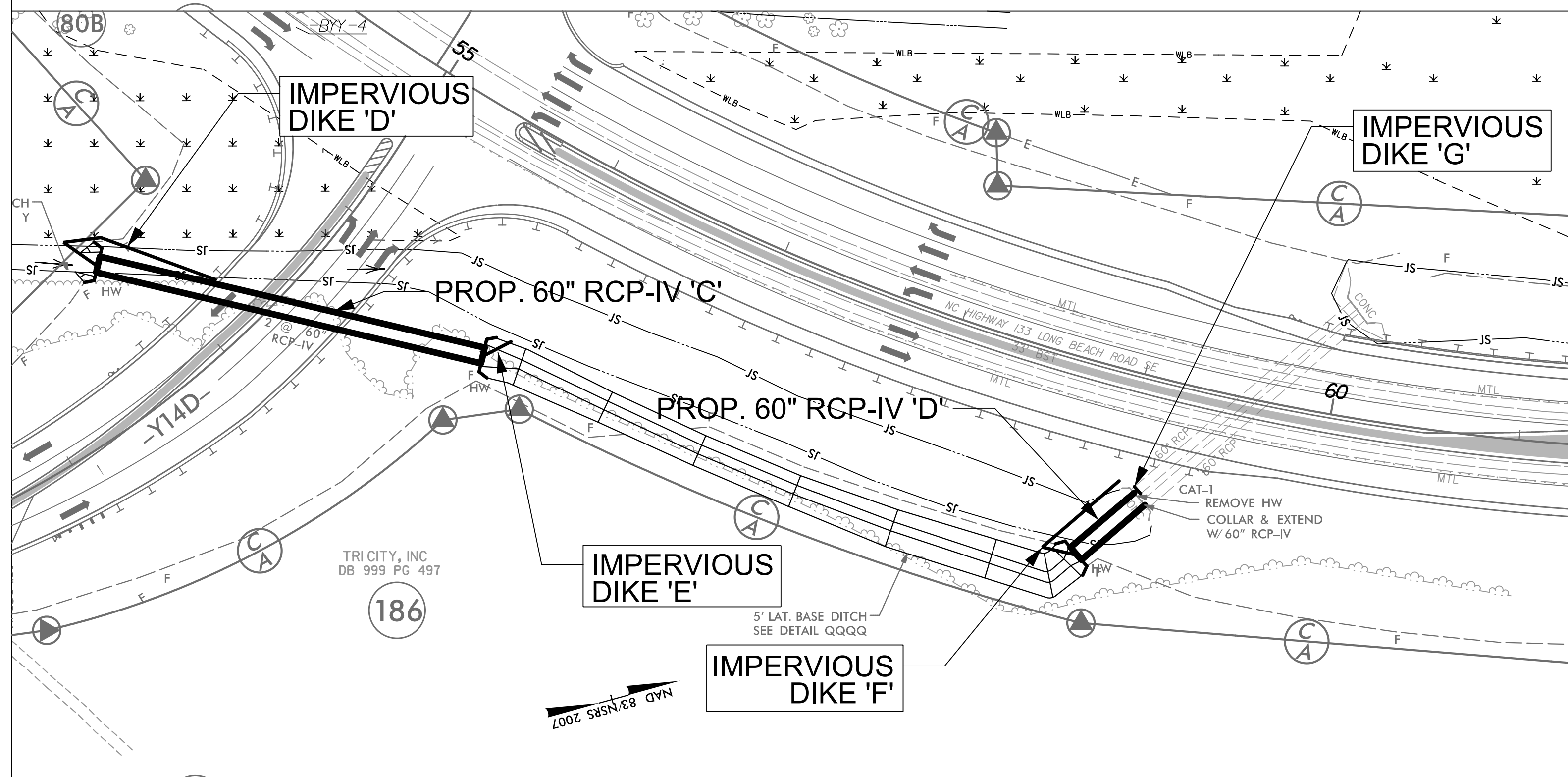

**PHASE II**

1. REMOVE IMPERVIOUS DIKES 'A', 'B' AND 'C'.
2. INSTALL IMPERVIOUS DIKES 'D', 'E', 'F' AND 'G'.
3. DEWATER CONSTRUCTION AREA(S) INTO SPECIAL STILLING BASIN(S).
4. DIVERT FLOW TO NEWLY CONSTRUCTED 60" RCP-IV 'A' AND 'B'.
5. INSTALL PROPOSED 60" RCP-IV 'C' AND 'D' AND HEADWALLS.
6. REMOVE IMPERVIOUS DIKES 'D', 'E', 'F' AND 'G'.
7. CONSTRUCT PROPOSED FILL SLOPE SOUTH SIDE OF Y14A (NC HIGHWAY 133 LONG BEACH ROAD SE).