

REMOVE CONFLICTING PAVEMENT MARKING.

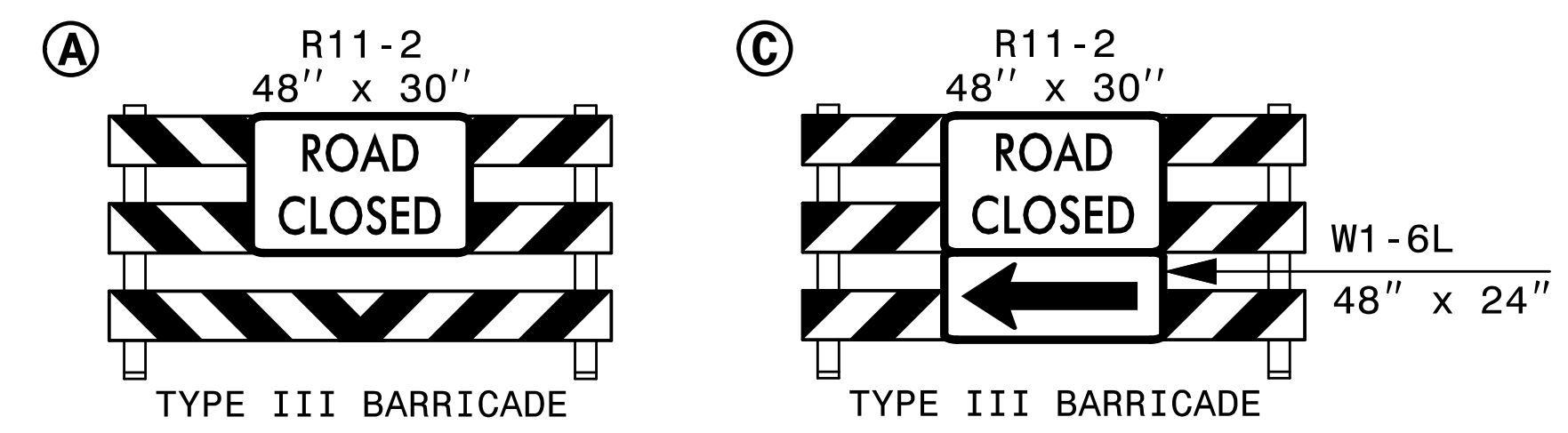

16 EST QUANTITY = 766.5 SF
 TEMPORARY SHORING
 FROM -L- STA 316+15+/-, 8' LT
 TO -L- STA 317+21+/-, 7.18' LT
 (SEE SHEET TMP-2G FOR TEMPORARY SHORING NOTES)

17 EST QUANTITY = 1106 SF
 TEMPORARY SHORING
 FROM -L- STA 316+02+/-, 9' LT
 TO -L- STA 317+23+/-, 9' LT
 (SEE SHEET TMP-2G FOR TEMPORARY SHORING NOTES)

INSTALL SIGNS AS REQUIRED PER RSD 1101.03 (SHEET 3 OF 9.)

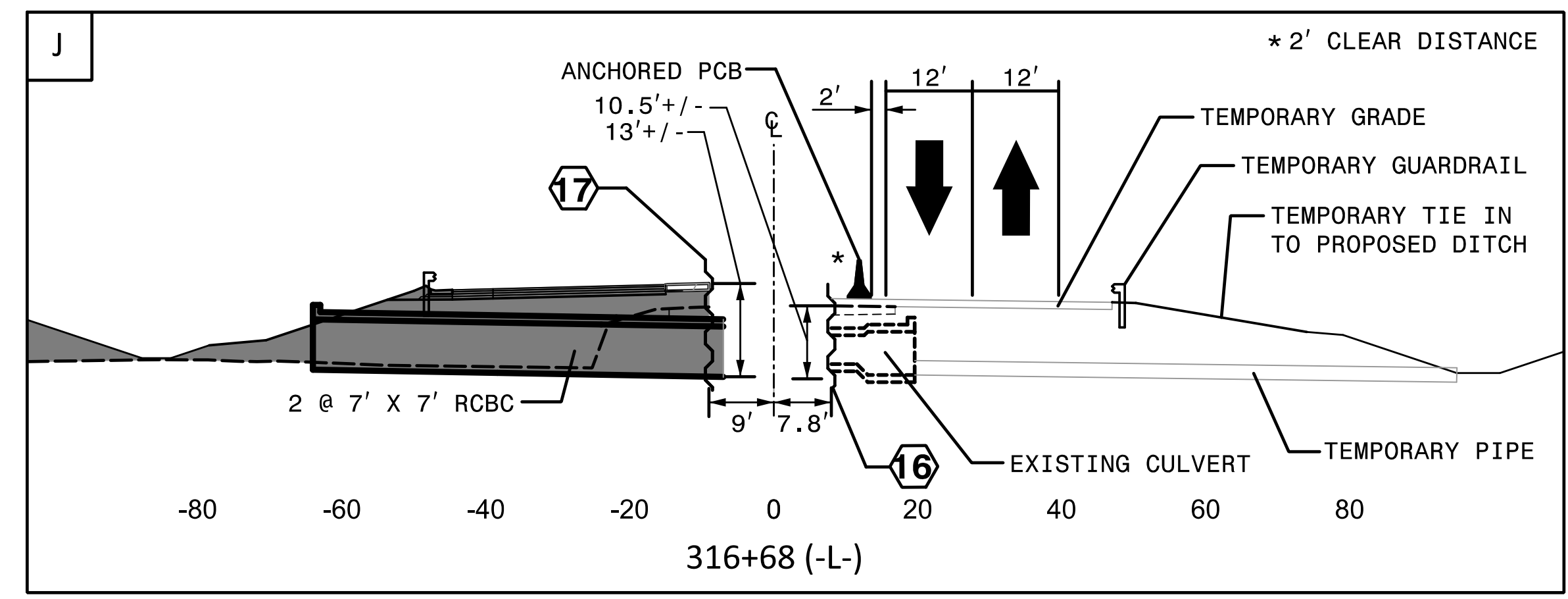
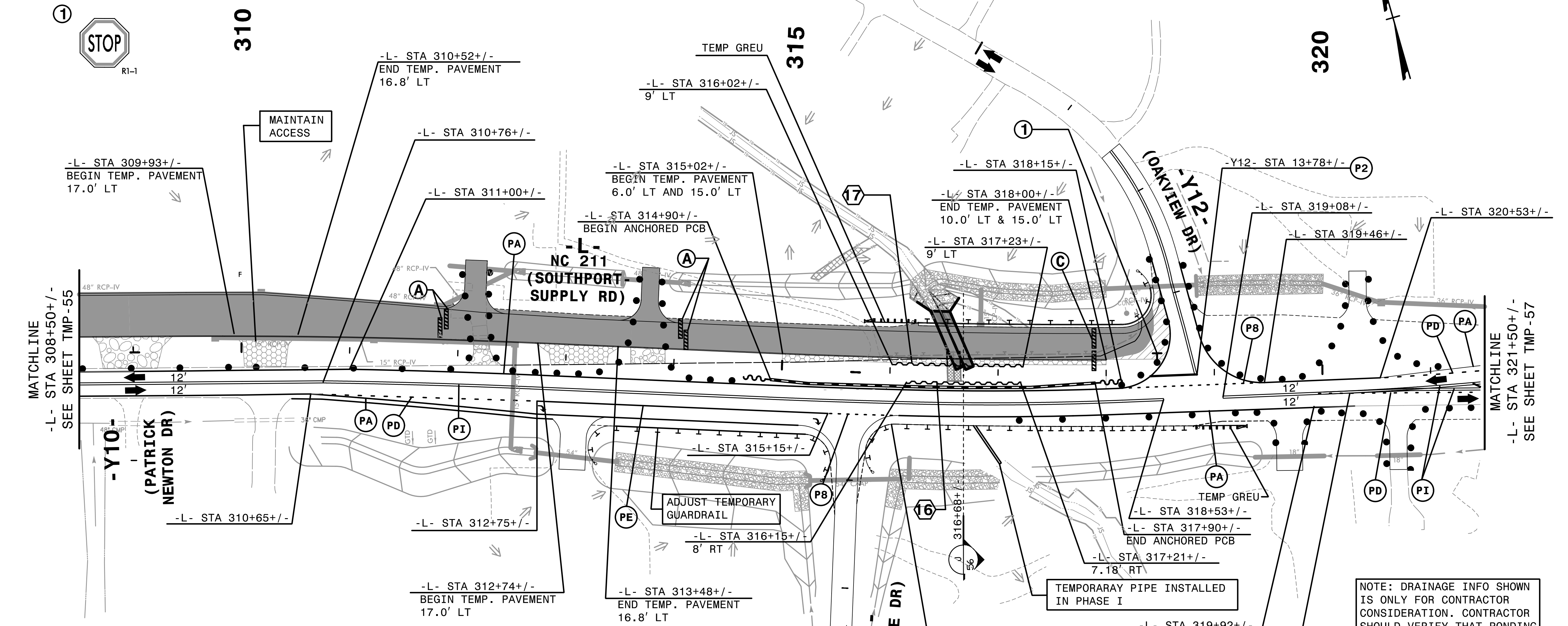

NOTE: DRAINAGE INFO SHOWN IS ONLY FOR CONTRACTOR CONSIDERATION. CONTRACTOR SHOULD VERIFY THAT PONDING OF WATER WILL NOT OCCUR IN THE TRAVEL LANES.

SEE EC-23A/CONST.23 FOR CULVERT PHASING

10/09/28 AM
\\TCR\5021_Tc_pld\ta.dgn
\$\$\$\$\$USERNAME\$\$\$\$\$

HNTB
 HNTB NORTH CAROLINA, P.C.
 343 E. Six Forks Road, Suite 200
 Raleigh, North Carolina 27609
 NC License No: C-1554

APPROVED: *Helen Shyu*
 DATE: 10/28/2021
 SEAL
 DOCUMENT NOT CONSIDERED FINAL
 UNLESS ALL SIGNATURES COMPLETED

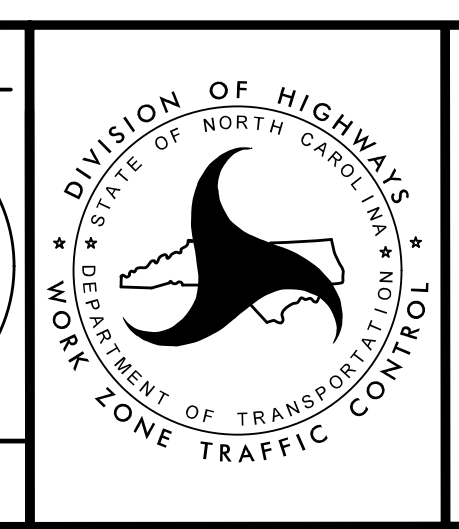

TRANSPORTATION
 MANAGEMENT PLAN
 PHASE IA
 DETAIL