

SURVEY CONTROL SHEET

W/ EXISTING CENTERLINE ALIGNMENTS PRIOR TO CONSTRUCTION

PROJECT REFERENCE NO.	SHEET NO.
R-5021	RW02C-3
Location and Surveys	
LOCATION & SURVEYS DIVISION 3 5310 BARBADOS BLVD. #102 CASTLE HAYNE, NC 28429 (910) 341-2280	
PROJECT SURVEYOR	
DOCUMENT NOT CONSIDERED FINAL UNLESS ALL SIGNATURES COMPLETED	

I, CHRISTOPHER J. SAWYER, PLS, certify that the Project Control was [performed/verified] under my supervision from an actual GPS survey made under my supervision and the following information was used to perform the survey:

Class of survey: **AA**
 Type of GPS field procedure: NC-VRS-RTN
 Dates of survey: NOVEMBER 2009 TO SEPTEMBER 2021
 Datum/Epoch: NAD 83/NSRS 2007
 Published/Fixed-control use: Project_Control_N/A_for_RTN
 Localized around: SOUTHPORT EAST BASE RESET 1981
 Northing: 74895.9850
 Easting: 228816.3700
 Combined grid factor: 1.00012636797
 Geoid model: G09NC
 Units: US SURVEY FEET

I also certify that the Baseline Control for this project was not completed under my direct and responsible charge from an actual survey made under my supervision; that all horizontal closures had a minimum ratio of precision of 1:20,000 (Class AA) and Vertical accuracy to Class A. Field work was performed from NOVEMBER 2009 to SEPTEMBER 2021, and all coordinates are based on NAD 83/2007 and all elevations are based on NAVD 88; that this survey was performed to meet the requirements of 21NCAC 56.1600 as applicable.

This 24TH day of SEPTEMBER, 2021.

DocuSigned by:

 Professional Land Surveyor L-4526

MATCHLINE
SEE SHEET RW02C-2

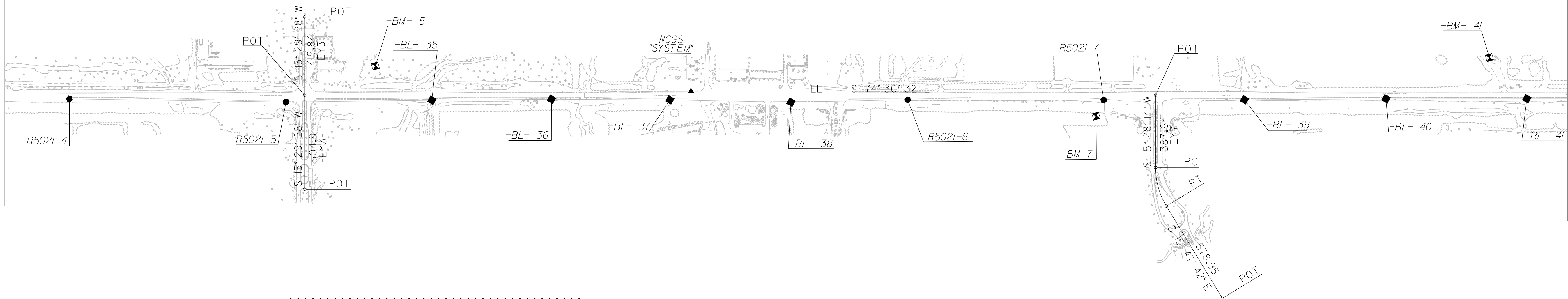

MATCHLINE
SEE SHEET RW02C-4

```

.....
BM5      ELEVATION = 45.55
N 78478   E 2276834
BM5_9*PINE
.....
BM7      ELEVATION = 42.95
N 77186   E 2280490
BM7_9*PINE
.....
BM41     ELEVATION = 42.16
N 76925   E 2282609
BM41_12*PINE
.....
SYSTEM1  ELEVATION = 43.38
N 77896   E 2278431
NCGS MON SYSTEM
.....
    
```

BL	POINT	DESC.	NORTH	EAST	ELEVATION
R5021-4		GPS CAP AND REBAR	78746.6700	2275204.0760	47.56
R5021-5		GPS CAP AND REBAR	78420.1800	2276319.9310	45.79
BL-35		TRV CAP AND REBAR	78219.9253	2277076.9963	44.56
BL-36		TRV CAP AND REBAR	78053.7357	2277697.3186	39.88
BL-37		TRV CAP AND REBAR	77880.5670	2278308.6558	43.18
BL-38		TRV CAP AND REBAR	77695.1310	2278931.5463	44.04
R5021-6		GPS CAP AND REBAR	77540.4450	2279539.0060	42.39
R5021-7		GPS CAP AND REBAR	77257.7380	2280552.7630	41.47
BL-39		TRV CAP ANDREBAR	77057.5700	2281281.1511	40.93
BL-40		TRV CAP AND REBAR	76859.5256	2282014.5704	40.61
BL-41		TRV CAP AND REBAR	76657.9680	2282743.2962	40.60

NOTES:

- PROJECT CONTROL WAS ESTABLISHED USING GNSS, THE GLOBAL NAVIGATION SATELLITE SYSTEM.
- THE SURVEY CONTROL DATA FOR THIS PROJECT HAS BEEN COMPILED FROM VARIOUS SOURCES. IF FURTHER INFORMATION REGARDING PROJECT CONTROL IS NEEDED, PLEASE CONTACT THE LOCATION AND SURVEYS UNIT.

REVISIONS

27-SEP-2021 11:59 S:\Units\033\Projects\RURAL\Brunswick Co\RW021\Working\RW Sheets\210907 revised rw sheets\REVISED 210924\RW021.LS_RW02C-3.dgn
 m.jduval At LS-298896