

5/28/19

PROJECT REFERENCE NO. R-5021	SHEET NO. 52
ROADWAY DESIGN ENGINEER	HYDRAULICS ENGINEER

**DOCUMENT NOT CONSIDERED FINAL
UNLESS ALL SIGNATURES COMPLETED**



NOTE: SEE CROSS SECTIONS FOR UNDERCUT LOCATIONS FROM:
-L- 360+95 TO 363+33 RT

NOTE: FOR -L- ALIGNMENT, SEE SHEET - 26

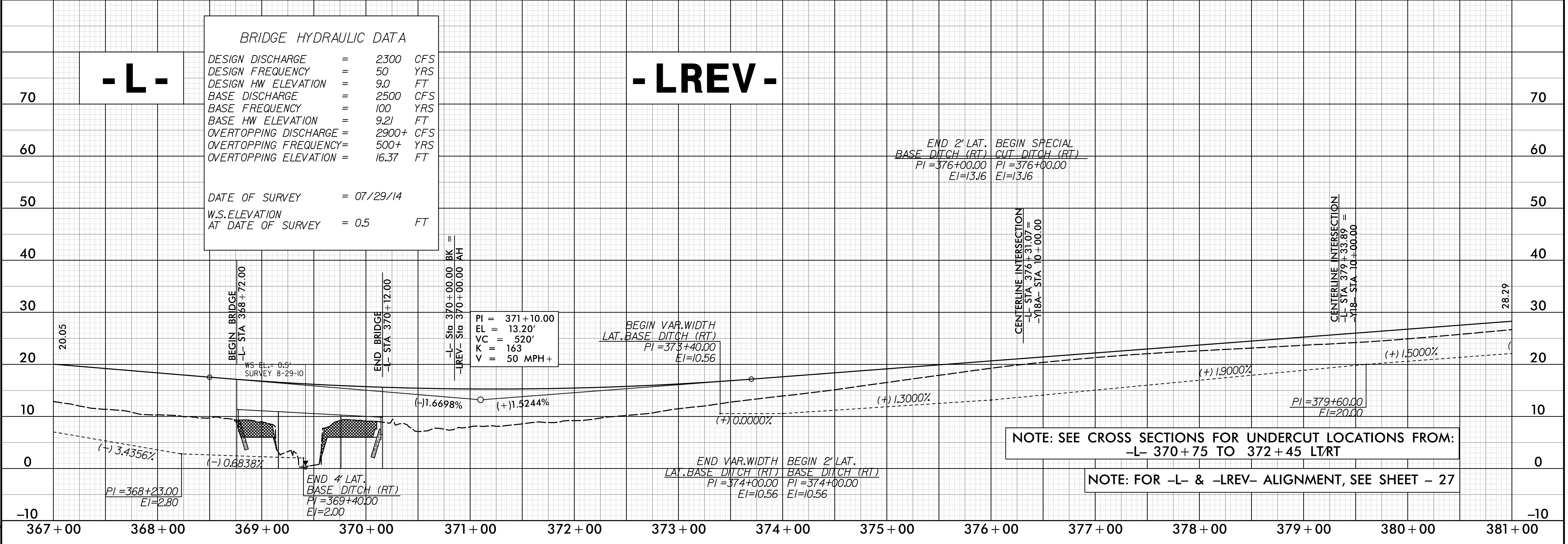

NOTE: SEE CROSS SECTIONS FOR UNDERCUT LOCATIONS FROM:
-L- 370+75 TO 372+45 LT/RT

NOTE: FOR -L- & -LREV- ALIGNMENT, SEE SHEET - 27

22-JUL-2021 09:58
\\p03dway\p\proj\5021\RDY_PFL_PSH52.dgn
AHL