

5/28/19

PROJECT REFERENCE NO. R-5021	SHEET NO. 50
ROADWAY DESIGN ENGINEER	HYDRAULICS ENGINEER

DOCUMENT NOT CONSIDERED FINAL UNLESS ALL SIGNATURES COMPLETED

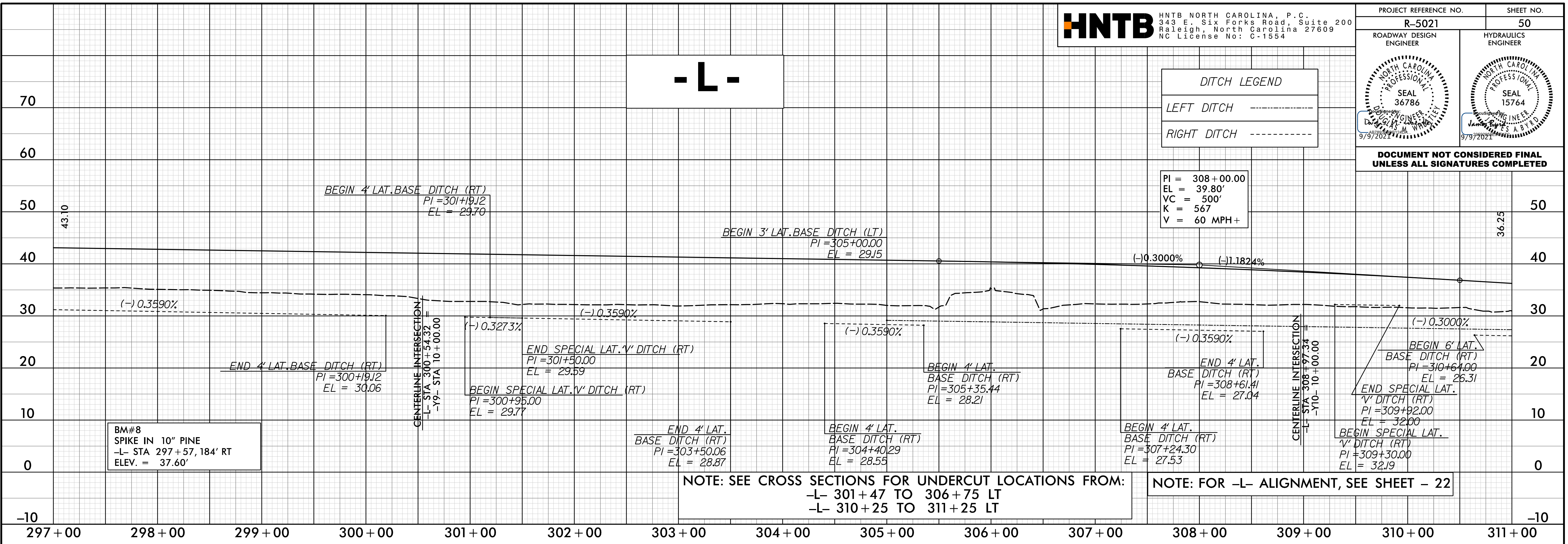

PI = 308+00.00
 EL = 39.80'
 VC = 500'
 K = 567
 V = 60 MPH+

NOTE: FOR -L- ALIGNMENT, SEE SHEET - 22

NOTE: SEE CROSS SECTIONS FOR UNDERCUT LOCATIONS FROM:
 -L- 301+47 TO 306+75 LT
 -L- 310+25 TO 311+25 LT

BM#8
 SPIKE IN 10" PINE
 -L- STA 297+57, 184' RT
 ELEV. = 37.60'

CULVERT HYDRAULIC DATA

DESIGN DISCHARGE	= 830	CFS
DESIGN FREQUENCY	= 50	YRS
DESIGN HW ELEVATION	= 27.6	FT
BASE DISCHARGE	= 870	CFS
BASE FREQUENCY	= 100	YRS
BASE HW ELEVATION	= 27.8	FT
OVERTOPPING DISCHARGE	= 950+	CFS
OVERTOPPING FREQUENCY	= 500+	YRS
OVERTOPPING ELEVATION	= 31.87	FT

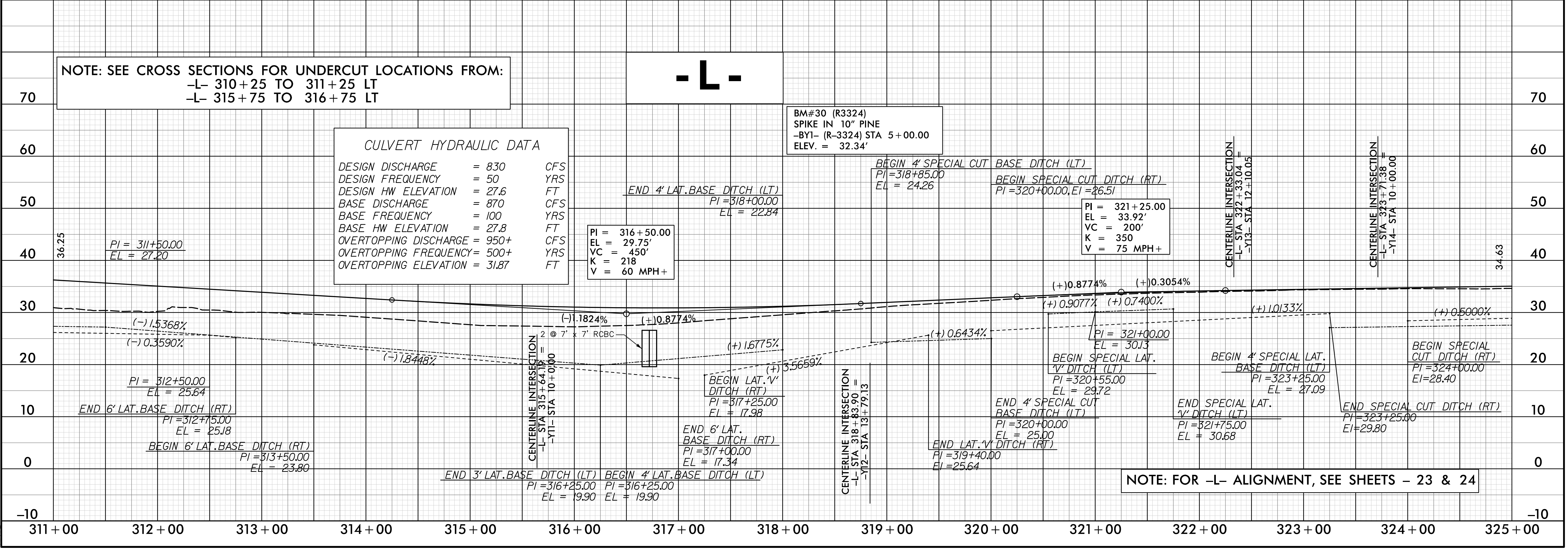

NOTE: FOR -L- ALIGNMENT, SEE SHEETS - 23 & 24

NOTE: SEE CROSS SECTIONS FOR UNDERCUT LOCATIONS FROM:
 -L- 310+25 TO 311+25 LT
 -L- 315+75 TO 316+75 LT

22-JUL-2021 09:58
 (Roadway) P-coj-r-5021-L-RD-L-PFL_PSH50.dgn
 DATE