

5/28/2021

PROJECT REFERENCE NO. R-5021	SHEET NO. 48
ROADWAY DESIGN ENGINEER <i>[Signature]</i>	HYDRAULICS ENGINEER <i>[Signature]</i>

DOCUMENT NOT CONSIDERED FINAL UNLESS ALL SIGNATURES COMPLETED

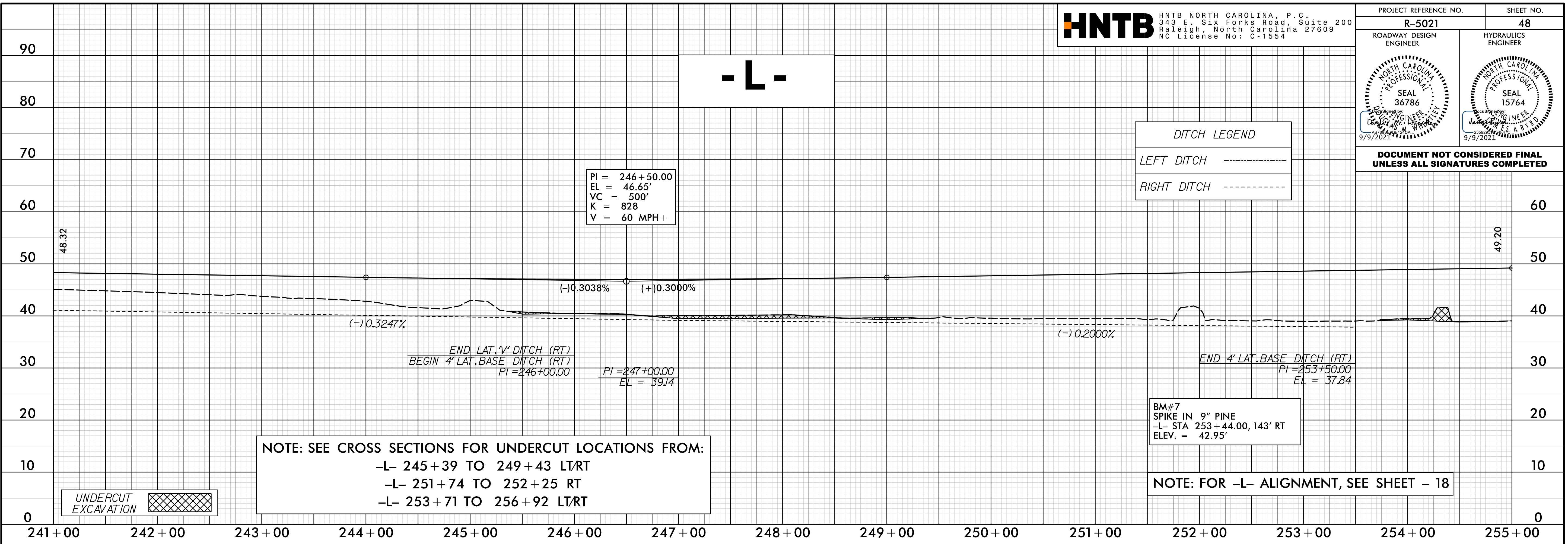

NOTE: SEE CROSS SECTIONS FOR UNDERCUT LOCATIONS FROM:
 -L- 245+39 TO 249+43 LT/RT
 -L- 251+74 TO 252+25 RT
 -L- 253+71 TO 256+92 LT/RT

NOTE: FOR -L- ALIGNMENT, SEE SHEET - 18



PIPE HYDRAULIC DATA
 -L- Sta. 255+65 (STR #1901)

DRAINAGE AREA	= 20	AC
DESIGN FREQUENCY	= 50	YRS
DESIGN DISCHARGE	= 50	CFS
DESIGN HW ELEVATION	= 42.0	FT
100 YEAR DISCHARGE	= -	CFS
100 YEAR HW ELEVATION	= -	FT
OVERTOPPING FREQUENCY	= 100(-)	YRS
OVERTOPPING DISCHARGE	= 58	CFS
OVERTOPPING ELEVATION	= 42.6	FT

PIPE HYDRAULIC DATA
 -L- Sta. 266+00 (STR #1910)

DRAINAGE AREA	= 42	AC
DESIGN FREQUENCY	= 5	YRS
DESIGN DISCHARGE	= 38	CFS
DESIGN HW ELEVATION	= 40.5	FT
100 YEAR DISCHARGE	= -	CFS
100 YEAR HW ELEVATION	= -	FT
OVERTOPPING FREQUENCY	= 5	YRS
OVERTOPPING DISCHARGE	= 38	CFS
OVERTOPPING ELEVATION	= 40.5	FT

NOTE: SEE CROSS SECTIONS FOR UNDERCUT LOCATIONS FROM:
 -L- 253+71 TO 256+92 LT/RT
 -L- 259+05 TO 262+82 LT/RT

NOTE: FOR -L- ALIGNMENT, SEE SHEET - 19

22-JUL-2021 09:58
 (Roadway) (Profile) R-5021-L-RDY_PFL_PSH48.dgn