

PROJECT REFERENCE NO. R-5021	SHEET NO. 31
RW SHEET NO.	
ROADWAY DESIGN ENGINEER	HYDRAULICS ENGINEER
DOCUMENT NOT CONSIDERED FINAL UNLESS ALL SIGNATURES COMPLETED	

**DO NOT DISTURB THE MONUMENT
"NCGS K216".**

NAD 83/NSRS 2007

EXISTING TRAFFIC SIGNAL

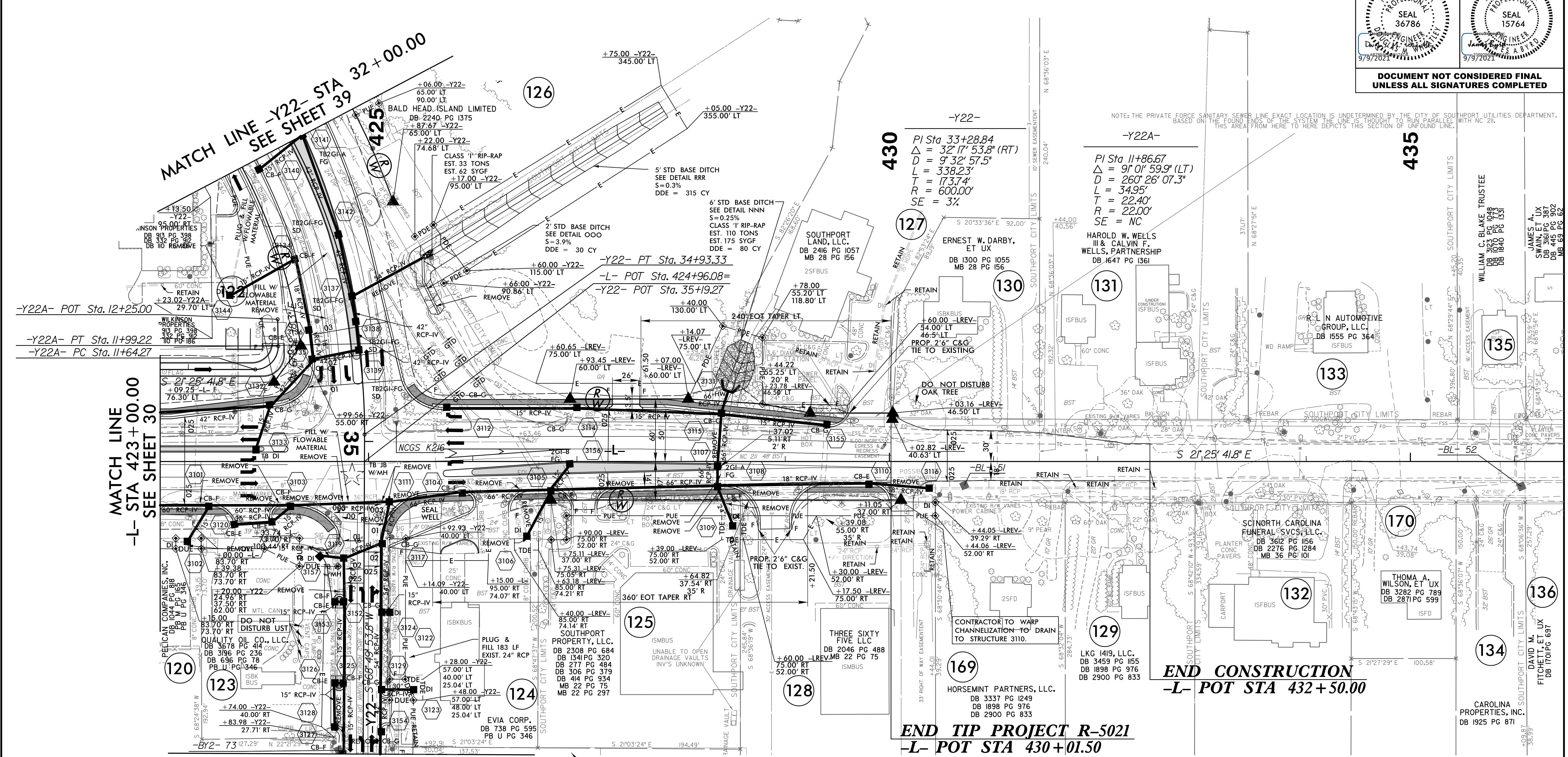

MATCH LINE -Y22- STA 32+00.00
SEE SHEET 29

MATCH LINE -Y22- STA 39+00.00
SEE SHEET 30

MATCH LINE -Y22- STA 38+00.00
SEE SHEET 40

-Y22A- POT Sta. 12+25.00
-Y22A- POT Sta. 11+99.22
-Y22A- PC Sta. 11+64.27

MATCH LINE
-L- STA 423+00.00
SEE SHEET 30

**END TIP PROJECT R-5021
-L- POT STA 430+01.50**

**END CONSTRUCTION
-L- POT STA 432+50.00**

NOTE:

1. ALL DRIVEWAY RADII ARE 20' UNLESS NOTED ON PLANS.
2. PAVED TURNOUTS FOR SHOULDER SECTION SHOULD EXTEND 50' UNLESS NOTED ON PLANS.

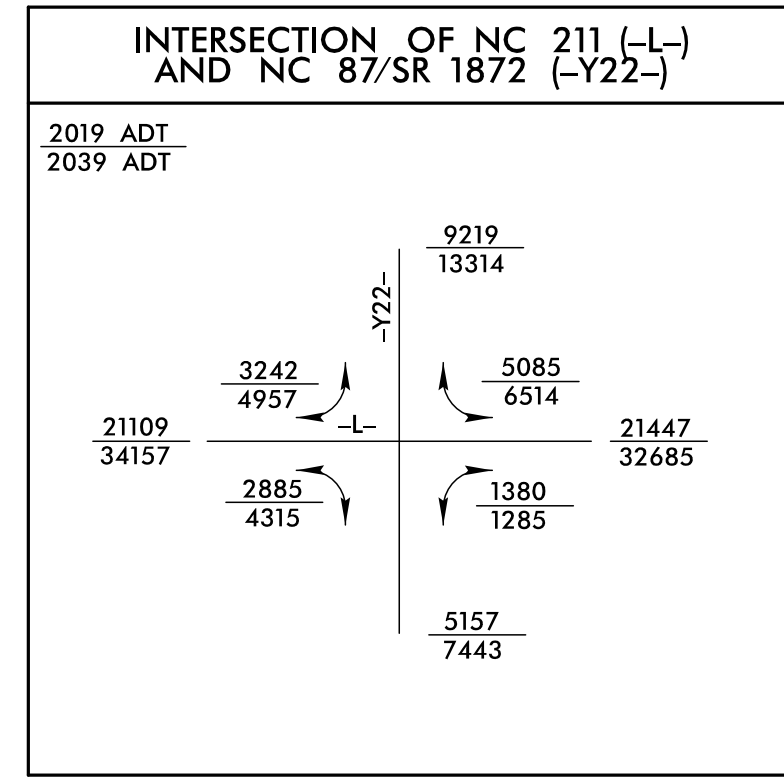

FOR -L- PROFILE, SEE SHEET 54
FOR -Y22- PROFILE, SEE SHEET 69
FOR INTERSECTION DETAIL, SEE SHEET 2B-4
FOR DRAINAGE DETAILS, SEE SHEETS 2D-1 THRU 2D-3