

5/14/2017

PROJECT REFERENCE NO. R-5021	SHEET NO. 23
ROADWAY DESIGN ENGINEER	HYDRAULICS ENGINEER
DOCUMENT NOT CONSIDERED FINAL UNLESS ALL SIGNATURES COMPLETED	

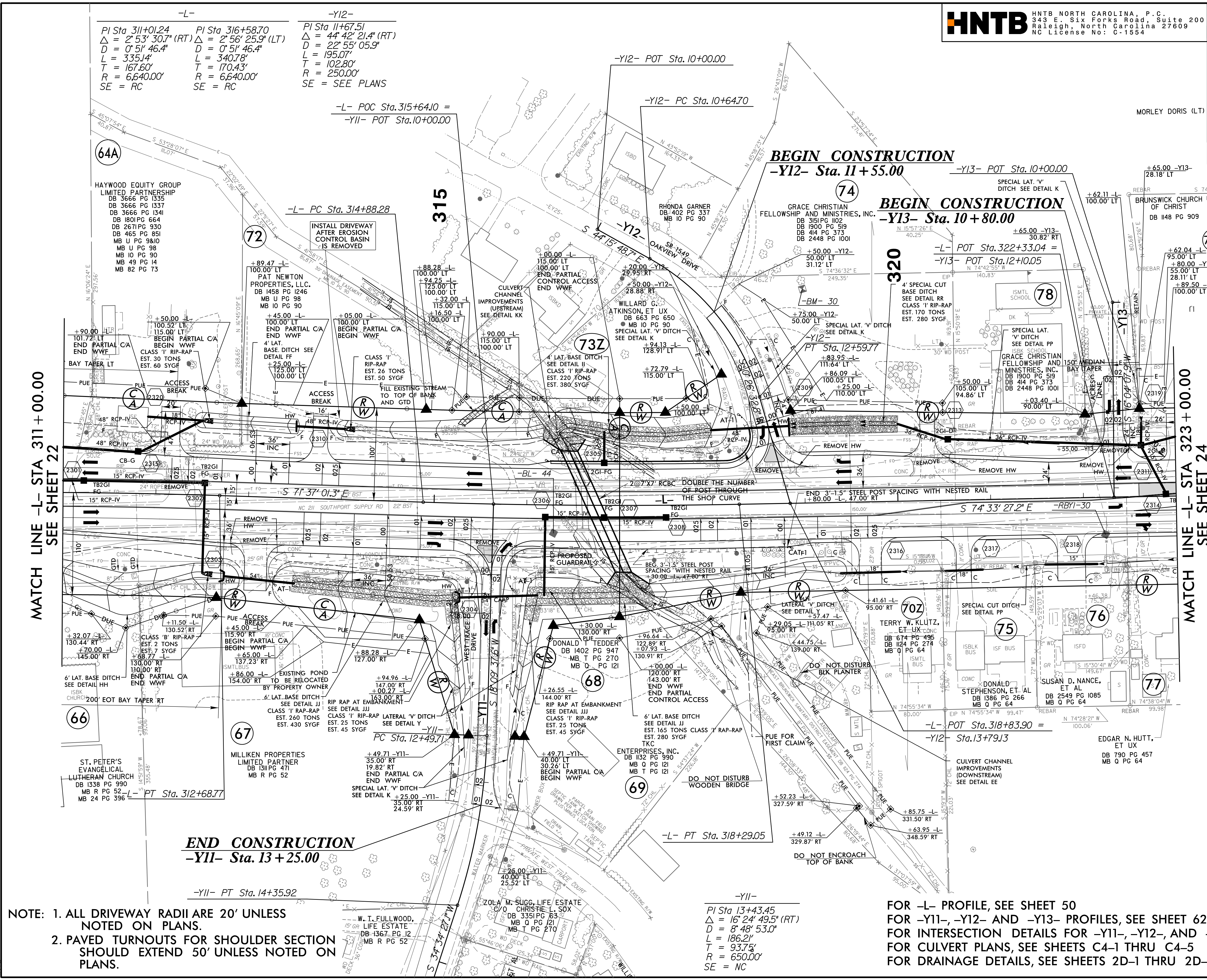

MATCH LINE -L- STA 311 + 00.00
SEE SHEET 22

MATCH LINE -L- STA 323 + 00.00
SEE SHEET 24

-L-	-Y12-
PI Sta 311+01.24 Δ = 2° 53' 30.7" (RT) D = 0° 51' 46.4" L = 335.14' T = 167.60' R = 6,640.00' SE = RC	PI Sta 11+67.51 Δ = 44° 42' 21.4" (RT) D = 22° 55' 05.9" L = 195.07' T = 102.80' R = 250.00' SE = SEE PLANS

-L- POC Sta.315+64.10 =
-Y11- POT Sta.10+00.00

-Y12- POT Sta.10+00.00

-Y12- PC Sta.10+64.70

BEGIN CONSTRUCTION
-Y12- Sta. 11 + 55.00

BEGIN CONSTRUCTION
-Y13- Sta. 10 + 80.00

END CONSTRUCTION
-Y11- Sta. 13 + 25.00

-Y11- PT Sta.14+35.92

-L- PT Sta. 318+29.05

-Y11-

PI Sta 13+43.45
Δ = 16° 24' 49.5" (RT)
D = 8° 48' 53.0"
L = 186.21'
T = 93.73'
R = 650.00'
SE = NC

FOR -L- PROFILE, SEE SHEET 50
FOR -Y11-, -Y12- AND -Y13- PROFILES, SEE SHEET 62
FOR INTERSECTION DETAILS FOR -Y11-, -Y12-, AND -Y13-, SEE SHEET 2B-3
FOR CULVERT PLANS, SEE SHEETS C4-1 THRU C4-5
FOR DRAINAGE DETAILS, SEE SHEETS 2D-1 THRU 2D-3

NOTE: 1. ALL DRIVEWAY RADII ARE 20' UNLESS NOTED ON PLANS.
2. PAVED TURNOUTS FOR SHOULDER SECTION SHOULD EXTEND 50' UNLESS NOTED ON PLANS.

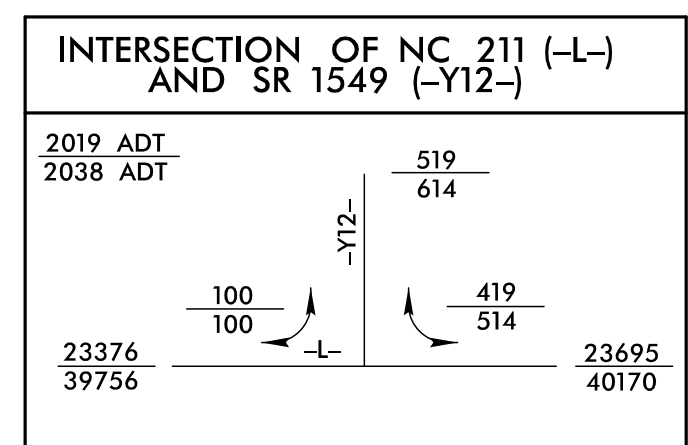
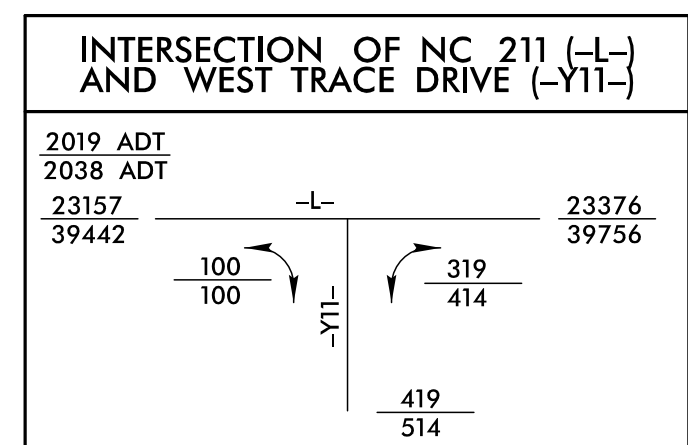

02-NOV-2021 14:09
\\regway\p\co\NR-5021.LRD\PSH23.dgn