

5/14/2021

PROJECT REFERENCE NO. <b>R-5021</b>		SHEET NO. <b>18</b>	
RW SHEET NO.			
ROADWAY DESIGN ENGINEER		HYDRAULICS ENGINEER	
<b>DOCUMENT NOT CONSIDERED FINAL UNLESS ALL SIGNATURES COMPLETED</b>			

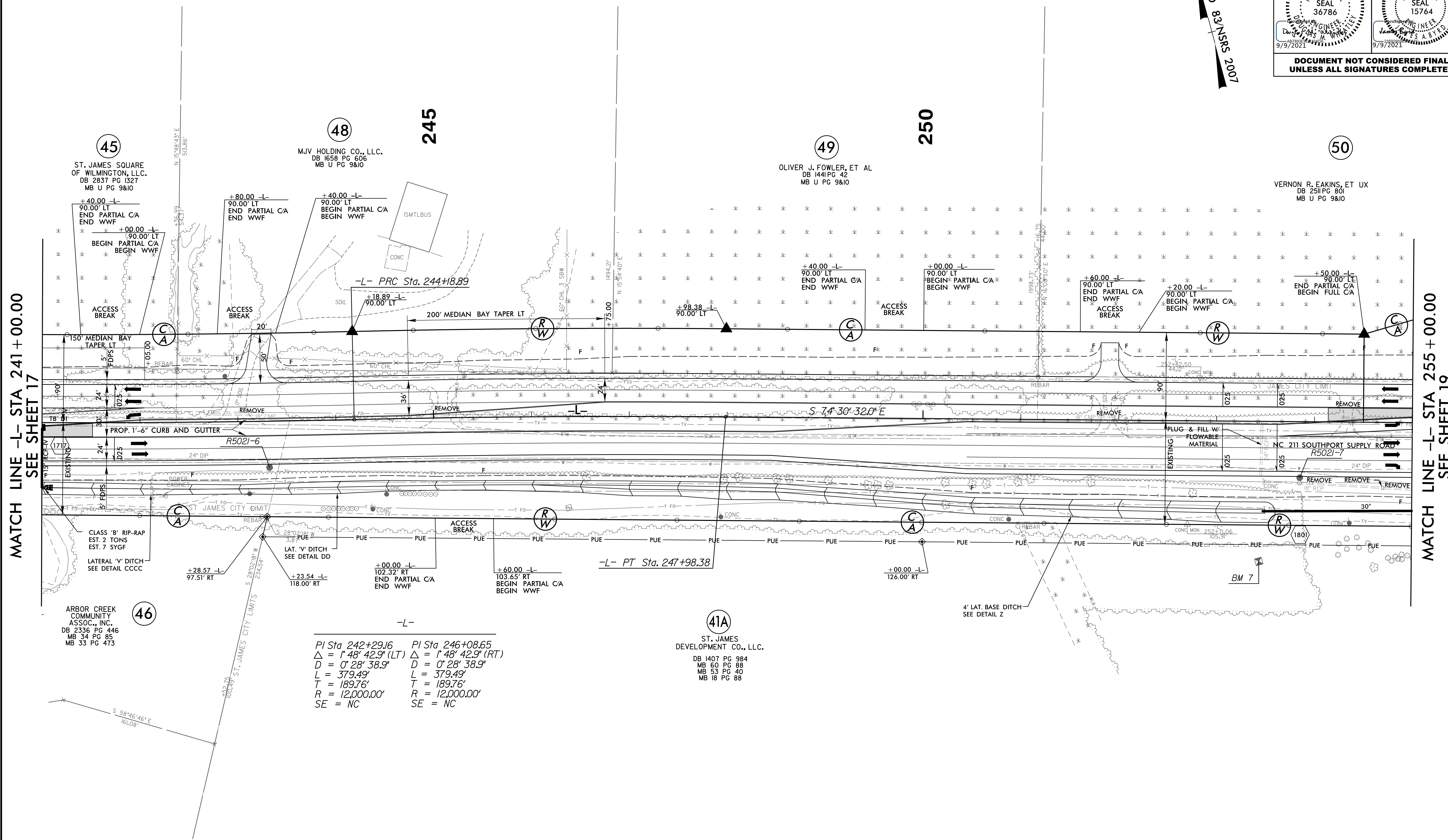
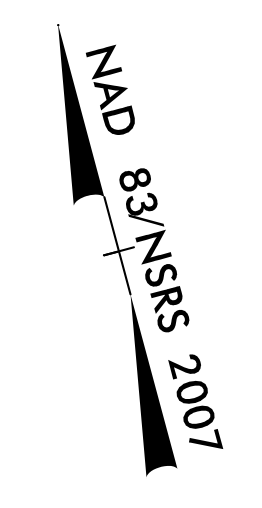

MATCH LINE -L- STA 241+00.00  
SEE SHEET 17

MATCH LINE -L- STA 255+00.00  
SEE SHEET 19

**45**  
ST. JAMES SQUARE  
OF WILMINGTON, LLC.  
DB 2837 PG 1327  
MB U PG 9810

**48**  
MJV HOLDING CO., LLC.  
DB 1658 PG 606  
MB U PG 9810

**49**  
OLIVER J. FOWLER, ET AL  
DB 1441 PG 42  
MB U PG 9810

**50**  
VERNON R. EAKINS, ET UX  
DB 2511 PG 801  
MB U PG 9810

**46**  
ARBOR CREEK  
COMMUNITY  
ASSOC., INC.  
DB 2336 PG 446  
MB 34 PG 85  
MB 33 PG 473

**-L-**

PI Sta 242+29.16	PI Sta 246+08.65
$\Delta = 1' 48' 42.9''$ (LT)	$\Delta = 1' 48' 42.9''$ (RT)
$D = 0' 28' 38.9''$	$D = 0' 28' 38.9''$
$L = 379.49'$	$L = 379.49'$
$T = 189.76'$	$T = 189.76'$
$R = 12,000.00'$	$R = 12,000.00'$
SE = NC	SE = NC

**41A**  
ST. JAMES  
DEVELOPMENT CO., LLC.  
DB 1407 PG 984  
MB 60 PG 88  
MB 53 PG 40  
MB 18 PG 88

**NOTE:**

1. ALL DRIVEWAY RADII ARE 20' UNLESS NOTED ON PLANS.
2. PAVED TURNOUTS FOR SHOULDER SECTION SHOULD EXTEND 50' UNLESS NOTED ON PLANS.

FOR -L- PROFILE, SEE SHEET 48  
FOR DETAIL FOR DIRECTIONAL CROSS OVER, SEE SHEET 2B-2  
FOR DRAINAGE DETAILS, SEE SHEETS 2D-1 THRU 2D-3

22-JUL-2021 09:56  
\\Roadway\Projects\NR-5021-RD\PSH18.dgn