

5/14/2019

PROJECT REFERENCE NO. R-5021	SHEET NO. 17
RW SHEET NO.	
ROADWAY DESIGN ENGINEER	HYDRAULICS ENGINEER

**DOCUMENT NOT CONSIDERED FINAL
UNLESS ALL SIGNATURES COMPLETED**

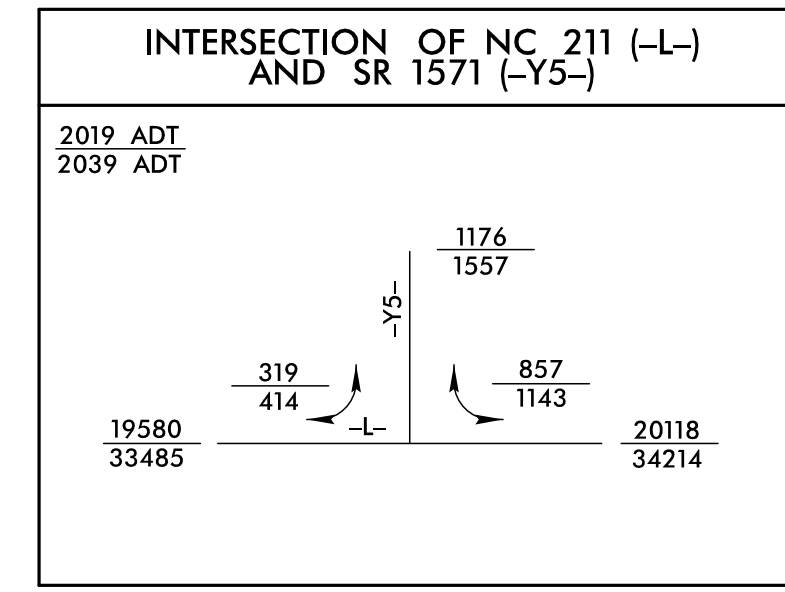

MATCH LINE -L- STA 227+00.00
SEE SHEET 16

MATCH LINE -L- STA 241+00.00
SEE SHEET 18

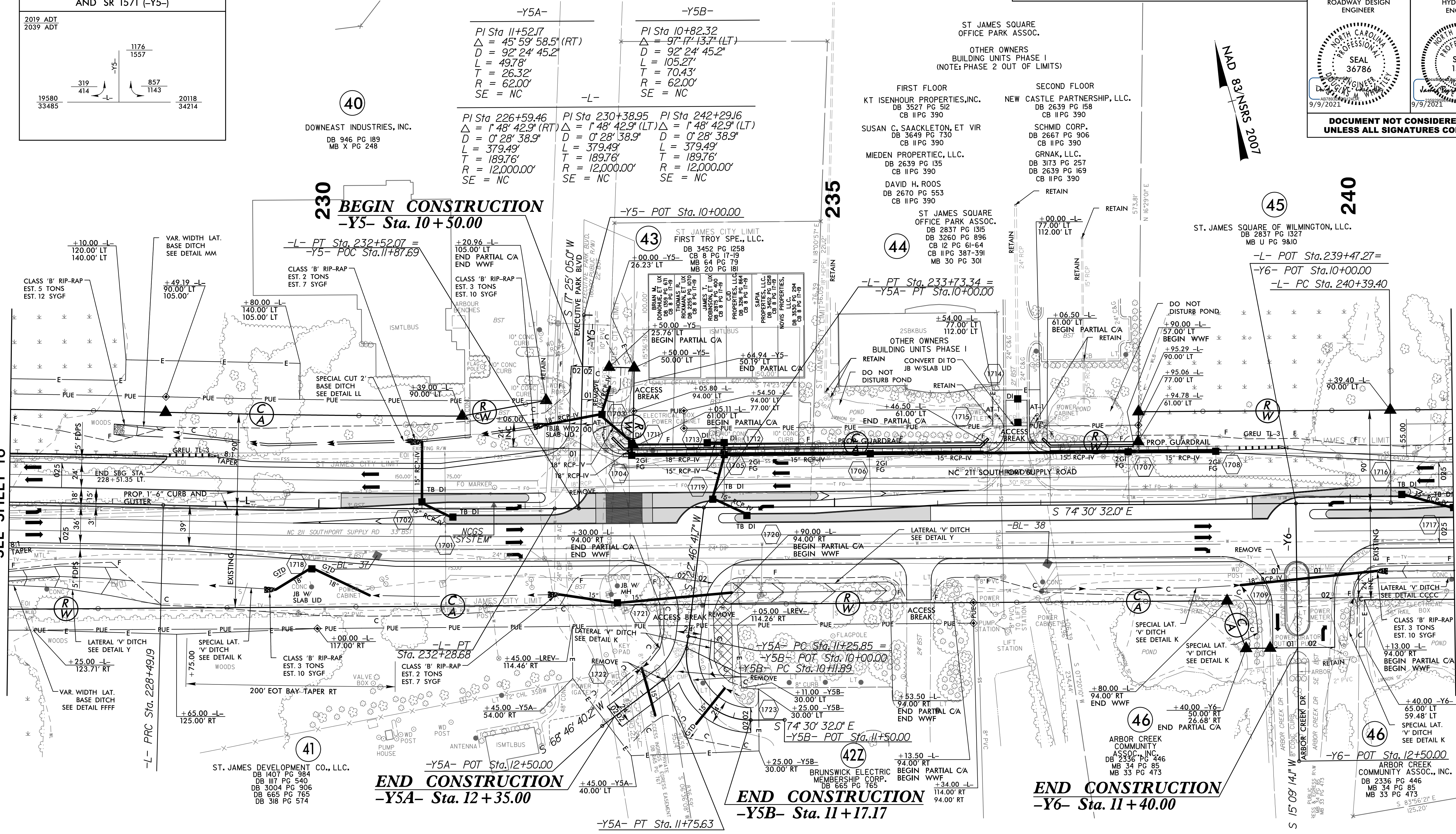

NOTE:

1. ALL DRIVEWAY RADII ARE 20' UNLESS NOTED ON PLANS.
2. PAVED TURNOUTS FOR SHOULDER SECTION SHOULD EXTEND 50' UNLESS NOTED ON PLANS.

- FOR -L- PROFILE, SEE SHEET 47
- FOR -Y5- & -Y6- PROFILES, SEE SHEET 61
- FOR -Y5A- PROFILE, SEE SHEET 61
- FOR -Y5B- PROFILE, SEE SHEET 61
- FOR -Y5- & -Y6- INTERSECTION DETAILS, SEE SHEET 2B-2
- FOR DRAINAGE DETAILS, SEE SHEETS 2D-1 THRU 2D-3
- FOR RETAINING WALL PLANS, SEE SHEETS W-1 THRU W-2

22-JUL-2021 09:56
Roadway\Projects\NR-5021.LRDY_PSH17.dgn