

| | |
|--|------------------------|
| PROJECT REFERENCE NO. R-5021 | SHEET NO. 16 |
| RW SHEET NO. | |
| ROADWAY DESIGN ENGINEER | HYDRAULICS ENGINEER |
| | |
| DOCUMENT NOT CONSIDERED FINAL UNLESS ALL SIGNATURES COMPLETED | |

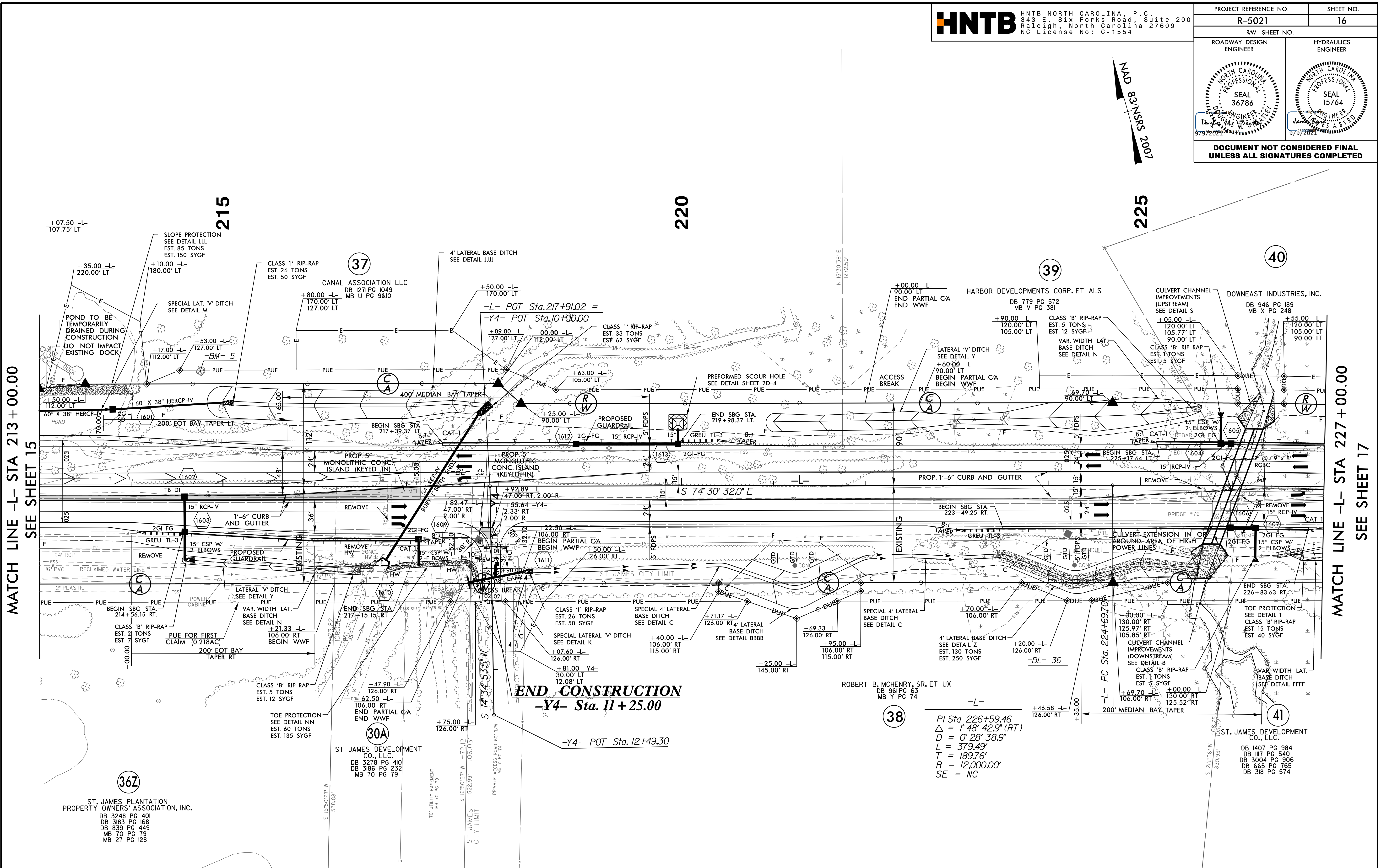

NOTE:

1. ALL DRIVEWAY RADII ARE 20' UNLESS NOTED ON PLANS.
2. PAVED TURNOUTS FOR SHOULDER SECTION SHOULD EXTEND 50' UNLESS NOTED ON PLANS.

- FOR -L- PROFILE, SEE SHEET 47
- FOR -Y4- PROFILE, SEE SHEET 60
- FOR INTERSECTION DETAIL, SEE SHEET 2B-1
- FOR DRAINAGE DETAILS, SEE SHEETS 2D-1 THRU 2D-3
- FOR CULVERT DETAILS, SEE SHEETS C3-1 THRU C3-5