

5/14/2021

PROJECT REFERENCE NO. R-5021	SHEET NO. 13
RW SHEET NO.	
ROADWAY DESIGN ENGINEER	HYDRAULICS ENGINEER
DOCUMENT NOT CONSIDERED FINAL UNLESS ALL SIGNATURES COMPLETED	

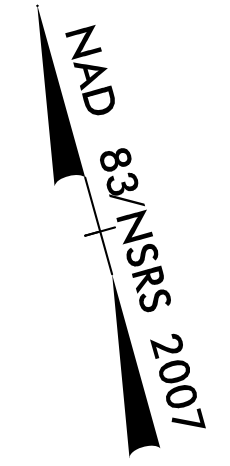

MATCH LINE -L- STA 171 + 00.00
SEE SHEET 12

MATCH LINE -L- STA 185 + 00.00
SEE SHEET 14

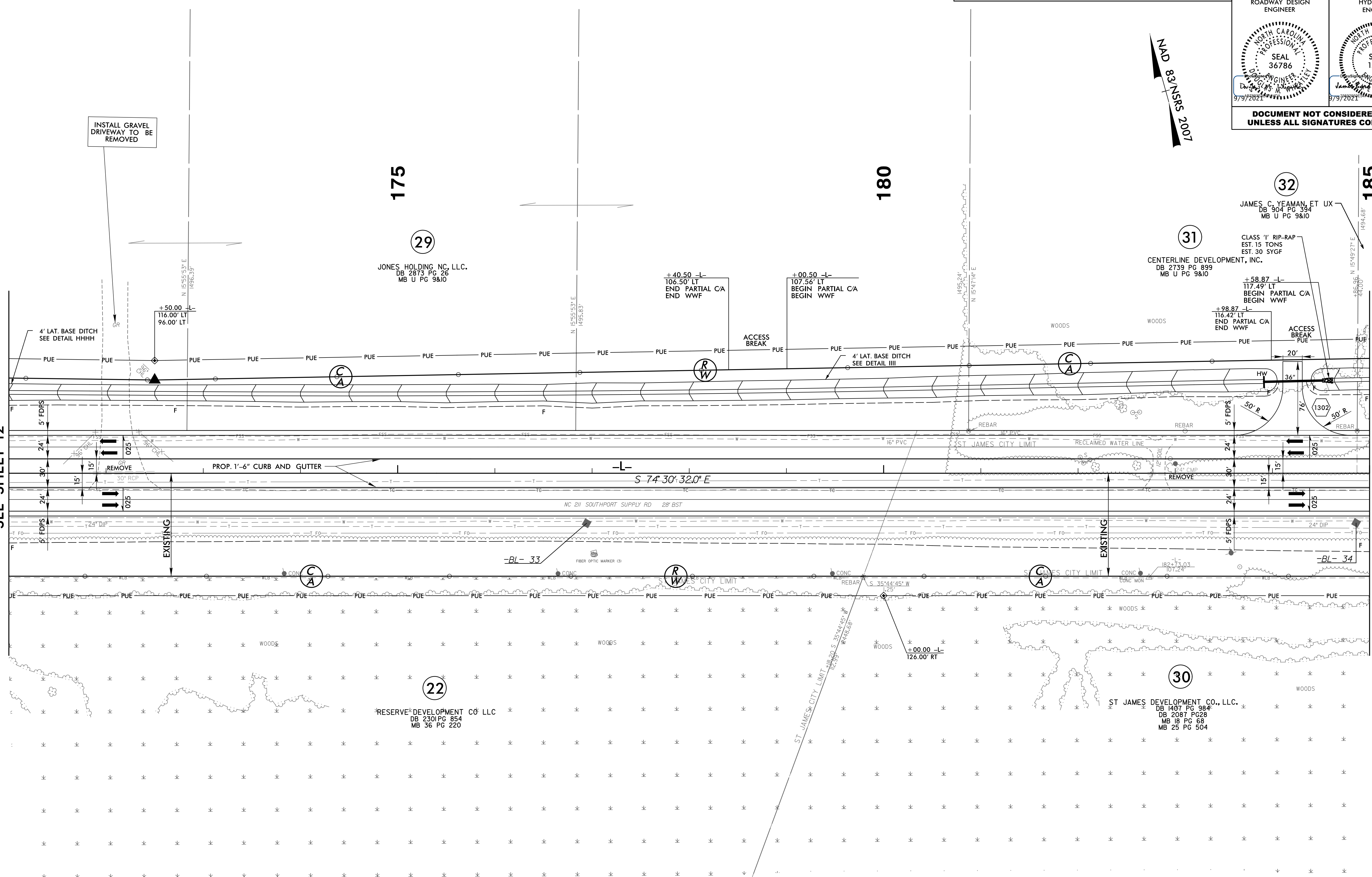

- NOTE:**
1. ALL DRIVEWAY RADII ARE 20' UNLESS NOTED ON PLANS.
 2. PAVED TURNOUTS FOR SHOULDER SECTION SHOULD EXTEND 50' UNLESS NOTED ON PLANS.

FOR -L- PROFILE, SEE SHEET 45
 FOR DRAINAGE DETAILS, SEE SHEETS 2D-1 THRU 2D-3

22-JUL-2021 09:56
 R:\Roadway\Projects\NR-5021\RD\PSH13.dgn
 JML