

5/14/99

| | | | |
|--|---------------------|-----------|--|
| PROJECT REFERENCE NO. | | SHEET NO. | |
| R-5021 | | 4 | |
| RW SHEET NO. | | | |
| ROADWAY DESIGN ENGINEER | HYDRAULICS ENGINEER | | |
| | | | |
| DOCUMENT NOT CONSIDERED FINAL UNLESS ALL SIGNATURES COMPLETED | | | |

NAD 83/NSRS 2007

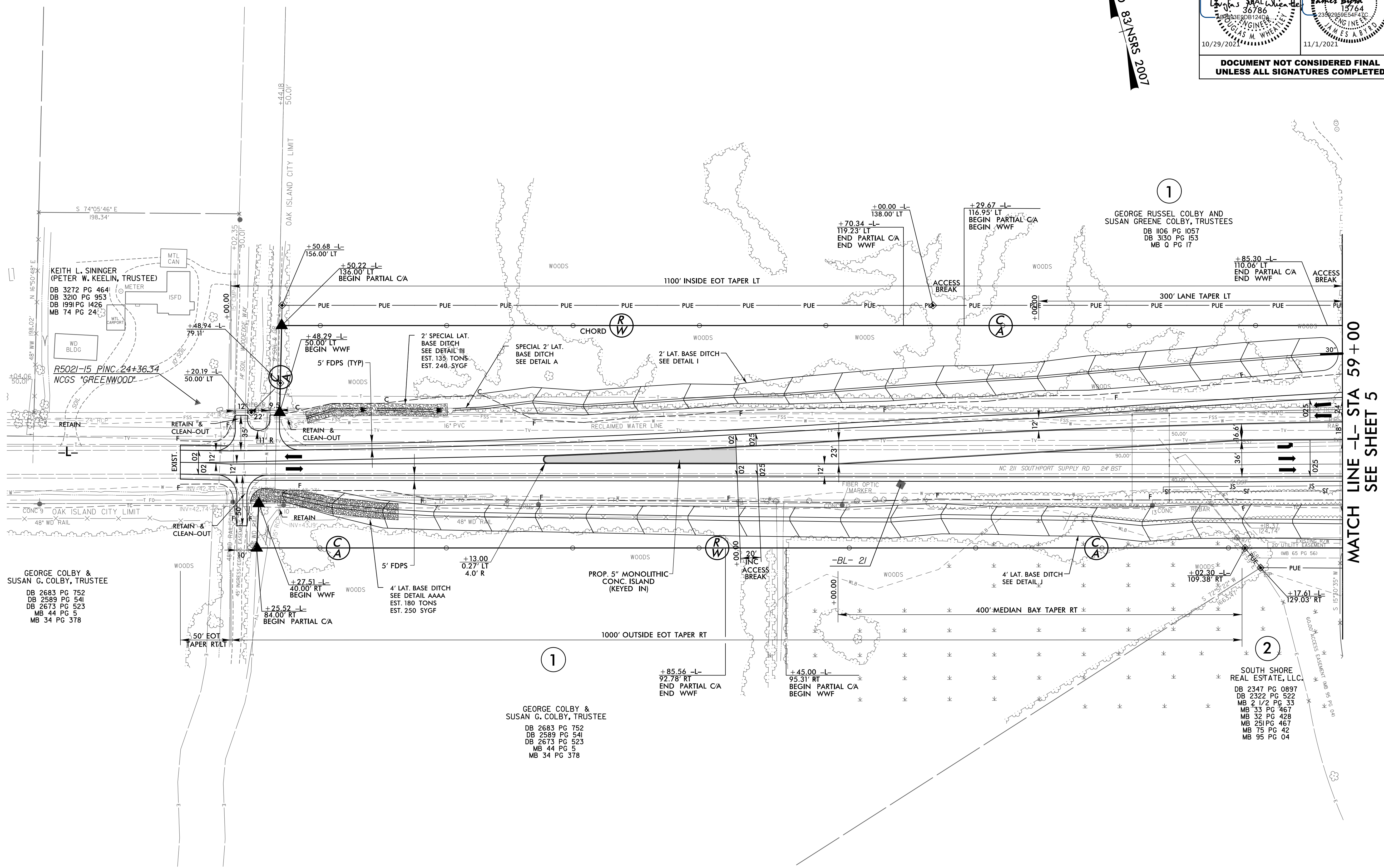

GEORGE COLBY &
SUSAN G. COLBY, TRUSTEE
DB 2683 PG 752
DB 2589 PG 541
DB 2673 PG 523
MB 44 PG 5
MB 34 PG 378

GEORGE COLBY &
SUSAN G. COLBY, TRUSTEE
DB 2683 PG 752
DB 2589 PG 541
DB 2673 PG 523
MB 44 PG 5
MB 34 PG 378

SOUTH SHORE
REAL ESTATE, L.L.C.
DB 2347 PG 0897
DB 2322 PG 522
MB 2 1/2 PG 33
MB 33 PG 467
MB 32 PG 428
MB 251 PG 467
MB 75 PG 42
MB 95 PG 04

MATCH LINE -L- STA 59 + 00
SEE SHEET 5

NOTE:

1. ALL DRIVEWAY RADII ARE 20' UNLESS NOTED ON PLANS.
2. PAVED TURNOUTS FOR SHOULDER SECTION SHOULD EXTEND 50' UNLESS NOTED ON PLANS.

FOR -L- PROFILE, SEE SHEET 41
FOR DRAINAGE DETAILS, SEE SHEETS 2D-1 THRU 2D-3

30-SEP-2021 09:18
R-5021_RDY_PSH4.dgn