

5/14/2007

INTERSECTION DETAIL AND DIRECTIONAL CROSSOVER INTO MDI MANAGEMENT, INC -L- STA 66+00.00

HNTB HNTB NORTH CAROLINA, P.C.
343 E. Six Forks Road, Suite 200
Raleigh, North Carolina 27609
NC License No: C-1554

PROJECT REFERENCE NO. R-5021	SHEET NO. 2B-1
RW SHEET NO.	
ROADWAY DESIGN ENGINEER	
<p>DOCUMENT NOT CONSIDERED FINAL UNLESS ALL SIGNATURES COMPLETED</p>	

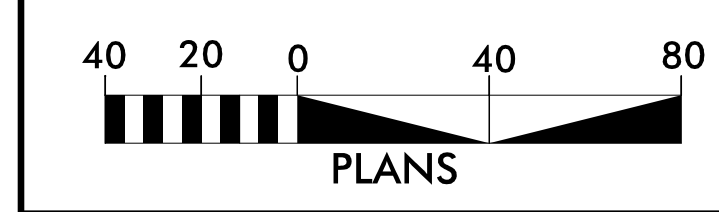
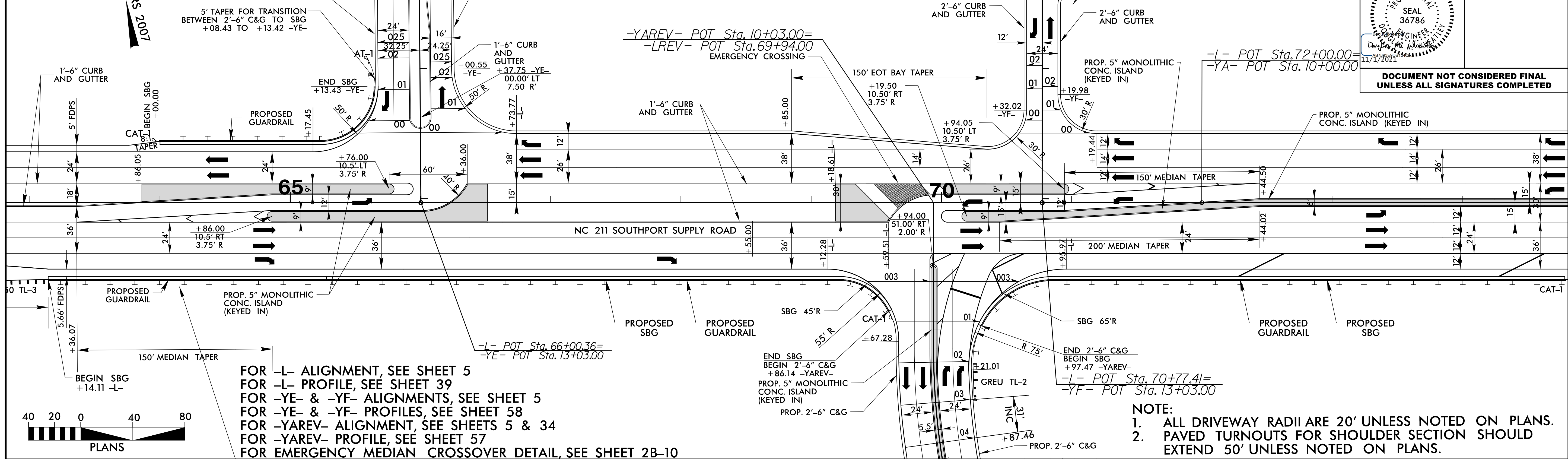

FOR -L- ALIGNMENT, SEE SHEET 5
 FOR -L- PROFILE, SEE SHEET 39
 FOR -YE- & -YF- ALIGNMENTS, SEE SHEET 5
 FOR -YE- & -YF- PROFILES, SEE SHEET 58
 FOR -YAREV- ALIGNMENT, SEE SHEETS 5 & 34
 FOR -YAREV- PROFILE, SEE SHEET 57
 FOR EMERGENCY MEDIAN CROSSOVER DETAIL, SEE SHEET 2B-10

NOTE:
 1. ALL DRIVEWAY RADII ARE 20' UNLESS NOTED ON PLANS.
 2. PAVED TURNOUTS FOR SHOULDER SECTION SHOULD EXTEND 50' UNLESS NOTED ON PLANS.

INTERSECTION DETAILS AT -L-, Y2A, -Y3- AND -Y4-

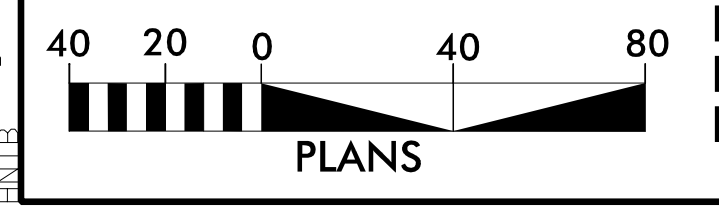
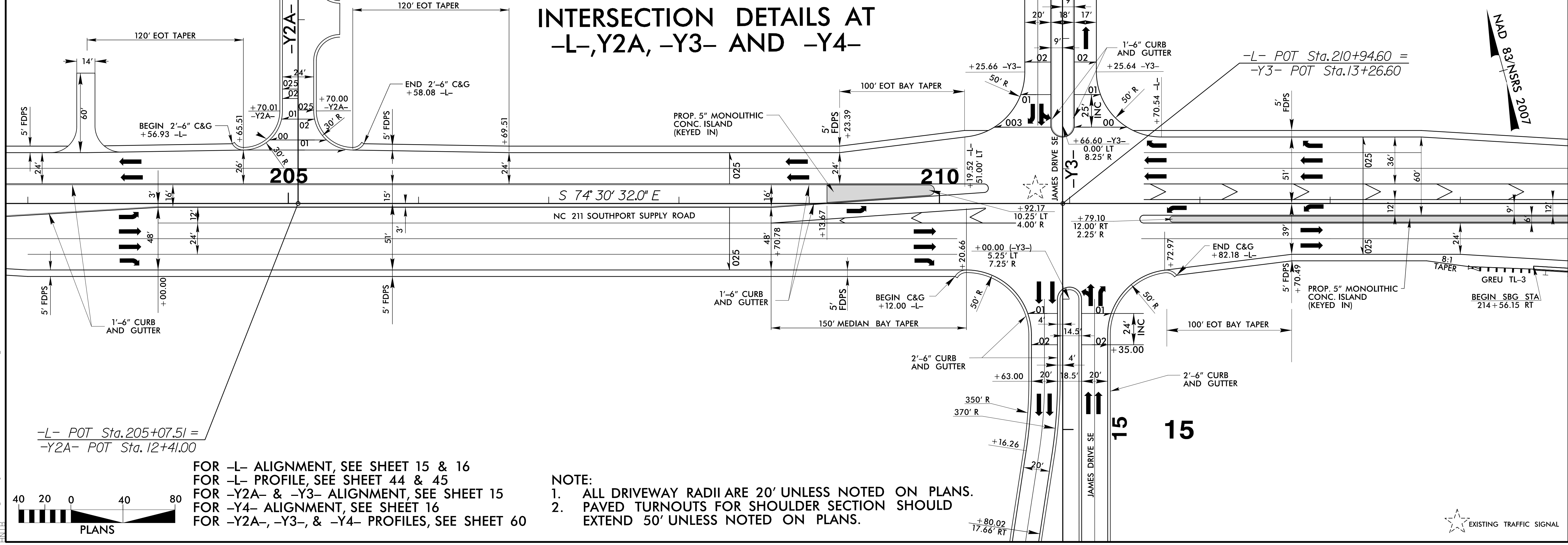

FOR -L- ALIGNMENT, SEE SHEET 15 & 16
 FOR -L- PROFILE, SEE SHEET 44 & 45
 FOR -Y2A- & -Y3- ALIGNMENT, SEE SHEET 15
 FOR -Y4- ALIGNMENT, SEE SHEET 16
 FOR -Y2A-, -Y3-, & -Y4- PROFILES, SEE SHEET 60

NOTE:
 1. ALL DRIVEWAY RADII ARE 20' UNLESS NOTED ON PLANS.
 2. PAVED TURNOUTS FOR SHOULDER SECTION SHOULD EXTEND 50' UNLESS NOTED ON PLANS.



29-SEP-2009 09:38 R-5021_RDY_DETAIL_2B-1.dgn