

**END BENT DIAPHRAGM D4-STAGE III**

(2 TOTAL)

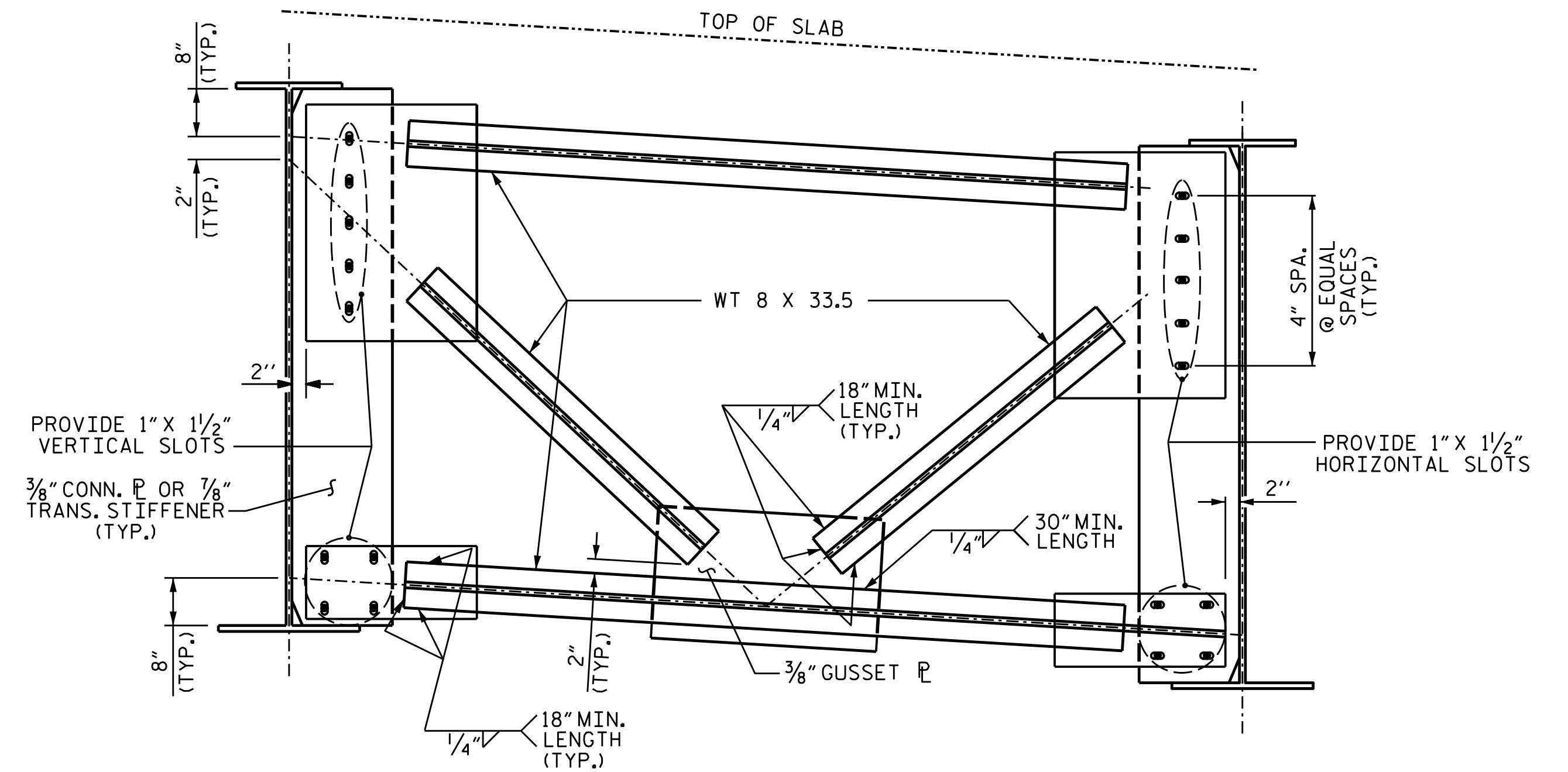

**TYPICAL INTERMEDIATE DIAPHRAGM D5-STAGE III**

(17 TOTAL)

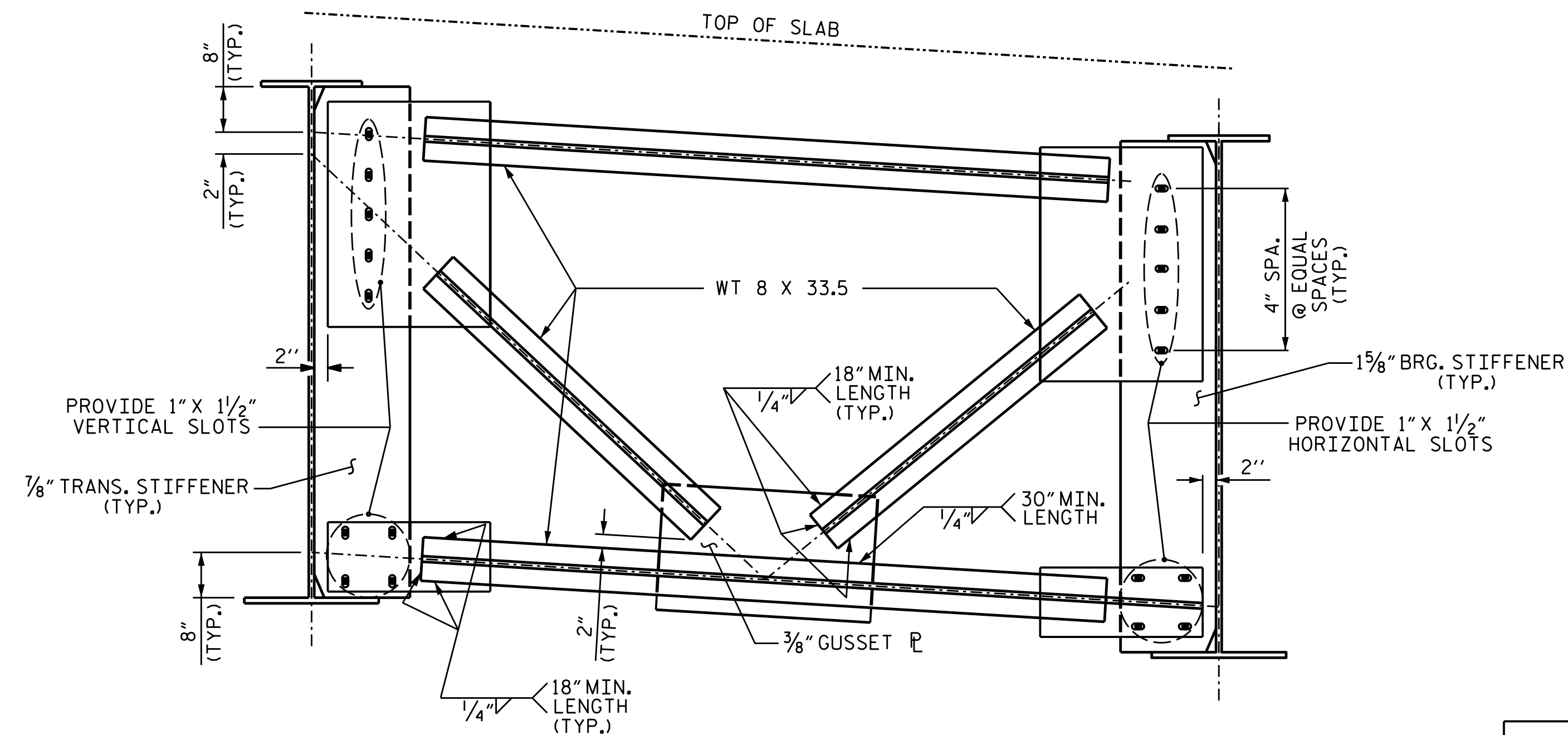

**TYPICAL BENT DIAPHRAGM D6-STAGE III**

(1 REQ'D)

WATAUGA R-2566BA  
 WATAUGA COUNTY  
 STATION: 164+30.00 -L-

SHEET 3 OF 10



STATE OF NORTH CAROLINA  
 DEPARTMENT OF TRANSPORTATION  
 RALEIGH

SUPERSTRUCTURE  
 STRUCTURAL STEEL  
 DETAILS

DRAWN BY : S. B. WILLIAMS DATE : 4-19  
 CHECKED BY : MGC DATE : 6-19  
 DESIGN ENGINEER OF RECORD: RDE DATE : 9-21

9/23/2021  
 X:\NCDOT\R-2566BA\Structures\Final plans\DCN files\401.039.R-2566BA.SMU. SS03.S19.940005.dgn  
 Users\sbwilliams

DOCUMENT NOT CONSIDERED FINAL  
 UNLESS ALL SIGNATURES COMPLETED  
 TGS ENGINEERS  
 706 HILLSBOROUGH STREET  
 SUITE 200  
 RALEIGH, NC 27603  
 PH (919) 773-8887  
 CORP. LICENSE NO.: C-0275

REVISIONS						SHEET NO.
NO.	BY:	DATE:	NO.	BY:	DATE:	S-19
1			3			TOTAL SHEETS
2			4			79