

**Project: R-2566BA**

STATE OF NORTH CAROLINA  
DIVISION OF HIGHWAYS

**WATAUGA COUNTY**

LOCATION: NC 105 AT SR 1112 (BROADSTONE RD.) IN BOONE

TYPE OF WORK: TRAFFIC SIGNALS

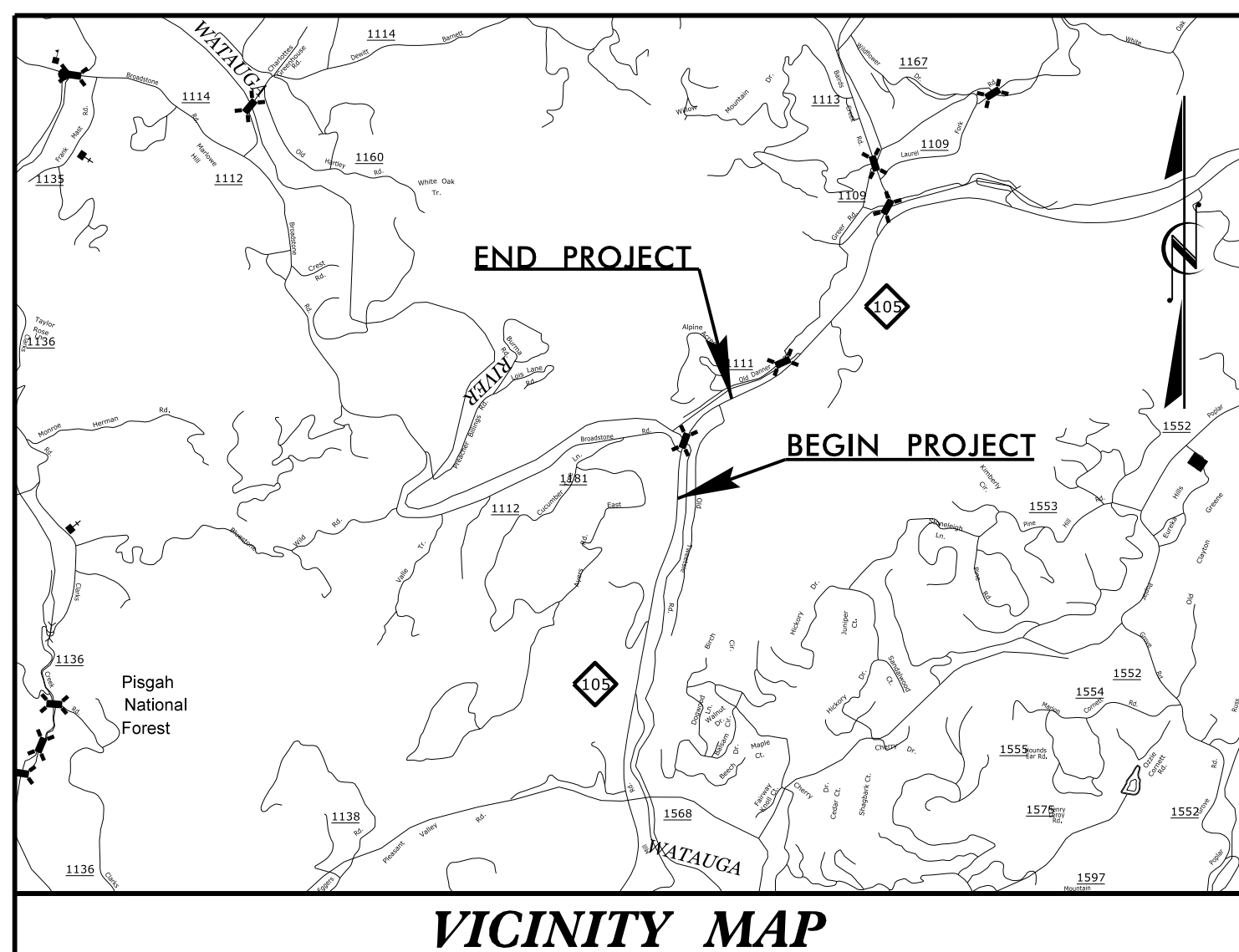

VICINITY MAP

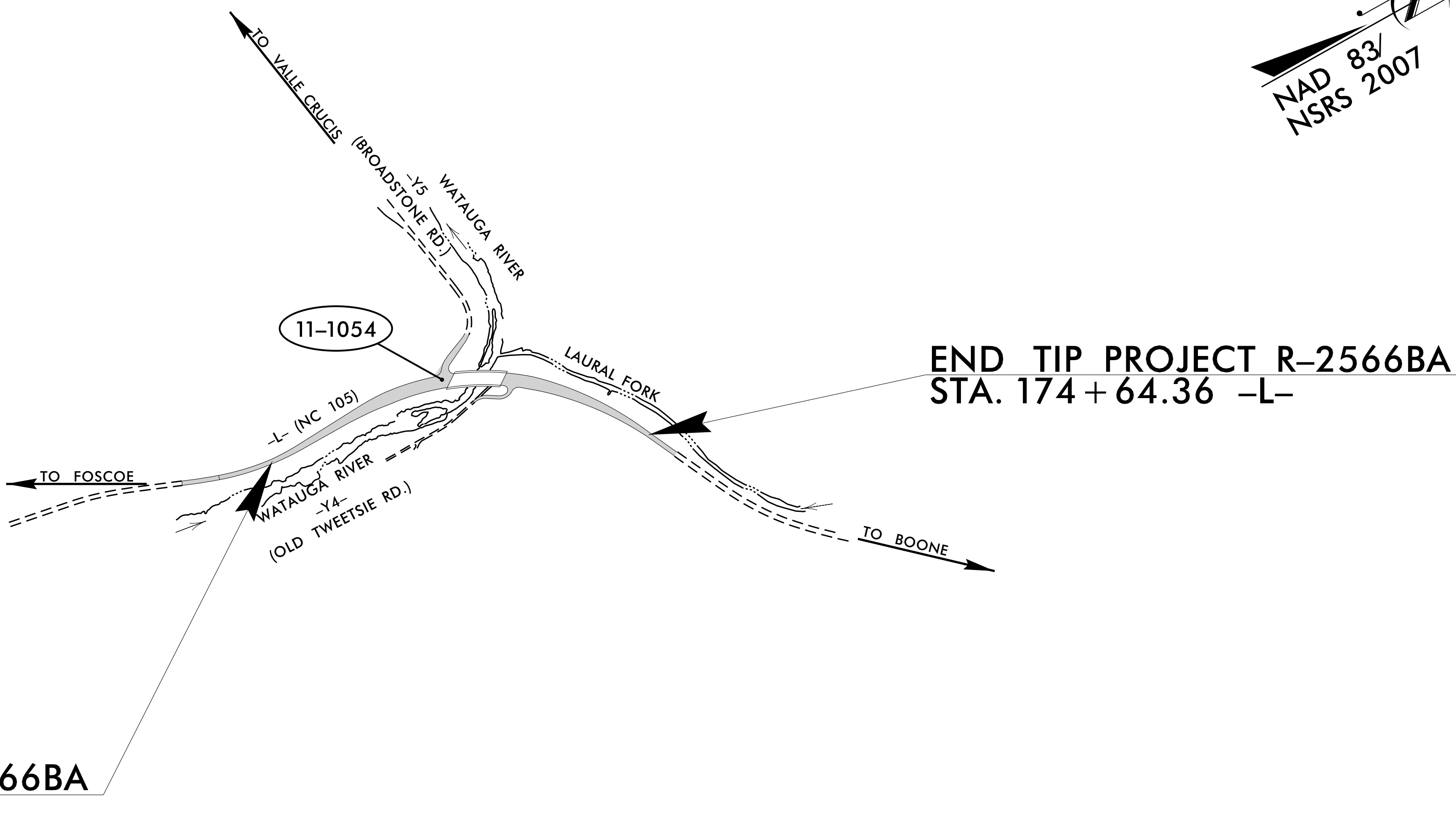
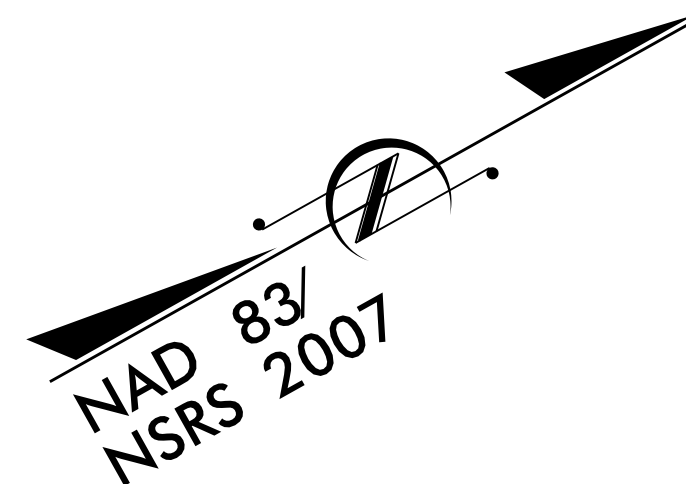

BEGIN TIP PROJECT R-2566BA  
STA. 151+99.39 -L-

END TIP PROJECT R-2566BA  
STA. 174+64.36 -L-

Refer to "Roadway Standard Drawings  
NCDOT" dated January 2018 and  
"Standard Specifications for Roads  
and Structures" dated January 2018.

**Index of Plans**

Sheet #	Reference #	Location/Description
Sig. 1.0	-----	Title Sheet
Sig. 2.0-7.1	11-1054	NC 105 at SR 1112 (Broadstone Rd.)
Sig. 8.0	-----	Revised Standard Drawings
Sig. M1-M8	-----	Metal Pole Standard Drawings

**INTELLIGENT TRANSPORTATION AND SIGNALS UNIT**

Contacts:

Timothy J. Williams, PE - Western Region Signals Engineer  
Keith Mims, PE - Signal Equipment Design Engineer  
Neil Avery - Intelligent Transportation Systems Engineer

Prepared in the Office of:  
DIVISION OF HIGHWAYS  
TRANSPORTATION MOBILITY AND SAFETY  
DIVISION

