

NAD 83/2007

For Slopes Excavated Greater Than 10 feet
Install Matting for Erosion Control on
Entire Slope as Work Allows.

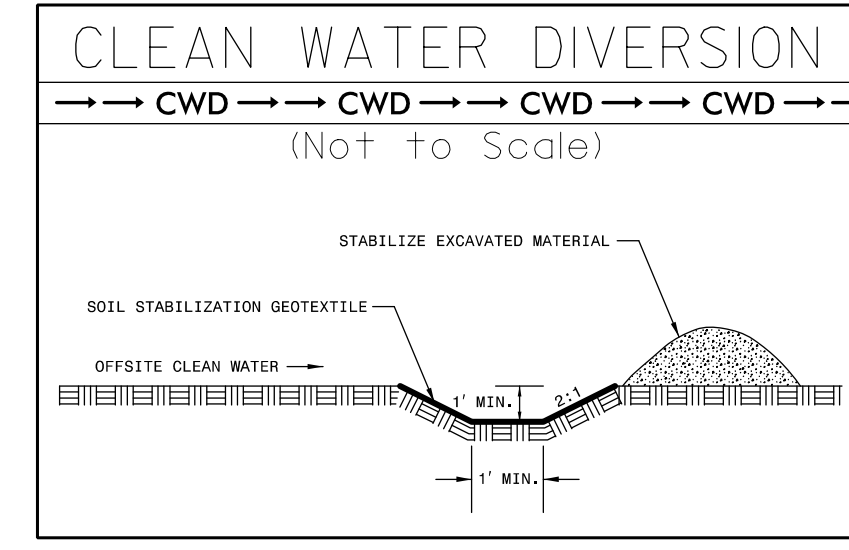

INSTALL MATTING IN THE
PROPOSED DITCH LINE
-L- STA 152+50 TO 162+00 LT
EST. 845 SY

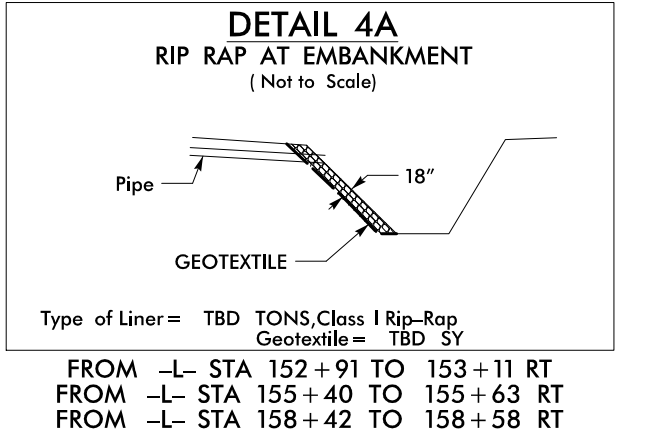
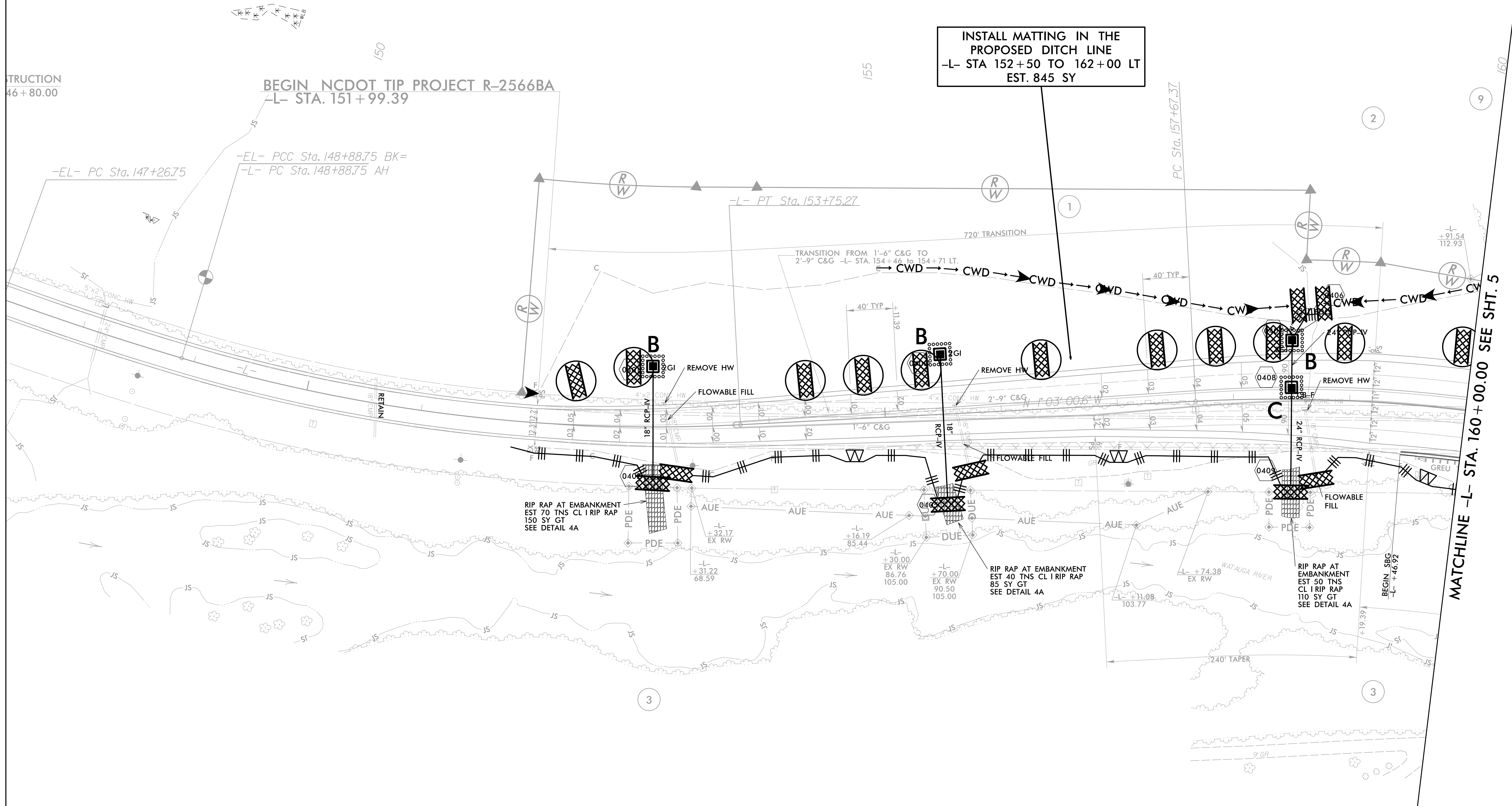

-EL-	-L-	-L-
PI Sta 148+07.77	PI Sta 151+34.38	PI Sta 163+46.06
$\Delta = 3^{\circ} 23' 59.8''$ (LT)	$\Delta = 19^{\circ} 29' 36.7''$ (LT)	$\Delta = 46^{\circ} 24' 19.4''$ (RT)
D = 2' 05' 55.5"	D = 4' 00' 24.1"	D = 4' 14' 38.9"
L = 162.00'	L = 486.52'	L = 1,093.40'
T = 81.02'	T = 245.64'	T = 578.69'
R = 2,730.00'	R = 1,430.00'	R = 1,350.00'
SE = EXIST.	SE = 0.06 FT/FT	SE = 0.06 FT/FT
RO = EXIST.	RO = SEE PLANS	RO = SEE PLANS