

**CONTRACT: C204355 PROJECT: R-2566BA**

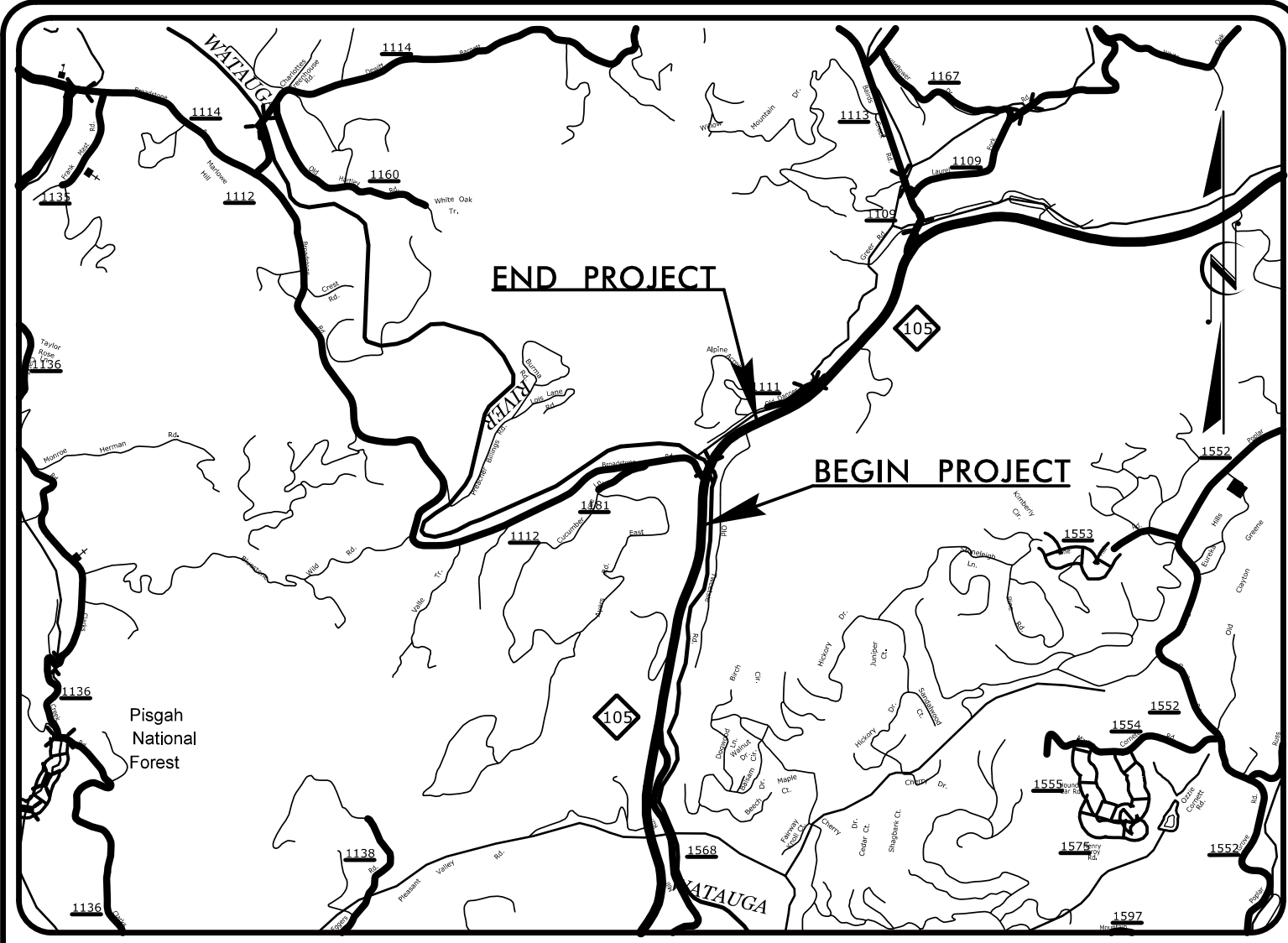

**VICINITY MAP**  
NOT TO SCALE

STATE OF NORTH CAROLINA  
DIVISION OF HIGHWAYS  
**PLAN FOR PROPOSED  
HIGHWAY EROSION CONTROL**

**WATAUGA COUNTY**

**LOCATION: NC 105 - CONSTRUCT NEW BRIDGE OVER WATAUGA RIVER AND LEFT-TURN LANE AT SR 1112 (BROADSTONE RD.) WITHIN THE LIMITS OF R-2566B**

**TYPE OF WORK: DRAINAGE, GRADING, PAVING, SIGNAL AND STRUCTURE**

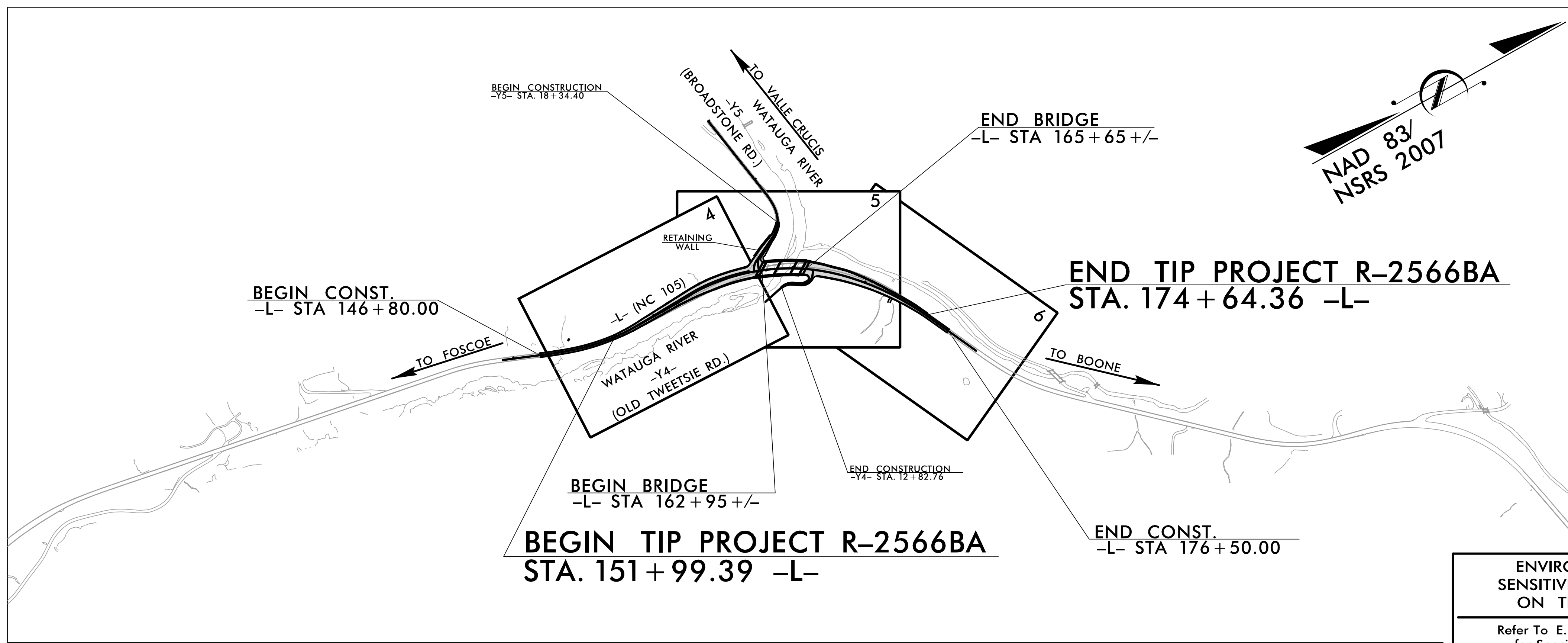

**EROSION AND SEDIMENT CONTROL MEASURES**

Std. #	Description	Symbol
1630.03	Temporary Silt Ditch	---
1630.05	Temporary Diversion	---
1605.01	Temporary Silt Fence	
1606.01	Special Sediment Control Fence	---X---
1622.01	Temporary Berms and Slope Drains	--->---
1630.02	Silt Basin Type B	---[ ]---
1633.01	Temporary Rock Silt Check Type-A	---[X]---
	Temporary Rock Silt Check Type-A with Matting and Polyacrylamide (PAM)	---[X]---
1633.02	Temporary Rock Silt Check Type-B	---[X]---
	Wattle/Coir Fiber Wattle	---[ ]---
	Wattle/Coir Fiber Wattle with Polyacrylamide (PAM)	---[ ]---
1634.01	Temporary Rock Sediment Dam Type-A	---[ ]---
1634.02	Temporary Rock Sediment Dam Type-B	---[ ]---
1635.01	Rock Pipe Inlet Sediment Trap Type-A	---[ ]---
1635.02	Rock Pipe Inlet Sediment Trap Type-B	---[ ]---
1630.04	Stilling Basin	---[ ]---
1630.06	Special Stilling Basin	---[ ]---
	Rock Inlet Sediment Trap:	
1632.01	Type A	---[ ]---
1632.02	Type B	---[ ]---
1632.03	Type C	---[ ]---
	Skimmer Basin	---[ ]---
	Tiered Skimmer Basin	---[ ]---
	Infiltration Basin	---[ ]---

THIS PROJECT CONTAINS  
EROSION CONTROL PLANS  
FOR CLEARING AND  
GRUBBING PHASE OF  
CONSTRUCTION.

THIS PROJECT HAS  
BEEN DESIGNED TO  
SENSITIVE WATERSHED  
STANDARDS.

**ENVIRONMENTALLY  
SENSITIVE AREA(S) EXIST  
ON THIS PROJECT**  
Refer To E. C. Special Provisions  
for Special Considerations.

HIGH QUALITY WATER(S) EXIST  
ON THIS PROJECT  
High Quality Water Zone(s) Exist  
From Sta. Begin  
to Sta. End  
Refer To E. C. Special Provisions  
for Special Considerations.

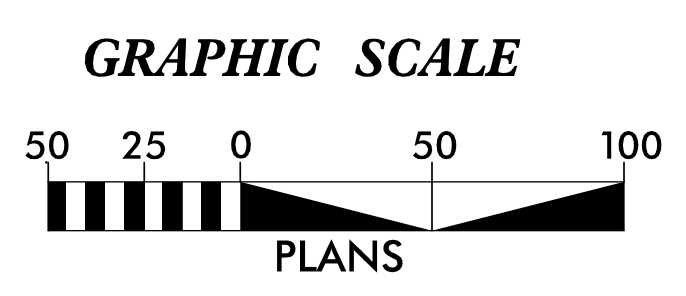

THESE EROSION AND SEDIMENT CONTROL PLANS COMPLY WITH  
THE APPLICABLE REGULATIONS SET FORTH BY THE NCG-010000  
GENERAL CONSTRUCTION PERMIT EFFECTIVE APRIL 1, 2019  
AND ISSUED BY THE NORTH CAROLINA DEPARTMENT OF  
ENVIRONMENTAL QUALITY DIVISION OF WATER RESOURCES.

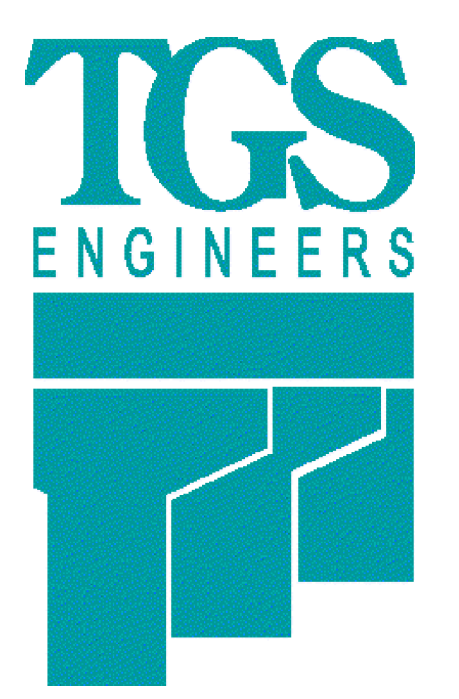

Prepared In the Office of:  
**TGS ENGINEERS**  
804-C N. LAFAYETTE ST.  
SHELBY, NC 28150

Designed by:  
**Andrew H. Cochrane, PE** 3015  
NAME LEVEL III CERTIFICATION NO.

Roadway Standard Drawings

The following roadway english standards as appear in "Roadway Standard Drawings"- Roadway Design Unit - N. C. Department of Transportation - Raleigh, N. C., dated January 2018 and the latest revision thereto are applicable to this project and by reference hereby are considered a part of these plans.

1604.01 Railroad Erosion Control Detail	1632.01 Rock Inlet Sediment Trap Type A
1605.01 Temporary Silt Fence	1632.02 Rock Inlet Sediment Trap Type B
1606.01 Special Sediment Control Fence	1632.03 Rock Inlet Sediment Trap Type C
1607.01 Gravel Construction Entrance	1633.01 Temporary Rock Silt Check Type A
1622.01 Temporary Berms and Slope Drains	1633.02 Temporary Rock Silt Check Type B
1630.01 Riser Basin	1634.01 Temporary Rock Sediment Dam Type A
1630.02 Silt Basin Type B	1634.02 Temporary Rock Sediment Dam Type B
1630.03 Temporary Silt Ditch	1635.01 Rock Pipe Inlet Sediment Trap Type A
1630.04 Stilling Basin	1635.02 Rock Pipe Inlet Sediment Trap Type B
1630.05 Temporary Diversion	1640.01 Coir Fiber Baffle
1630.06 Special Stilling Basin	1645.01 Temporary Stream Crossing
1631.01 Matting Installation	