

09/08/99

TIP PROJECT: R-2566BA

STATE OF NORTH CAROLINA
DIVISION OF HIGHWAYS

STATE	STATE PROJECT REFERENCE NO.	SHEET NO.	TOTAL SHEETS
N.C.	R-2566BA	RW01	6

SURVEY CONTROL, EXISTING CENTERLINES,
RIGHT OF WAY, EASEMENTS AND PROPERTY TIES

WATAUGA COUNTY

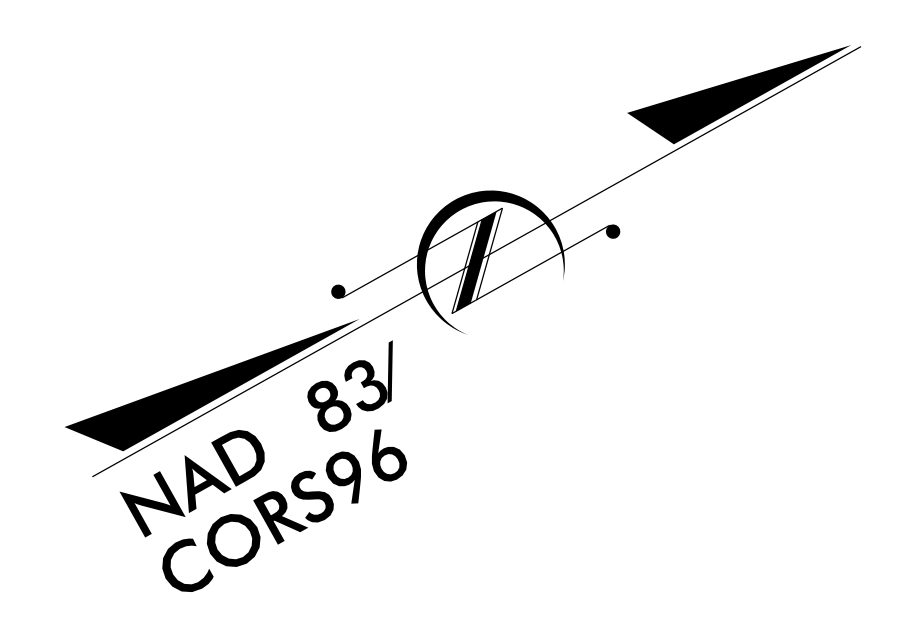
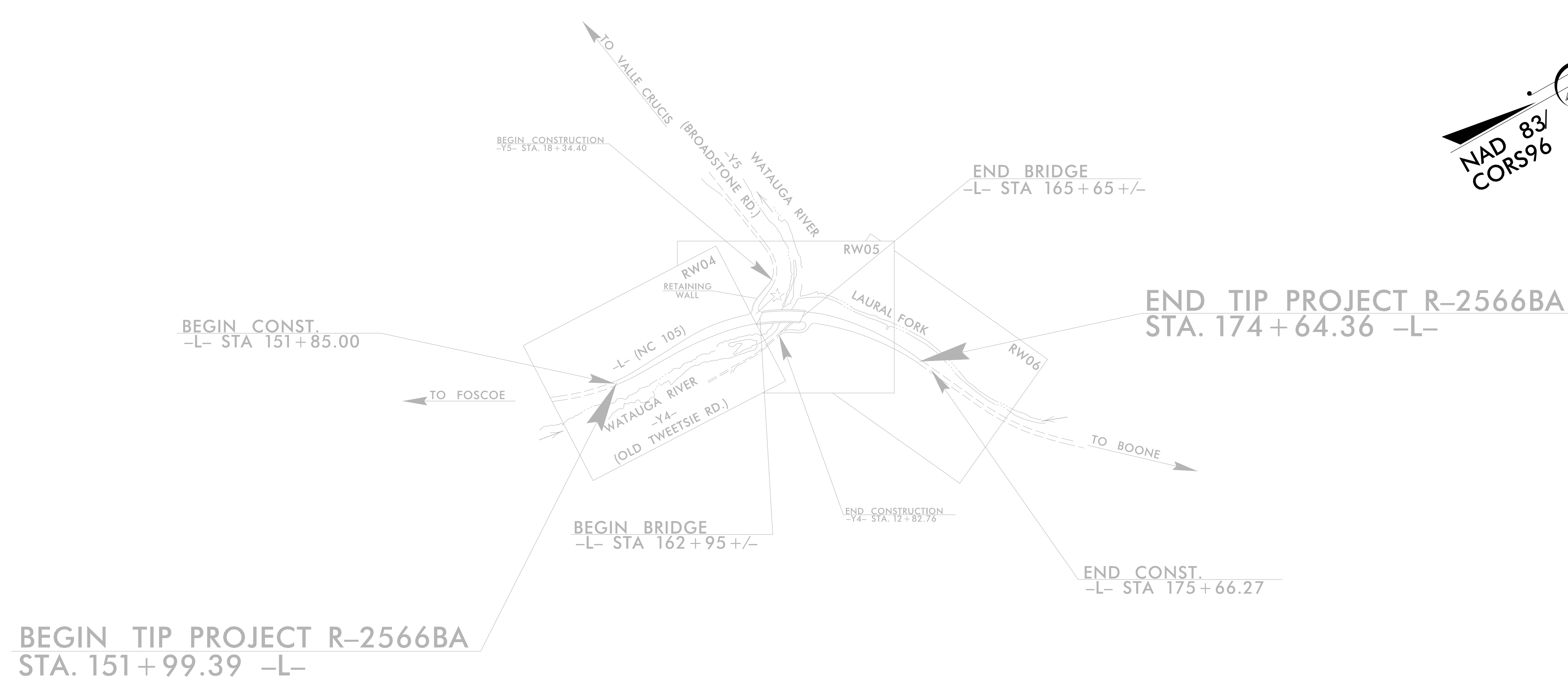

BEGIN TIP PROJECT R-2566BA
STA. 151+99.39 -L-

END TIP PROJECT R-2566BA
STA. 174+64.36 -L-

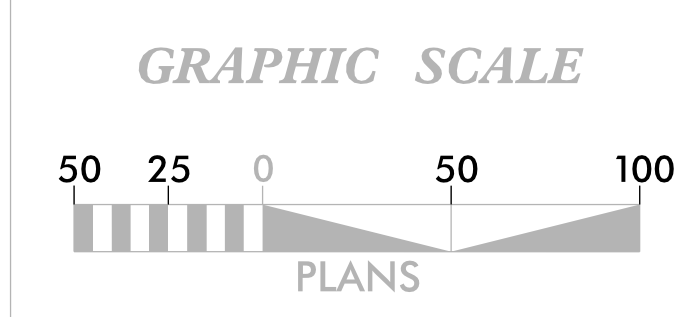

DATUM DESCRIPTION

THE LOCALIZED COORDINATE SYSTEM DEVELOPED FOR THIS PROJECT IS BASED ON THE STATE PLANE COORDINATES ESTABLISHED BY NCGS FOR MONUMENT "MARJONS 1971" WITH NAD 83/CORS96 STATE PLANE GRID COORDINATES OF NORTHING: 882813.127(ft) EASTING: 1172749.269(ft) ELEVATION: 3232.93'(ft)

THE AVERAGE COMBINED GRID FACTOR USED ON THIS PROJECT (GROUND TO GRID) IS: 0.99986638

THE N.C. LAMBERT GRID BEARING AND LOCALIZED HORIZONTAL GROUND DISTANCE FROM "MARJONS 1971" TO -L- STATION 151+99.39 IS N 45-35-54.7 E 23968.07'(ft)

ALL LINEAR DIMENSIONS ARE LOCALIZED HORIZONTAL DISTANCES VERTICAL DATUM USED IS NAVD 88

Prepared in the Office of:

2018 STANDARD SPECIFICATIONS

RIGHT OF WAY DATE:
NOVEMBER 2018

LETTING DATE:

PROFESSIONAL LAND SURVEYOR



DocuSigned by:
R. Landon Wagner
94066137FD30A2D

6/3/2021

SIGNATURE:

Date:

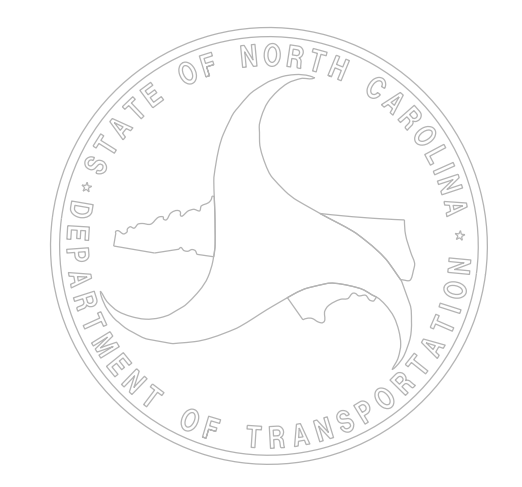

03-JUN-2021 09:55
Z:\OLD_D\NWILKES\R-2566BA\RW CONTROL SHEET\R-2566BA_RdV_psh_01.fsh.dgn
csmosfjn AT LS-300027