

5/28/2021

BM7  
N 899.026 E 1,189.650 ELEV. = 2,817.94'  
RR SPIKE IN BASE OF 24" DBL TULIP POPLAR

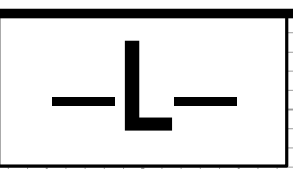

**WETHERILL ENGINEERING**  
1223 Jones Franklin Rd.  
Raleigh, N.C. 27606  
License No. F-0377  
Bus: 919 851 8077  
Fax: 919 851 8107

TRANSPORTATION PLANNING/DESIGN - BRIDGE/STRUCTURE DESIGN  
CIVIL/SITE DESIGN - GIS/GPS - CONSTRUCTION OBSERVATION

**TGS ENGINEERS**  
706 HILLSBOROUGH ST. SUITE 200  
RALEIGH, NC 27603  
PH (919) 773-8887  
CORP. LICENSE NO.: C-0275

PROJECT REFERENCE NO. <b>R-2566BA</b>	SHEET NO. <b>7</b>
ROADWAY DESIGN ENGINEER <i>[Signature]</i>	HYDRAULICS ENGINEER <i>[Signature]</i>
8/3/2021	8/3/2021

**DOCUMENT NOT CONSIDERED FINAL  
UNLESS ALL SIGNATURES COMPLETED**

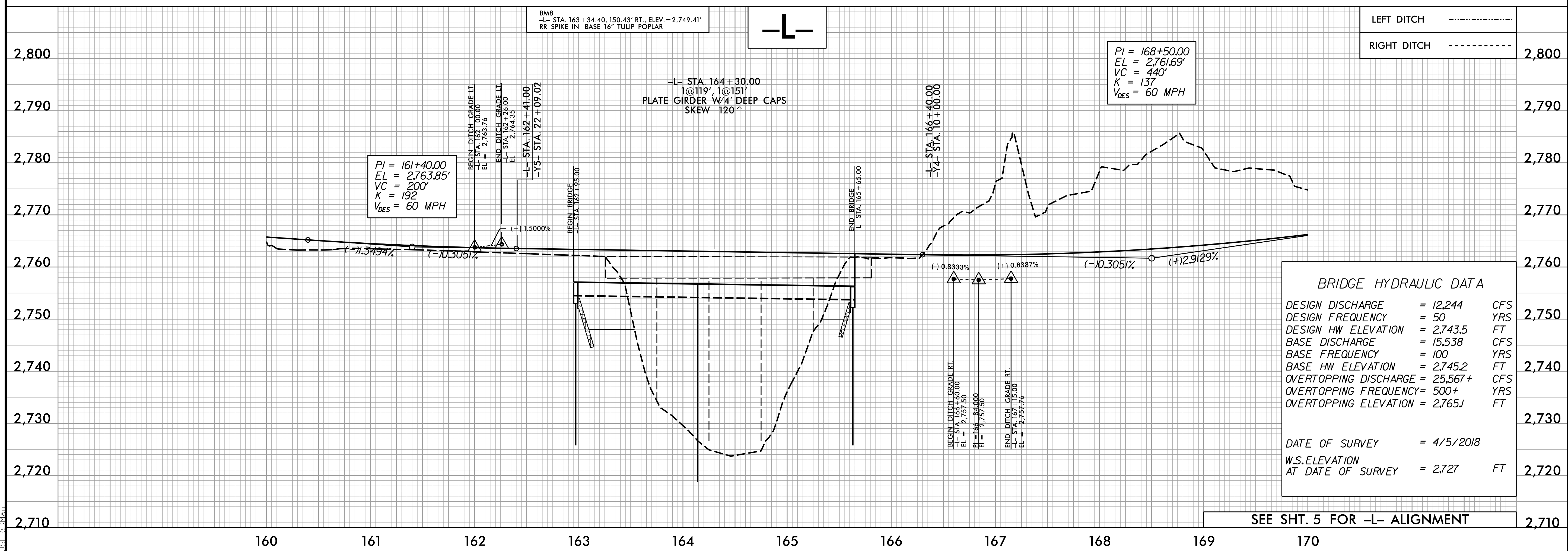
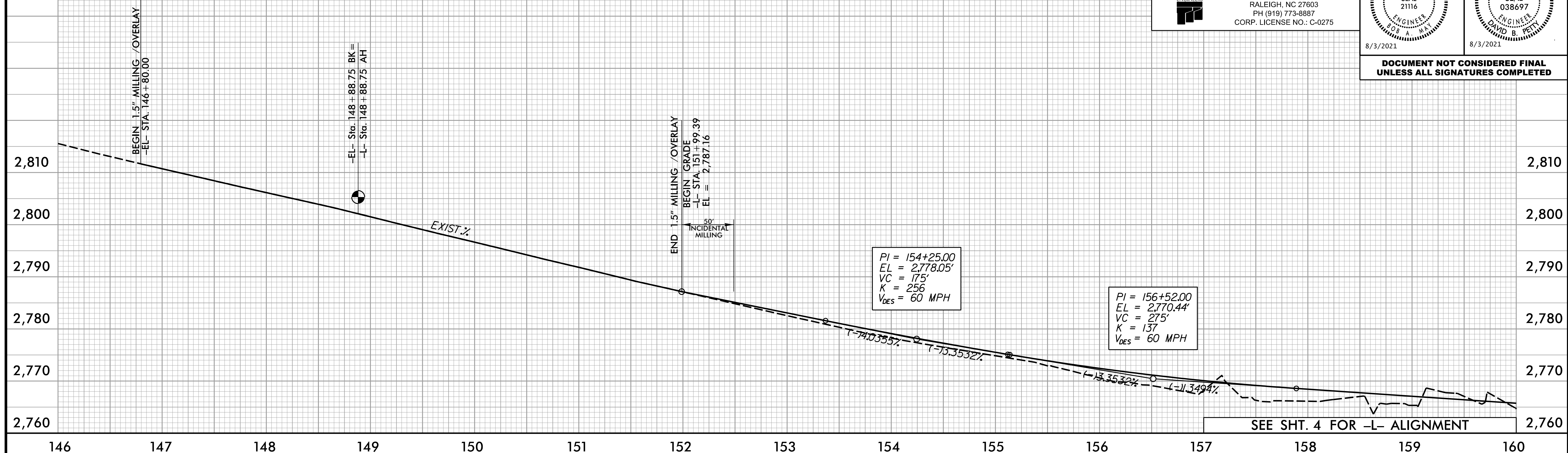

BRIDGE HYDRAULIC DATA		
DESIGN DISCHARGE	= 12,244	CFS
DESIGN FREQUENCY	= 50	YRS
DESIGN HW ELEVATION	= 2,743.5	FT
BASE DISCHARGE	= 15,538	CFS
BASE FREQUENCY	= 100	YRS
BASE HW ELEVATION	= 2,745.2	FT
OVERTOPPING DISCHARGE	= 25,567+	CFS
OVERTOPPING FREQUENCY	= 500+	YRS
OVERTOPPING ELEVATION	= 2,765J	FT
DATE OF SURVEY	= 4/5/2018	
W.S. ELEVATION AT DATE OF SURVEY	= 2,727	FT

7/30/2021 2:06:00 PM R:\p1\p1.dgn

SEE SHT. 5 FOR -L- ALIGNMENT