

09.08/99

26-MAY-2020 11:39 Y:\Projects\NCDOT\Utility On-Call Contract\BR-0035 Moore County\Utilities\BR0035\_ut\_tsh\_U01\_psh.dgn C:\Users\at\_caryl\OneDrive\AT\_CARYL\NCSOME

**TIP PROJECT: BR-0035**

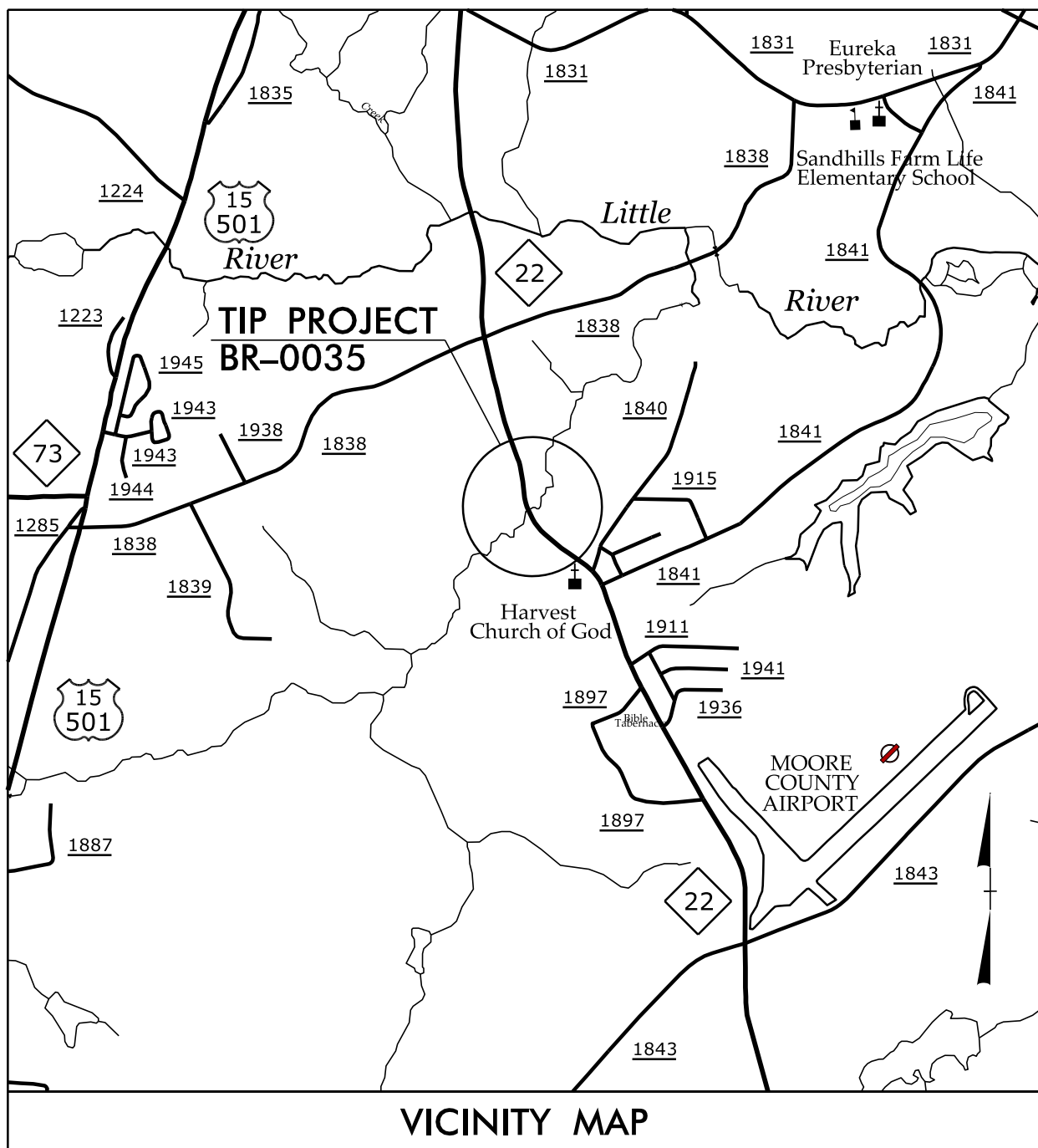

STATE OF NORTH CAROLINA  
DIVISION OF HIGHWAYS

**UTILITIES BY OTHERS PLANS  
MOORE COUNTY**

**LOCATION: BRIDGE NO. 24 ON NC 22 OVER NICKS CREEK**

**TYPE OF WORK: POWER AND COMMUNICATIONS RELOCATION**

T.I.P. NO.	SHEET NO.
<b>BR-0035</b>	<b>UO-1</b>

NOTE:  
ALL UTILITY WORK SHOWN ON THIS SHEET WILL BE DONE BY OTHERS. NO PAYMENT WILL BE MADE TO THE CONTRACTOR FOR UTILITY WORK SHOWN ON THIS SHEET.

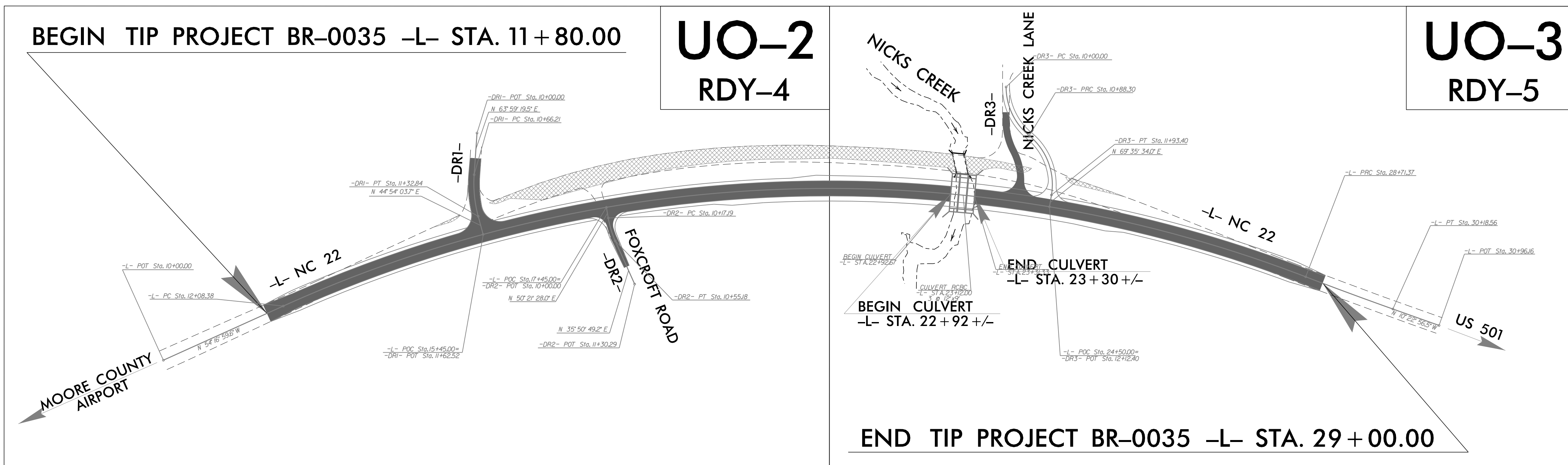
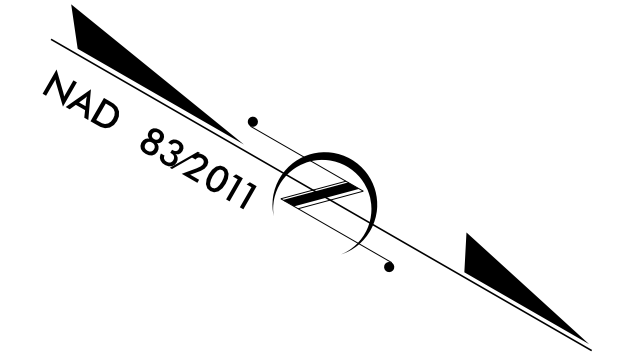

PRELIMINARY PLANS  
DO NOT USE FOR CONSTRUCTION

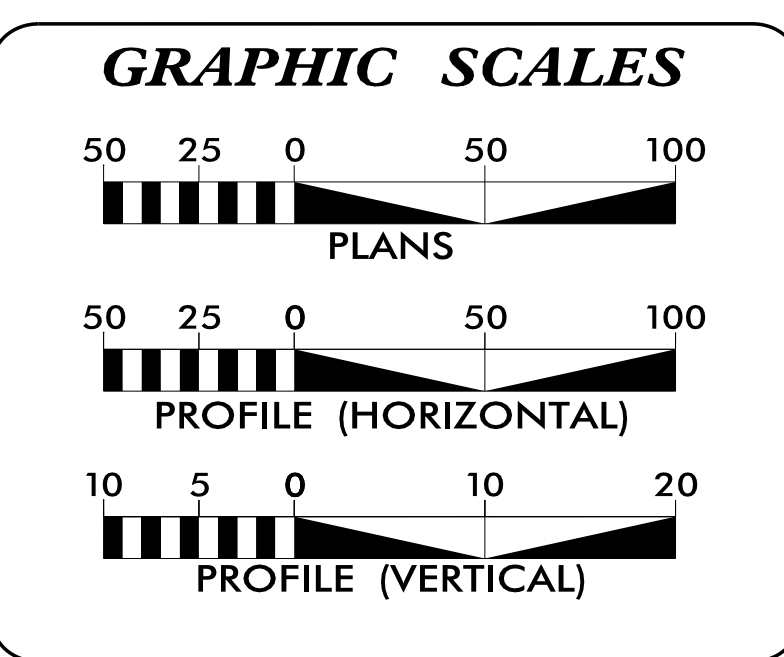

**INDEX OF SHEETS**

SHEET NO.:	DESCRIPTION:
UO-1	TITLE SHEET
UO-2, UO-3	UBO PLAN SHEETS

**UTILITY OWNERS WITH CONFLICTS**

(A) POWER (DISTRIBUTION) - DUKE ENERGY  
(B) COMMUNICATIONS - CENTURYLINK  
(C) COMMUNICATIONS - CONTERRA

PREPARED IN THE OFFICE OF:

**Michael Baker INTERNATIONAL**

Michael Baker Engineering, Inc.  
8000 Regency Parkway, Suite 600  
Cary, NC 27518  
919-463-5488

Daniel Oliver	UTILITY PROJECT MANAGER
Daniel Oliver	PROJECT UTILITY COORDINATOR
Christina Newsome	PROJECT UTILITY TECHNICIAN

**DIVISION OF HIGHWAYS  
UTILITIES UNIT**

1555 MAIL SERVICES CENTER  
RALEIGH, NC 27699-1555  
PHONE (919) 707-6690  
FAX (919) 250-4151

Tucker R. Martin, PE	UTILITIES REGIONAL ENGINEER
Jon Loughry	UTILITIES ENGINEER
Jon E. Gaillard	UTILITIES COORDINATOR

### UTILITIES BY OTHERS

ALL PROPOSED UTILITY WORK SHOWN ON THIS SHEET WILL BE DONE BY OTHERS. NO PAYMENT WILL BE MADE TO THE CONTRACTOR FOR PROPOSED UTILITY WORK SHOWN ON THIS SHEET.

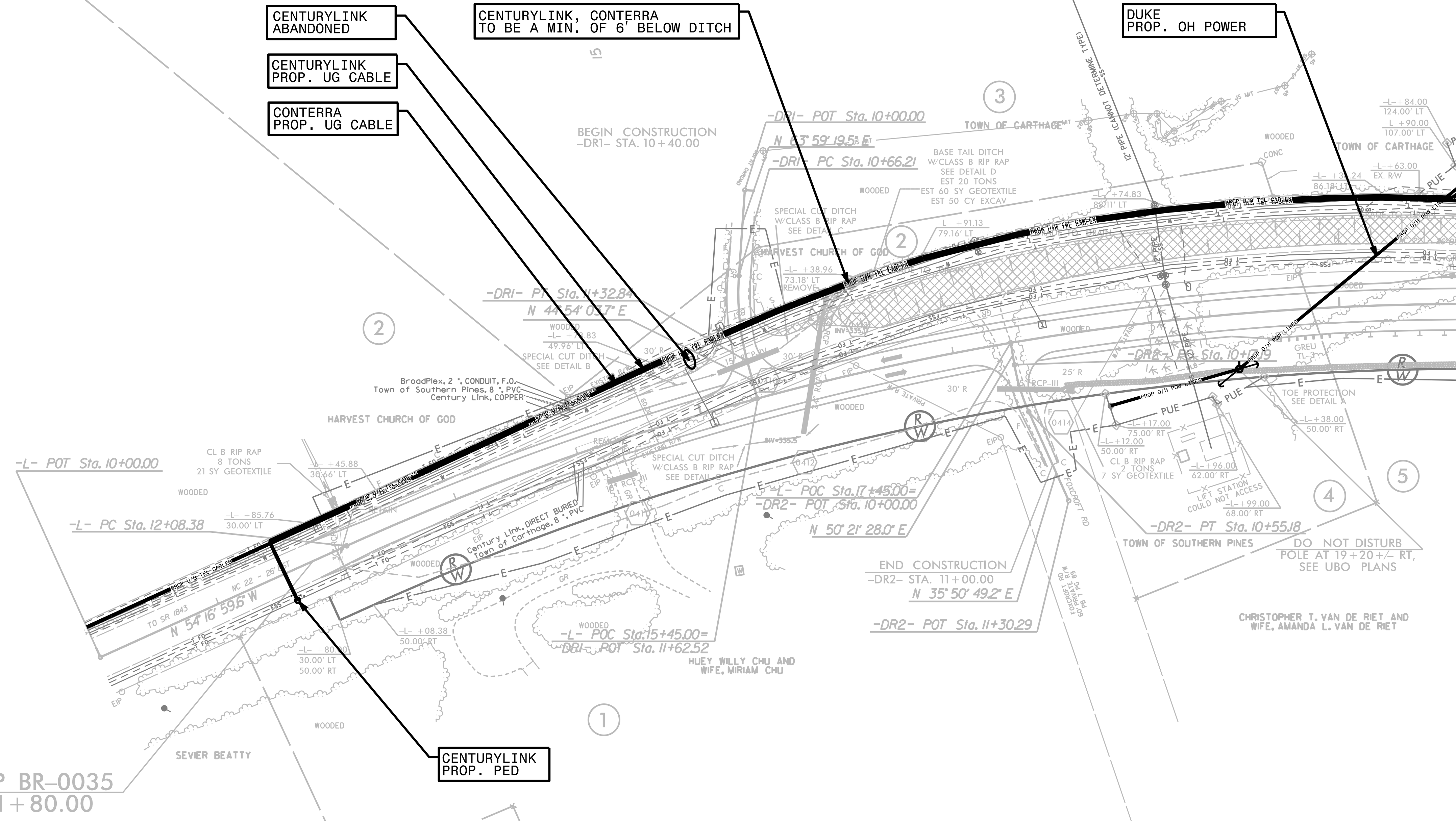
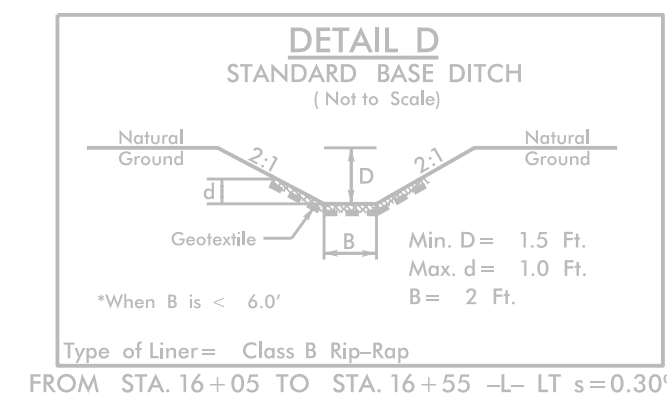
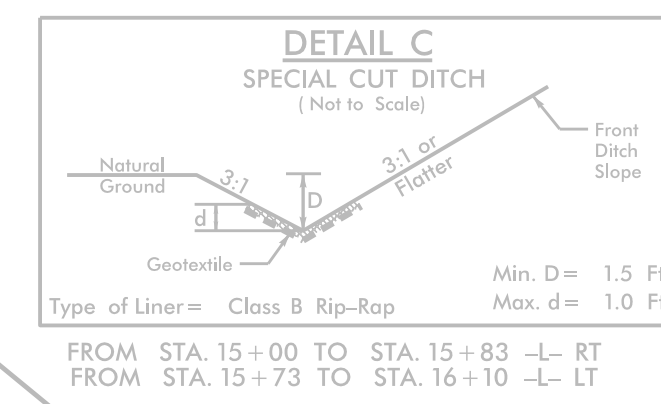
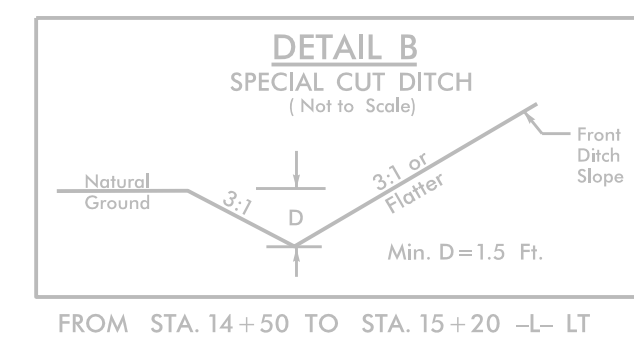
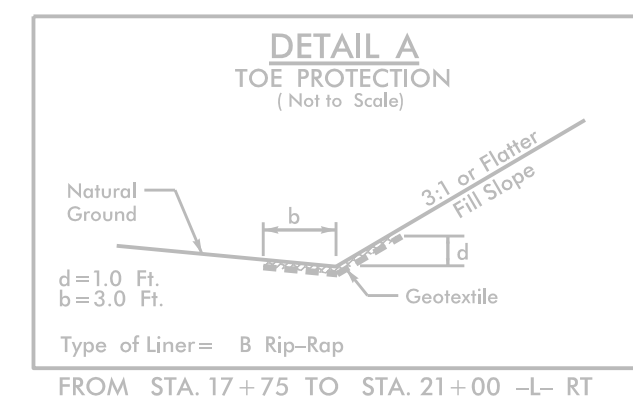
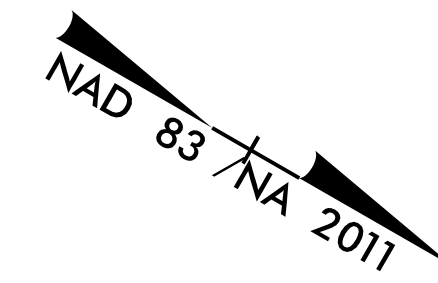

MATCHLINE -L- STA. 21+00.00 SEE SHEET UO-3

5/14/99  
#1  
#2  
#3  
#4  
#5  
#6  
#7  
#8  
#9  
#10  
#11  
#12  
#13  
#14  
#15  
#16  
#17  
#18  
#19  
#20  
#21  
#22  
#23  
#24  
#25  
#26  
#27  
#28  
#29  
#30  
#31  
#32  
#33  
#34  
#35  
#36  
#37  
#38  
#39  
#40  
#41  
#42  
#43  
#44  
#45  
#46  
#47  
#48  
#49  
#50  
#51  
#52  
#53  
#54  
#55  
#56  
#57  
#58  
#59  
#60  
#61  
#62  
#63  
#64  
#65  
#66  
#67  
#68  
#69  
#70  
#71  
#72  
#73  
#74  
#75  
#76  
#77  
#78  
#79  
#80  
#81  
#82  
#83  
#84  
#85  
#86  
#87  
#88  
#89  
#90  
#91  
#92  
#93  
#94  
#95  
#96  
#97  
#98  
#99  
#100

### UTILITIES BY OTHERS

ALL PROPOSED UTILITY WORK SHOWN ON THIS SHEET WILL BE DONE BY OTHERS. NO PAYMENT WILL BE MADE TO THE CONTRACTOR FOR PROPOSED UTILITY WORK SHOWN ON THIS SHEET.

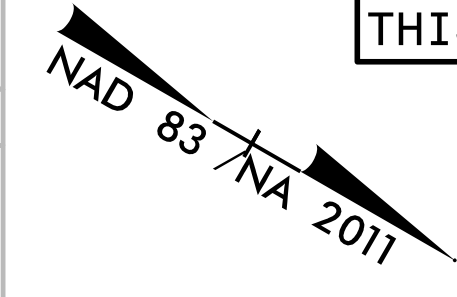

-L-	
PI Sta 20+86.24	PI Sta 29+44.97
$\Delta = 45^{\circ} 22' 21.6" (RT)$	$\Delta = 1^{\circ} 28' 18.5" (LT)$
$D = 2^{\circ} 43' 42.1"$	$D = 1^{\circ} 00' 00.0"$
$L = 1663.00'$	$L = 147.18'$
$T = 877.86'$	$T = 73.59'$
$R = 2100.00'$	$R = 5729.58'$
$RO = \text{SEE PLANS}$	
$SE = .06$	

  

-DR3-	
PI Sta 10+47.26	PI Sta 11+46.29
$\Delta = 50^{\circ} 35' 24.0" (LT)$	$\Delta = 60^{\circ} 13' 20.5" (RT)$
$D = 57^{\circ} 17' 44.8"$	$D = 57^{\circ} 17' 44.8"$
$L = 88.30'$	$L = 105.11'$
$T = 47.26'$	$T = 57.99'$
$R = 100.00'$	$R = 100.00'$

CENTURYLINK  
PROP. UG CABLE  
DIRECTIONAL BORE  
10' BELOW CREEK BED

CONTERRA  
PROP. UG CABLE  
DIRECTIONAL BORE  
10' BELOW CREEK BED

MATCHLINE -L- STA. 21+00.00 SEE SHEET UO-2

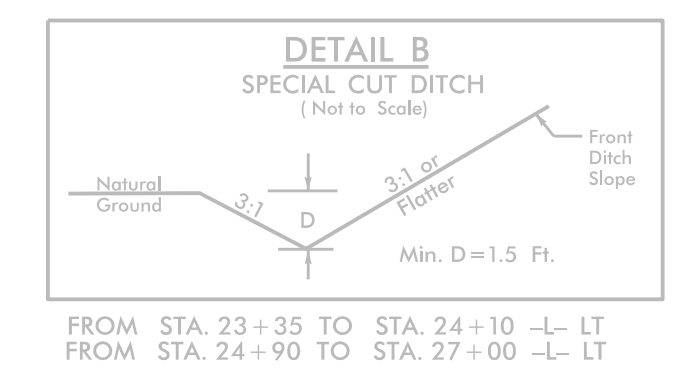
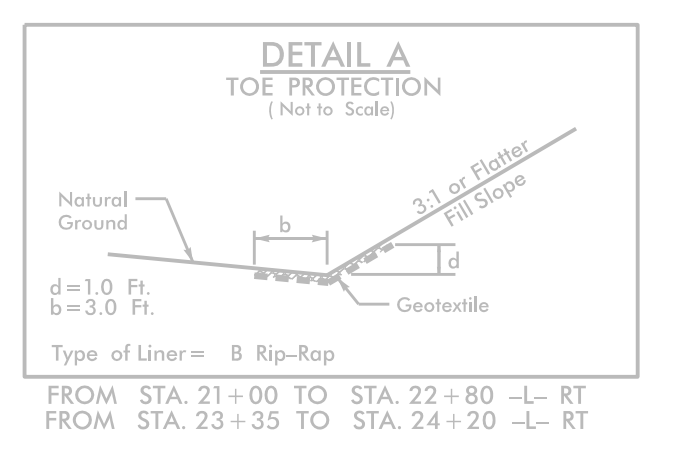
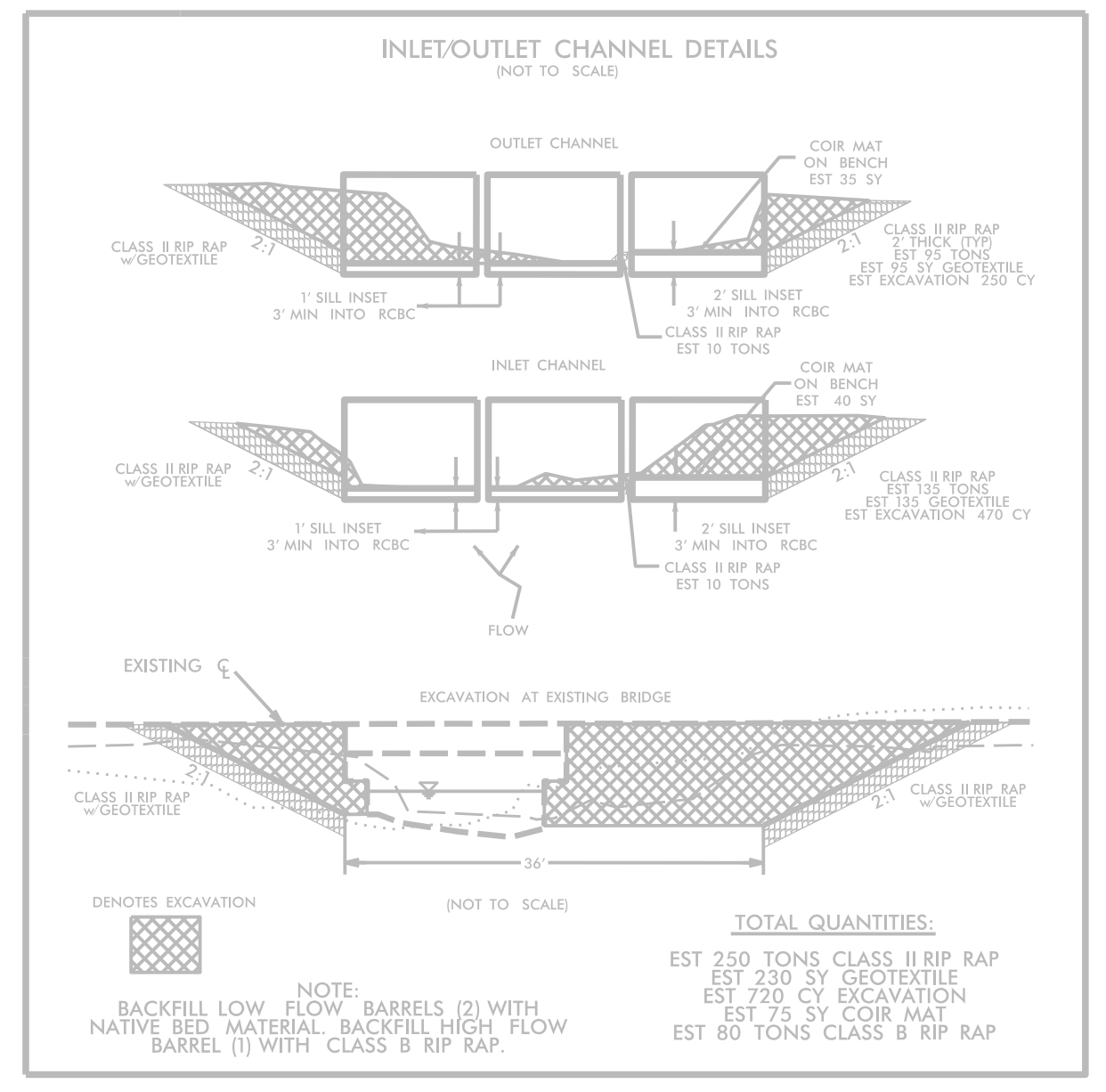
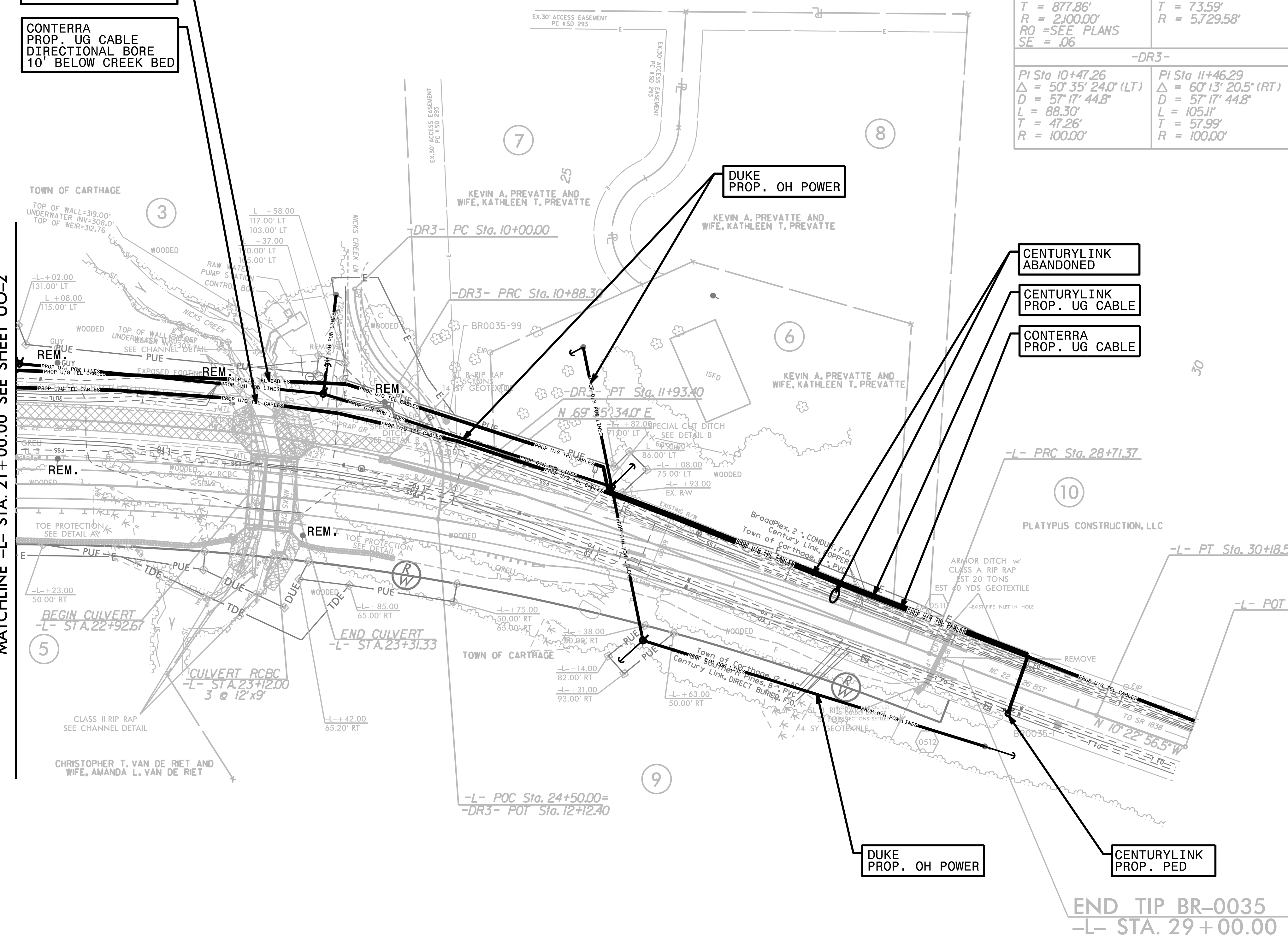

5/14/2019