

09/06/19

TIP PROJECT: U-4405A

STATE OF NORTH CAROLINA  
DIVISION OF HIGHWAYS

SURVEY CONTROL, EXISTING CENTERLINES,  
RIGHT OF WAY, EASEMENTS AND PROPERTY TIES

**CUMBERLAND COUNTY**

LOCATION: US 401 FROM OLD RAEFORD ROAD TO EAST OF NC 162  
(BUNCE RD) IN FAYETTEVILLE

STATE	STATE PROJECT REFERENCE NO.	SHEET NO.	TOTAL SHEETS
N.C.	U-4405A	RW01	21
STATE PROJ. NO.	F. A. PROJ. NO.	DESCRIPTION	
39049.2.2	STPDA-0401(300)	RW	
39049.2.4	STPDA-0401(300)	UTIL	

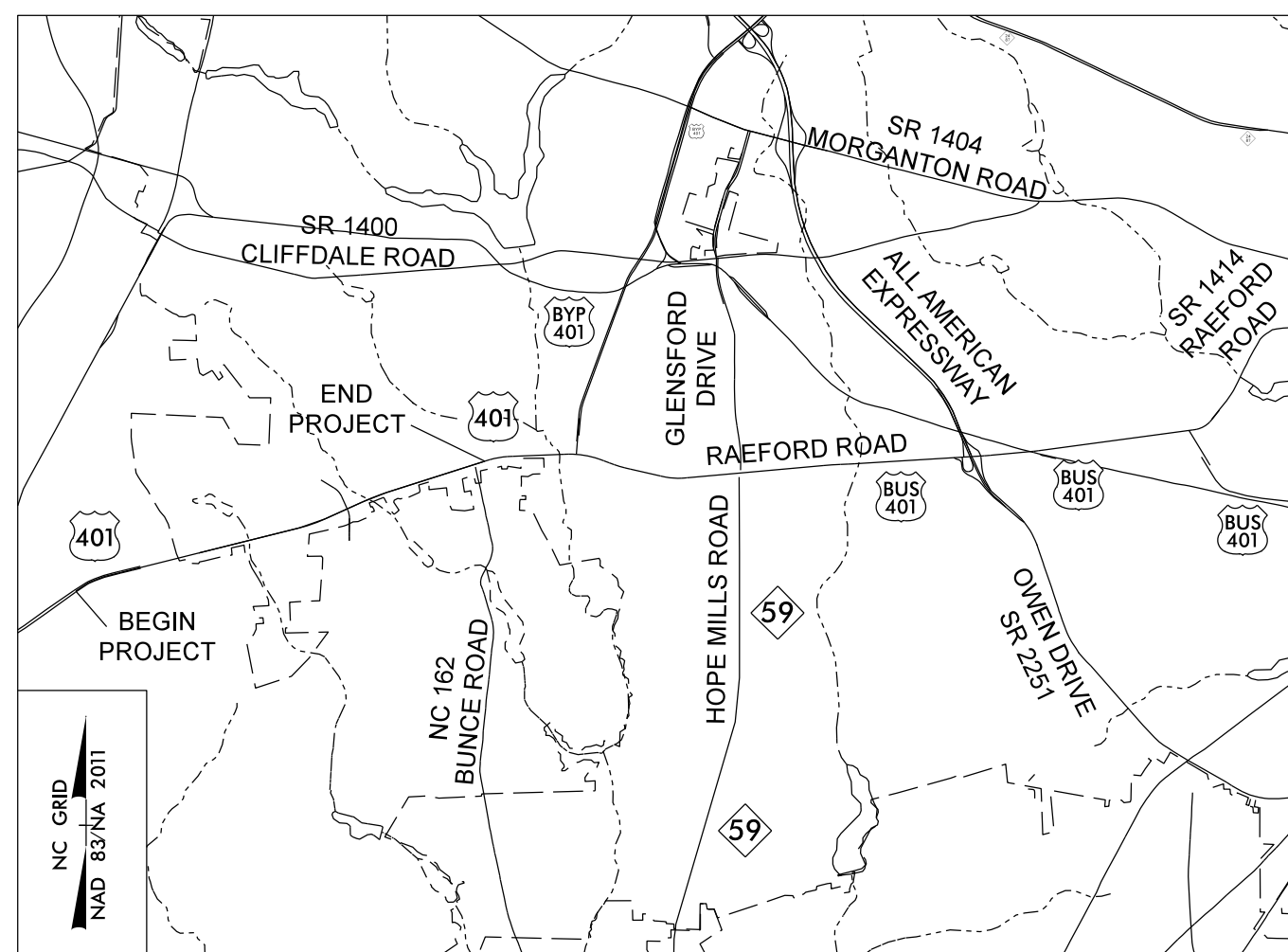

VICINITY MAP

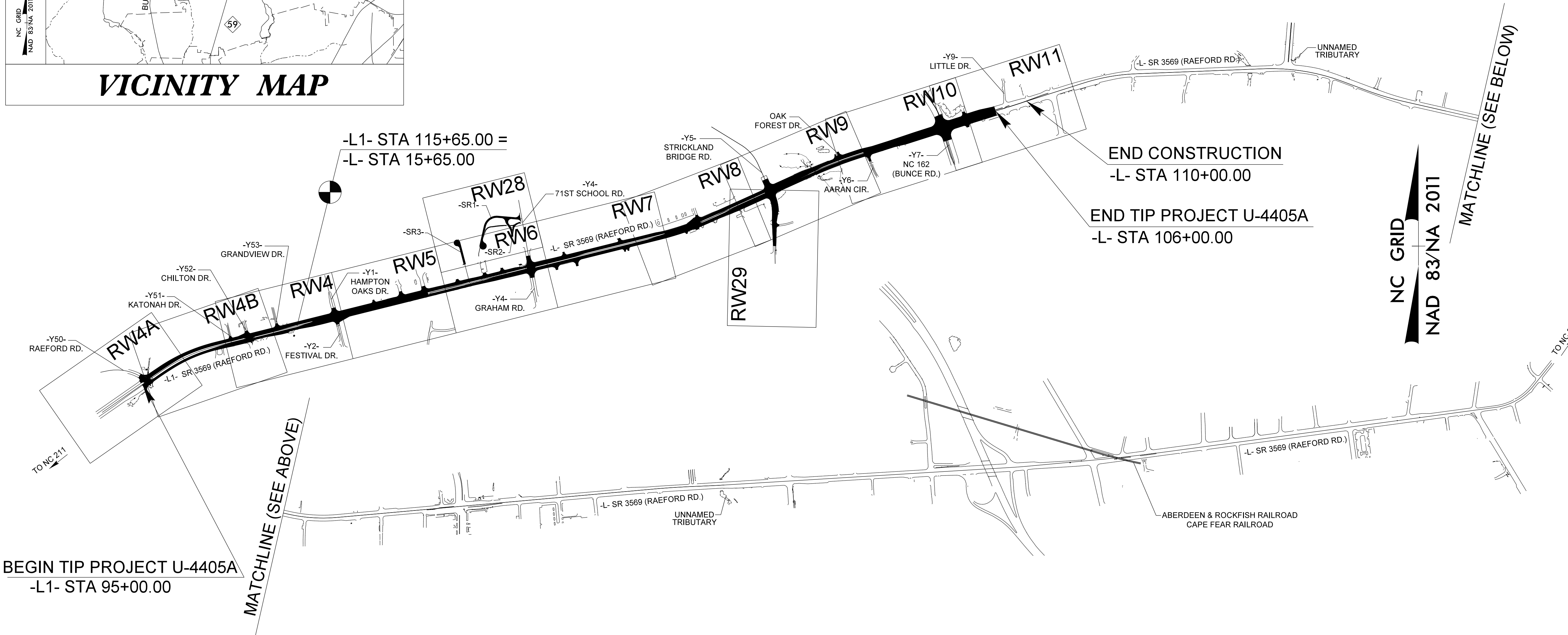

BEGIN TIP PROJECT U-4405A  
-L1- STA 95+00.00

-L1- STA 115+65.00 =  
-L- STA 15+65.00

END CONSTRUCTION  
-L- STA 110+00.00

END TIP PROJECT U-4405A  
-L- STA 106+00.00

★ PROPOSED SIGNAL

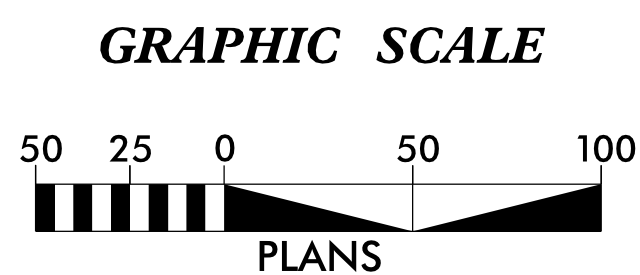

**DATUM DESCRIPTION**

THE LOCALIZED COORDINATE SYSTEM DEVELOPED FOR THIS PROJECT IS BASED ON THE STATE PLANE COORDINATES ESTABLISHED BY NCDOT FOR MONUMENT "U-3424-1" WITH NAD 83/NSRS 2011 STATE PLANE GRID COORDINATES OF NORTHING: 470729.9010(ft) EASTING: 2,003,980.0510(ft) ELEVATION: 211.690(ft)

THE AVERAGE COMBINED GRID FACTOR USED ON THIS PROJECT (GROUND TO GRID) IS: 0.99987500

THE N.C. LAMBERT GRID BEARING AND LOCALIZED HORIZONTAL GRID DISTANCE FROM "U-3424-1" TO -L- STATION 10+00.00 IS S 72°-34'45.67" W 9496.53(ft)

ALL LINEAR DIMENSIONS ARE LOCALIZED HORIZONTAL DISTANCES VERTICAL DATUM USED IS NAVD 88

Prepared in the Office of:

NCDOT DIVISION 6  
LOCATION & SURVEYS  
4834 US HWY 301 S  
HOPE MILLS, NC 28348

2018 STANDARD SPECIFICATIONS

RIGHT OF WAY DATE:  
JULY 29, 2016

LETTING DATE:  
OCTOBER 19, 2021

PROFESSIONAL LAND SURVEYOR

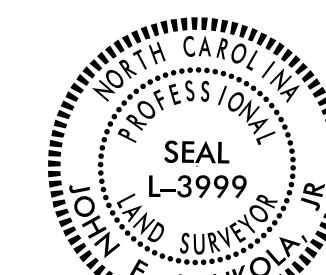

DocuSigned by:  
John E. Kankola, Jr.  
SIGNATURE

8/5/2021  
Date:

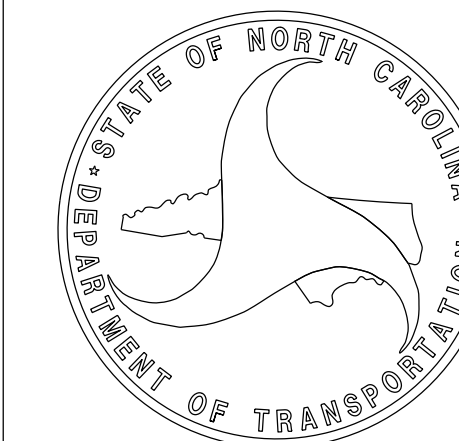

\$\$\$\$\$ SYSTEM TIME\$\$\$\$\$  
\$\$\$\$\$ DGN\$\$\$\$\$  
\$\$\$\$\$ USERNAME\$\$\$\$\$