

CLASS II (PARTIAL DEPTH) REPAIR

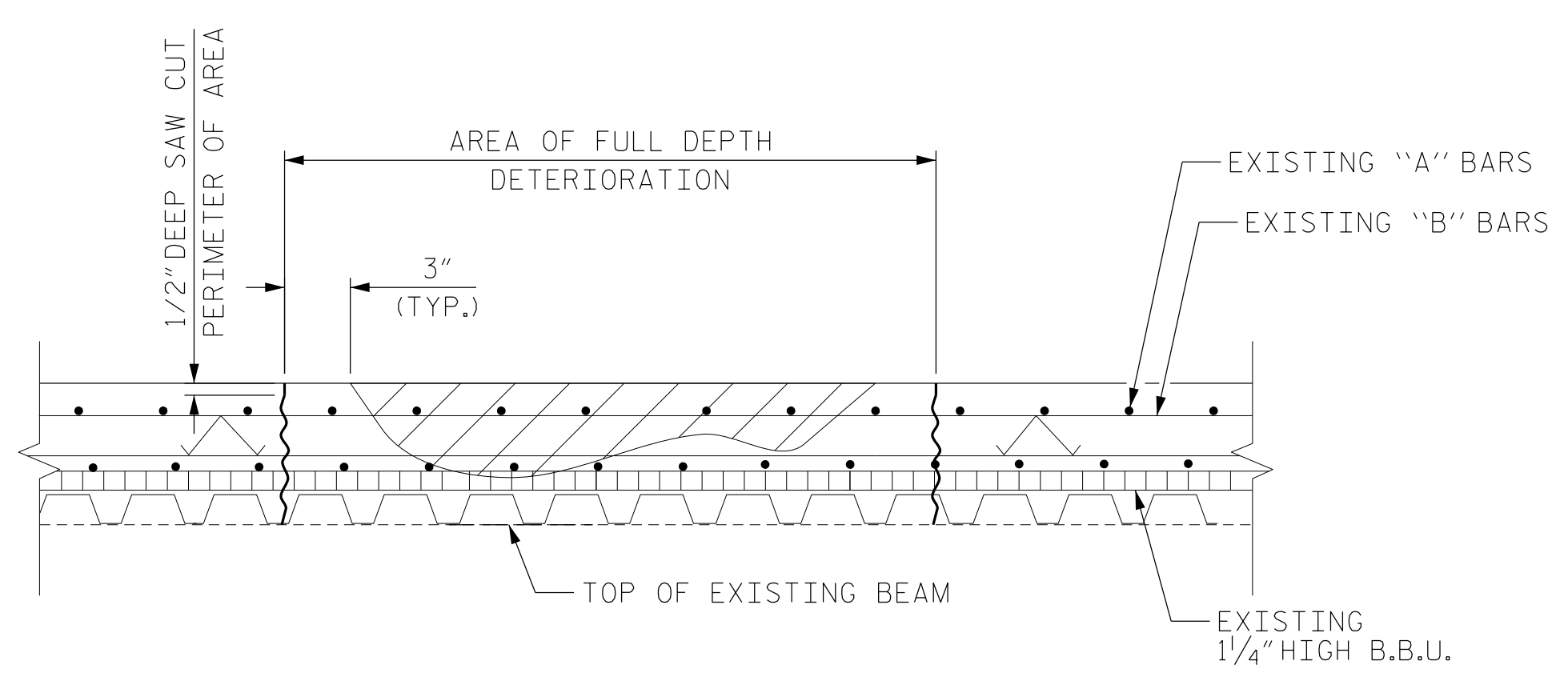

CLASS III (FULL DEPTH) REPAIR

NOTES

FOR AREAS TO BE REPAIRED, SEE "PLAN OF SPANS" SHEETS.
 ALL DECK REPAIRS SHALL BE COMPLETED PRIOR TO PLACEMENT OF OVERLAY.
 FOR CLASS II AND CLASS III SURFACE PREPARATION, SEE OVERLAY SURFACE PREPARATIONS SPECIAL PROVISION.
 FOR CONCRETE FOR DECK REPAIR, SEE SPECIAL PROVISIONS.
 FOR SHOTCRETE REPAIR, SEE SPECIAL PROVISIONS.
 THE CONTRACTOR SHALL SUBMIT WORKING DRAWINGS TO THE ENGINEER FOR APPROVAL PRIOR TO STARTING WORK FOR TEMPORARY FORMWORK. FOR SUBMITTALS OF WORKING DRAWINGS, SEE SPECIAL PROVISIONS.
 UPON REMOVAL OF TEMPORARY FORMWORK, ALL VOIDS AND HONEYCOMBS ON THE UNDERSIDE OF DECK SURFACE SHALL BE FILLED WITH THE SAME MATERIAL AS USED FOR THE PATCH, AND FINISHED TO CONFORM TO THE SURROUNDING CONCRETE SURFACE.
 NO FORMWORK SHALL BE LEFT IN PLACE.

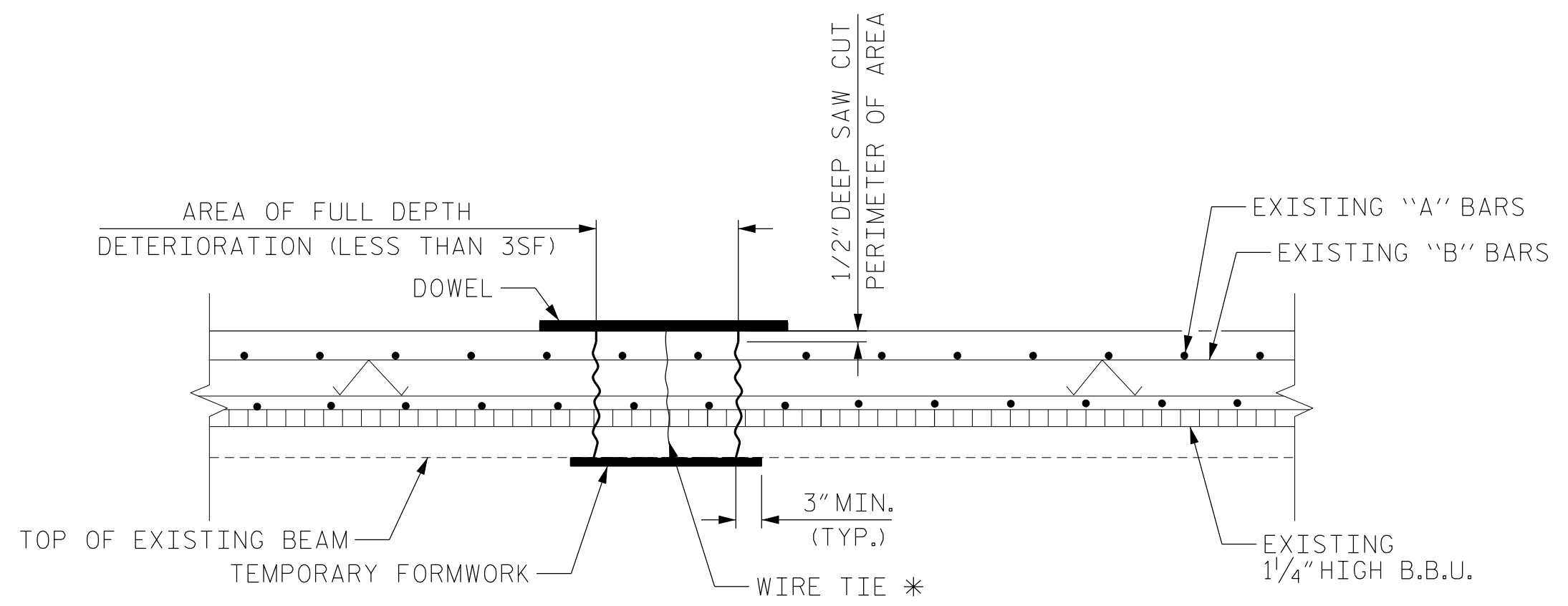

FULL DEPTH REPAIR WITH TEMPORARY FORMWORK

(FOR AREAS OF DETERIORATION EQUAL TO OR LESS THAN 3SF)

* WIRE TIE TO BE KNOTTED BELOW TEMPORARY FORMWORK AND ATTACHED TO DOWEL THAT IS WIDER THAN FORMED FULL DEPTH HOLE. ROTATE DOWEL TO TIGHTEN FORMWORK AGAINST BOTTOM OF DECK.

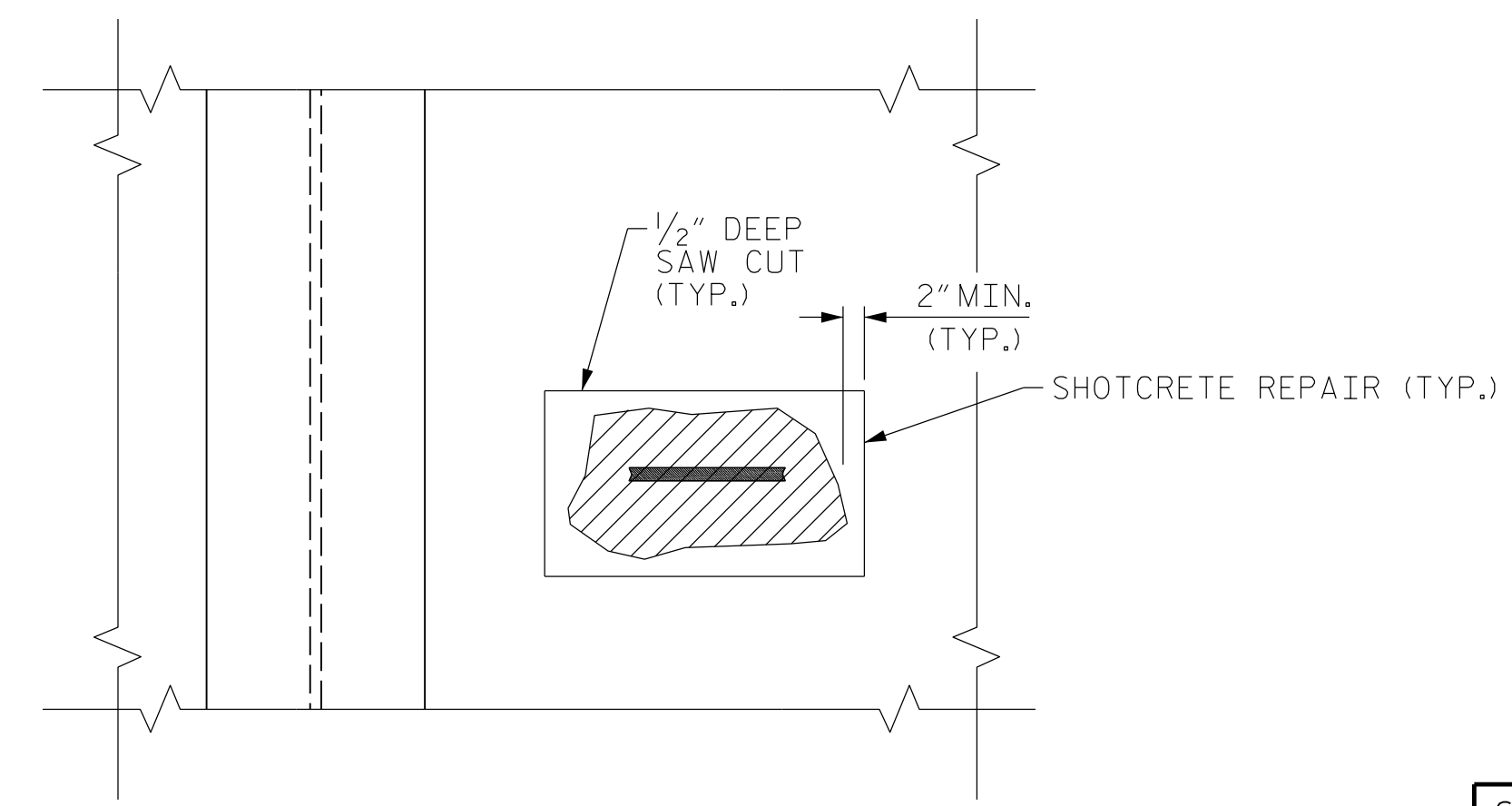

SECTION D-D

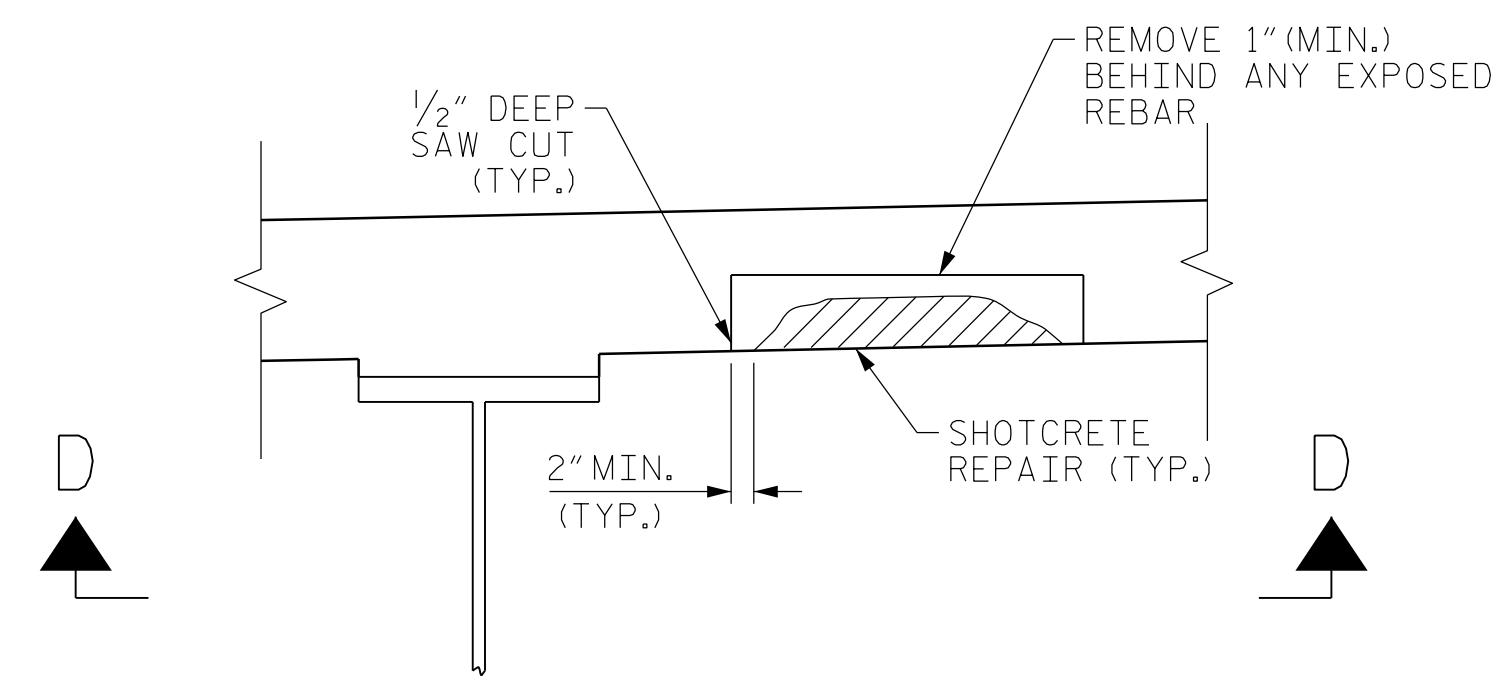

TYPICAL SECTION

UNDERSIDE OF DECK REPAIR

BAR SIZE	SUPERSTRUCTURE REINFORCING STEEL LENGTHS ARE BASED ON THE FOLLOWING MINIMUM SPLICE LENGTHS				
	SUPERSTRUCTURE EXCEPT APPROACH SLABS, PARAPET, AND BARRIER RAIL		APPROACH SLABS		PARAPET AND BARRIER RAIL
	EPOXY COATED	UNCOATED	EPOXY COATED	UNCOATED	
#4	2'-0"	1'-9"	2'-0"	1'-9"	2'-9"
#5	2'-6"	2'-2"	2'-6"	2'-2"	3'-5"
#6	3'-0"	2'-7"	3'-10"	2'-7"	4'-4"
#7	5'-3"	3'-6"			
#8	6'-10"	4'-7"			

BRIDGES: 770010, 770012, 770004, 770086, 770089, 770090, 770096, 770098, 770104, 770106, 770107, 770124, 770130, 770131

PROJECT NO. I-5939
ROBESON COUNTY
 BRIDGE NO. MULTIPLE

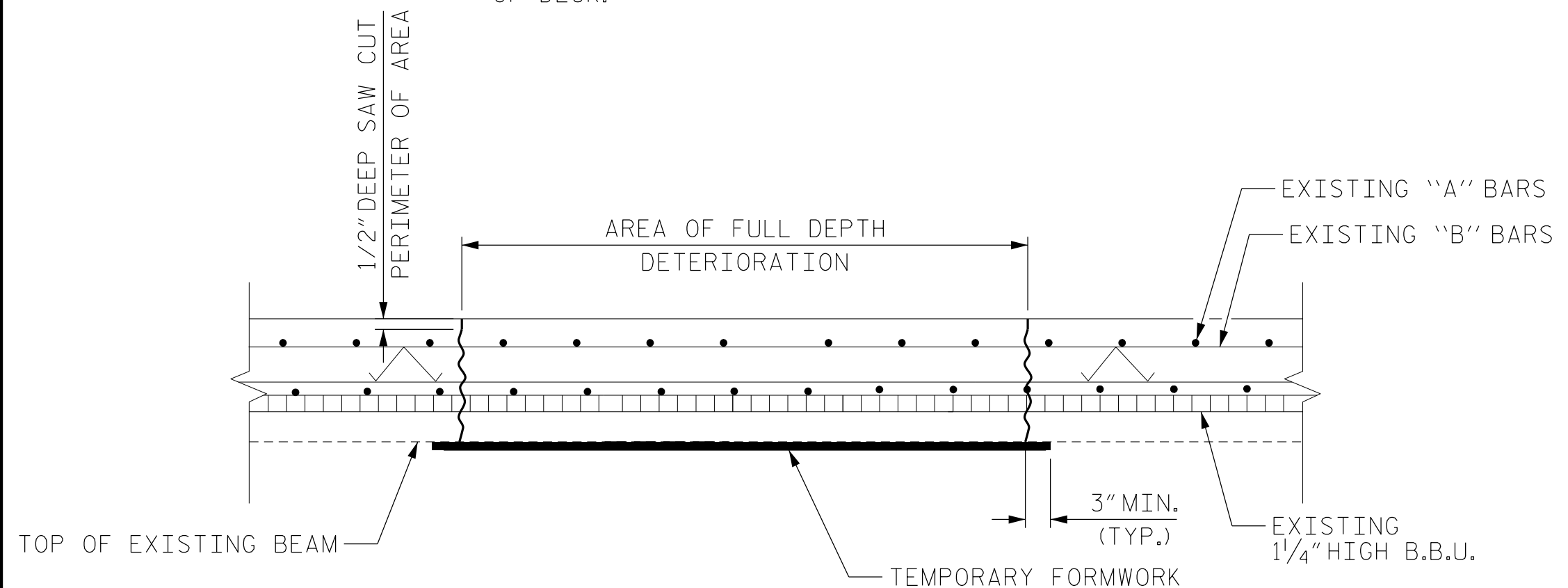

FULL DEPTH REPAIR WITH TEMPORARY FORMWORK

(FOR AREAS OF DETERIORATION GREATER THAN 3SF)

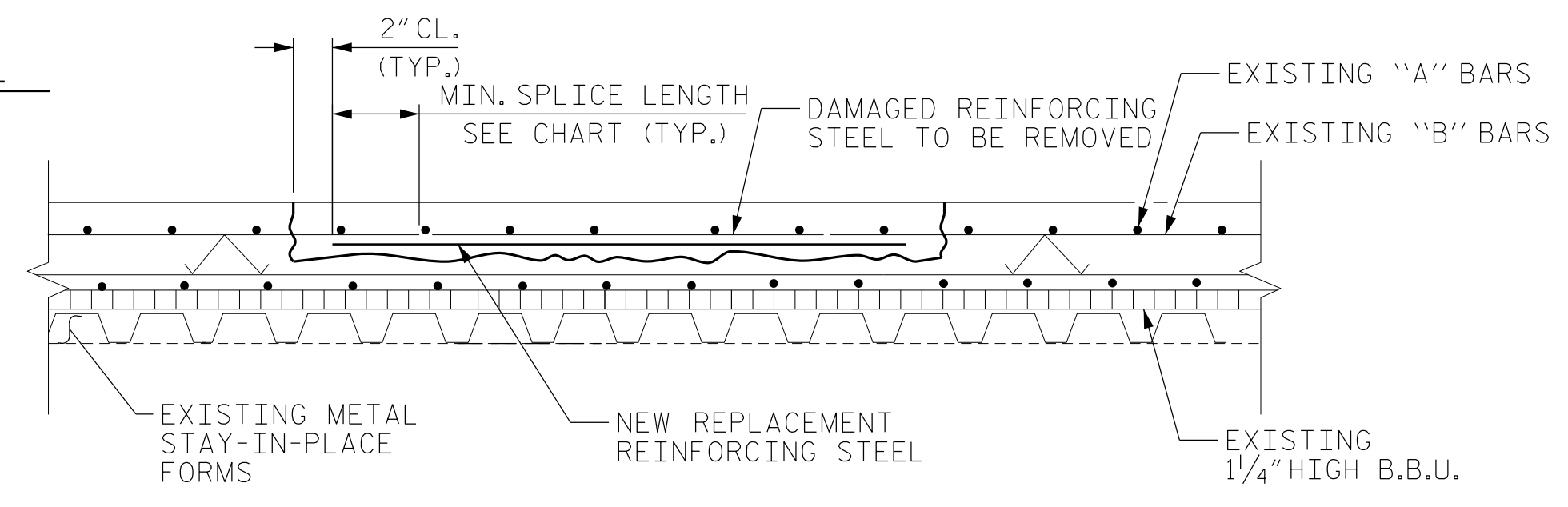

REINFORCING STEEL REPAIR

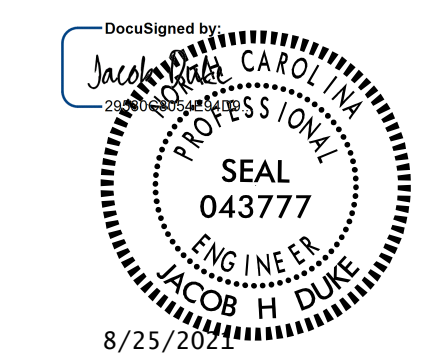

STATE OF NORTH CAROLINA DEPARTMENT OF TRANSPORTATION RALEIGH STANDARD DECK REPAIR DETAILS					
REVISIONS					SHEET NO.
NO.	BY:	DATE:	NO.	BY:	DATE:
1			3		
2			4		
					S5
					TOTAL SHEETS 12

ASSEMBLED BY :	DATE :
CHECKED BY :	DATE :
DRAWN BY : NAP 9/18	
CHECKED BY :	
DRAWN BY : FIDEL L. FLORES	DATE : 06/2021
CHECKED BY : DIEGO A. AGUIRRE	DATE : 06/2021
DESIGN ENGINEER OF RECORD: JACOB H. DUKE	DATE : 06/2021

DOCUMENT NOT CONSIDERED FINAL UNLESS ALL SIGNATURES COMPLETED