

MESSAGE NO. 1 S 301 CLOSED AHEAD	MESSAGE NO. 2 FOLLOW S 301 DETOUR	MESSAGE NO. 1 S 301 EXT CLSD 1 MILE	MESSAGE NO. 2 S 301 DETOUR EXIT 193	MESSAGE NO. 1 S 301 EXIT CLOSED	MESSAGE NO. 2 S 301 DETOUR EXIT 193
---	--	--	--	--	--

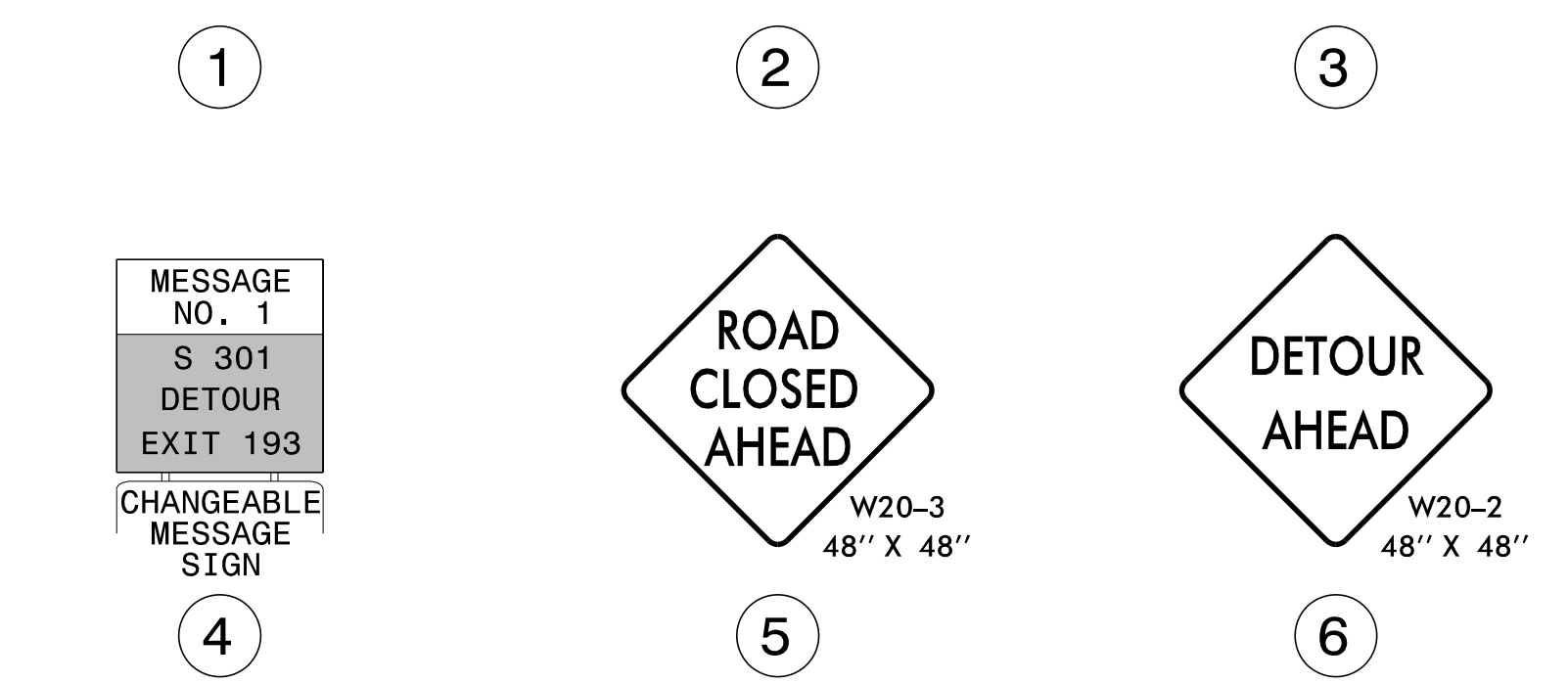

ROAD (SB 301) & EXIT 1A CLOSURE DETAIL

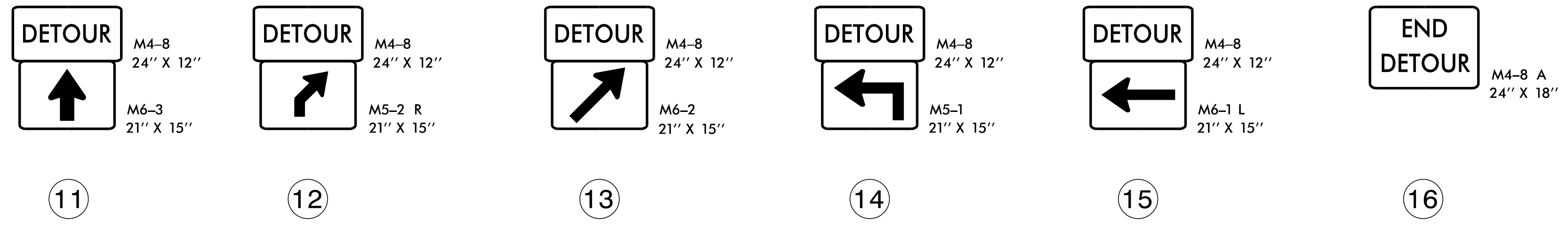
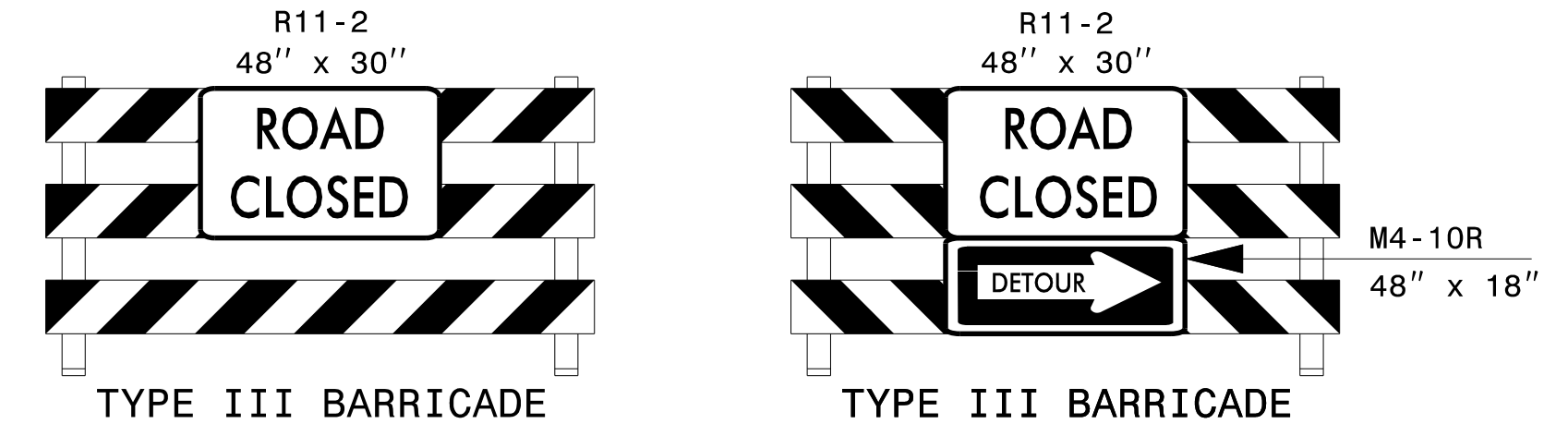
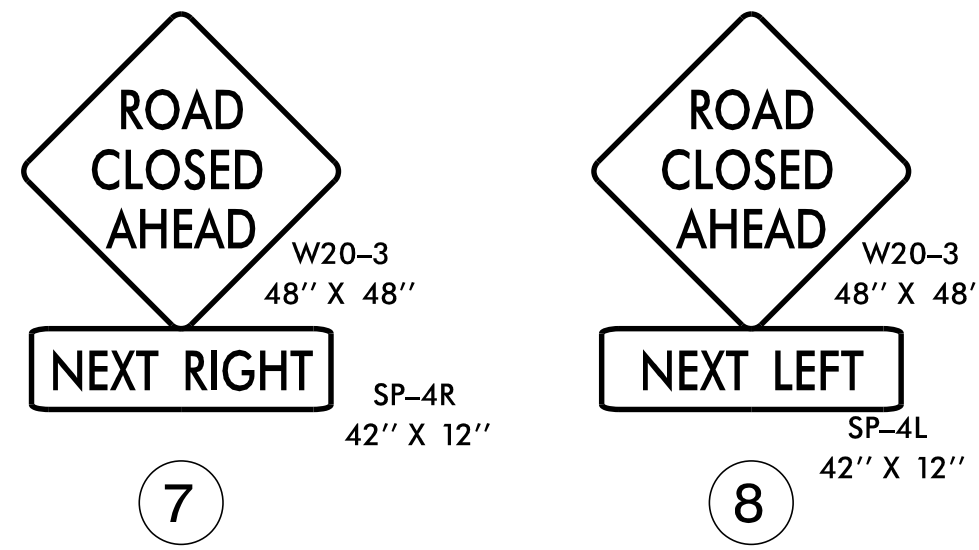
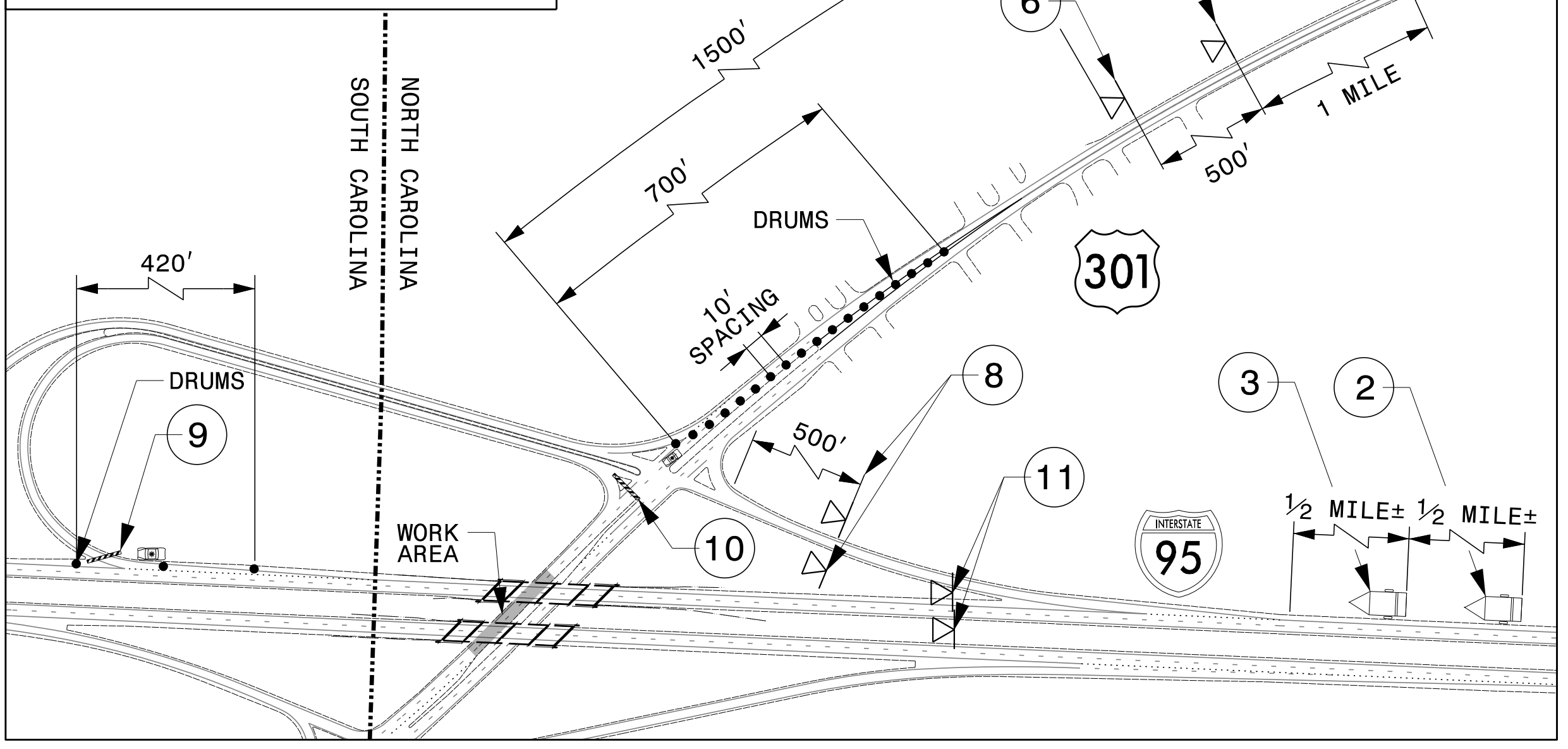

DETOUR DESCRIPTION:
I95 SB TO EXIT 193 TO SC 9 EAST
TO I95 NB TO EXIT 1 301 SOUTH

NOTES:
1. TRAFFIC CONTROL DEVICES 1 THRU 16 SHALL BE INSTALLED PER ENGINEER'S INSTRUCTIONS.

8/13/2021
15939_TC_TMP_Detour_010_012_Y1_301_SB.dgn
User: jdebone

APPROVED: *Jacob Duke*
DATE: 8/13/2021

SEAL

DOCUMENT NOT CONSIDERED FINAL
UNLESS ALL SIGNATURES COMPLETED

DIVISION OF HIGHWAYS
STATE OF NORTH CAROLINA
DEPARTMENT OF TRANSPORTATION
WORK ZONE TRAFFIC CONTROL

Y1 US 301/US 501
SB DETOUR