

LOAD AND RESISTANCE FACTOR RATING (LRFD) SUMMARY FOR PRESTRESSED CONCRETE GIRDERS

LEVEL	VEHICLE	WEIGHT (W) (TONS)	CONTROLLING LOAD RATING	MINIMUM RATING FACTORS (RF)	TONS = W X RF	STRENGTH I LIMIT STATE										SERVICE III LIMIT STATE					COMMENT NUMBER			
						MOMENT					SHEAR					MOMENT								
						LIVELOAD FACTORS	DISTRIBUTION FACTORS (DF)	RATING FACTOR	SPAN	GIRDER LOCATION	DISTANCE FROM LEFT END OF SPAN (ft)	DISTRIBUTION FACTORS (DF)	RATING FACTOR	SPAN	GIRDER LOCATION	DISTANCE FROM LEFT END OF SPAN (ft)	LIVELOAD FACTORS	DISTRIBUTION FACTORS (DF)	RATING FACTOR	SPAN		GIRDER LOCATION	DISTANCE FROM LEFT END OF SPAN (ft)	
DESIGN LOAD RATING	HL-93(Inv)	N/A	1	1.202	--	1.75	0.256	2.04	30'	EL	14.423	0.655	1.2	30'	EL	1.442	0.80	0.256	1.75	30'	EL	14.423		
	HL-93(0pr)	N/A	--	1.558	--	1.35	0.256	2.64	30'	EL	14.423	0.655	1.56	30'	EL	1.442	N/A	--	--	--	--	--		
	HS-20(Inv)	36.000	2	1.365	49.124	1.75	0.256	2.82	30'	EL	11.538	0.655	1.36	30'	EL	1.442	0.80	0.256	2.45	30'	EL	11.538		
	HS-20(0pr)	36.000	--	1.769	63.679	1.35	0.256	3.65	30'	EL	11.538	0.655	1.77	30'	EL	1.442	N/A	--	--	--	--	--		
LEGAL LOAD RATING	SV	SNSH	13.500	--	3.333	45.002	1.4	0.256	5.76	30'	EL	14.423	0.655	3.33	30'	EL	1.442	0.80	0.256	3.95	30'	EL	14.423	
		SNGARBS2	20.000	--	2.581	51.624	1.4	0.256	5.04	30'	EL	11.538	0.655	2.58	30'	EL	1.442	0.80	0.256	3.50	30'	EL	11.538	
		SNAGRIS2	22.000	--	2.487	54.723	1.4	0.256	5.13	30'	EL	11.538	0.655	2.49	30'	EL	1.442	0.80	0.256	3.56	30'	EL	11.538	
		SNCOTTS3	27.250	--	1.684	45.891	1.4	0.256	2.89	30'	EL	14.423	0.655	1.68	30'	EL	1.442	0.80	0.256	1.99	30'	EL	14.423	
		SNAGGRS4	34.925	--	1.551	54.185	1.4	0.256	2.79	30'	EL	14.423	0.655	1.55	30'	EL	1.442	0.80	0.256	1.91	30'	EL	14.423	
		SNS5A	35.550	--	1.645	58.469	1.4	0.256	2.7	30'	EL	14.423	0.655	1.64	30'	EL	1.442	0.80	0.256	1.85	30'	EL	14.423	
		SNS6A	39.950	--	1.547	61.791	1.4	0.256	2.55	30'	EL	14.423	0.655	1.55	30'	EL	1.442	0.80	0.256	1.75	30'	EL	14.423	
	SNS7B	42.000	--	1.578	66.285	1.4	0.256	2.48	30'	EL	14.423	0.655	1.58	30'	EL	1.442	0.80	0.256	1.70	30'	EL	14.423		
	TTST	TNAGRIT3	33.000	--	1.838	60.67	1.4	0.256	3.31	30'	EL	14.423	0.655	1.84	30'	EL	1.442	0.80	0.256	2.27	30'	EL	14.423	
		TNT4A	33.075	--	1.71	56.559	1.4	0.256	3.13	30'	EL	14.423	0.655	1.71	30'	EL	1.442	0.80	0.256	2.15	30'	EL	14.423	
		TNT6A	41.600	--	1.652	68.714	1.4	0.256	2.85	30'	EL	14.423	0.655	1.65	30'	EL	1.442	0.80	0.256	1.96	30'	EL	14.423	
		TNT7A	42.000	--	1.573	66.067	1.4	0.256	2.94	30'	EL	14.423	0.655	1.57	30'	EL	1.442	0.80	0.256	2.02	30'	EL	14.423	
		TNT7B	42.000	--	1.536	64.525	1.4	0.256	2.77	30'	EL	14.423	0.655	1.54	30'	EL	1.442	0.80	0.256	1.90	30'	EL	14.423	
		TNAGRIT4	43.000	--	1.486	63.9	1.4	0.256	2.87	30'	EL	14.423	0.655	1.49	30'	EL	1.442	0.80	0.256	1.97	30'	EL	14.423	
TNAGT5A		45.000	--	1.594	71.736	1.4	0.256	2.79	30'	EL	14.423	0.655	1.59	30'	EL	1.442	0.80	0.256	1.92	30'	EL	14.423		
TNAGT5B	45.000	3	1.399	62.946	1.4	0.256	2.68	30'	EL	11.538	0.655	1.4	30'	EL	1.442	0.80	0.256	1.85	30'	EL	11.538			

LOAD FACTORS:

DESIGN LOAD RATING FACTORS	LIMIT STATE	γ_{DC}	γ_{DW}
	STRENGTH I	1.25	1.50
	SERVICE III	1.00	1.00

NOTES:

MINIMUM RATING FACTORS ARE BASED ON THE STRENGTH I AND SERVICE III LIMIT STATES.
ALLOWABLE STRESSES FOR SERVICE III LIMIT STATE ARE AS REQUIRED FOR DESIGN.

CONTROLLING LOAD RATING

1 DESIGN LOAD RATING (HL-93)

2 DESIGN LOAD RATING (HS-20)

3 LEGAL LOAD RATING **

** SEE CHART FOR VEHICLE TYPE

GIRDER LOCATION

I - INTERIOR GIRDER
EL - EXTERIOR LEFT GIRDER
ER - EXTERIOR RIGHT GIRDER

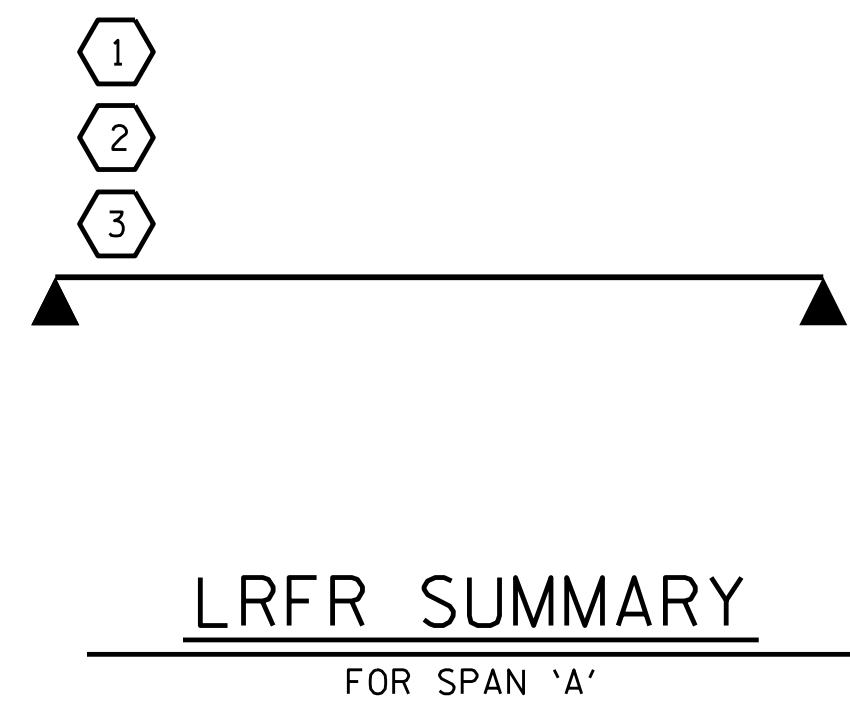

PROJECT NO. 17BP.2.R.92
PITT COUNTY
 STATION: 13+78.50 -L-

ASSEMBLED BY : ZCS	DATE : 06/19
CHECKED BY : MGC	DATE : 09/19
DRAWN BY : CVC 6/10	
CHECKED BY : DNS 6/10	

DOCUMENT NOT CONSIDERED FINAL
UNLESS ALL SIGNATURES COMPLETED

TCS ENGINEERS
 706 HILLSBOROUGH STREET
 SUITE 200
 RALEIGH, NC 27603
 PH (919) 773-8887
 CORP. LICENSE NO.: C-0275

STATE OF NORTH CAROLINA
 DEPARTMENT OF TRANSPORTATION
 RALEIGH

**STANDARD
 LRFR SUMMARY FOR
 30' CORED SLAB UNIT
 120° SKEW
 (NON-INTERSTATE TRAFFIC)**

REVISIONS						SHEET NO.
NO.	BY:	DATE:	NO.	BY:	DATE:	S-3
1			3			TOTAL SHEETS
2			4			19

STD. NO. 21LRFR1.60&120S_30L