

MATCH LINE
(STEP 2 OF 2)
(2 OF 2)

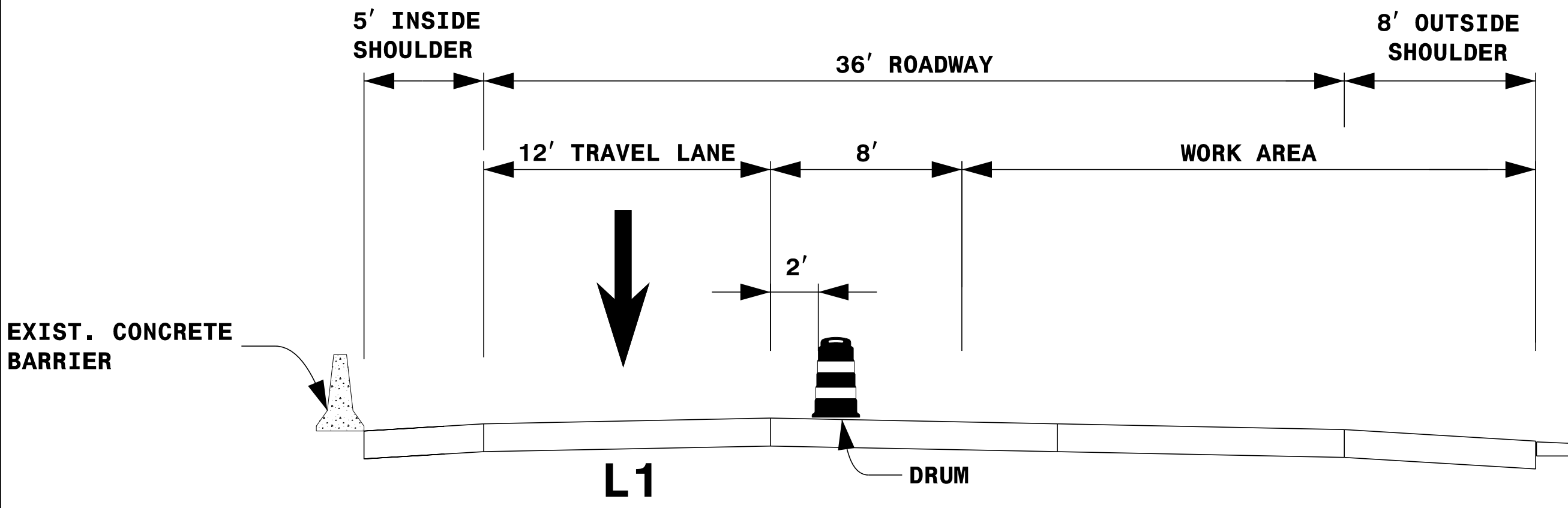

TYPICAL SECTION
SECTION 17E
SOUTHBOUND

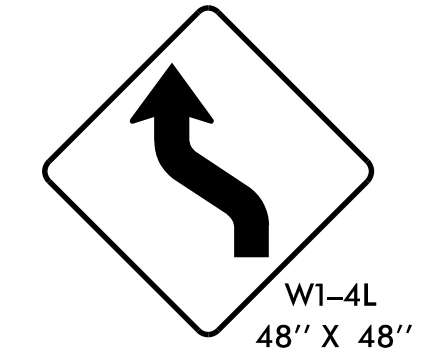

1

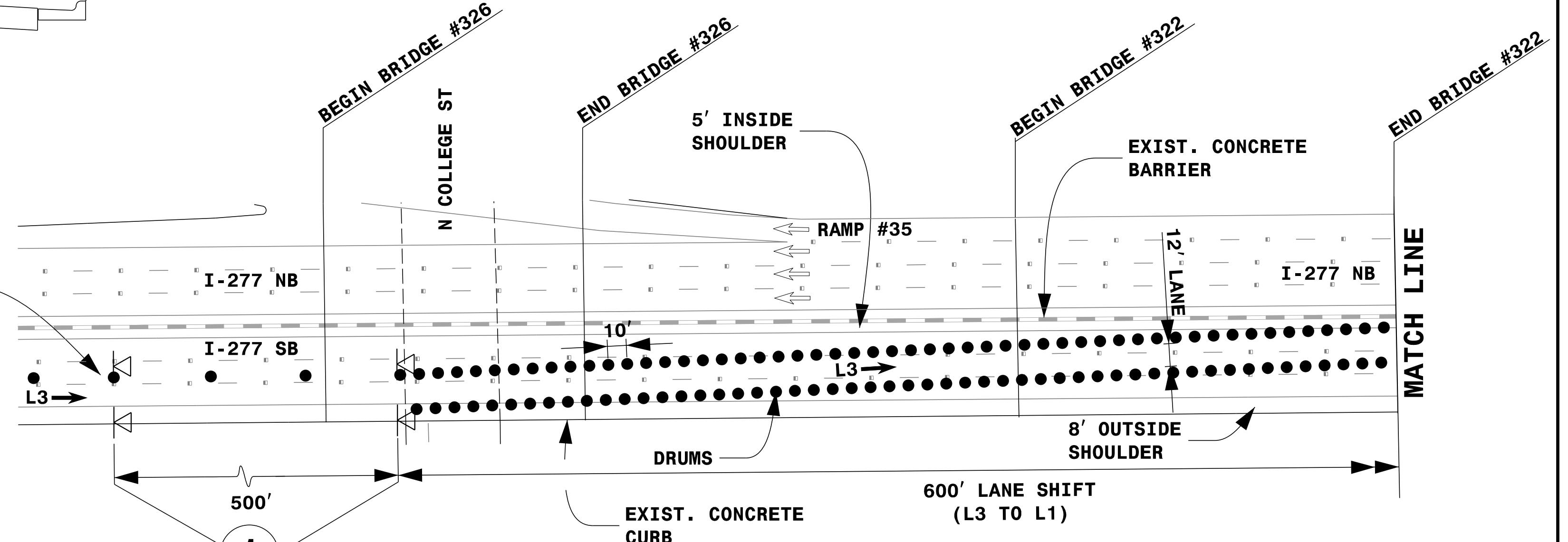

MATCH LINE

LEGEND	
	PORTABLE SIGN
	FLASHING ARROW BOARD (TYPE C) (96"X48" MIN.) "CAUTION MODE"
	TRUCK MOUNTED ATTENUATOR (TMA)
	WORK AREA
	DIRECTION OF TRAFFIC FLOW
	TRAFFIC DRUM

NOTES:

1. THIS DRAWING IS TO BE USED IN CONJUNCTION WITH TMP-15 (OFFSITE DETOUR #39), TMP-58 AND RSD 1101.02 SHEET 8 OF 14.
2. FOR ENTRANCE AND EXIT RAMPS SIGNING, REFER TO RSD 1101.01, DETAIL B & C.
3. FOR ADDITIONAL NOTES, SEE RSD 1101.01, SHEET 2.
4. SEE TMP-3 (PAVEMENT PRESERVATION VICINITY MAP) FOR SECTION LOCATIONS.
5. TRAFFIC CONTROL DEVICE ① SHALL BE INSTALLED PER ENGINEER'S INSTRUCTIONS.

DocuSigned by:
John P. Mazeres
Professional Engineer
SEAL 043935
8/5/2021

STATE OF NORTH CAROLINA
DIVISION OF TRANSPORTATION
WORK ZONE TRAFFIC CONTROL

DOCUMENT NOT CONSIDERED FINAL
UNLESS ALL SIGNATURES COMPLETED

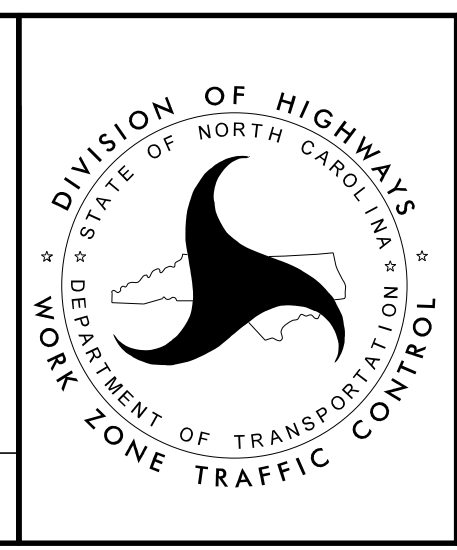

LANE CLOSURE DETAIL
SECTION 17E
SOUTHBOUND
(STEP 2 OF 2)
(1 OF 2)

8/5/2021
2007.L15746E_TMP-57_LANE_CLOSURE_DETAIL_SECTION_17E_SOUTHBOUND (STEP 2 OF 2) (OF 2).dgn
User: jduke