

SEE RSD 1101.02 SHEET 8 OF 14

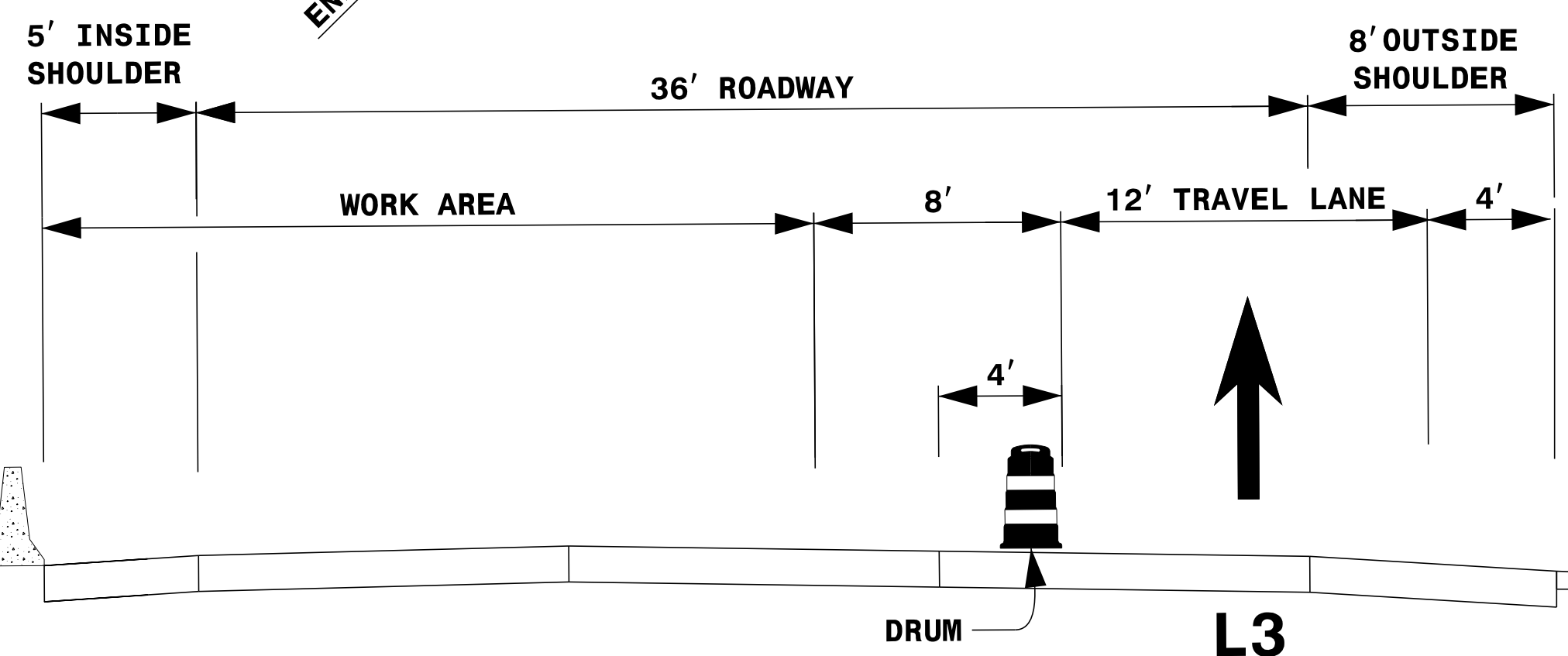

**TYPICAL SECTION  
SECTION 5E NORTHBOUND**

LEGEND	
	PORTABLE SIGN
	FLASHING ARROW BOARD (TYPE C) (96"X48" MIN.) "CAUTION MODE"
	TRUCK MOUNTED ATTENUATOR (TMA)
	WORK AREA
	DIRECTION OF TRAFFIC FLOW
	TRAFFIC DRUM

**NOTES:**

1. THIS DRAWING IS TO BE USED IN CONJUNCTION WITH RSD 1101.02 SHEET 8 OF 14.
2. FOR ENTRANCE AND EXIT RAMP SIGGING, REFER TO RSD 1101.01, DETAIL B & C.
3. FOR ADDITIONAL NOTES, SEE RSD 1101.01, SHEET 2.
4. SEE TMP-3 (PAVEMENT PRESERVATION VICINITY MAP) FOR SECTION LOCATIONS.
5. TRAFFIC CONTROL DEVICES ① AND ② SHALL BE INSTALLED PER ENGINEER'S INSTRUCTIONS.

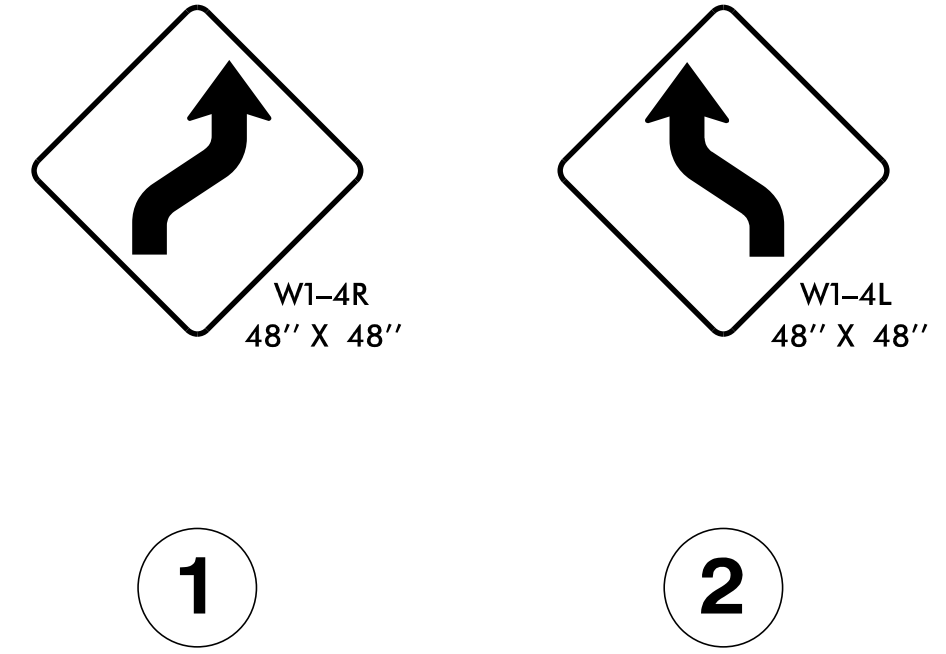

8/5/2021 2:00:45 PM I-5746E\_TMP-31\_LANE\_CLOSURE\_DETAIL\_SECTION\_5E\_NORTHBOUND (STEP 1 OF 2).dgn User: jduke

DocuSigned by:  
*John P. Mazeres*  
JOHN P. MAZERES  
ENGINEER  
SEAL 043935  
8/5/2021

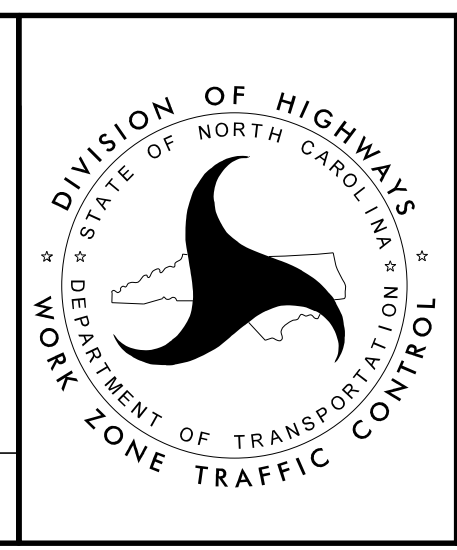

**LANE CLOSURE DETAIL  
SECTION 5E  
NORTHBOUND  
(STEP 1 OF 2)**

**DOCUMENT NOT CONSIDERED FINAL  
UNLESS ALL SIGNATURES COMPLETED**