

DETOUR DESCRIPTION:

I-277 NB EXIT 2A TO E 4TH ST./NC16 TO N.CHURCH ST. AND TO US29/GRAHAM ST.
US74WB TO I-277SB/US7WB TO EXIT 2A TO E 4TH ST./NC16 TO N.CHURCH ST.
AND TO US29/GRAHAM ST.

NOTES:

1. TRAFFIC CONTROL DEVICES ① THRU ⑦ AND ①A THRU ①F SHALL BE INSTALLED PER ENGINEER'S INSTRUCTIONS.
2. FOR DETOUR DESTINATION SIGNS, SEE SIGN DETAIL SHEETS.

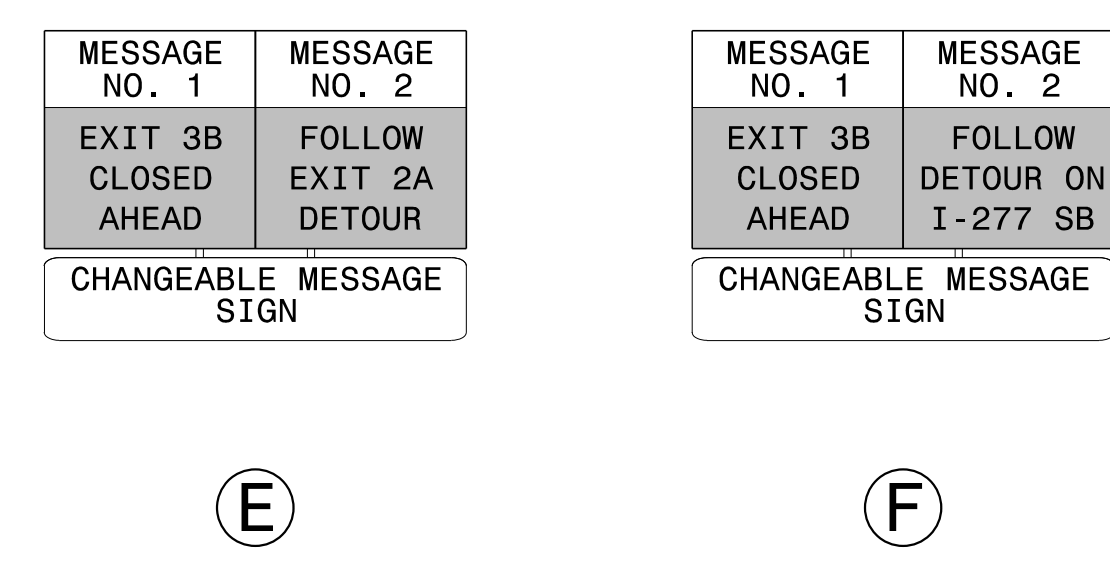
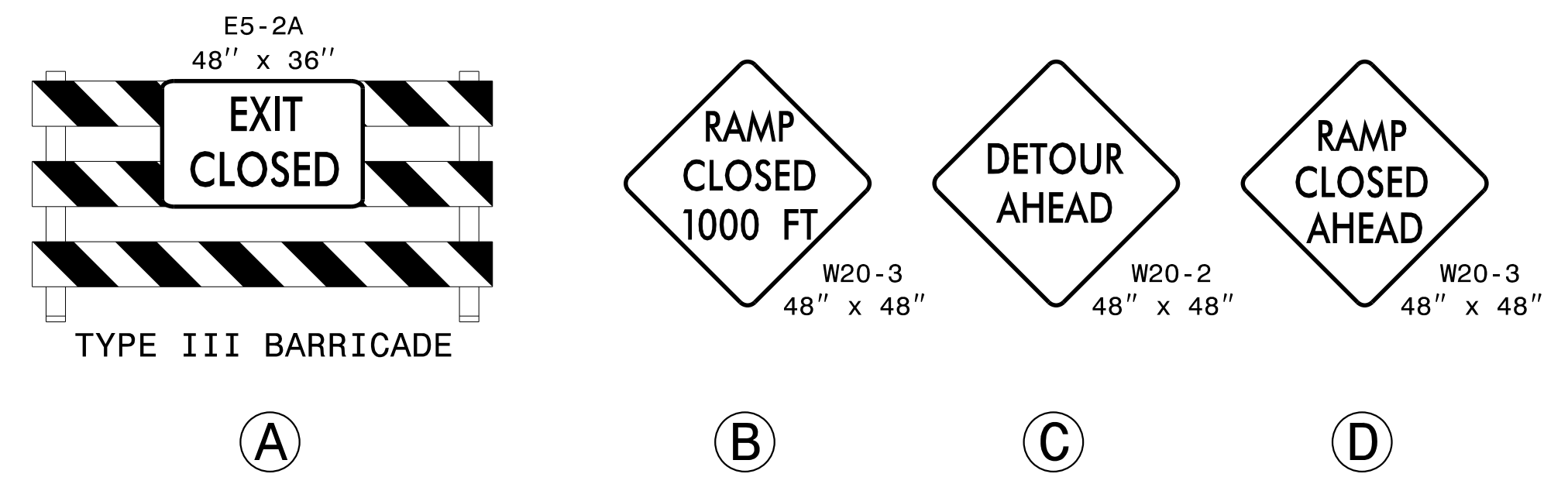

 DOCUMENT NOT CONSIDERED FINAL UNLESS ALL SIGNATURES COMPLETED		OFFSITE DETOUR 35 SIGNING AND ROAD CLOSURE SIGNING
--	--	---