

**2023 S GRANVILLE COUNTY
RESURFACING**

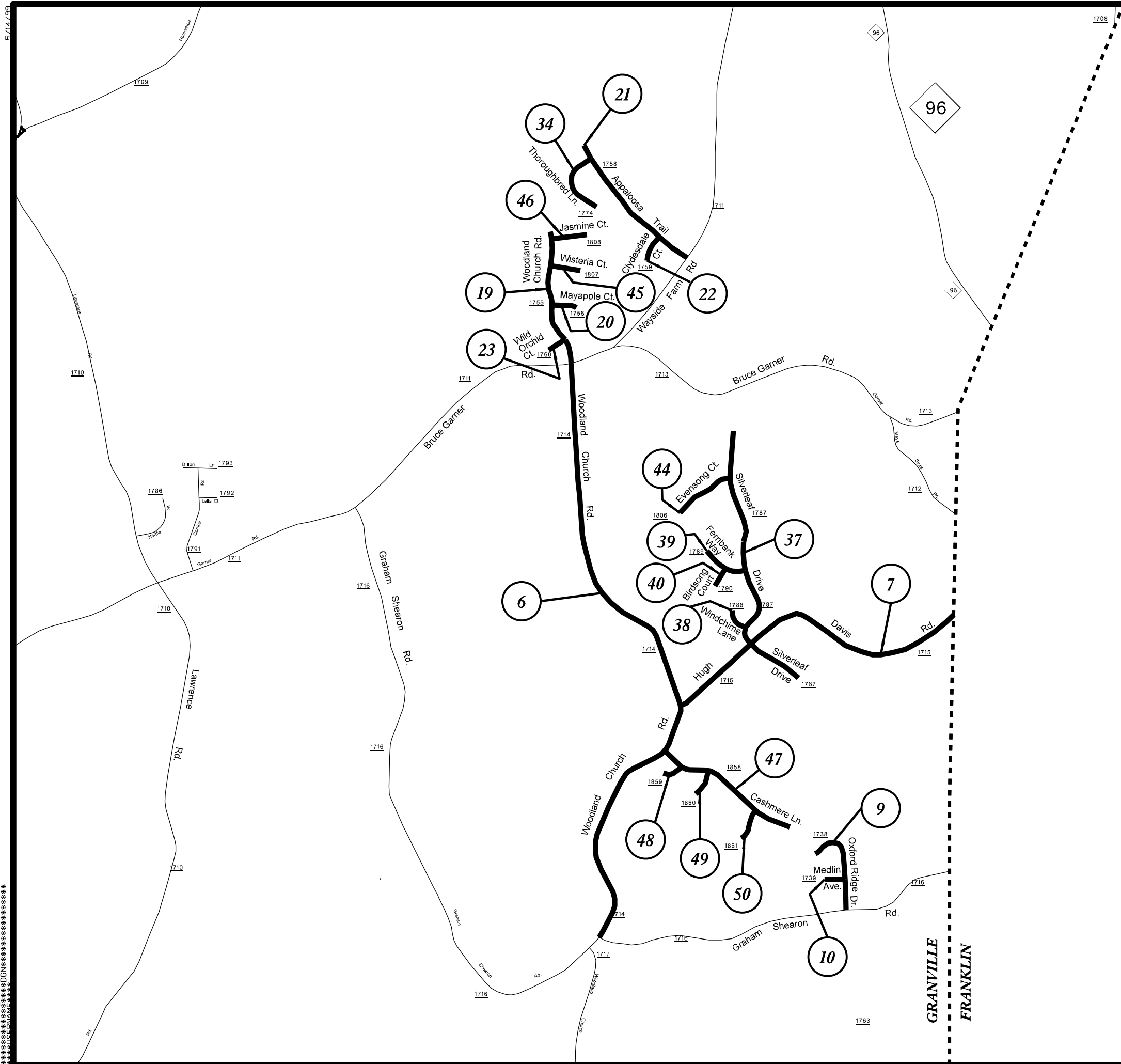

- 6. SR 1714 – WOODLAND CHURCH RD
- 7. SR 1715 – HUGH DAVIS RD
- 9. SR 1738 – OXFORD RIDGE DR
- 10. SR 1739 – MEDLIN AVE
- 19. SR 1755 – WOODLAND CHURCH RD
- 20. SR 1756 – MAYAPPLE CT
- 21. SR 1758 – APPALOOSA TRL
- 22. SR 1759 – CLYDESDALE CT
- 23. SR 1760 – WILD ORCHID CT
- 34. SR 1774 – THOROUGHbred LN
- 37. SR 1787 – SILVERLEAF DR
- 38. SR 1788 – WINDCHIME LN
- 39. SR 1789 – FERNBANK WAY
- 40. SR 1790 – BIRDSONG CT
- 44. SR 1806 – EVENSONG CT
- 45. SR 1807 – WHISTERIA CT
- 46. SR 1808 – JASMINE CT
- 47. SR 1858 – CASHMERE LN
- 48. SR 1859 – CANTERBURY CT
- 49. SR 1860 – CHATHAM CT
- 50. SR 1861 – BROWNING PL

GRANVILLE COUNTY ENGINEERING DEPARTMENT
 1000 EAST MAIN STREET, SUITE 100
 GRANVILLE, OHIO 43031
 (614) 885-4300
 WWW.GRANVILLECOUNTYOHIO.GOV