

p:\gfn\p-bentley.com\gfn\p-01\Documents\Projects\63639\Task 010 B-4626\Discipline\Struct\Drawn\Rowan 3\Archives\Delete\401.113.B4626-SMU_BM02_790003_055 9/2/2021 4:02:58 PM pdf_color_gfcolt_FS.plt Rowan.pen.tbl

GROOVING BRIDGE FLOORS	
APPROACH SLABS	1,628 SQ.FT.
BRIDGE DECK	36,332 SQ.FT.
TOTAL	37,960 SQ.FT.

SUPERSTRUCTURE BILL OF MATERIAL			
	CLASS "AA" CONCRETE	REINFORCING STEEL	EPOXY COATED REINFORCING STEEL
	CU. YARDS	LBS.	LBS.
UNIT 1	391.6	45,280	48,750
UNIT 2	545.6	65,246	64,182
UNIT 3	374.5	43,242	47,010
TOTAL **	1311.7	153,768	159,942

SUPERSTRUCTURE REINFORCING STEEL LENGTHS ARE BASED ON THE FOLLOWING MINIMUM SPLICE LENGTHS					
BAR SIZE	SUPERSTRUCTURE EXCEPT APPROACH SLABS, PARAPET, AND BARRIER RAIL		APPROACH SLABS		PARAPET AND BARRIER RAIL
	EPOXY COATED	UNCOATED	EPOXY COATED	UNCOATED	
#4	1'-11"	1'-7"	1'-11"	1'-7"	2'-6"
#5	2'-5"	2'-0"	2'-5"	2'-0"	3'-1"
#6	2'-10"	2'-5"	3'-7"	2'-5"	3'-8"
#7	4'-2"	2'-9"	-	-	-
#8	4'-9"	3'-2"	-	-	-

BILL OF MATERIAL DECK & DIAPHRAGM - UNIT 1					
BAR	NO.	SIZE	TYPE	LENGTH	WEIGHT
*A1	671	#5	STR.	38'-11"	27,236
A2	671	#5	STR.	38'-11"	27,236
*B1	82	#4	STR.	22'-4"	1,223
*B2	164	#6	STR.	50'-6"	12,440
*B3	144	#6	STR.	20'-4"	4,398
*B4	123	#4	STR.	20'-11"	1,719
*B5	82	#4	STR.	22'-10"	1,251
B6	300	#5	STR.	57'-8"	18,044
*G1	2	#5	STR.	38'-11"	81
*K1	8	#5	1	9'-4"	78
*K2	12	#5	2	12'-2"	152
*S1	56	#4	3	3'-8"	137
REINFORCING STEEL					45,280 LBS.
*EPOXY COATED REINF. STEEL					48,715 LBS.

BILL OF MATERIAL DECK & DIAPHRAGM - UNIT 2					
BAR	NO.	SIZE	TYPE	LENGTH	WEIGHT
*A1	963	#5	STR.	38'-11"	39,088
A2	963	#5	STR.	38'-11"	39,088
*B21	246	#4	STR.	33'-1"	5,437
*B22	82	#6	STR.	60'-0"	7,390
*B23	82	#6	STR.	43'-2"	5,317
*B24	72	#6	STR.	45'-2"	4,885
*B25	82	#4	STR.	29'-11"	1,639
B26	440	#5	STR.	57'-0"	26,158
*G1	2	#5	STR.	38'-11"	81
*K3	8	#5	1	10'-8"	89
*K4	8	#5	2	14'-10"	124
*S1	54	#4	3	3'-8"	132
REINFORCING STEEL					65,246 LBS.
*EPOXY COATED REINF. STEEL					64,182 LBS.

BILL OF MATERIAL DECK & DIAPHRAGM - UNIT 3											
BAR	NO.	SIZE	TYPE	LENGTH	WEIGHT	BAR	NO.	SIZE	TYPE	LENGTH	WEIGHT
*A1	625	#5	STR.	38'-11"	25,369	A43	1	#5	STR.	22'-1"	23
A2	625	#5	STR.	38'-11"	25,369	A44	1	#5	STR.	20'-10"	22
*A3	1	#5	STR.	37'-8"	39	A45	1	#5	STR.	19'-6"	20
*A4	1	#5	STR.	36'-4"	38	A46	1	#5	STR.	18'-2"	19
*A5	1	#5	STR.	35'-1"	37	A47	1	#5	STR.	16'-11"	18
*A6	1	#5	STR.	33'-9"	35	A48	1	#5	STR.	15'-7"	16
*A7	1	#5	STR.	32'-6"	34	A49	1	#5	STR.	14'-4"	15
*A8	1	#5	STR.	31'-2"	33	A50	1	#5	STR.	13'-0"	14
*A9	1	#5	STR.	29'-11"	31	A51	1	#5	STR.	11'-9"	12
*A10	1	#5	STR.	28'-7"	30	A52	1	#5	STR.	10'-5"	11
*A11	1	#5	STR.	27'-3"	28	A53	1	#5	STR.	9'-2"	10
*A12	1	#5	STR.	26'-0"	27	A54	1	#5	STR.	7'-10"	8
*A13	1	#5	STR.	24'-8"	26	A55	1	#5	STR.	6'-6"	7
*A14	1	#5	STR.	23'-5"	24	A56	1	#5	STR.	5'-3"	5
*A15	1	#5	STR.	22'-1"	23	A57	1	#5	STR.	3'-11"	4
*A16	1	#5	STR.	20'-10"	22	A58	3	#5	STR.	3'-4"	10
*A17	1	#5	STR.	19'-6"	20	*B2	82	#6	STR.	50'-6"	6,220
*A18	1	#5	STR.	18'-2"	19	*B3	72	#6	STR.	20'-4"	2,199
*A19	1	#5	STR.	16'-11"	18	*B4	82	#4	STR.	20'-11"	1,146
*A20	1	#5	STR.	15'-7"	16	*B31	82	#4	STR.	22'-10"	1,251
*A21	1	#5	STR.	14'-4"	15	*B32	41	#6	STR.	51'-2"	3,151
*A22	1	#5	STR.	13'-0"	14	*B33	36	#6	STR.	20'-8"	1,117
*A23	1	#5	STR.	11'-9"	12	*B34	21	#4	STR.	21'-5"	300
*A24	1	#5	STR.	10'-5"	11	*B35	20	#4	STR.	13'-8"	183
*A25	1	#5	STR.	9'-2"	10	*B36	41	#6	STR.	48'-2"	2,966
*A26	1	#5	STR.	7'-10"	8	*B37	36	#6	STR.	19'-2"	1,036
*A27	1	#5	STR.	6'-6"	7	*B38	41	#4	STR.	35'-8"	977
*A28	1	#5	STR.	5'-3"	5	B39	30	#5	STR.	56'-3"	1,760
*A29	1	#5	STR.	3'-11"	4	B40	60	#5	STR.	56'-0"	3,504
*A30	3	#5	STR.	3'-4"	10	B41	60	#5	STR.	55'-6"	3,473
A31	1	#5	STR.	37'-8"	39	B42	60	#5	STR.	55'-0"	3,442
A32	1	#5	STR.	36'-4"	38	B43	60	#5	STR.	54'-6"	3,411
A33	1	#5	STR.	35'-1"	37	B44	30	#5	STR.	53'-11"	1,687
A34	1	#5	STR.	33'-9"	35	*G1	1	#5	STR.	38'-11"	41
A35	1	#5	STR.	32'-6"	34	*G2	1	#5	STR.	41'-8"	43
A36	1	#5	STR.	31'-2"	33	*K1	4	#5	1	9'-4"	39
A37	1	#5	STR.	29'-11"	31	*K2	6	#5	2	12'-2"	76
A38	1	#5	STR.	28'-7"	30	*K5	4	#5	1	9'-10"	41
A39	1	#5	STR.	27'-3"	28	*K6	6	#5	2	12'-9"	80
A40	1	#5	STR.	26'-0"	27	*S1	28	#4	3	3'-8"	69
A41	1	#5	STR.	24'-8"	26	*S2	28	#4	3	3'-11"	73
A42	1	#5	STR.	23'-5"	24						
REINFORCING STEEL										43,242 LBS.	
*EPOXY COATED REINF. STEEL										46,973 LBS.	

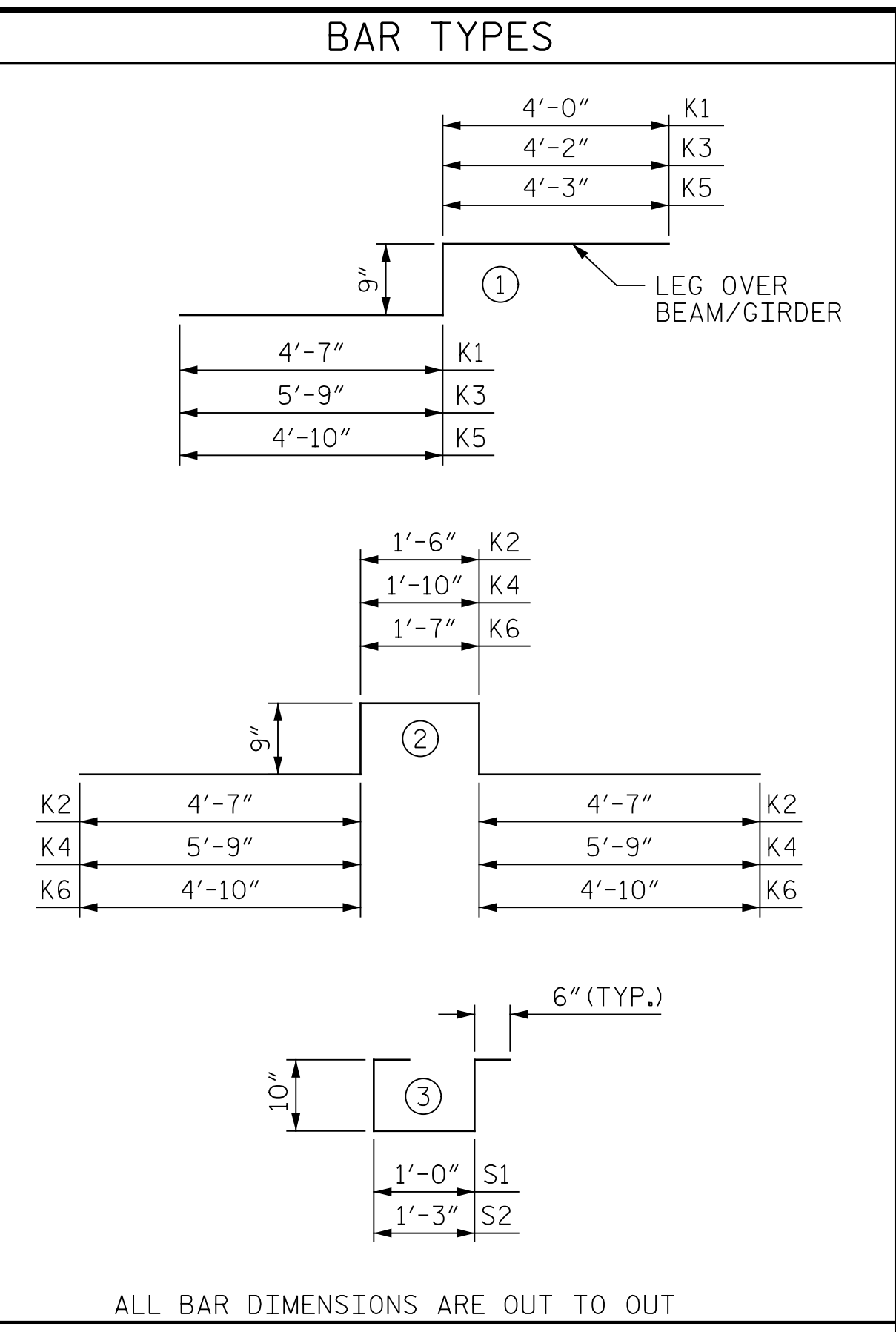

* = EPOXY COATED REINFORCING STEEL
 ** = QUANTITIES FOR BARRIER RAIL ARE NOT INCLUDED.

PROJECT NO. B-4626
STANLY, ROWAN
AND DAVIDSON COUNTY
 STATION: 45+22.65 -EBL-

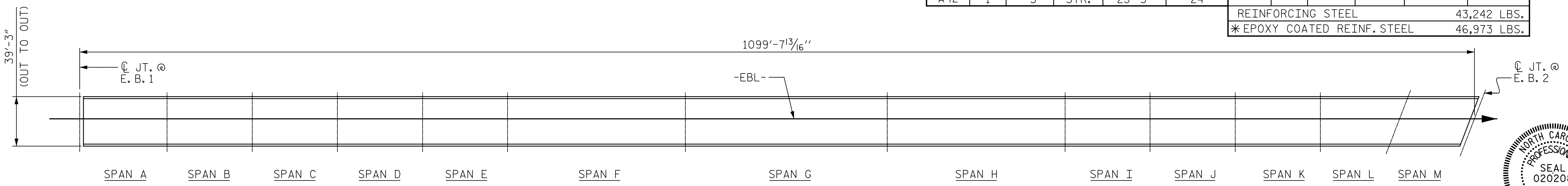

LAYOUT FOR COMPUTING AREA OF REINFORCED CONCRETE DECK SLAB

(SQ. FT. = 43,161)

DRAWN BY : I. FORD DATE : 04/2021
 CHECKED BY : R. FISHER DATE : 05/2021
 DESIGN ENGINEER OF RECORD: R. NELSON DATE : 05/2021

PLANS PREPARED BY:
Gannett Fleming
 Excellence Delivered As Promised
 One Glenwood Avenue
 Suite 900
 Raleigh, NC 27603
 (919) 420-7660
 NC Lic. No. F-0270

DocuSigned by:
 E. B. Nelson
 9/2/2021
 NORTH CAROLINA PROFESSIONAL SEAL 020208
 ENGINEER
 E. B. NELSON, P.E.

DOCUMENT NOT CONSIDERED FINAL UNLESS ALL SIGNATURES COMPLETED

STATE OF NORTH CAROLINA DEPARTMENT OF TRANSPORTATION RALEIGH					
SUPERSTRUCTURE BILL OF MATERIAL					
REVISIONS					
NO.	BY:	DATE:	NO.	BY:	DATE:
1			3		
2			4		

SHEET NO. S1-55	
TOTAL SHEETS 125	