

8/17/99

PROJECT REFERENCE NO. <b>B-4626</b>		SHEET NO. <b>4</b>
RW SHEET NO.		
ROADWAY DESIGN ENGINEER	HYDRAULICS ENGINEER	
<b>DOCUMENT NOT CONSIDERED FINAL UNLESS ALL SIGNATURES COMPLETED</b>		

-EBL-

PI Sta 12+67.80	PI Sta 18+95.92
$\Delta = 3^{\circ} 21' 18.4''$ (RT)	$\Delta = 5^{\circ} 08' 04.0''$ (LT)
$D = 0^{\circ} 37' 35.8''$	$D = 0^{\circ} 56' 49.3''$
$L = 535.44'$	$L = 542.16'$
$T = 267.80'$	$T = 271.26'$
$R = 9,143.80'$	$R = 6,050.00'$

REVISIONS

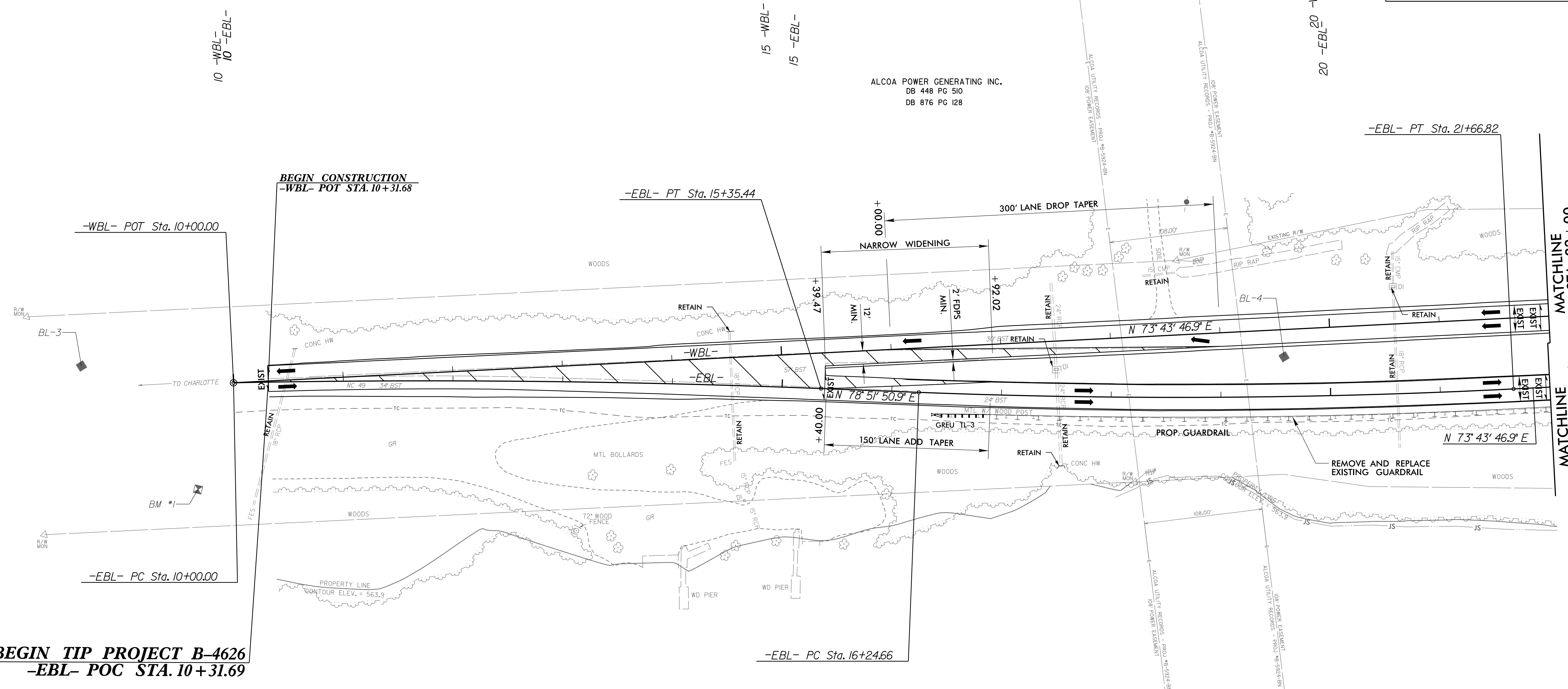

**BEGIN TIP PROJECT B-4626**  
**-EBL- POC STA. 10+31.69**

ALCOA POWER GENERATING INC.  
DB 448 PG 510  
DB 876 PG 128

FOR -EBL- PROFILE, SEE SHEET 9  
FOR -WBL- PROFILE, SEE SHEET 12

14-SEP-2021 11:31  
F:\dwork\p101\B4626\_RDY\_PSH4.dgn